

DISPLAY THIS CARD ON PRINCIPAL FRONTAGE OF WORK  
CITY OF PORTLAND

Please Read  
Application And  
Notes, If Any,  
Attached

BUILDING DEPARTMENT  
PERMIT

PERMIT ISSUED  
NOV 14 2005  
Permit Number 0051634  
CITY OF PORTLAND

This is to certify that PETERS PALMER F & RAUEL L CONLEY, ITS/Shed Hangers

has permission to install an 8' x 12' Shed

AT 201 LAMBERT ST 385 A007001

provided that the person or persons performing or accepting this permit shall comply with all of the provisions of the Statutes of the State and of the Ordinances of the City of Portland regulating the construction, maintenance and use of buildings and structures, and of the application on file in this department.

Apply to Public Works for street line and grade if nature of work requires such information.

Notification of inspection must be given and when permission is procured before this building or part thereof is occupied or closed-in. 48 HOURS NOTICE IS REQUIRED.

A certificate of occupancy must be procured by owner before this building or part thereof is occupied.

OTHER REQUIRED APPROVALS  
Fire Dept.  
Health Dept.  
Appeal Board  
Other Department Name

James Boule 11/9/05  
Director - Building & Inspection Services

PENALTY FOR REMOVING THIS CARD

City of Portland, Maine - Building or Use Permit Application  
389 Congress Street, 04101 Tel: (207) 874-8703, Fax: (207) 874-8716

PERMIT ISSUED

PERMIT NO. 05-1635

ISSUE DATE: NOV 14 2005

CDT 385 A007001

Location of Construction:  
201 LAMBERT ST

Owner Name:  
PETERS PALMER F & RACHEL

Owner Address:  
PMB 1152 PO BOX 9739

Phone:  
2078923636

Business Name:

Contractor Name:  
Shed Happens

Contractor Address:  
1042 Chadborne Rd. Standish

Phone:  
2078923636

Lessee/Buyer's Name

Phone:

Permit Type:  
Sheds

Zone:  
R3

Past Use:  
Single Family Home

Proposed Use:  
Single Family Home/ install an 8' x 12' Shed

Permit Fee:  
\$39.00

Cost of Work:  
\$1,975.00

CEO District:  
5

Proposed Project Description:  
install an 8' x 12' Shed

FIRE DEPT:  
☐ Approved  
☐ Denied

INSPECTION:  
Use Group: R3  
Type: 66

Signature:  
JMB 11/9/05

Signature:

PEDESTRIAN ACTIVITIES DISTRICT (P.A.D.)

Action: ☐ Approved ☐ Approved w/Conditions ☐ Denied

Signature:

Date:

Permit Taken By:  
ldobson

Date Applied For:  
11/08/2005

Zoning Approval

1. This permit application does not preclude the Applicant(s) from meeting applicable State and Federal Rules.

2. Building permits do not include plumbing, septic or electrical work.

3. Building permits are void if work is not started within six (6) months of the date of issuance. False information may invalidate a building permit and stop all work..

Special Zone or Reviews

☐ Shoreland

☐ Wetland

☐ Flood Zone

☐ Subdivision

☐ Site Plan

Maj ☐ Minor ☐ MM ☐

Date: JMB 11/9/05

Zoning Appeal

☐ Variance

☐ Miscellaneous

☐ Conditional Use

☐ Interpretation

☐ Approved

☐ Denied

Date:

Historic Preservation

☒ Not in District or Landmark

☐ Does Not Require Review

☐ Requires Review

☐ Approved

☐ Approved w/Conditions

☐ Denied

Date: JMB

CERTIFICATION

I hereby certify that I am the owner of record of the named property, or that the proposed work is authorized by the owner of record and that I have been authorized by the owner to make this application as his authorized agent and I agree to conform to all applicable laws of this jurisdiction. In addition, if a permit for work described in the application is issued, I certify that the code official's authorized representative shall have the authority to enter all areas covered by such permit at any reasonable hour to enforce the provision of the code(s) applicable to such permit.

SIGNATURE OF APPLICANT	ADDRESS	DATE	PHONE
RESPONSIBLE PERSON IN CHARGE OF WORK, TITLE			
		DATE	PHONE

**City of Portland, Maine - Building or Use Permit**  
389 Congress Street, 04101 Tel: (207) 874-8703, Fax: (207) 874-8716

Permit No:	Date Applied For:	CBL:
05-1635	11/08/2005	385 A007001

Location of Construction: 201 LAMBERT ST	Owner Name: PETERS PALMER F & RACHEL L	Owner Address: PMB 1152 PO BOX 9739	Phone:
Business Name:	Contractor Name: Shed Happens	Contractor Address: 1042 Chadborne Rd. Standish	Phone (207) 892-3636
Lessee/Buyer's Name	Phone:	Permit Type: Sheds	

Proposed Use: Single Family Home/ install an 8' x 12' Shed	Proposed Project Description: install an 8' x 12' Shed
---	---

Dept: Zoning	Status: Approved	Reviewer: Jeanine Bourke	Approval Date: 11/09/2005
Note:			Ok to Issue: <input checked="" type="checkbox"/>
Dept: Building	Status: Not Applicable	Reviewer: Jeanine Bourke	Approval Date: 11/09/2005
Note:			Ok to Issue: <input checked="" type="checkbox"/>
1) This structure is exempt from meeting the City of Portland Building Code based on size.			



## General Building Permit Application

If you or the property owner owes real estate or personal property taxes or user charges on any property within the City, payment arrangements must be made before permits of any kind are accepted.

Location/Address of Construction: <u>201 Lambert St.</u>		
Total Square Footage of Proposed Structure <u>8x12! Wooden Shed</u>		Square Footage of Lot <u>100 wide by 200' deep (20,000 sq ft)</u>
Tax Assessor's Chart, Block & Lot Chart# <u>385</u> Block# <u>A</u> Lot# <u>7</u>	Owner: <u>Palmer Peters</u>	Telephone: <u>775-7911 x240</u> <u>878-4962 Home</u>
Lessee/Buyer's Name (If Applicable)	Applicant name, address & telephone: <u>Palmer F. Peters</u> <u>201 Lambert St</u> <u>Portland, ME 04103</u>	Cost Of Work: \$ Fee: \$ C of O Fee: \$ <u>39<sup>00</sup>00</u>
Current Specific use: Proposed Specific use:		
Project description: <u>Free standing wooden shed 8x12 shed -</u>		
Contractor's name, address & telephone:		
Who should we contact when the permit is ready: <u>Palmer Peters</u>		
Mailing address: Phone: <u>775-7911 Social Services</u> <u>Please Leave message</u>		

Please submit all of the information outlined in the Commercial Application Checklist.  
Failure to do so will result in the automatic denial of your permit.

In order to be sure the City fully understands the full scope of the project, the Planning and Development Department may request additional information prior to the issuance of a permit. For further information visit us on-line at [www.portlandmaine.gov](http://www.portlandmaine.gov), stop by the Building Inspections office, room 315 City Hall or call 874-8703.

I hereby certify that I am the Owner of record of the named property, or that the owner of record authorizes the proposed work and that I have been authorized by the owner to make this application as his/her authorized agent. I agree to conform to all applicable laws of this jurisdiction. In addition, if a permit for work described in this application is issued, I certify that the Code Official's authorized representative shall have the authority to enter all areas covered by this permit at any reasonable hour to enforce the provisions of the codes applicable to this permit.

Signature of applicant: [Signature]

Date: 11-7-05

This is not a permit; you may not commence ANY work until the permit is issued.

**201 LAMBERT STREET-PORTLAND, ME 04103** **Chart # 385** **Block #A** **Lot# 7**

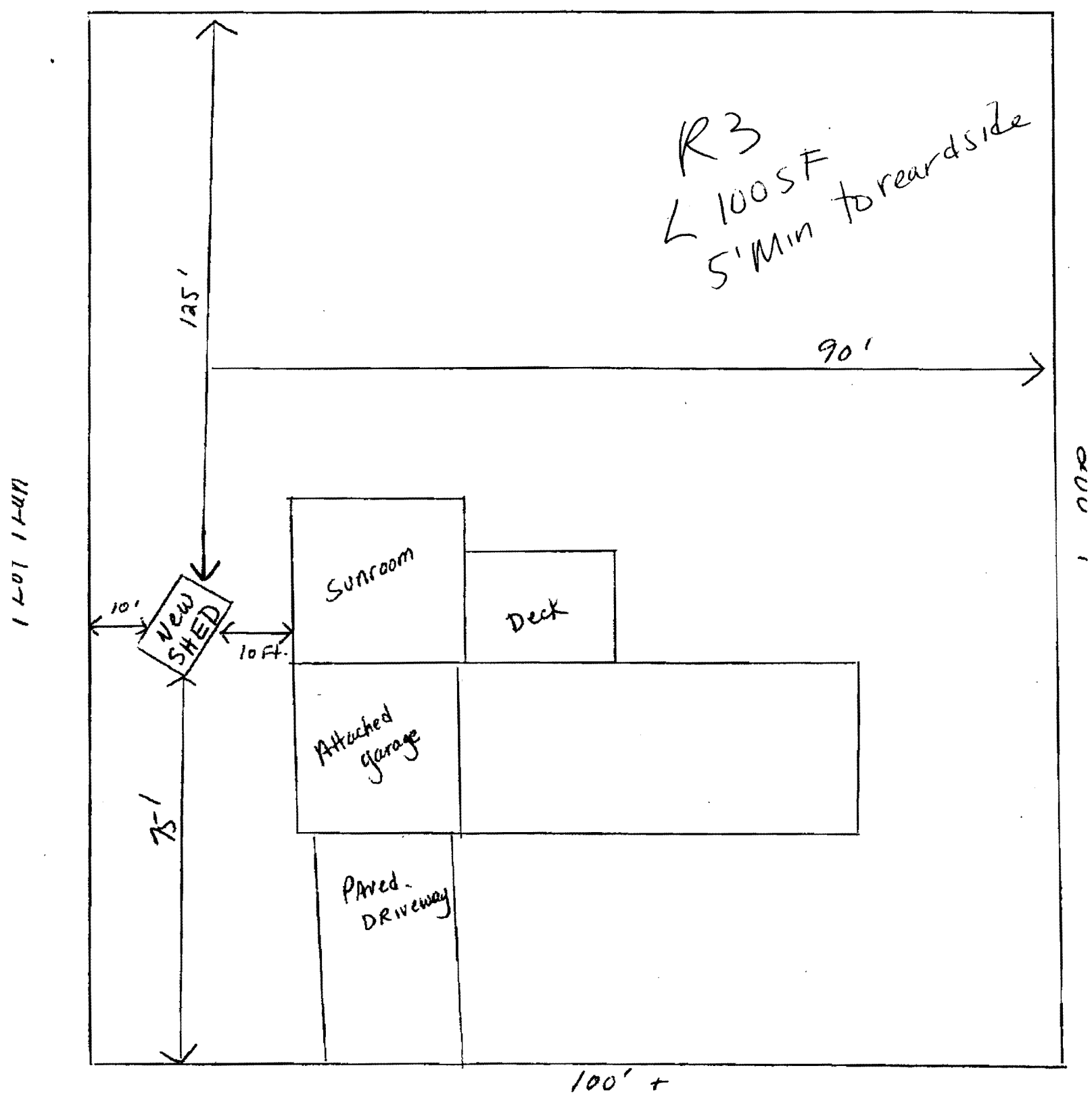

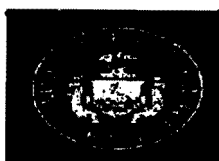

# PORTLAND MAINE

*Strengthening a Remarkable City, Building a Community for Life* • [www.portlandmaine.gov](http://www.portlandmaine.gov)

Health & Human Services Department  
Douglas S. Gardner, Director

Social Services Division  
Robert Duranleau, Administrator

## FAX

TO: LAMI

FROM: P. Peters

FAX #: 874-8716

# OF PGS: 3 (Including Cover)

PHONE: \_\_\_\_\_

DATE: 11-7-05

RE: Review

COMMENTS:

I hope this makes sense -

**NOTICE**

*This fax message is intended for the exclusive use of the individual or entity identified above. It may contain information that is privileged and/or confidential under both state and federal law. If you are not the intended recipient or an agent of the recipient, you are hereby notified that any further dissemination, copy, or disclosure of this communication and information contained herein is strictly prohibited. If you have received this transmittal in error, please immediately notify us at 207-775-5911 and return the original transmission to us by mail without making /retaining a copy. Your cooperation in protecting confidential information is greatly appreciated.*

Social Services Division  
196 Lancaster Street Portland, Maine 04101 Ph (207) 775-7911 Fx (207) 775-7918 TTY 775-6314

## Structurally the Best Shed Available

Our sheds are built on P.T. 4" x 4" Skids  
 6' and 8' wide sheds have 2 x 4 floor joist 16" OC  
 10' and wider sheds have 2 x 6 floor joist 16" OC  
 3/4" CDX Floor Sheathing  
 Walls and roof framing 2 x 4, 16" OC  
 Industry first metal wall bracing  
 7/16" OSB roof sheathing  
 Drip edge on rakes and eaves, 25 yr asphalt shingles  
 2- 8" x 8" Aluminum Gable Vents  
 Shed 8 x 10 and smaller 1 window, larger with 2 windows  
 Standard shed 1 door (30" single, 4' or 5' double barn)  
 Collar ties on all gambrels and regulars 10' and wider

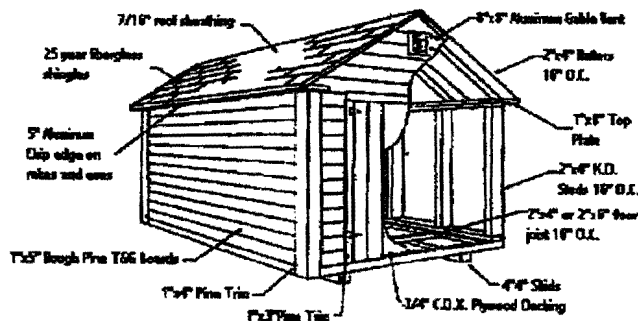

### Notes

- Yes, There is a charge to build your shed on site (this charge may vary) Its better if you can to put the shed someplace you can move it if you ever need to
- The average cost to move one of our sheds is \$350.00, to move a shed built by our competition (our competitors do not offer the service of moving their sheds) \$500.00
- moving rocks, trash, or other item to have a clean safe work area will be charged a minimum fee of \$25.00
- All of our structures are ordered to your specifications so we shall charge a 20% restocking fee on any cancelled orders after construction has begun
- 1/3 payment is due upon ordering your shed, the remaining balance is due upon completion of the shed, upon delivery
- Failed or missed delivery appointments shall be charged \$150
- Materials are subject to change without notice at manufacturers discretion



2 x 4 framing 16" O.C.



Industry First Metal Wall Bracing

### Delivery

- Free delivery within 30 miles, we will deliver anywhere! (each additional mile over 30 will \$2.00 per mile)
- 8 cement blocks included in price (each end and 1 time in the middle up to 16' long, 2 times in the middle on 20' and larger)
- delivery is considered to be driveway only (as long as property owner assumes full non-binding responsibility, we will place your shed where you want within our abilities and reason)
- property owner is fully responsible for all permits to be obtained by their respective town (And are urged to do so) Also property owner is responsible to ensure all set backs from property lines are conformed to
- Site requires a 3' clear perimeter around where shed will be placed, land grade must be less then 12" from highest to lowest points with no protruding stumps or rocks, clear access to site is necessary
- Delivery schedule shall be Monday through Thursday, any shed that requires a Friday or Saturday delivery will be charged an additional \$100.00

### Limited Warranty

Shed Happens, Inc. warrants your building to the original owner as long as it remains in its original location against defects in workmanship and materials for 10 years, under normal residential use only. Our structures are not designed for commercial applications, except by written agreement with our customers. Shed Happens, Inc. makes no warranty expressed or implied with respect to customer's designs and specifications, except that products will be free from defects in workmanship and materials as indicated previously. No warranties are made, expressed or implied, with respect to doors and windows which are used in the construction of our buildings.

### Screenhouse

We offer High Quality Screen Houses with removable metal screens. Available in all sizes, prices are same as Gambrel Shed Prices.

Shed Happens, Inc.

**Structurally the Best manufactured Shed Available Gauranteed**  
**2005**

Mailing Address: 1042 Chadbourne Road Standish, Me 04084  
Phone #892-3636 Fax # 892-3622  
Retail Location: intersection of Rte 302 and 115 North Windham  
**WWW.Shedhappens.com**

ATTN: LARRY

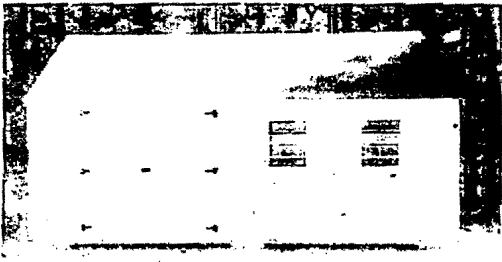

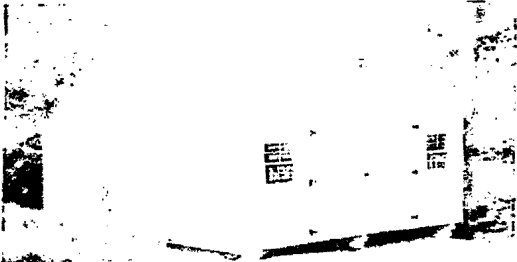

Gable



Gambrel

Delivery, setup and leveling are included granted 3 criteria are satisfied  
Delivery is within 30 miles of Standish, over 30 miles is \$2 per mile one way  
That we can back our 1 ton pickup truck and 18' trailer up to shed site  
That the shed site grade is less than 12" from high corner to low corner

							
6' x 8'	\$1225	12' x 12'	\$2575	6' x 8'	N/A	12' x 12'	\$2725
6' x 10'	\$1400	12' x 14'	\$2900	6' x 10'	N/A	12' x 14'	\$3050
6' x 12'	\$1575	12' x 16'	\$3100	6' x 12'	N/A	12' x 16'	\$3250
8' x 8'	\$1475	12' x 20'	\$3925	8' x 8'	\$1575	12' x 20'	\$4075
8' x 10'	\$1675	12' x 24'	\$4950	8' x 10'	\$1775	12' x 24'	\$5100
8' x 12'	\$1875	14' x 14'	\$3578	8' x 12'	\$1975	14' x 14'	\$3778
8' x 14'	\$2100	14' x 16'	\$4082	8' x 14'	\$2225	14' x 16'	\$4282
8' x 16'	\$2325	14' x 20'	\$5082	8' x 16'	\$2425	14' x 20'	\$5282
8' x 20'	\$2900	14' x 24'	\$6182	8' x 20'	\$3000	14' x 24'	\$6382
10' x 10'	\$1975			10' x 10'	\$2100		
10' x 12'	\$2225			10' x 12'	\$2350		
10' x 14'	\$2475			10' x 14'	\$2625		
10' x 16'	\$2675			10' x 16'	\$2825		
10' x 20'	\$3475			10' x 20'	\$3600		

Quickest average delivery time in the industry. Guaranteed! (Due to delivering completely built sheds) 2 week turnaround for most orders (excludes custom orders and materials) SHI is the only Shed company that can or will give you a delivery date at time of order!





**CITY OF PORTLAND, MAINE**  
Department of Building Inspections

11.8 2003

Received from Palmer Peters

Location of Work 201 Lambert St.

Cost of Construction \$                     

Permit Fee \$ 3900

Building (IL)        Plumbing (IS)        Electrical (I2)        Site Plan (U2)       

Other                                     

CBL: 085-11-7

Check #: 2013 Total Collected \$ 3900

**THIS IS NOT A PERMIT**

No work is to be started until PERMIT CARD is actually posted upon the premises. Acceptance of fee is no guarantee that permit will be granted. PRESERVE THIS RECEIPT. In case permit cannot be granted the amount of the fee will be refunded upon return of the receipt less \$10.00 or 10% whichever is greater.

WHITE - Applicant's Copy  
YELLOW - Office Copy  
PINK - Permit Copy