

CITY OF PORTLAND

SECTION

PERMIT

ISSUED
FEB 14 2003
Permit Number: 020021
CITY OF PORTLAND

Please Read Application And Notes, If Any, Attached

This is to certify that Grace Baptist Church/The Sibley
has permission to Erect 48" x 22.25" Sign
AT .66 Lambert St 384 A021001

provided that the person or persons, firm or corporation accepting this permit shall comply with all of the provisions of the Statutes of Maine and of the Ordinances of the City of Portland regulating the construction, maintenance and use of buildings and structures, and of the application on file in this department.

Apply to Public Works for street line and grade if nature of work requires such information.

Notification of inspection must be given and when permission is procured before this building or part thereof is occupied or closed-in. 24 HOUR NOTICE IS REQUIRED.

A certificate of occupancy must be procured by owner before this building or part thereof is occupied.

OTHER REQUIRED APPROVALS
Fire Dept. _____
Health Dept. _____
Appeal Board _____
Other _____
Department Name _____

[Signature]
Director - Building & Inspecting Services

PENALTY FOR REMOVING THIS CARD

City of Portland, Maine - Building or Use Permit Application

389 Congress Street, 04101 Tel: (207) 874-8703, Fax: (207) 874-8716

Permit No: 03-0071	Issue Date: FEB 14 2003	City: 385-C-2 84 A021001
-----------------------	----------------------------	--------------------------------

Location of Construction: 66 Lambert St	Owner Name: Grace Baptist Church	Owner Address: 476 Summit St	Phone: 7-5509
Business Name: n/a	Contractor Name: The Signery	Contractor Address: 299 Forest Avenue Portland	Phone: 2078797700
Lessee/Buyer's Name: n/a	Phone: n/a	Permit Type: Signs - Permanent	Zone: R-2
Past Use: Grace Babbist Church	Proposed Use: Grace Babbist Church / Erect 48" x 22.25" foam routed sign, painted w/ white copy on white post	Permit Fee: \$36.00	Cost of Work: \$0.00
Proposed Project Description: Erect 48" x 22.25" Sign		FIRE DEPT: <input type="checkbox"/> Approved <input type="checkbox"/> Denied	CEO District: 2
		INSPECTION: Use Group: J Type: NA 2/14/03 [Signature]	
		Signature:	Signature:
		PEDESTRIAN ACTIVITIES DISTRICT (P.A.D.)	
		Action: <input type="checkbox"/> Approved <input type="checkbox"/> Approved w/Conditions <input type="checkbox"/> Denied	
		Signature: _____ Date: _____	

Permit Taken By: gg	Date Applied For: 01/31/2003	Zoning Approval		
<ol style="list-style-type: none"> This permit application does not preclude the Applicant(s) from meeting applicable State and Federal Rules. Building permits do not include plumbing, septic or electrical work. Building permits are void if work is not started within six (6) months of the date of issuance. False information may invalidate a building permit and stop all work. 		Special Zone or Reviews <input type="checkbox"/> Shoreland <input checked="" type="checkbox"/> Wetland <input type="checkbox"/> Flood Zone <input type="checkbox"/> Subdivision <input type="checkbox"/> Site Plan Maj <input type="checkbox"/> Minor <input type="checkbox"/> MM <input type="checkbox"/> Denied Date: 2/13/03 [Signature]	Zoning Appeal <input type="checkbox"/> Variance <input type="checkbox"/> Miscellaneous <input type="checkbox"/> Conditional Use <input type="checkbox"/> Interpretation <input type="checkbox"/> Approved <input type="checkbox"/> Denied	Historic Preservation <input checked="" type="checkbox"/> Not in District or Landmark <input type="checkbox"/> Does Not Require Review <input type="checkbox"/> Requires Review <input type="checkbox"/> Approved <input type="checkbox"/> Approved w/Conditions <input type="checkbox"/> Denied Date: [Signature]

CERTIFICATION

I hereby certify that I am the owner of record of the named property, or that the proposed work is authorized by the owner of record and that I have been authorized by the owner to make this application as his authorized agent and I agree to conform to all applicable laws of this jurisdiction. In addition, if a permit for work described in the application is issued, I certify that the code official's authorized representative shall have the authority to enter all areas covered by such permit at any reasonable hour to enforce the provision of the code(s) applicable to such permit.

SIGNATURE OF APPLICANT	ADDRESS	DATE	PHONE
RESPONSIBLE PERSON IN CHARGE OF WORK, TITLE		DATE	PHONE

City of Portland, Maine - Building or Use Permit

389 Congress Street, 04101 Tel: (207) 874-8703, Fax: (207) 874-8716

Permit No: 03-0071	Date Applied For: 01/31/2003	CBL: 384 A021001
-----------------------	---------------------------------	---------------------

Location of Construction: 66 Lambert St	Owner Name: Grace Baptist Church	Owner Address: 476 Summit St	Phone: 207-797-5509
Business Name: n/a	Contractor Name: The Signery	Contractor Address: 299 Forest Avenue Portland	Phone: (207) 879-7700
Lessee/Buyer's Name: n/a	Phone: n/a	Permit Type: Signs - Permanent	

Proposed Use: Grace Baptist Church / Erect 48" x 22 .25" foam routed sign, painted w/ white copy on white post	Proposed Project Description: Erect 48" x 22.25" Sign
---	--

Dept: Zoning **Status:** Approved with Conditions **Reviewer:** Marge Schmuckal **Approval Date:** 02/13/2003
Note: 2/13/03 Deb A. Reviewed and gave approval to this sign under section 14-526(a)(22) **Ok to Issue:**
 1) This sign is subject to being placed five (5) feet from the front property line.

Dept: Building **Status:** Approved **Reviewer:** Mike Nugent **Approval Date:** 02/14/2003
Note: **Ok to Issue:**

THIS IS NOT A PERMIT/CONSTRUCTION MAY NOT COMMENCE UNTIL THE PERMIT IS ISSUED

Signage Application

If you or the property owner owes real estate or personal property taxes or user charges on any property within the City, payment arrangements must be made before permits of any kind are accepted.

476 66 Lambert 3

Location/Address of Construction: <i>476 Summit St. PORT. Me. 04103</i>		
Total Square Footage of Proposed Structure <i>6 Square Feet</i>	Square Footage of Lot <i>8 acres +/-</i>	
Tax Assessor's Chart, Block & Lot Chart# <i>384</i> Block# <i>A</i> Lot# <i>001</i> <i>Tax Exempt E-22143</i>	Owner: <i>GRACE Baptist Church</i>	Telephone: <i>797-5509</i>
Lessee/Buyer's Name (if Applicable)	Applicant name, address & telephone: <i>GRACE Baptist Church 476 Summit St. PORT. Me. 04103</i>	Total s.f. of signage <i>6</i> x 1.00 per s.f. \$ <i>6.00</i> , plus \$30.00 base fee Fee: \$ <i>36.00</i>
Current use: <i>Church/School</i>		
If the location is currently vacant, what was prior use: _____		
Approximately how long has it been vacant: _____		
Proposed use: <i>Sign to be erected to let people know</i> Project description: <i>we have a Christian Day School.</i>		
Contractor's name, address & telephone:		
Who should we contact when the permit is ready: <i>The Signery (Forest Ave)</i> Mailing address: <i>879-7700</i>		
We will contact you by phone when the permit is ready. You must come in and pick up the permit and review the requirements before starting any work, with a Plan Reviewer. A stop work order will be issued and a \$50.00 fee if any work starts before the permit is picked up. Phone: <i>879-7700</i>		

IF THE REQUIRED INFORMATION IS NOT INCLUDED IN THE SUBMISSIONS THE PERMIT WILL BE AUTOMATICALLY DENIED AT THE DISCRETION OF THE BUILDING/PLANNING DEPARTMENT, WE MAY REQUIRE ADDITIONAL INFORMATION IN ORDER TO APPROVE THIS PERMIT.

I hereby certify that I am the Owner of record of the named property, or that the owner of record authorizes the proposed work and that I have been authorized by the owner to make this application as his/her authorized agent. I agree to conform to all applicable laws of the jurisdiction. In addition, if a permit for work described in this application is issued, I certify that the Code Official's authorized representative shall have the authority to enter all areas covered by this permit at any reasonable hour to enforce the provisions of the codes applicable to this permit.

Signature of applicant: *Elizabeth W. Bayliff, Principal* Date: *12-10-02*

This is NOT a permit, you may not commence ANY work until the permit is issued.
If you are in a Historic District you may be subject to additional permitting and fees with the Planning Department on the 4th floor of City Hall

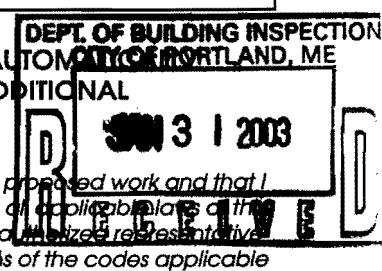

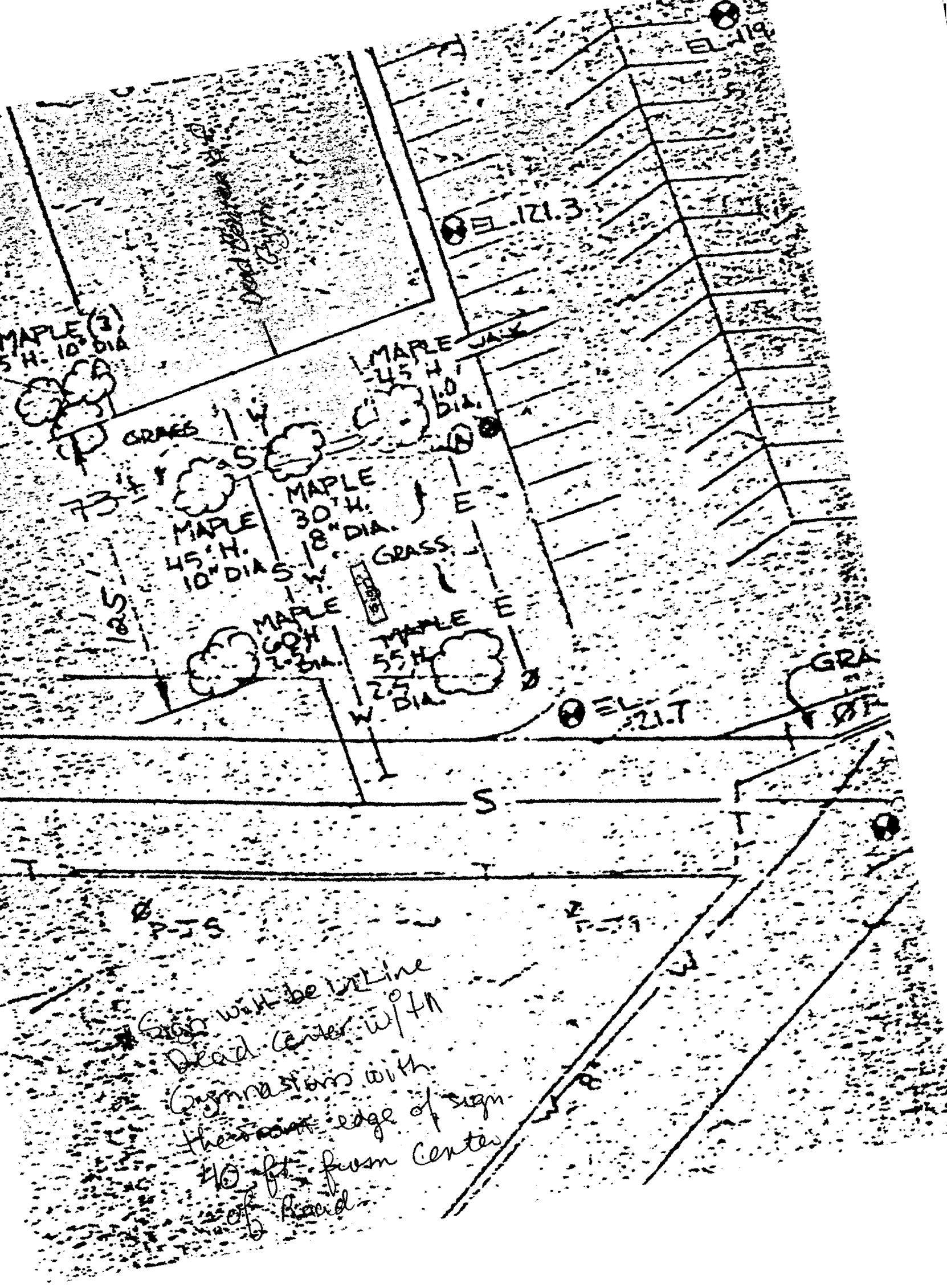

Sign will be in line
 Dead center w/ 411
 (symmetrical with
 their own edge of sign
 10 ft. from center
 of road

SIGNAGE PRE-APPLICATION

PLEASE ANSWER ALL QUESTIONS

ADDRESS: 476 Summit St. PTLDM⁰⁴¹⁰³ ZONE: Comm R-2

OWNER: Grace Baptist Church

APPLICANT: Grace Baptist Church/School (Elbridge Bayle Jr)

ASSESSOR NO. N/A (Principal)

PLEASE CIRCLE APPROPRIATE ANSWER

SINGLE TENANT LOT? YES NO MULTI-TENANT LOT? YES NO

FREESTANDING SIGN? (ex. Pole Sign) YES NO --- DIMENSIONS 48" HEIGHT 22 1/2"

MORE THAN ONE SIGN? YES NO DIMENSIONS _____ HEIGHT _____

SIGN ATTACHED TO BLDG.? YES NO DIMENSIONS _____

MORE THAN ONE SIGN? YES NO DIMENSIONS _____

AWNING: YES NO IS AWNING BACKLIT? YES NO HEIGHT OFF SIDEWALK _____

IS THERE ANY MESSAGE, TRADEMARK OR SYMBOL ON IT? NO

LIST ALL EXISTING SIGNAGE AND THEIR DIMENSIONS:

We currently have a 4ft by 8ft sign for our Church.

*** TENANT BLDG. FRONTAGE (IN FEET): NOT SURE? *** REQUIRED INFORMATION

AREA FOR COMPUTATION

YOU SHALL PROVIDE:

A SITE SKETCH AND BUILDING SKETCH SHOWING EXACTLY WHERE EXISTING AND NEW SIGNAGE IS LOCATED MUST BE PROVIDED. SKETCHES AND/OR PICTURES OF PROPOSED ARE ALSO REQUIRED.

SIGNATURE OF APPLICANT: Elbridge W. Bayle Jr. DATE: 12-10-02



(1) Foam Routed Sign
 22.25x48
 Painted Red w/ White Copy
 White Post

Note
 2 Free Standing Signs
 are spaced

25# allowed
 $22.25 \times 48 = 1068\#$

7.42#
 25# allowed

53" = 4.42' high
 8' high allowed

Post
 53"
 4.42'



CITY OF PORTLAND, MAINE
Department of Building Inspections

Jan 31 2003

Received from Grace Baptist Church

Location of Work 66 Sanborn / 476 Camino

Cost of Construction \$ _____

Permit Fee \$ 3600

Building (IL) Plumbing (IS) _____ Electrical (I2) _____ Site Plan (U2) _____

Other Sign

CBL: 384 A031

Check #: 19615 Total Collected \$ 3600

THIS IS NOT A PERMIT

No work is to be started until PERMIT CARD is actually posted upon the premises. Acceptance of fee is no guarantee that permit will be granted. PRESERVE THIS RECEIPT. In case permit cannot be granted the amount of the fee will be refunded upon return of the receipt less \$10.00 or 10% whichever is greater.

Sign

WHITE - Applicant's Copy
YELLOW - Office Copy
PINK - Permit Copy

