

RIDGE VENTING CONTINUOUS  
 1/2" GYP. BOARD / 1/2" EPS INSULATION  
 1/2" GYP. BOARD @ 1/4" O.C.  
 VINYL TRIM BOARD WITH VENTING  
 5/8" O.S.B. ROOF SHEATHING  
 ZIP ROOF SYSTEM  
 MEMBRANE SHIELD GAVES AND  
 WALLS

RIDGE VENTING CONTINUOUS  
 2" X 2" RIDGE BOARD  
 2" X 2" @ 16" O.C. ROOF RAFTERS  
 5/8" O.S.B. ROOF SHEATHING  
 ZIP ROOF SYSTEM  
 MEMBRANE SHIELD GAVES AND  
 WALLS  
 ASPHALT ROOF SHINKLES

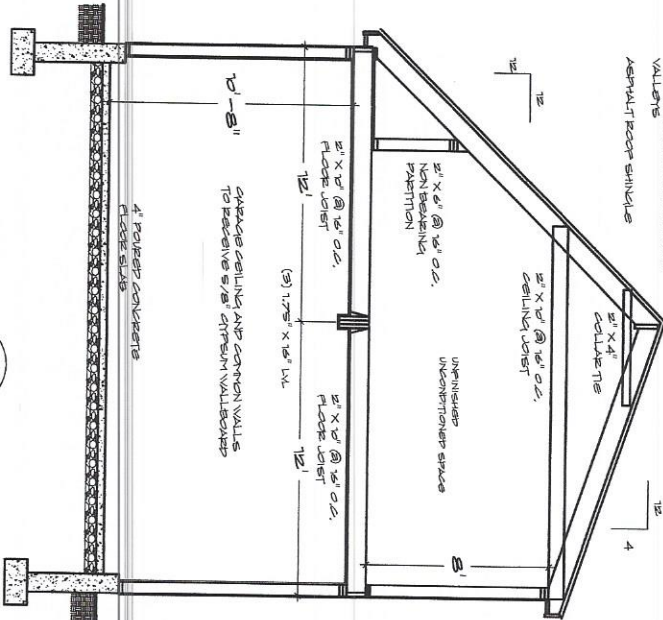

SECTION 2

3/8"=1'-0"

RIDGE VENTING CONTINUOUS  
 1/2" GYP. BOARD / 1/2" EPS INSULATION  
 1/2" GYP. BOARD @ 1/4" O.C.  
 VINYL TRIM BOARD WITH VENTING  
 5/8" O.S.B. ROOF SHEATHING  
 ZIP ROOF SYSTEM  
 MEMBRANE SHIELD GAVES AND  
 WALLS

RIDGE VENTING CONTINUOUS  
 2" X 2" RIDGE BOARD  
 2" X 2" @ 16" O.C. ROOF RAFTERS  
 5/8" O.S.B. ROOF SHEATHING  
 ZIP ROOF SYSTEM  
 MEMBRANE SHIELD GAVES AND  
 WALLS  
 ASPHALT ROOF SHINKLES

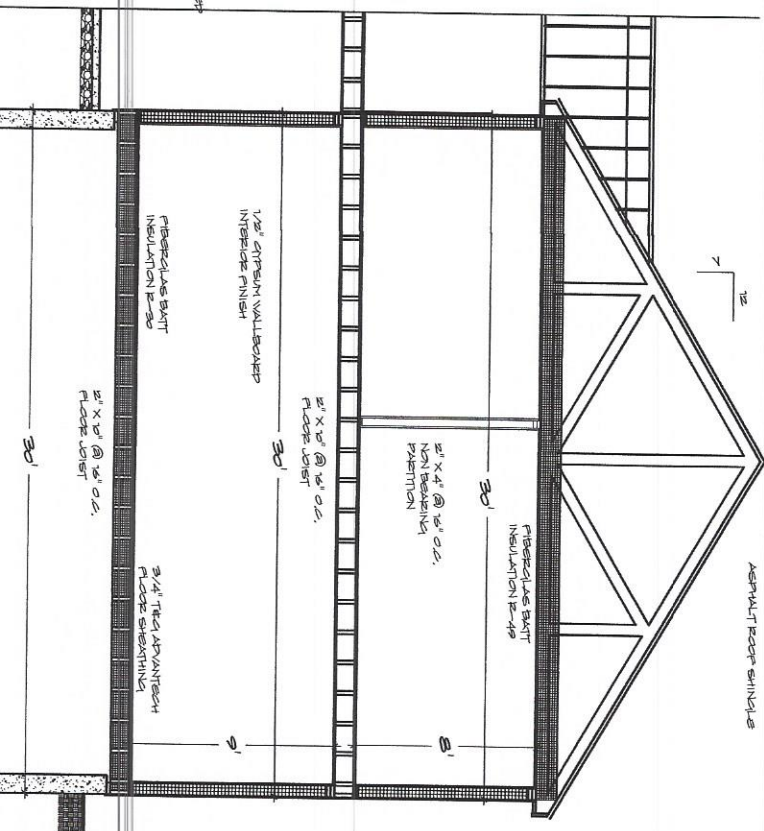

SECTION 1

3/8"=1'-0"

S-12

RT  
 RESIDENTIAL DESIGN  
 DESIGNERS  
 CONSULTANT  
 CORPORATION  
 FRENCHVILLE  
 P.O. BOX 67  
 CONWAY, NH  
 03823-0067  
 TEL: 603-853-1111  
 FAX: 603-853-1112

AMERICAN  
 INSTITUTE  
 OF BUILDING  
 OFFICERS  
 REGISTERED  
 PROFESSIONAL  
 ARCHITECTS  
 STATE OF NEW HAMPSHIRE  
 LICENSE NO. 10000

SHEET 1  
 CROSS SECTION  
 DATE 6-24-11  
 REVISION  
 SHEET NUMBER  
 5