

DISPLAY THIS CARD ON PRINCIPAL FRONTAGE OF WORK



CITY OF PORTLAND

BUILDING PERMIT

This is to certify that ANZELC RUSSELL PROPERTIES LLC Located At 392 AUBURN

Job ID: 2011-08-1961-ALTR

CBL: 383 - - A - 021 - 001 - - - -

has permission to Rebuild 18' x 26' garage in same footprint
provided that the person or persons, firm or corporation accepting this permit shall comply with all of the provisions of the Statues of Maine and of the Ordinances of the City of Portland regulating the construction, maintenance and use of the buildings and structures, and of the application on file in the department.

Notification of inspection and written permission procured before this building or part thereof is lathed or otherwise closed-in. 48 HOUR NOTICE IS REQUIRED.

A final inspection must be completed by owner before this building or part thereof is occupied. If a certificate of occupancy is required, it must be

Fire Prevention Officer

Code Enforcement Officer / Plan Reviewer

**THIS CARD MUST BE POSTED ON THE STREET SIDE OF THE PROPERTY
PENALTY FOR REMOVING THIS CARD**

BUILDING PERMIT INSPECTION PROCEDURES

Please call 874-8703 or 874-8693 (ONLY)

or email: buildinginspections@portlandmaine.gov

With the issuance of this permit, the owner, builder or their designee is required to provide adequate notice to the city of Portland Inspections Services for the following inspections. Appointments must be requested 48 to 72 hours in advance of the required inspection. The inspection date will need to be confirmed by this office.

- **Please read the conditions of approval that is attached to this permit!! Contact this office if you have any questions.**
 - **Permits expire in 6 months. If the project is not started or ceases for 6 months.**
 - **If the inspection requirements are not followed as stated below additional fees may be incurred due to the issuance of a "Stop Work Order" and subsequent release to continue.**
1. Building location and footing inspection required prior to pouring concrete.
 2. Close-in inspection required prior to drywalling or insulating.
 3. Final inspection required upon completion of work.

The project cannot move to the next phase prior to the required inspection and approval to continue, REGARDLESS OF THE NOTICE OF CIRCUMSTANCES.

IF THE PERMIT REQUIRES A CERTIFICATE OF OCCUPANCY, IT MUST BE PAID FOR AND ISSUED TO THE OWNER OR DESIGNEE BEFORE THE SPACE MAY BE OCCUPIED.



PORTLAND MAINE

Strengthening a Remarkable City, Building a Community for Life • www.portlandmaine.gov

Director of Planning and Urban Development
Penny St. Louis

Job ID: 2011-08-1961-ALTR

Located At: 392 AUBURN

CBL: 383 - - A - 021 - 001 - - - -

Conditions of Approval:

Building

1. Separate permits are required for any electrical, plumbing, sprinkler, fire alarm HVAC systems, heating appliances, commercial hood exhaust systems and fuel tanks. Separate plans may need to be submitted for approval as a part of this process.
2. Application approval based upon information provided by applicant. Any deviation from approved plans requires separate review and approval prior to work.

City of Portland, Maine - Building or Use Permit Application

389 Congress Street, 04101 Tel: (207) 874-8703, FAX: (207) 8716

Job No: 2011-08-1961-ALTR	Date Applied: 8/9/2011	CBL: 383 - - A - 021 - 001 - - - - -	
Location of Construction: 392 AUBURN STREET	Owner Name: ANZELC RUSSELL PROPERTIES LLC	Owner Address: 49 CLIFTON ST PORTLAND, ME - MAINE 04101	Phone: 776-2144
Business Name:	Contractor Name: Ken Bolstridge	Contractor Address: 294 Main Street, Westbrook, ME 04092	Phone: 468-4805
Lessee/Buyer's Name:	Phone:	Permit Type: rebuild demoed garage	Zone: R-3
Past Use: Single family dwelling	Proposed Use: Same: single family dwelling - to rebuild demolished 18' x 26' garage (under #2011-08- 1960) in the same footprint and building envelope	Cost of Work: \$5000.00	CEO District:
		Fire Dept: <input checked="" type="checkbox"/> Approved <input type="checkbox"/> Denied <input type="checkbox"/> N/A	Inspection: Use Group: <i>R3/C</i> Type: <i>SB</i>
Proposed Project Description: rebuild 18' x 26' garage on exact footprint.		Signature: <i>[Handwritten Signature]</i>	Signature: <i>[Handwritten Signature]</i>
Permit Taken By: Gayle		Pedestrian Activities District (P.A.D.)	

	Zoning Approval		
	Special Zone or Reviews	Zoning Appeal	Historic Preservation
1. This permit application does not preclude the Applicant(s) from meeting applicable State and Federal Rules.	<input type="checkbox"/> Shoreland	<input type="checkbox"/> Variance	<input checked="" type="checkbox"/> Not in Dist or Landmark
2. Building Permits do not include plumbing, septic or electrical work.	<input type="checkbox"/> Wetlands	<input type="checkbox"/> Miscellaneous	<input type="checkbox"/> Does not Require Review
3. Building permits are void if work is not started within six (6) months of the date of issuance. False informatin may invalidate a building permit and stop all work.	<input type="checkbox"/> Flood Zone	<input type="checkbox"/> Conditional Use	<input type="checkbox"/> Requires Review
	<input type="checkbox"/> Subdivision	<input type="checkbox"/> Interpretation	<input type="checkbox"/> Approved
	<input type="checkbox"/> Site Plan	<input type="checkbox"/> Approved	<input type="checkbox"/> Approved w/Conditions
	<input type="checkbox"/> Maj <input type="checkbox"/> Min <input type="checkbox"/> MM	<input type="checkbox"/> Denied	<input type="checkbox"/> Denied
	Date: <i>OK with conditions</i> <i>S 8/16/11</i>	Date:	Date: <i>[Handwritten Signature]</i>

CERTIFICATION

I hereby certify that I am the owner of record of the named property, or that the proposed work is authorized by the owner of record and that I have been authorized by the owner to make this application as his authorized agent and I agree to conform to all applicable laws of this jurisdiction. In addition, if a permit for work described in the appication is issued, I certify that the code official's authorized representative shall have the authority to enter all areas covered by such permit at any reasonable hour to enforce the provision of the code(s) applicable to such permit.

SIGNATURE OF APPLICANT ADDRESS DATE PHONE

RESPONSIBLE PERSON IN CHARGE OF WORK, TITLE DATE PHON

read August 9

2011 08196

R-3



General Building Permit Application

If you or the property owner owes real estate or personal property taxes or user charges on any property within the City, payment arrangements must be made before permits of any kind are accepted.

Location/Address of Construction: <u>392 Huburn St (Garage)</u>		
Total Square Footage of Proposed Structure/Area <u>468</u>	Square Footage of Lot <u>22275</u>	Number of Stories <u>1</u>
Tax Assessor's Chart, Block & Lot Chart# <u>383</u> Block# <u>H-021</u> Lot# <u>001</u>	Applicant *must be owner, Lessee or Buyer* Name <u>Pamela Anzela</u> Address <u>49 Clifton St.</u> City, State & Zip <u>Portland Me 04601</u>	Telephone: <u>207 776 2144</u>
Lessee/DBA (If Applicable)	Owner (if different from Applicant) Name Address City, State & Zip	Cost Of Work: \$ <u>5,600</u> C of O Fee: \$ Total Fee: \$ <u>870</u>
Current legal use (i.e. single family) <u>Garage</u> Number of Residential Units _____ If vacant, what was the previous use? _____ Proposed Specific use: _____ Is property part of a subdivision? _____ If yes, please name _____ Project description: <u>detached 10'x26' Garage Remove & Replace exact footprint</u>		
Contractor's name: <u>owner</u>		
Address: <u>49 Clifton St</u> <u>Mail To 468 4805</u>		
City, State & Zip <u>Portland Me 04601</u> Telephone: <u>294 Main St. 776 2144</u>		
Who should we contact when the permit is ready: <u>owner Waterbury Me</u> Telephone: _____		
Mailing address: <u>04692</u>		

Please submit all of the information outlined on the applicable Checklist. Failure to do so will result in the automatic denial of your permit.

In order to be sure the City fully understands the full scope of the project, the Planning and Development Department may request additional information prior to the issuance of a permit. For further information or to download copies of this form and other applications visit the Inspections Division on-line at www.portlandmaine.gov, or stop by the Inspections Division office, room 315 City Hall or call 874-8703.

I hereby certify that I am the Owner of record of the named property, or that the owner of record authorizes the proposed work and that I have been authorized by the owner to make this application as his/her authorized agent. I agree to conform to all applicable laws of this jurisdiction. In addition, if a permit for work described in this application is issued, I certify that the Code Official's authorized representative shall have the authority to enter all areas covered by this permit at any reasonable hour to enforce the provisions of the codes applicable to this permit.

Signature: _____ Date: 8-8-11

This is not a permit; you may not commence ANY work until the permit is issued

392 Auburn St

Proposed

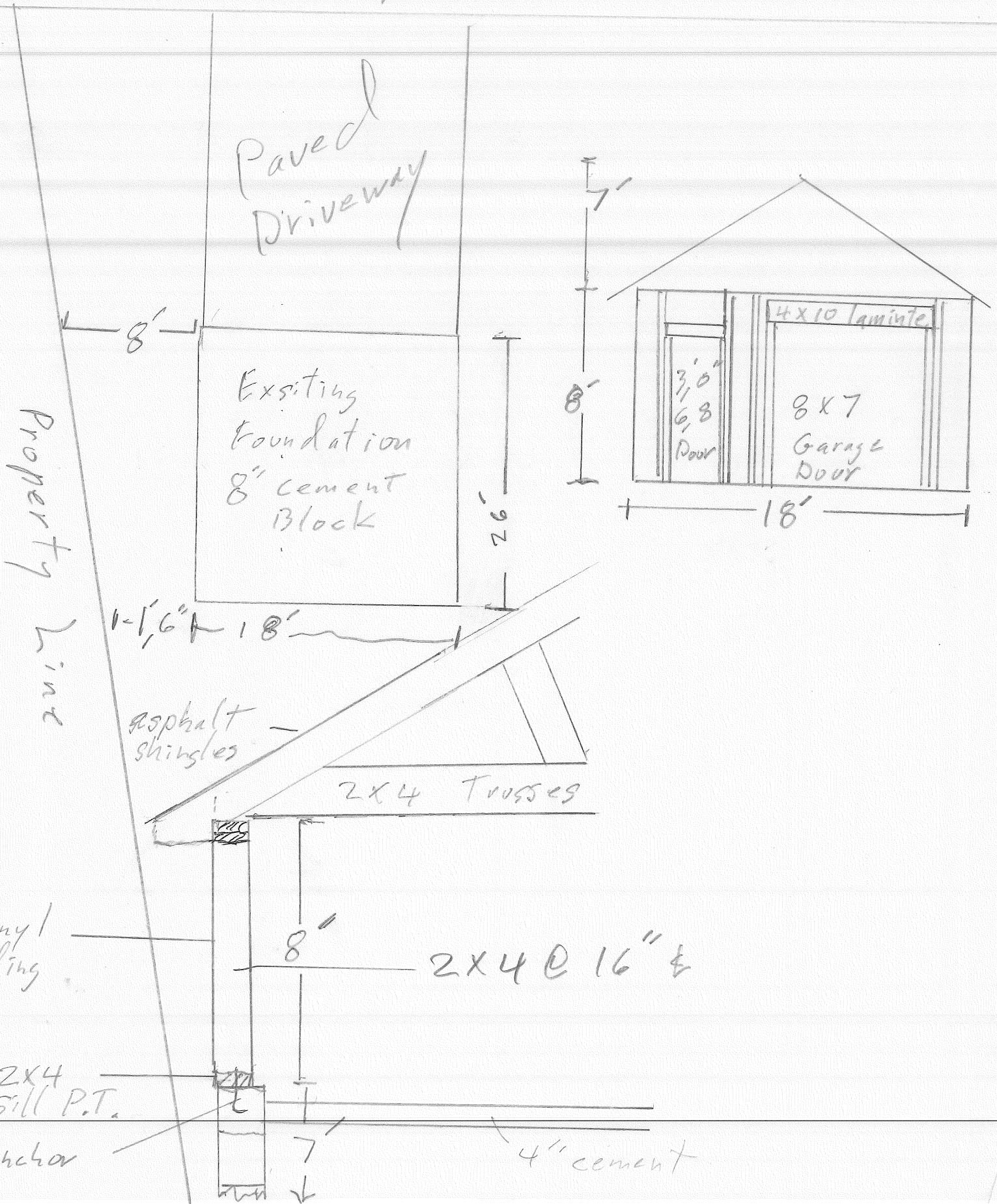

Auburn St.

392 AS Found

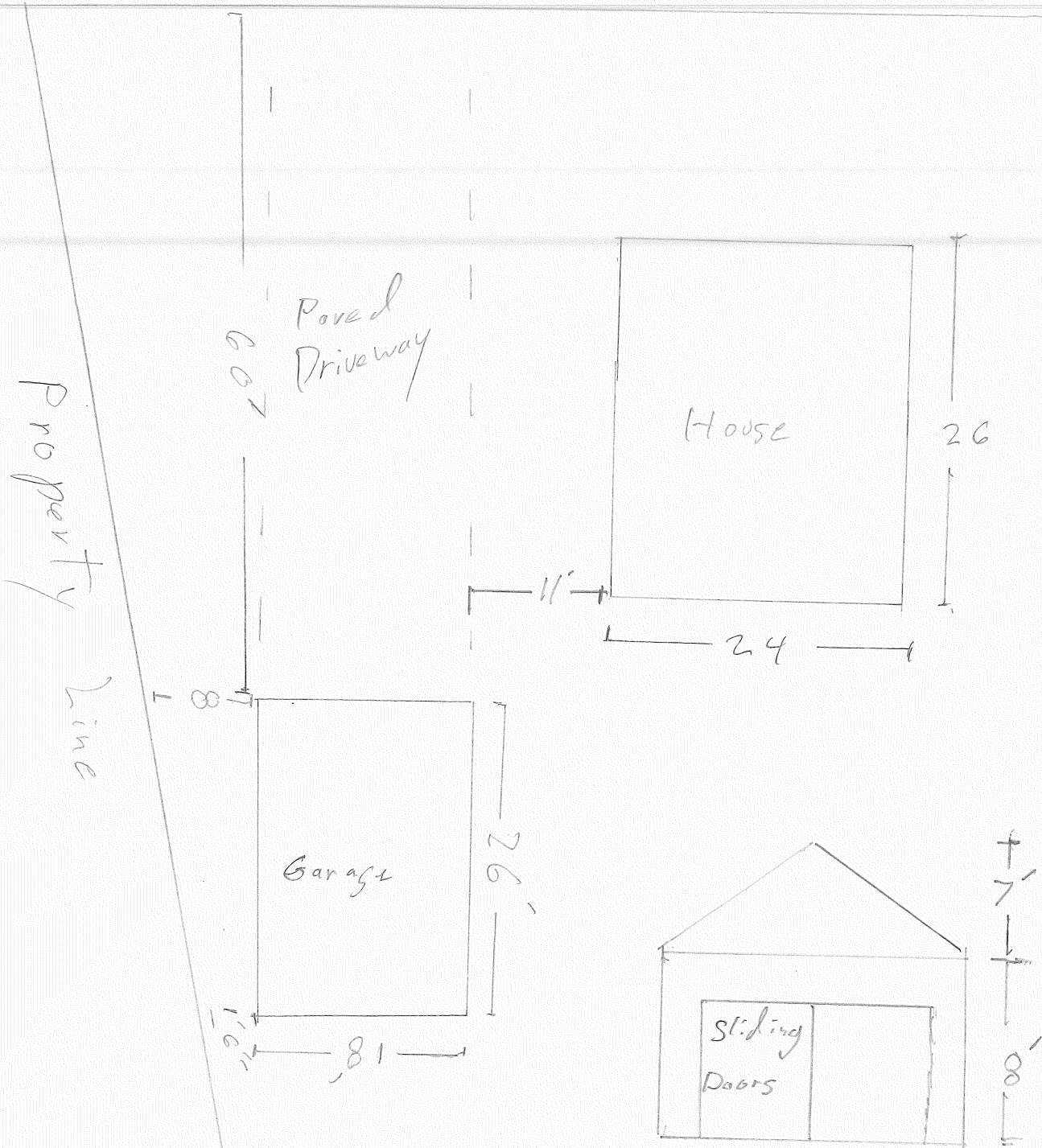



CITY OF PORTLAND, MAINE

Department of Building Inspections

Original Receipt

August 9 2011

Received from Kenneth D. Partridge

Location of Work 292 Main St. Portland, ME

Cost of Construction \$ _____ Building Fee: _____

Permit Fee \$ _____ Site Fee: _____

Certificate of Occupancy Fee: _____

Total: _____

Building (IL) _____ Plumbing (I5) _____ Electrical (I2) _____ Site Plan (U2) _____

Other Dem-o 50.00

CBL: 292 A02 Garage 70.00

Check #: 510 Total Collected \$ 120.00

**No work is to be started until permit issued.
Please keep original receipt for your records.**

Taken by: [Signature]

WHITE - Applicant's Copy
YELLOW - Office Copy
PINK - Permit Copy