

WINDOW SCHEDULE									
NUMBER	LABEL	QTY	FLOOR	SIZE	WIDTH	HEIGHT	R/O	DESCRIPTION	HEADER
W01	ADH2858	2	1	2757DH	31 1/4"	67 1/4"	32"X68"	DOUBLE HUNG	2X6X35" (2)
W02	ADH2858-3	1	1	8257	97 3/4"	67 1/4"	98 1/2"X68"	MULLED UNIT	2X12X101 1/2" (2)
W03	ADH3030	1	1	211211DH	35 1/4"	35 1/4"	36"X36"	DOUBLE HUNG	2X11X39" (2)
W04	CENTER ARCH	1	1	8240FX	97 3/4"	48"	98 1/2"X48 3/4"	FIXED GLASS-AT	2X11X101 1/2" (2)
W05	LH PARTIAL CORD	1	1	2728FX	31 1/4"	32 1/4"	32"X33"	FIXED GLASS-AT	2X12X35" (2)
W06	RH PARTIAL CORD	1	1	2728FX	31 1/4"	32 1/4"	32"X33"	FIXED GLASS-AT	2X12X35" (2)

DOOR SCHEDULE										
NUMBER	LABEL	QTY	FLOOR	SIZE	WIDTH	HEIGHT	R/O	DESCRIPTION	HEADER	THICKNESS
D01	FWHDS468 PALR	1	1	5368 EX	63 1/4"	79 1/2"	64"X80 1/8"	EXT. DOUBLE HINGED DOOR F07 - COLOR - BONE	2X12X67" (2)	1 3/4"

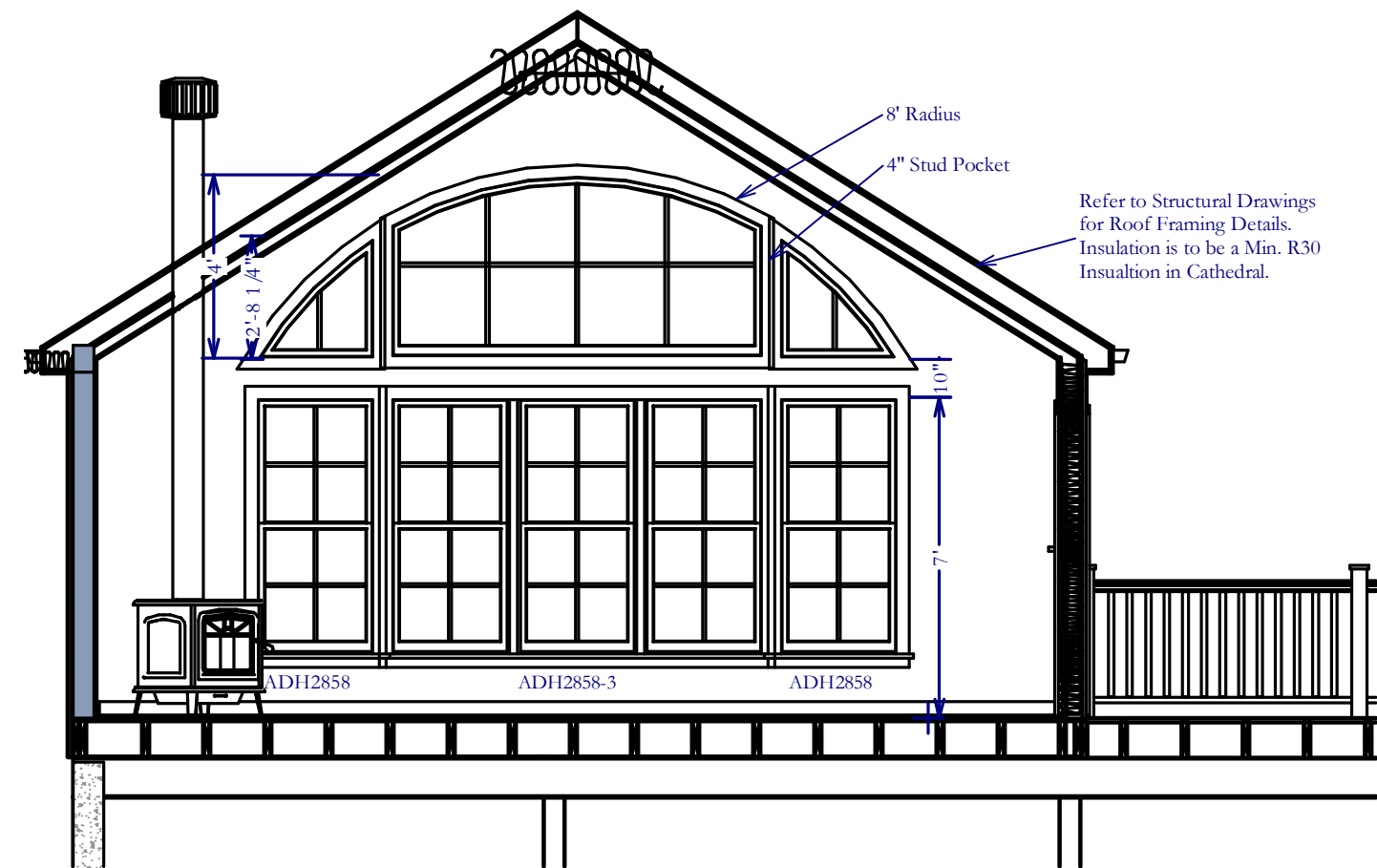

1
A1

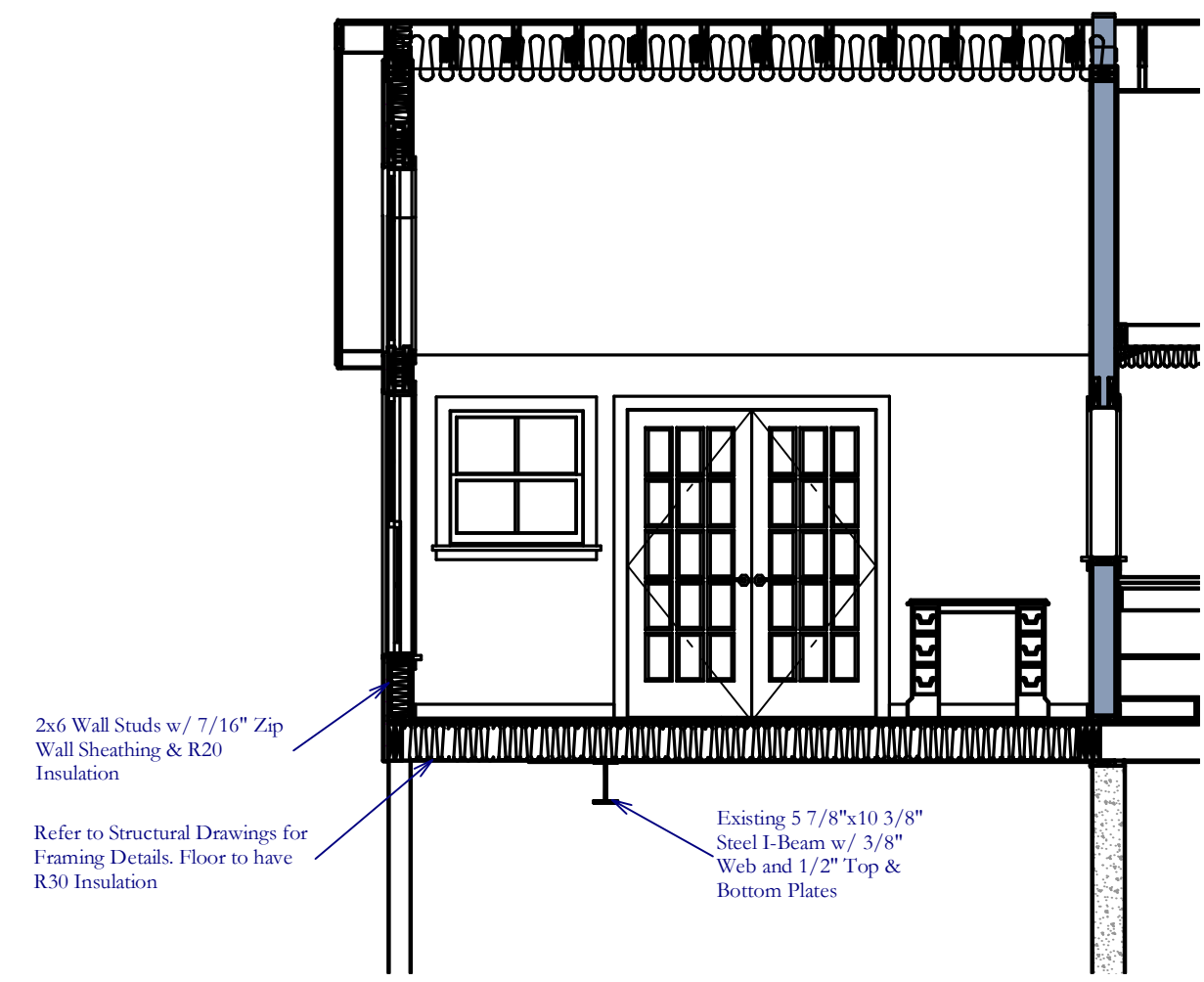

2
A1

REVISIONS By

GRENIER ADDITION
 ROBERT GRENIER
 370 SUMMIT STREET PORTLAND, ME 04103
 M.R. Brewer Fine Woodworking, Inc. - 91 Bell Street, Portland, ME 04103 - (207) 797-7534 - Fax (207) 797-0973

Date: 1/26/12
 Scale: 1/4"=1'
 Drawn by: MRB
 Job: 11672
 Page #:

A1

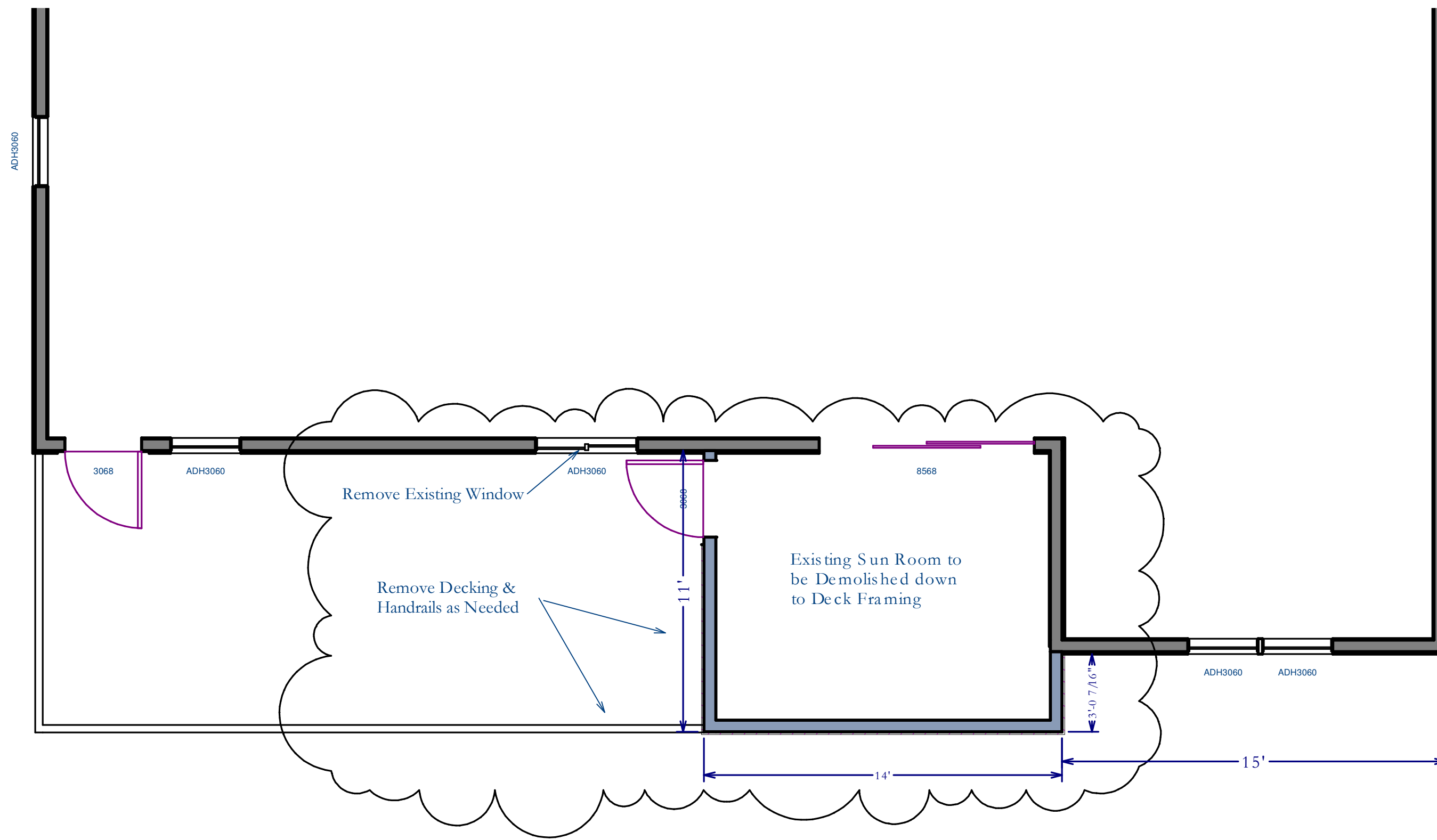

Picture of Existing Sun Room

REVISIONS	By

GRENIER ADDITION
 ROBERT GRENIER
 370 SUMMIT STREET PORTLAND, ME 04103

M.R. Brewer Fine Woodworking, Inc. - 91 Bell Street, Portland, ME 04103 - (207) 797-7534 - Fax (207) 797-0973

Date: 1/26/12
 Scale:
 Drawn by: MRB
 Job: 11672
 Page #:

D1