



Jeff Levine, AICP, Director
Planning & Urban Development Department

Tammy Munson, Director
Inspections Division

Electronic Signature and Fee Payment Confirmation

Notice: Your electronic signature is considered a legal signature per state law.

By digitally signing the attached document(s), you are signifying your understanding this is a legal document and your electronic signature is considered a **legal signature** per Maine state law. You are also signifying your intent on paying your fees by the opportunities below.

I, the undersigned, intend and acknowledge that no permit application can be reviewed until payment of appropriate permit fees are **paid in full** to the Inspections Office, City of Portland Maine by method noted below:

- Within 24-48 hours, once my complete permit application and corresponding paperwork has been electronically delivered, I intend to **call the Inspections Office** at 207-874-8703 and speak to an administrative representative and provide a credit/debit card over the phone.
- Within 24-48 hours, once my permit application and corresponding paperwork has been electronically delivered, I intend to **hand deliver** a payment method to the Inspections Office, Room 315, Portland City Hall.
- I intend to deliver a payment method through the U.S. Postal Service mail once my permit paperwork has been electronically delivered.

Applicant Signature: Paula E. Junkins

Date: 10/17/14

I have provided digital copies and sent them on:

Date: 10/17/14

NOTE: All electronic paperwork must be delivered to buildinginspections@portlandmaine.gov or by physical means ie; a thumb drive or CD to the office.



Acknowledgment of Code Compliance Responsibility- Fast Track Project



I, Paula E. Junkins am the owner or duly **authorized owner's agent** of the property listed below
Print Legal Name

18 Jackson Street
Physical Address

I am seeking a permit for the construction or installation of:

One Fujitsu Heat Pump

Proposed Project Description

I understand that the permits obtained pursuant to this acknowledgement of code compliance responsibility will be in my name and that I am acting as the **general contractor** for this project. I accept full responsibility for the work performed.

I am submitting for a permit authorized by the **State of Maine Uniform Building and Energy Code (MUBEC), Fuel Board Laws and Rules and all locally adopted codes and standards applying to Plumbing, Electrical, Fire Prevention and Protection in anticipation of having it approved or approved with conditions.** I have read the following statement and understand that **failure to comply with all conditions once construction is begun may necessitate an immediate work stoppage until such time as compliance with the stipulated conditions is attained.** I certify that I have made a diligent inquiry regarding the need for concurrent state or federal permits to engage in the work requested under this building permit, and no such permits are required or I will have obtained the required permits prior to issuance of this permit. I understand that the granting of this permit shall not be construed as satisfying the requirements of other applicable Federal, State or Local laws or regulations, including City of Portland historic preservation requirements, if applicable. I understand and agree that this permit does not authorize the violation of regulations.

In addition, I understand and agree that this building permit does not authorize the violation of the **12 M.R.S. § 12801 et seq. - Endangered Species.**

I certify under penalty of perjury and under the laws of the State of Maine the foregoing is true and correct. I further certify that all easements, deed restrictions, or other encumbrances restricting the use of the property are shown on the site plans submitted with this application.

I hereby apply for a permit as a owners agent of the below listed property and by so doing will assume responsibility for compliance with all applicable codes, bylaws, rules and regulations.
Owner or Owner's Agent

I further understand that it is my responsibility to schedule inspections of the work as required and that the City's inspections will, at that time, check the work for code compliance. The City's inspectors may require modifications to the work completed if it does not meet applicable codes. PEJ INITIAL HERE

Sign Here: Paula E. Junkins
Owner or Owner's Authorized Agent

Date: 10/17/14

PLEASE ALSO FILL OUT AND SIGN SECOND PAGE



Acknowledgment of Code Compliance Responsibility- Fast Track Project

OFFICE USE ONLY

PERMIT # _____

CBL # _____



THIS PROJECT IS ELIGIBLE FOR FAST TRACK PERMITTING BECAUSE IT IS IN THE FOLLOWING CATEGORY / CATEGORIES (CHECK ALL THAT APPLY):

- One/Two Family Swimming Pools, Spas or Hot Tubs
- One/Two Family Decks, Stairs and Porches (attached or detached) First Floor Only
- One/Two Family Detached One Story Accessory Structures (garages, sheds, etc.) not to exceed 600sq ft with no habitable space
- Home Occupations (excluding day cares)
- One/Two Family Renovation/Rehabilitation (within the existing shell)
- Attached One /Two Family Garages /Additions/Dormers bearing the seal of a licensed design professional
- New *Sprinklered* One and Two Family Homes (bearing the seal of a licensed design professional stating code compliance) – **MUST STILL RECEIVE LEVEL 1 SITE PLAN APPROVAL FROM PLANNING**
- One/Two Family HVAC (including boilers, furnaces, heating appliances, pellet and wood stoves)
- Interior office renovations with no change of use (no expansions; no site work; no load bearing structural changes are eligible) bearing the seal of a licensed design professional stating code compliance
- Interior Demolition with no load bearing demolition
- Amendments to existing permits
- Commercial HVAC systems (with structural and mechanical plans bearing the seal of a licensed design professional stating code compliance)
- Commercial HVAC for Boilers/Furnaces/Heating Appliances
- Commercial Signs or Awnings
- Exterior Propane Tanks
- Residential or Commercial Subsurface Waste Water Systems (No Rule Variance Only)
- Renewal of Outdoor Dining Areas
- Temporary Outdoor Tents and stages under 750 sq ft per tent or stage
- Fire Suppression Systems (Both non-water and water based installations)
- Fences over 6'-0" in height
- Site work only
- Retaining walls over 4ft in height with stamped plans (or approval from inspection staff)

I understand that if the property is located in a historic district this application will also be reviewed by Historic Preservation. I further understand that the Building Inspections Division reserves the right to deny a fast track eligible project.

Sign Here: Paula E. Junkins
Owner or Owner's Authorized Agent

Date: 10/17/14

Andrew Roy



Descriptor/Area

- A: -----
- B: 1Fr
32 sqft
- C: WD
260 sqft
- D: OFP
60 sqft
- E: RG1
360 sqft

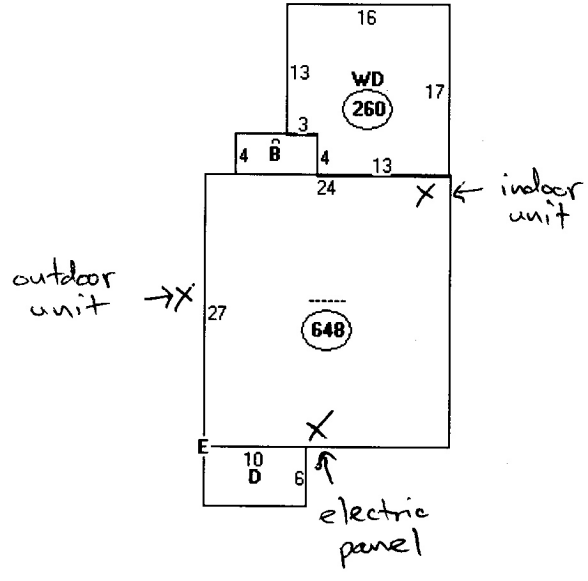

15RLS2 Submittal

AOU15RLS2, ASU15RLS2 Inverter Driven Heat Pump

Job Name: Andrew Roy
 Location: 18 Jackson Street
 Engineer: n/a
 Submitted to: City of Portland
 Submitted by: Stoggen Energy
 Reference: n/a

Approval: _____
 Date: _____
 Construction: _____
 Unit #: _____
 Drawing #: _____

Outdoor Unit Power 208-230/VAC-1Ph-60Hz
 Available Voltage Range 187-253VAC
 Fuse Size, Max. 20A
 MCA 13.5A

Compressor Inverter Driven Variable Speed DC Rotary
 No. used 1
 Output 1000W
 Lubricant Oil POE (RB68)

Fan type Propeller
 Motor Output 115W
 Airflow Rate Cooling/Heating (High) 1206 / 1082CFM

Refrigerant R410A
 Outdoor Unit 2lbs 12.0oz
 Control Electronic Expansion Valve
 O.D. Discharge (in) 1/4"(Flare)
 O.D. Suction (in) 1/2"(Flare)

Dimensions H x W x D
 Uncrated (in) 24-1/2 x 31-3/32 x 11-11/32
 (mm) (620 x 790 x 290)
 Crated (in) 28-1/16 x 37-7/32 x 15-9/16
 (mm) (713 x 945 x 395)

Weight Outdoor
 Net 86lbs (39kg)
 Gross Shipping 95lbs (43kg)

Cooling
 Rated Capacity 14,500BTU/h
 Min-Max Capacity 3,100~18,400BTU/h
 Rated Power Input 4.25kw
 Max. Power Input 5.40kw
 SEER 21.5
 Outdoor Sound Rating 51dB

Heating
 Rated Capacity 18,000BTU/h
 Min-Max Capacity 3,100~23,900BTU/h
 Rated Power Input 5.28kw
 Max. Power Input 7.00kw
 HSPF 12
 Outdoor Sound Rating 51dB

Piping Lengths
 Max. Piping Length (Total) 66ft
 Max. Pipe Height Difference 49ft
 Connection method (Flared)

Operating Range
 Cooling 14°F~115°F DB
 Heating -5°F~75°F DB

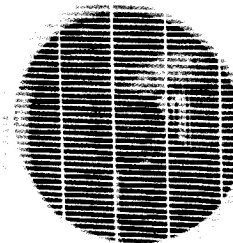

FUJITSU
 Halcyon

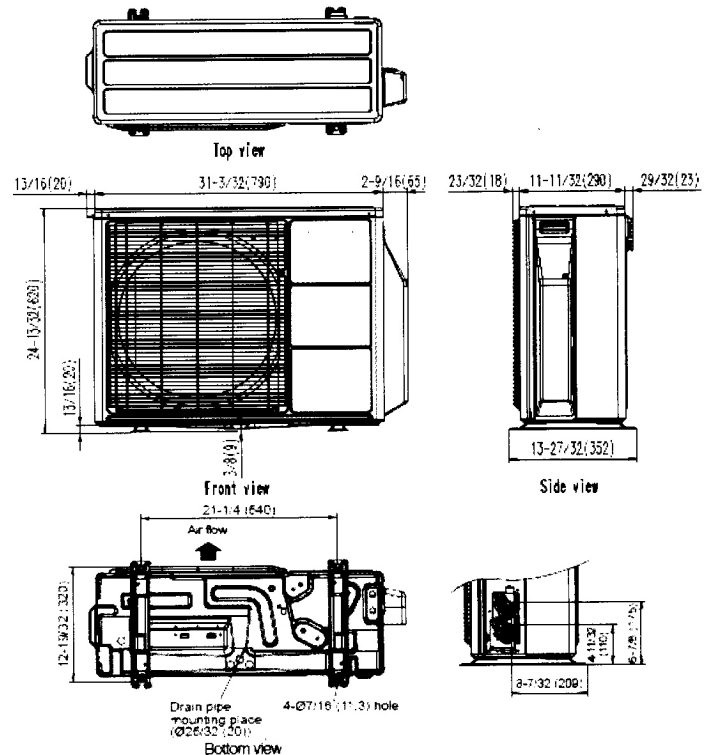

Fujitsu General America, Inc.
 Fairfield, NJ 07004
 Toll Free: 1-888-888-3424
 Fax: (973) 836-0447
 www.fujitsugeneral.com

Fujitsu products are subject to continuous improvements. Fujitsu reserves the right to modify product design, specifications and information in this data sheet without notice and without incurring any obligations.

Note: Specifications are based on the following conditions.

Power source of specifications : 230V

Cooling: Indoor temperature of 80°F(26.67°C)DB / 67°F(19.44°C)WB, and outdoor temperature of 95°F(35°C)DB/75°F(23.89°C)WB.

Heating: Indoor temperature of 70°F(21.11°C)DB / 60°F(15.56°C)WB, and outdoor temperature of 47°F(8.33°C)DB/43°F(6.11°C)WB.

Pipe length : 24ft. 7in.(7.5m),Height difference : 0 ft.(0m) [Outdoor unit - Indoor unit]



Inspections Division
Date: 10/23/14



Indoor Unit Power	208-230/VAC-1Ph-60Hz	
Available Voltage Range	187-253VAC	
Fan type	Cross flow	
Motor Output	29W	
MCA	0.4A	
Sound Pressure Level		
Cooling	Lo-Hi	25-45dB
Heating	Lo-Hi	25-45dB
Airflow rate		
Cooling	Lo-Hi	229-529dB
Heating	Lo-Hi	253-559dB
Dimensions	H x W x D	
Uncrated	(in)	11-3/32 x 34-1/4 x 7-9/32
	(mm)	(282 x 870 x 185)
Crated	(in)	9-23/32 x 36-7/32 x 14-11/16
	(mm)	(247 x 920 x 373)
Weight	Indoor	
Net	21lbs (9.5kg)	
Gross Shipping	27lbs (12kg)	

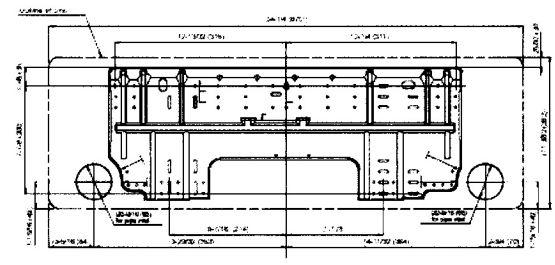
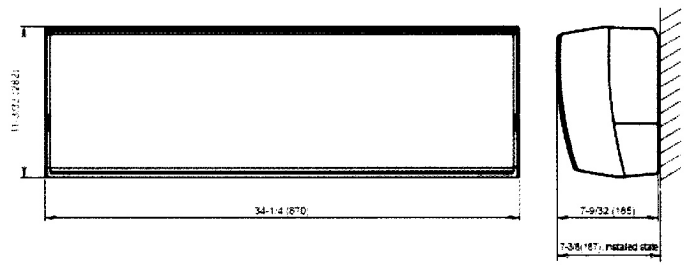

Fujitsu General America, Inc.
Fairfield, NJ 07004
Toll Free: 1-888-888-3424
Fax: (973) 836-0447
www.fujitsugeneral.com

Fujitsu products are subject to continuous improvements. Fujitsu reserves the right to modify product design, specifications and information in this data sheet without notice and without incurring any obligations.





Jeff Levine, AICP, Director
Planning & Urban Development Department

Tammy Munson, Director
Inspections Division

HVAC / Power Equipment Application & Checklist

All of the following information is required and must be submitted. Checking off each item as you prepare your application package will ensure your package is complete and will help to expedite the permitting process.

- 4 A floor plan that includes structural details, size and dimensions of the floor and location where the equipment is going to be installed.
- Information on how the unit is being vented & hanging details if appropriate.
- 4 Details of the specific equipment being installed; ie; specifications and any heating technical specifications. (Often this information can be obtained from the manufacturer's spec sheet or retail advertisements.)
- A plot plan showing the shape and dimension of the lot, with the distance from the actual property lines, and the principal structure may be required.
- Proof of ownership is required if it is inconsistent with the assessors records.
- 4 All documents as individual PDFs and named appropriately

All HVAC installations must be conducted in compliance with the IRC 2009 Building Code

Separate permits are required for plumbing and electrical installations, as required.

Separate permits are also required based on different properties
(different Chart, Block and Lot.)

Permit Fee: \$30.00 for the first \$1000.00 construction cost, \$10.00 per additional \$1000.00 cost

This is not a Permit; you may not commence any work until the Permit is issued.



FILL IN AND SIGN WITH INK



Inspections Division
Date: 10/23/14

Application for Heating, Ventilation, Air Condition (HVAC) Cooking or Power Equipment

To the Inspector of Buildings, Portland Maine:

The undersigned hereby applies for a permit to install the following HVAC, cooking or power equipment in accordance with the Laws of Maine, the Building Code of the City of Portland, and the following specifications:

Address/CBL: 18 Jackson Street Use of Building: Residential Date: 10/17/14

Name and Address of Owner: Andrew Roy, 18 Jackson Street, Portland, ME 04103

Installer's Name and Address: Goggin Energy, 22 Free Street, Suite 300, Portland, ME 04101

207-772-7557

E-Mail: pj@goggin.net

<p>Location of Appliance:</p> <p><input type="checkbox"/> Basement <input type="checkbox"/> Floor</p> <p><input type="checkbox"/> Attic <input type="checkbox"/> Roof</p> <p>Type of Fuel:</p> <p><input type="checkbox"/> Gas <input type="checkbox"/> Oil <input type="checkbox"/> Solid</p> <p>Appliance Name: <u>Fujitsu Heat Pump-Electric</u></p> <p>UL Approved: <input type="checkbox"/> Yes <input checked="" type="checkbox"/> No</p> <p>Will appliance be installed in accordance with the manufacturer's installation instructions? <input checked="" type="checkbox"/> Yes <input type="checkbox"/> No</p> <p>Type of License of Installer: Master Plumber #: _____</p> <p>Solid Fuel #: _____</p> <p>Oil #: _____</p> <p>Gas #: _____</p> <p>Other: <u>Universal Refrigeration, 101146545</u></p>	<p>Type of Venting: (<i>Plan required for submittal</i>)</p> <p><input type="checkbox"/> Masonry Lined Factory Built: _____</p> <p><input type="checkbox"/> Metal Factory Built UL Listing: _____</p> <p><input type="checkbox"/> Direct Vent Type: _____ UL #: _____</p> <p># of Tanks: _____</p> <p>Type of Fuel Tank:</p> <p><input type="checkbox"/> Gas <input type="checkbox"/> Oil</p> <p>Size of Tank: _____</p> <p>Distance from tank to center of flame: _____</p> <p>Cost of Work: \$ <u>4,505.00</u></p> <p>Permit Fee: \$ <u>69.00</u></p>
---	---

Approved

Approved with Conditions

Fire: _____

See attached letter or requirements

Electric: _____

Building: _____

Inspector's Signature

Date Approved

Signature of Installer: _____ **E-Mail:** pj@goggin.net