

**City of Portland, Maine – Building or Use Permit Application** 389 Congress Street, 04101, Tel: (207) 874-8703, FAX: 874-8716

Location of Construction: 111 Summit Avenue 04103 (Summit Park Ave)*Thomas F. Kane		Owner: *Thomas F. Kane		Phone: 797-8248		Permit No: <b>991365</b>	
Owner Address: *71 Chesley Ave. 04102		Lessee/Buyer's Name:		Phone:		BusinessName:	
Contractor Name: Thomas Kane Assoc.		Address: 71 Chesley Ave. 04102		Phone:		Permit Issued: DEC 13 1999	
Past Use: Single Family		Proposed Use: Same		COST OF WORK: \$900.00		PERMIT FEE: \$30.00	
				FIRE DEPT. <input type="checkbox"/> Approved <input type="checkbox"/> Denied		INSPECTION: Use Group: 43 Type: 5 BOCA 96 Signature: <i>Hoffman</i>	
Proposed Project Description: Addition Of Wheel Chair Ramp		Signature:		PEDESTRIAN ACTIVITIES DISTRICT (P.A.D.)		Zone: CBL: 380-A-B-006	
		Action: Approved <input type="checkbox"/> Approved with Conditions: <input type="checkbox"/> Denied: <input type="checkbox"/>		Signature:		Date:	
Permit Taken By: <i>GD</i>		Date Applied For: <i>GD</i> December 7, 1999				Zoning Approval: Special Zone or Reviews: <input type="checkbox"/> Shoreland <input type="checkbox"/> Wetland <input type="checkbox"/> Flood Zone <input type="checkbox"/> Subdivision <input type="checkbox"/> Site Plan maj <input type="checkbox"/> minor <input type="checkbox"/> mm <input type="checkbox"/>	

1. This permit application does not preclude the Applicant(s) from meeting applicable State and Federal rules.
2. Building permits do not include plumbing, septic or electrical work.
3. Building permits are void if work is not started within six (6) months of the date of issuance. False information may invalidate a building permit and stop all work..

**CERTIFICATION**

I hereby certify that I am the owner of record of the named property, or that the proposed work is authorized by the owner of record and that I have been authorized by the owner to make this application as his authorized agent and I agree to conform to all applicable laws of this jurisdiction. In addition, if a permit for work described in the application is issued, I certify that the code official's authorized representative shall have the authority to enter all areas covered by such permit at any reasonable hour to enforce the provisions of the code(s) applicable to such permit

December 7, 1999

SIGNATURE OF APPLICANT	ADDRESS:	DATE:	PHONE:
RESPONSIBLE PERSON IN CHARGE OF WORK, TITLE			PHONE:

White-Permit Desk Green-Assessor's Canary-D.P.W. Pink-Public File Ivory Card-Inspector

PERMIT ISSUED WITH REQUIREMENTS  
CEO DISTRICT

COMMENTS

1-27-00 went to site. checked measurements, setbacks, framing. All finished in accordance w/ attached plans OK to close permit for

Inspection Record

Type	Date
Foundation: _____	_____
Framing: _____	_____
Plumbing: _____	_____
Final: _____	_____
Other: _____	_____

**THIS IS NOT A PERMIT/CONSTRUCTION CANNOT COMMENCE UNTIL THE PERMIT IS ISSUED**

**Building or Use Permit Pre-Application  
Additions/Alterations/Accessory Structures  
To Detached Single Family Dwelling**

In the interest of processing your application in the quickest possible manner, please complete the Information below for a Building or Use Permit.

**NOTE\*\*If you or the property owner owes real estate or personal property taxes or user charges on any property within the City, payment arrangements must be made before permits of any kind are accepted.**

Location/Address of Construction:	111 Summit Ave. 04102	
-----------------------------------	-----------------------	--

Tax Assessor's Chart, Block & Lot Number Chart# 380 Block# A-B Lot# 004	Owner: Thomas F Kane III	Telephone#: 797 8248
Owner's Address: 71 Chesley Ave, Portland	Lessee/Buyer's Name (If Applicable)	Cost Of Work: \$900.00 Fee: \$30.00
Proposed Project Description:(Please be as specific as possible) Handicapped Wheel Chair Ramp		
Contractor's Name, Address & Telephone Thomas Kane Assoc 71 Chesley Ave Portland		Rec'd By: 

Separate permits are required for Internal & External Plumbing, HVAC and Electrical installation.

- All construction must be conducted in compliance with the 1996 B.O.C.A. Building Code as amended by Section 6-Art II.
- All plumbing must be conducted in compliance with the State of Maine Plumbing Code.
- All Electrical Installation must comply with the 1996 National Electrical Code as amended by Section 6-Art III.
- HVAC(Heating, Ventilation and Air Conditioning) installation must comply with the 1993 BOCA Mechanical Code.

You must Include the following with you application:

- 1) A Copy of Your Deed or Purchase and Sale Agreement
- 2) A Copy of your Construction Contract, if available
- 3) A Plot Plan (Sample Attached)

If there is expansion to the structure, a complete plot plan (Site Plan) must include:

- The shape and dimension of the lot, all existing buildings (if any), the proposed structure and the distance from the actual property lines. Structures include decks porches, a bow windows cantilever sections and roof overhangs, as well as, sheds, pools, garages and any other accessory structures.
- Scale and required zoning district setbacks

**4) Building Plans (Sample Attached)**

A complete set of construction drawings showing all of the following elements of construction:

- Cross Sections w/Framing details (including porches, decks w/ railings, and accessory structures)
- Floor Plans & Elevations
- Window and door schedules
- Foundation plans with required drainage and dampproofing
- Electrical and plumbing layout. Mechanical drawings for any specialized equipment such as furnaces, chimneys, gas equipment, HVAC equipment (air handling) or other types of work that may require special review must be included.

**Certification**

I hereby certify that I am the Owner of record of the named property, or that the proposed work is authorized by the owner of record and that I have been authorized by the owner to make this application as his/her authorized agent. I agree to conform to all applicable laws of this jurisdiction. In addition, if a permit for work described in this application is issued, I certify that the Code Official's authorized representative shall have the authority to enter all areas covered by this permit at any reasonable hour to enforce the provisions of the codes applicable to this permit.

Signature of applicant: 	Date: 12/6/99
--	---------------

Building Permit Fee: \$30.00 for the 1st \$1000.cost plus \$6.00 per \$1,000.00 construction cost thereafter.

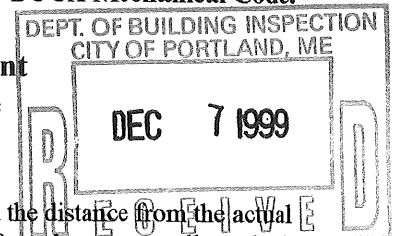

Inspection Services  
Michael J. Nugent  
Manager



Department of Urban Development  
Joseph E. Gray, Jr.  
Director

**CITY OF PORTLAND**

*congratulations !!!!!*

**Building or Use Permit Application  
Additions/Alterations/Accessory Structures  
To Detached Single Family Dwelling**

As an applicant for a building permit, you are about to enter into a relationship with our Office. We welcome any questions, comments or suggestions that will make the process more efficient. Attached you will find an application and some samples of the submissions you will provide at application time. Please read **ALL** of the information and if you need any further assistance please call 874-8703 or 874-8693.

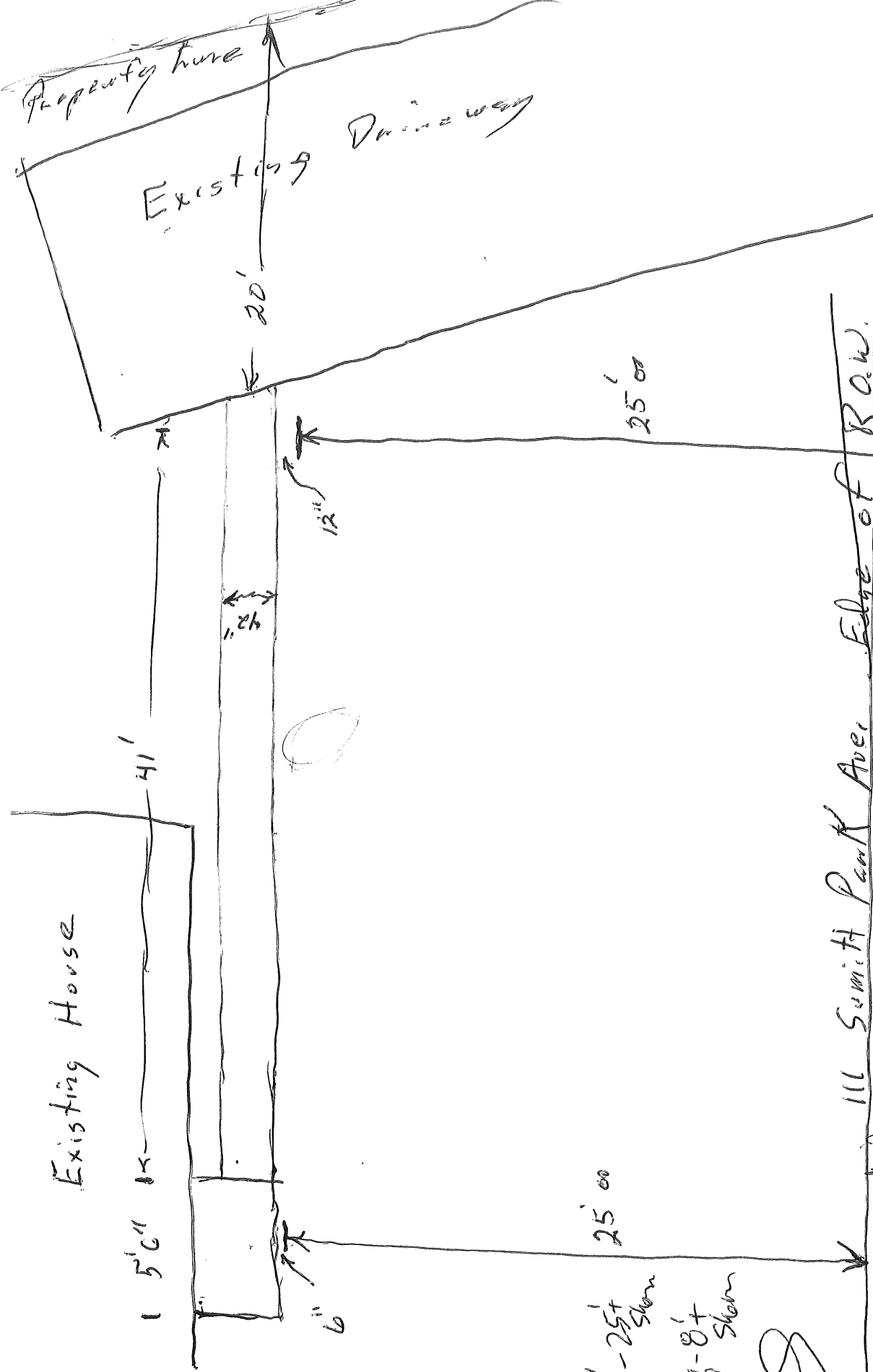

per Thomas Kane  
 This is their front line  
 and there is just over  
 25' to the new structure  
 12/13/99

111 Summit Park Ave. Edge of R.O.W.

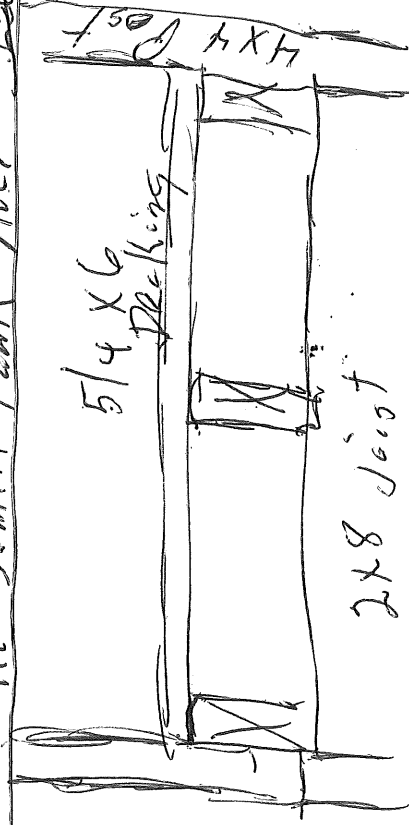

Front req: 25' - 25'±  
 Sides 0' req - 8'±

ok S

