

DISPLAY THIS CARD ON PRINCIPAL FRONTAGE OF WORK

# CITY OF PORTLAND

## BUILDING INSPECTION

### PERMIT

Please Read Application And Notes, If Any, Attached

PERMIT ISSUED  
Permit Number: 061091  
AUG 22 2006  
CITY OF PORTLAND

This is to certify that BASSO LOUIS A & LINDA TTTS / Tom Morissette

has permission to \_\_\_\_\_ new \_\_\_\_\_ k \_\_\_\_\_ staircas \_\_\_\_\_

AT 78 ALPINE RD \_\_\_\_\_ 380A A062001

provided that the person or persons who accept this permit shall comply with all of the provisions of the Statutes of the State and of the Ordinances of the City of Portland regulating the construction, maintenance and use of buildings and structures, and of the application on file in this department.

Apply to Public Works for street line and grade if nature of work requires such information.

Notification of inspection must be given and when permission procedure before this building or part thereof is started or service closed-in. 4 HOUR NOTICE REQUIRED.

A certificate of occupancy must be procured by owner before this building or part thereof is occupied.

#### OTHER REQUIRED APPROVALS

Fire Dept \_\_\_\_\_

Health Dept. \_\_\_\_\_

Appeal Board \_\_\_\_\_

Other \_\_\_\_\_

Department Name

*[Signature]*  
8/22/06  
Director - Building Inspection Services

**PENALTY FOR REMOVING THIS CARD**

# City of Portland, Maine - Building or Use Permit Application

389 Congress Street, 04101 Tel: (207) 874-8703, Fax: (207) 874-8716

Permit No: 06-091	Issue Date: <b>PERMIT ISSUED</b> AUG 22 2006	CBL: 380A A062001
Owner Name: BASSO LOUIS A & LINDA L JTS	Owner Address: 78 ALPINE RD	Phone:
Contractor Name: Tom Morissette	Contractor Address: 24 clearview dr Norway	Phone: 2076213910
Permit Type: Alterations - Dwellings	Zone: R-3	

Location of Construction: 78 ALPINE RD	Owner Name: BASSO LOUIS A & LINDA L JTS	Owner Address: 78 ALPINE RD
Business Name:	Contractor Name: Tom Morissette	Contractor Address: 24 clearview dr Norway
Lessee/Buyer's Name	Phone:	Permit Type: Alterations - Dwellings

Past Use: Single family	Proposed Use: Single Family new entry staircase and deck w/ staircase
----------------------------	--

Permit Fee: \$50.00	Cost of Work: \$2,400.00	CEO District: 5
------------------------	-----------------------------	--------------------

<b>FIRE DEPT:</b> <input type="checkbox"/> Approved <input type="checkbox"/> Denied Signature: <i>NA</i>	<b>INSPECTION:</b> Use Group <i>R-3</i> Type: <i>SB</i> <i>IRC 2003</i> Signature: <i>[Signature]</i>
<b>PEDESTRIAN ACTIVITIES DISTRICT (P.A.D.)</b> Action: <input type="checkbox"/> Approved <input type="checkbox"/> Approved w/Conditions <input type="checkbox"/> Denied Signature: _____ Date: _____	

**Proposed Project Description:**  
new entry staircase and deck w/ staircase

Permit Taken By: dmartin	Date Applied For: 07/20/2006	<b>Zoning Approval</b>
-----------------------------	---------------------------------	------------------------

1.  2. Building permits do not include plumbing, septic or electrical work.  3. Building permits are void if work is not started within six (6) months of the date of issuance. False information may invalidate a building permit and stop all work..	<b>Special Zone or Reviews</b> <input type="checkbox"/> Shoreland <input type="checkbox"/> Wetland <input type="checkbox"/> Flood Zone <input type="checkbox"/> Subdivision <input type="checkbox"/> Site Plan Maj <input type="checkbox"/> Minor <input type="checkbox"/> MM <input type="checkbox"/> <i>OK w/ conditions</i> Date: <i>8/1/06</i> <i>ABM</i>	<b>Zoning Appeal</b> <input type="checkbox"/> Variance <input type="checkbox"/> Miscellaneous <input type="checkbox"/> Conditional Use <input type="checkbox"/> Interpretation <input type="checkbox"/> Approved <input type="checkbox"/> Denied Date: _____	<b>Historic Preservation</b> <input checked="" type="checkbox"/> Not in District or Landmark <input type="checkbox"/> Does Not Require Review <input type="checkbox"/> Requires Review <input type="checkbox"/> Approved <input type="checkbox"/> Approved w/Conditions <input type="checkbox"/> Denied <i>ABM</i> Date: _____
--	---	---	--

## CERTIFICATION

I hereby certify that I am the owner of record of the named property, or that the proposed work is authorized by the owner of record and that I have been authorized by the owner to make this application as his authorized agent and I agree to conform to all applicable laws of this jurisdiction. In addition, if a permit for work described in the application is issued, I certify that the code official's authorized representative shall have the authority to enter all areas covered by such permit at any reasonable hour to enforce the provision of the code(s) applicable to such permit.

\_\_\_\_\_  
SIGNATURE OF APPLICANT ADDRESS DATE PHONE

\_\_\_\_\_  
RESPONSIBLE PERSON IN CHARGE OF WORK, TITLE DATE PHONE

**City of Portland, Maine - Building or Use Permit**

389 Congress Street, 04101 Tel: (207) 874-8703, Fax: (207) 874-8716

<b>Permit No:</b> 06-1091	<b>Date Applied For:</b> 07/20/2006	<b>CBL:</b> 380A A062001
------------------------------	--	-----------------------------

<b>Location of Construction:</b> 78 ALPINE RD	<b>Owner Name:</b> BASSO LOUIS A & LINDA L JTS	<b>Owner Address:</b> 78 ALPINE RD	<b>Phone:</b>
<b>Business Name:</b>	<b>Contractor Name:</b> Tom Morissette	<b>Contractor Address:</b> 24 clearview dr Norway	<b>Phone</b> (207) 621-3910
<b>Lessee/Buyer's Name</b>	<b>Phone:</b>	<b>Permit Type:</b> Alterations - Dwellings	

<b>Proposed Use:</b> Single Family new entry staircase and deck w/ staircase	<b>Proposed Project Description:</b> new entry staircase and deck w/ staircase
---	---

**Dept:** Zoning      **Status:** Approved with Conditions      **Reviewer:** Ann Machado      **Approval Date:** 08/01/2006

**Note:** Front of house is only 23.5' from the front property line. Using section 14-425 the front entry is now a total of 39.17 s.f. & and it extends out from the house 5'9.5".      **Ok to Issue:**

- 1) This property shall remain a single family dwelling. Any change of use shall require a separate permit application for review and approval.
- 2) This permit is being approved on the basis of plans submitted. Any deviations shall require a separate approval before starting that work.

**Dept:** Building      **Status:** Approved with Conditions      **Reviewer:** Tammy Munson      **Approval Date:** 08/22/2006

**Note:**      **Ok to Issue:**

- 1) Permit approved based on the plans submitted and reviewed w/owner/contractor, with additional information as agreed on and as noted on plans.

**Comments:**

7/26/06-amachado: Spoke to contractor, Tom Morissette. He will check all the setbacks to the new structures and get back to me.

7/31/06-amachado: Tom gave me the setbacks & the front setback is only 23.5'. The front entry way as proposed does not meet section 14-425. I left him a message.

8/1/06-amachado: Tom told me the setbacks over the phone. The house did not meet the front setback so he had to revise the front entry way.



# General Building Permit Application

If you ~~are~~ the property owner **owes** real estate or personal property taxes or user charges on any property within the City, payment arrangements must be made before permits of any kind are accepted.

Total Square Footage of Proposed Structure <i>48 Sq. Feet</i>		Square Footage of Lot <i>10,540</i>	
Tax Assessor's Chart, Block & Lot Chart# <i>380A</i> Block# <i>A</i> Lot# <i>62</i>		Owner: <i>Louise &amp; Linda Basso</i>	Telephone: <i>207 878 0337</i>
Lessee/Buyer's Name (If Applicable)	Applicant name, address & telephone: <i>Linda L. Basso 28 Alpine Rd Portland, ME 04107</i>		cost Of Work: <i>2400.00</i> <del>\$</del> Fee: \$ <i>50</i> C of O Fee: \$
<i>Entry staircase &amp; Deck w/ Staircase</i>			
Contractor's name, address & telephone:			
Who should we contact when the permit is ready: Mailing address: <i>24 Clearview Drive Norway, ME 04268</i>		Tom Morissette Phone: <i>(207) 621 3910</i> <i>Call Linda 774 5939 Ext 2107</i>	

**Please submit all of the information outlined in the Commercial Application Checklist. Failure to do so will result in the automatic denial of your permit,**

In order to be sure the City fully understands the full scope of the project, the Planning and Development Department may request additional information prior to the issuance of a permit. For further information visit us on-line at [www.portlandmaine.gov](http://www.portlandmaine.gov), stop by the Building Inspections office, room 315 City Hall or call 874-8703.

I hereby certify that I am the Owner of record of the named property, or that the owner of record authorizes the proposed work and that I have been authorized by the owner to make this application as his/her authorized agent. I agree to conform to all applicable laws of this jurisdiction. In addition, if a permit for work described in this application is issued, I certify that the Code Official's authorized representative shall have the authority to enter all areas covered by this permit at any reasonable hour to enforce the provisions of the codes applicable to this permit

Signature of applicant: *Linda L. Basso*  
*Louise A. Basso*

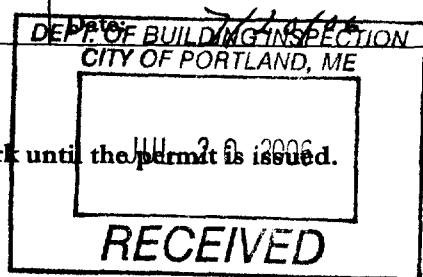

This is not a permit; you may not commence ANY work until the permit is issued.



L. BASSO  
 78 Alpine Rd  
 Portland Me.

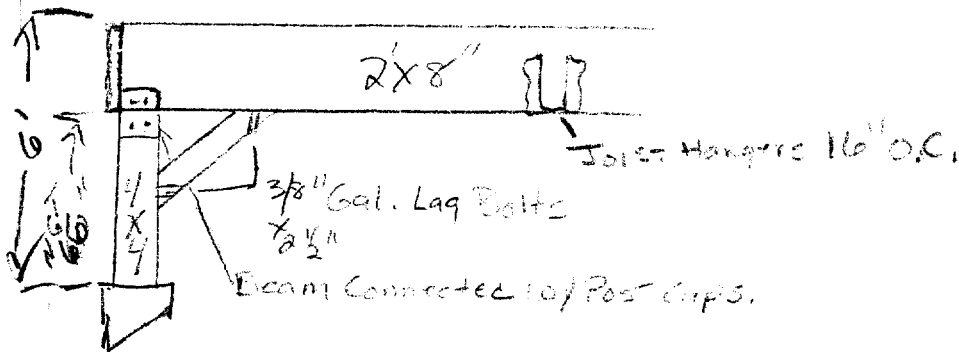
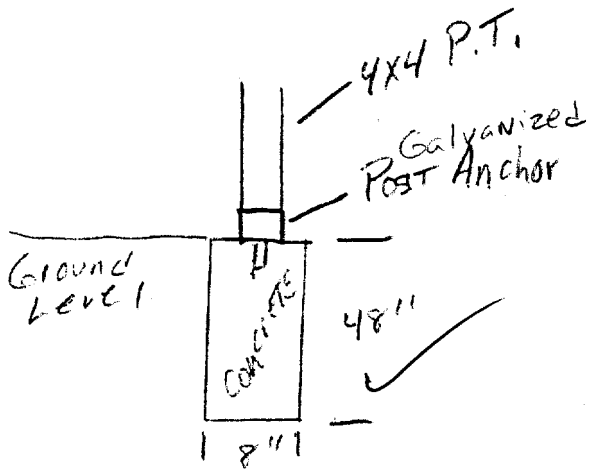

3/8" Galvanized Lag Bolts For All Post to Beam Connections For Hand rails

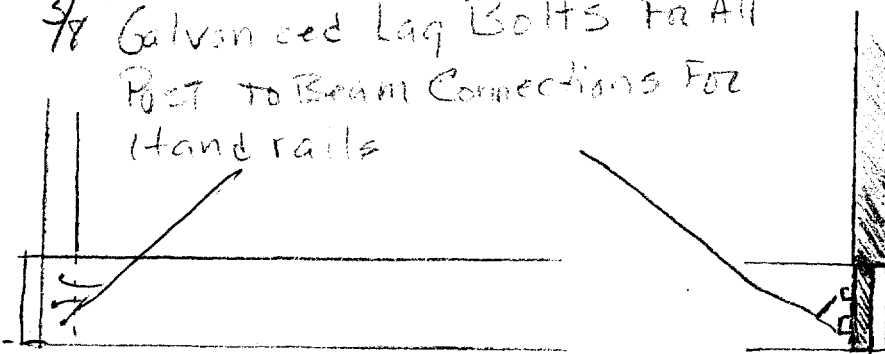

✓ Post Span  
 1 NGT 8' in Length

HAND RAIL LAYOUT

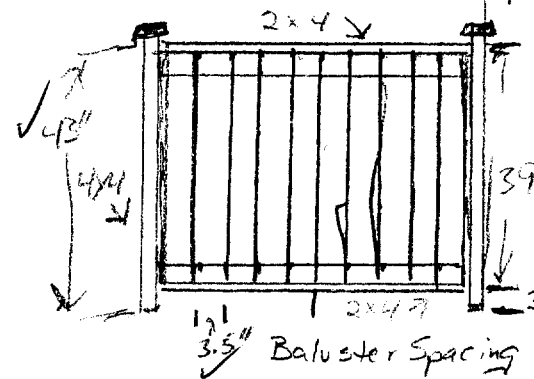

FROST POST/BEAM LAYOUT

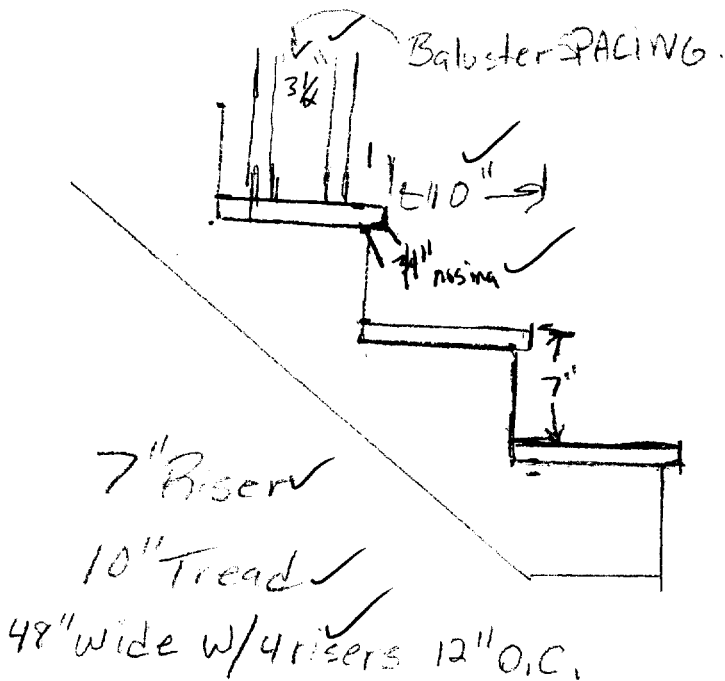
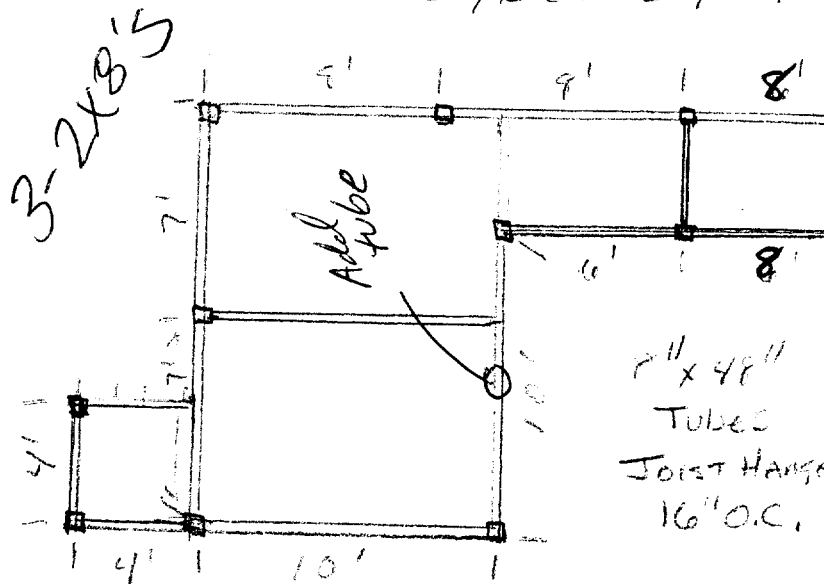

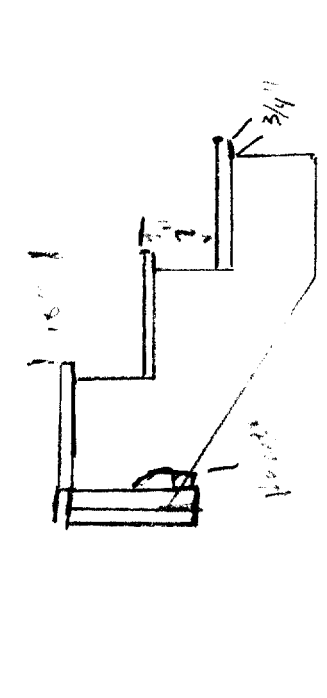
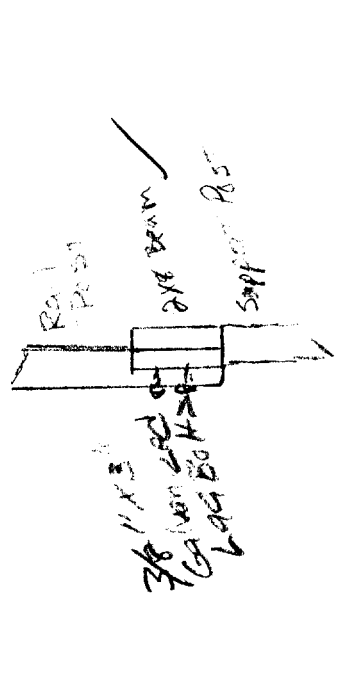
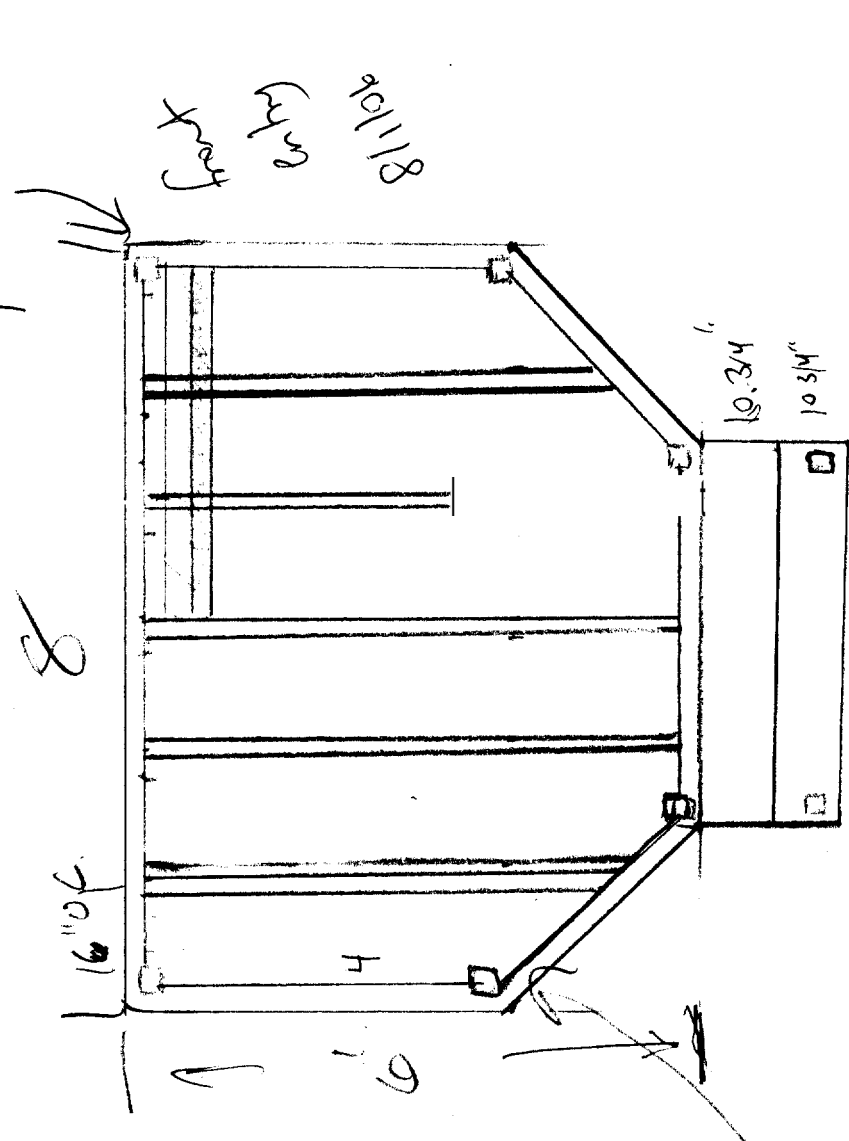
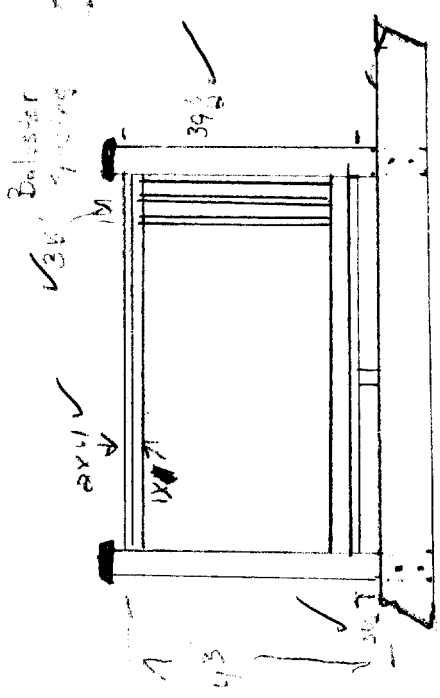
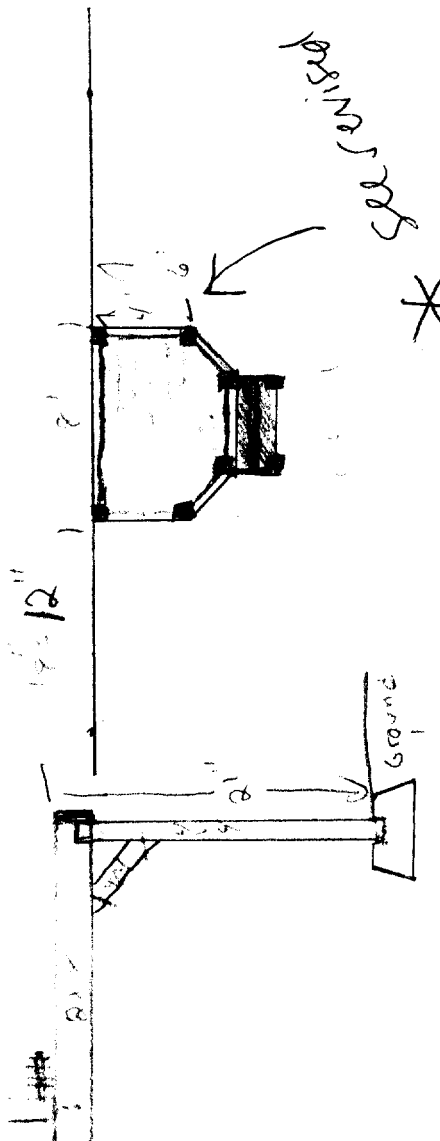

6 support Post

8/11/18  
 8/11/18  
 8/11/18

8/11/18  
 8/11/18  
 8/11/18

10 3/4  
 10 3/4

16 1/2

4

6

16 1/2

3 1/2  
 3 1/2  
 3 1/2

1 1/2

1 1/2

Ground

6 support Post

Tom Morissette  
671-3910

78 Alpine  
Portland Me.  
House

DEPT. OF BUILDING INSPECTION  
CITY OF PORTLAND, ME  
AUG - 1 2006  
RECEIVED

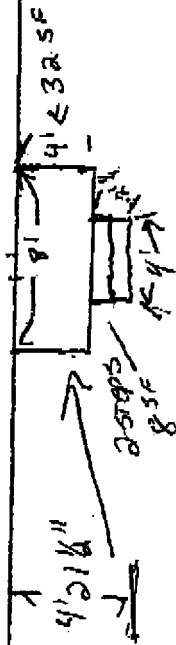

32
7.17 steps
39.17 total

23'6"

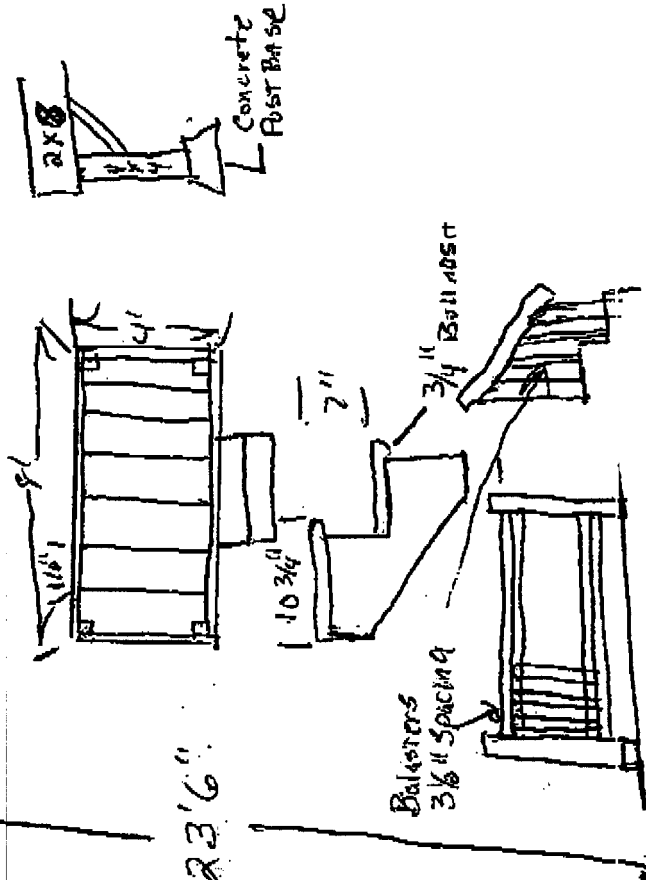

874 876

ALPINE  
ALPINE  
ALPINE





built 1967

Descriptor/Area

A: 1Fr/B  
1094 sqft

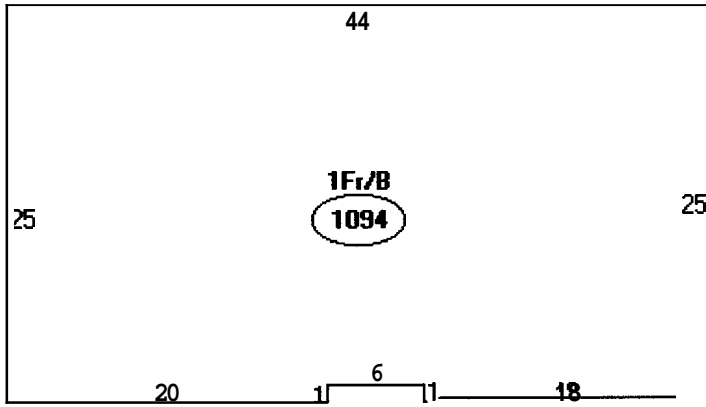

# BUILDING PERMIT INSPECTION PROCEDURES

**Please call 874-8703 or 874-8693 to schedule your inspections as agreed upon**

Permits expire in 6 months, if the project is not started or ceases for 6 months.

The Owner or their designee is required to notify the inspections office for the following inspections and provide adequate notice. Notice must be called in **48-72** hours in advance in order to schedule an inspection:

By initializing at each inspection time, you are agreeing that you understand the inspection procedure and additional fees from a "Stop Work Order" and "Stop Work Order Release" will be incurred if the procedure is not followed as stated below.

A Pre-construction Meeting will take place upon receipt of your building permit.

- Call **Footing/Building** Location Inspection: Prior to pouring concrete
- N/A Re-Bar Schedule Inspection: Prior to pouring concrete
- N/A **Foundation** Inspection: Prior to placing **ANY** backfill
- Call **Framing/Rough Plumbing/Electrical**: Prior to any insulating or drywalling
- Call **Final/Certificate of Occupancy**: Prior to any occupancy of the structure or use. NOTE: There is a \$75.00 fee per inspection at this point.

Certificate of Occupancy is not required for certain projects. Your inspector can advise you if your project requires a Certificate of Occupancy. **All** projects DO require a final inspection

\_\_\_\_\_ If any of the inspections do not occur, the project cannot go on to the next phase, **REGARDLESS OF THE NOTICE OR CIRCUMSTANCES.**

\_\_\_\_\_ **CERIFICATE OF OCCUPANICES MUST BE ISSUED AND PAID FOR, BEFORE THE SPACE MAY BE OCCUPIED**

\_\_\_\_\_  
Signature of Applicant/Designee  
[Signature]  
Signature of Inspections Official

\_\_\_\_\_  
Date 8/22/00  
Date

CBL: 310A062 Building Permit #: 081091