

DISPLAY THIS CARD ON PRINCIPAL FRONTAGE OF WORK



CITY OF PORTLAND

BUILDING PERMIT

This is to certify that LINDA M» PRIDE

Located At 291 AUBURN

Job ID: 2011-08-2004-ALTR

CBL: 379 - - F - 010 - 001 - - - -

has permission to after the fact permit add 6' x 8' porch

provided that the person or persons, firm or corporation accepting this permit shall comply with all of the provisions of the Statues of Maine and of the Ordinances of the City of Portland regulating the construction, maintenance and use of the buildings and structures, and of the application on file in the department.

Notification of inspection and written permission procured before this building or part thereof is lathed or otherwise closed-in. 48 HOUR NOTICE IS REQUIRED.

A final inspection must be completed by owner before this building or part thereof is occupied. If a certificate of occupancy is required, it must be

Fire Prevention Officer

[Signature]
8/24/11
Code Enforcement Officer / Plan Reviewer

**THIS CARD MUST BE POSTED ON THE STREET SIDE OF THE PROPERTY
PENALTY FOR REMOVING THIS CARD**

BUILDING PERMIT INSPECTION PROCEDURES

Please call 874-8703 or 874-8693 (ONLY)

or email: buildinginspections@portlandmaine.gov

With the issuance of this permit, the owner, builder or their designee is required to provide adequate notice to the city of Portland Inspections Services for the following inspections. Appointments must be requested 48 to 72 hours in advance of the required inspection. The inspection date will need to be confirmed by this office.

- **Please read the conditions of approval that is attached to this permit!! Contact this office if you have any questions.**
- **Permits expire in 6 months. If the project is not started or ceases for 6 months.**
- **If the inspection requirements are not followed as stated below additional fees may be incurred due to the issuance of a "Stop Work Order" and subsequent release to continue.**

1. Final inspection required.

The project cannot move to the next phase prior to the required inspection and approval to continue, REGARDLESS OF THE NOTICE OF CIRCUMSTANCES.

IF THE PERMIT REQUIRES A CERTIFICATE OF OCCUPANCY, IT MUST BE PAID FOR AND ISSUED TO THE OWNER OR DESIGNEE BEFORE THE SPACE MAY BE OCCUPIED.

City of Portland, Maine - Building or Use Permit Application

389 Congress Street, 04101 Tel: (207) 874-8703, FAX: (207) 8716

Job No: 2011-08-2004-ALTR	Date Applied: 8/17/2011	CBL: 379 - - F - 010 - 001 - - - - -	
Location of Construction: 291 AUBURN ST	Owner Name: LINDA M PRIDE	Owner Address: 291 AUBURN ST PORTLAND, ME - MAINE 04103	Phone: 797-5516
Business Name:	Contractor Name: Kevin Chase @ Above and Beyond LLC	Contractor Address: 55 Hollard St., Lewiston, ME 04240	Phone: 754-7782
Lessee/Buyer's Name:	Phone:	Permit Type: SF Alterations	Zone: R-2 Prime & R-3 sub
Past Use: Single family	Proposed Use: Same: Single Family - to add 6' x 8' porch with stairs on rear	Cost of Work: \$1000.00	CEO District:
		Fire Dept: <i>NA</i>	Inspection: <i>R-3</i> Use Group: Type: <i>5B</i>
		Signature: <i>[Signature]</i>	Signature: <i>[Signature]</i>
Proposed Project Description: 6' x 8' porch (after the fact)		Pedestrian Activities District (P.A.D.)	

Permit Taken By: Gayle	Zoning Approval		
<p>1. This permit application does not preclude the Applicant(s) from meeting applicable State and Federal Rules.</p> <p>2. Building Permits do not include plumbing, septic or electrical work.</p> <p>3. Building permits are void if work is not started within six (6) months of the date of issuance. False informatin may invalidate a building permit and stop all work.</p>	Special Zone or Reviews <input type="checkbox"/> Shoreland <input type="checkbox"/> Wetlands <input type="checkbox"/> Flood Zone <input type="checkbox"/> Subdivision <input type="checkbox"/> Site Plan <input type="checkbox"/> Maj <input type="checkbox"/> Min <input type="checkbox"/> MM Date: <i>8/23/11</i>	Zoning Appeal <input type="checkbox"/> Variance <input type="checkbox"/> Miscellaneous <input type="checkbox"/> Conditional Use <input type="checkbox"/> Interpretation <input type="checkbox"/> Approved <input type="checkbox"/> Denied Date:	Historic Preservation <input checked="" type="checkbox"/> Not in Dist or Landmark <input type="checkbox"/> Does not Require Review <input type="checkbox"/> Requires Review <input type="checkbox"/> Approved <input type="checkbox"/> Approved w/Conditions <input type="checkbox"/> Denied Date: <i>[Signature]</i>
	CERTIFICATION		

I hereby certify that I am the owner of record of the named property, or that the proposed work is authorized by the owner of record and that I have been authorized by the owner to make this application as his authorized agent and I agree to conform to all applicable laws of this jurisdiction. In addition, if a permit for work described in the application is issued, I certify that the code official's authorized representative shall have the authority to enter all areas covered by such permit at any reasonable hour to enforce the provision of the code(s) applicable to such permit

SIGNATURE OF APPLICANT	ADDRESS	DATE	PHONE
RESPONSIBLE PERSON IN CHARGE OF WORK, TITLE		DATE	PHON

2011 08 2004



General Building Permit Application

If you or the property owner owes real estate or personal property taxes or user charges on any property within the City, payment arrangements must be made before permits of any kind are accepted.

R-2 Prime
R-3 Sub

Location/Address of Construction: <u>291 Auburn Rd Portland</u>		
Total Square Footage of Proposed Structure/Area <u>48 sq ft.</u>		Square Footage of Lot <u>m Q</u>
Tax Assessor's Chart, Block & Lot Chart# Block# Lot# <u>379 F010</u>	Applicant * must be owner, Lessee or Buyer * Name <u>Linda Priole</u> Address <u>291 Auburn Rd</u> City, State & Zip <u>Portland, Me</u>	Telephone: <u>797-5516</u>
Lessee/DBA (If Applicable) RECEIVED AUG 17 2011 Dept. of Building Inspections	Owner (if different from Applicant) Name Address City, State & Zip	Cost Of Work: \$ <u>825.00</u> C of O Fee: \$ _____ Total Fee: \$ <u>30.00</u>
Current legal use (ie, single family) <input checked="" type="radio"/> <u>Single family</u> If vacant, what was the previous use? Proposed Specific use: <u>1 Chair sitting with stairs (Porch) 6x8 Porch</u> Is property part of a subdivision? _____ If yes, please name _____ Project description: <u>after the fact 6' x 8' Porch w/ 3 steps</u> <u>Per Nick</u>		
Contractor's name: <u>Above and Beyond LLC</u> Address: <u>55 Hillard St Lewiston Me 04240</u> City, State & Zip <u>Lewiston Me 04240</u> Telephone: <u>207 786-9966</u> Who should we contact when the permit is ready: <u>Kevin Chase</u> Telephone: <u>207 754 7782</u> Mailing address: <u>55 Hillard St. Lewiston Me 04240</u>		

Please submit all of the information outlined on the applicable Checklist. Failure to do so will result in the automatic denial of your permit.

In order to be sure the City fully understands the full scope of the project, the Planning and Development Department may request additional information prior to the issuance of a permit. For further information or to download copies of this form and other applications visit the Inspections Division on-line at www.portlandmaine.gov, or stop by the Inspections Division office, room 315 City Hall or call 874-8703.

I hereby certify that I am the Owner of record of the named property, or that the owner of record authorizes the proposed work and that I have been authorized by the owner to make this application as his/her authorized agent. I agree to conform to all applicable laws of this jurisdiction. In addition, if a permit for work described in this application is issued, I certify that the Code Official's authorized representative shall have the authority to enter all areas covered by this permit at any reasonable hour to enforce the provisions of the codes applicable to this permit.

Signature: Linda Priole Date: _____

This is not a permit; you may not commence ANY work until the permit is issued

Linda Pride

291 Auburn Rd,

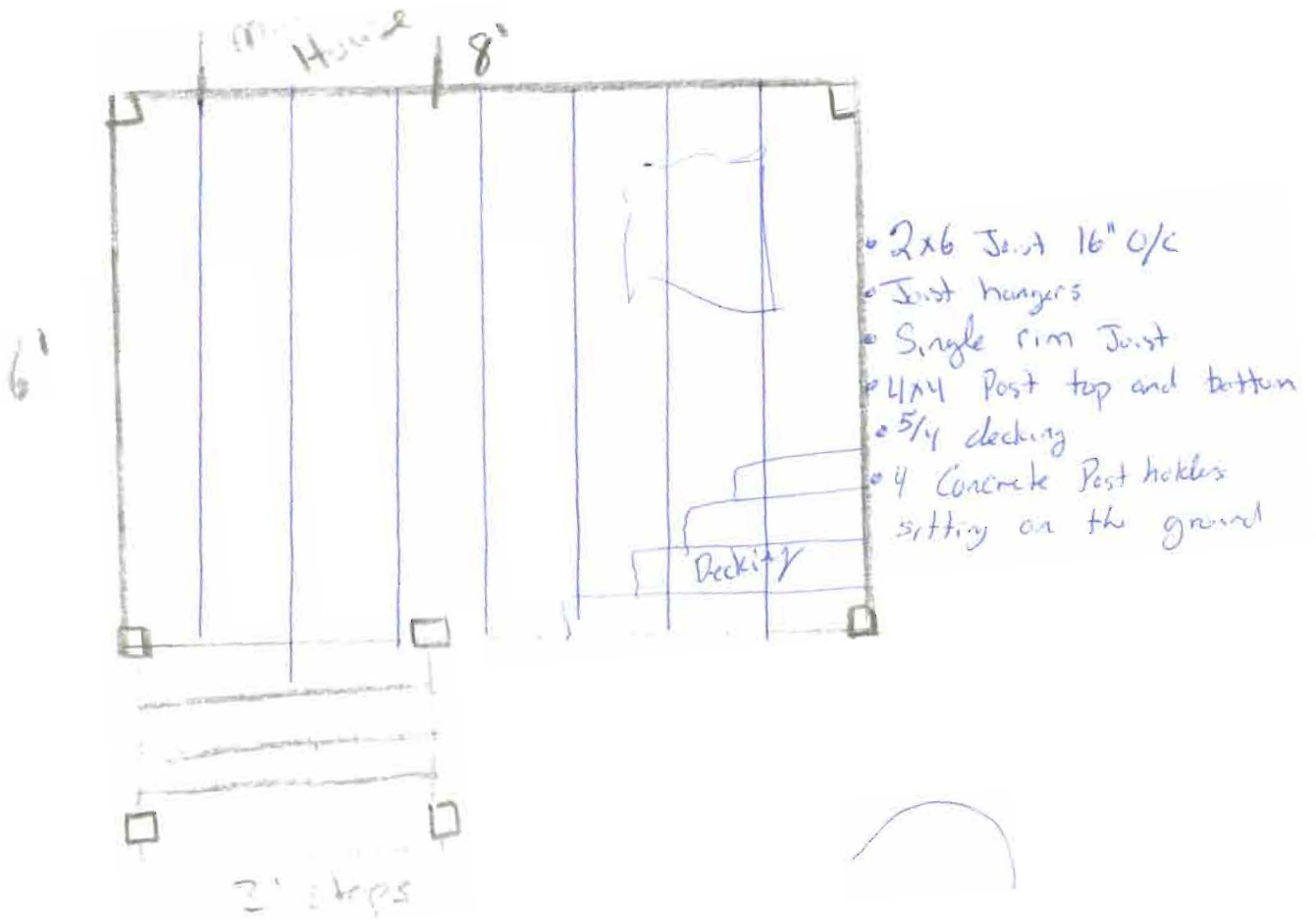

- 2x6 Joist 16" o/c
- Joist hangers
- Single rim Joist
- 4x4 Post top and bottom
- 5/4 decking
- 4 Concrete Post holders sitting on the ground

2	2x6x8	PT	(Joist Rim)
4	2x6x12	PT	(Joist)
1	2x12x16	Stranger	PT
12	2x6	Joist Hangers	
6	4x4x8	PT	(Post)
20	5/4 x 8	PT	(Decking)
8	2x4x8	PT	(Hand rails)
55	Balusters	2x2x36"	(Balusters)
4	Post holders		

~~\$491.80~~

Scott Richards

Linda Pride 291 Auburn Rd.

cannot be less than 25'

R-2

condition
to not
less than

- rear - 25' min - 25'
- front - 25' min - ok
- side - 12' min - 15' given

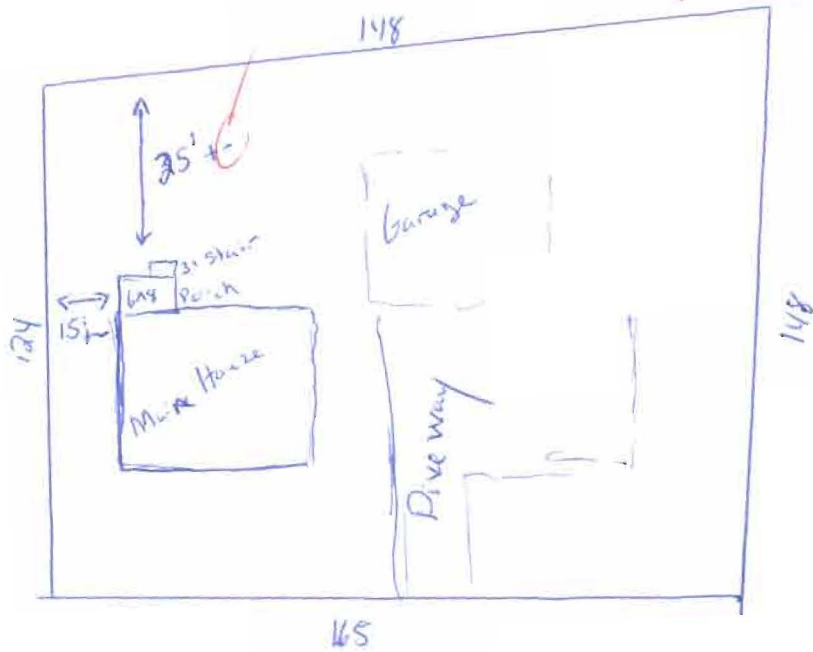

Map

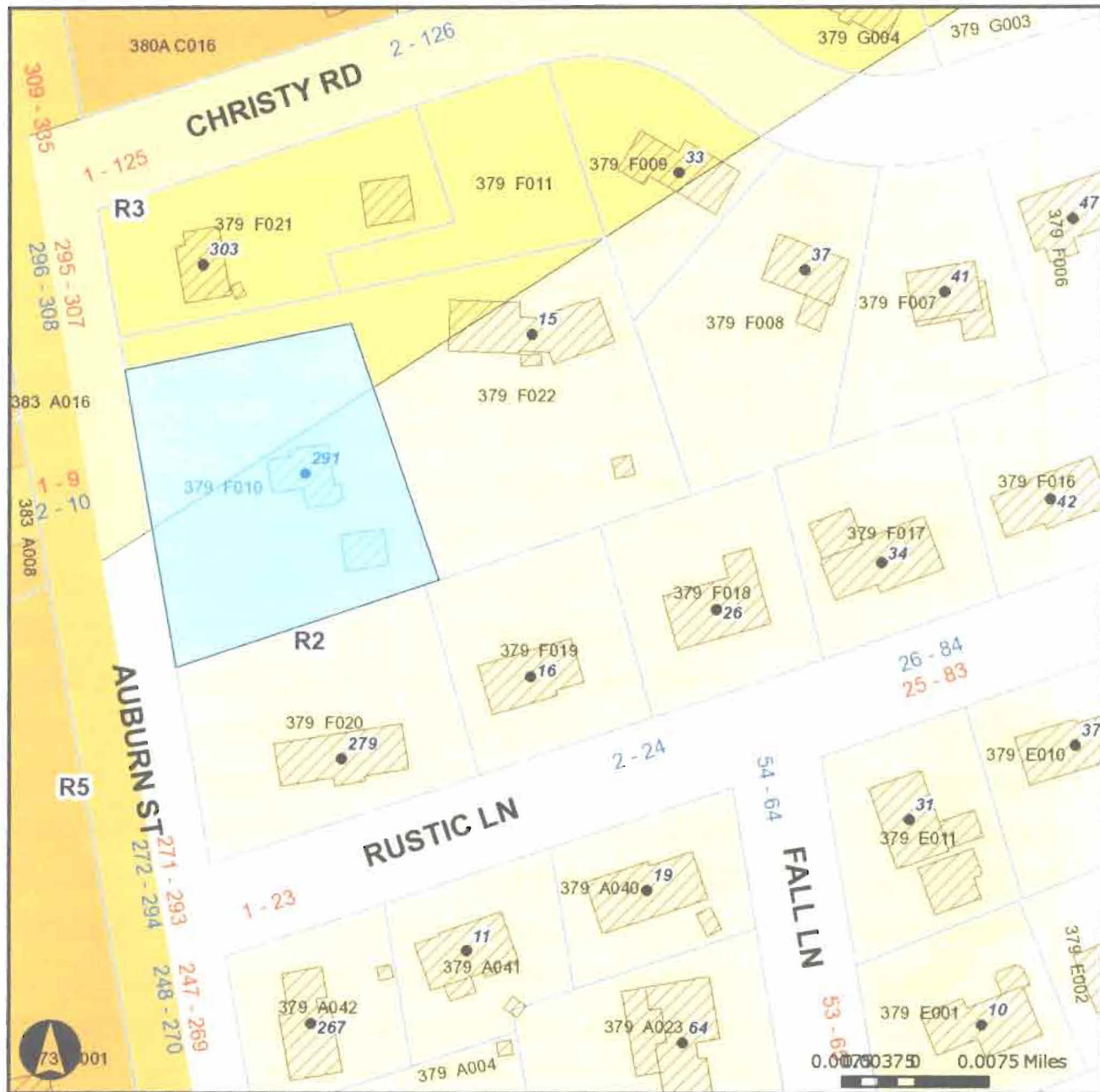

Parcels	Shoreland Overlay Zone	Zoning (continued)	Zoning (continued)
Parcels	Stream Overlay Zone	<input type="checkbox"/> R1 Residential	<input type="checkbox"/> C25
Parcels	<input type="checkbox"/> Stream_protection	<input type="checkbox"/> R2 Residential	<input type="checkbox"/> C26
Interstate	Island Zoning	<input type="checkbox"/> R3 Residential	<input type="checkbox"/> C27
Streets	<input type="checkbox"/> C43	<input type="checkbox"/> R4 Residential	<input type="checkbox"/> C28
	<input type="checkbox"/> I-B	<input type="checkbox"/> R5 Residential	<input type="checkbox"/> C29
	<input type="checkbox"/> I-TS	<input type="checkbox"/> R6 Residential	<input type="checkbox"/> C30
		<input type="checkbox"/> ROS Recreation Open	<input type="checkbox"/> C31



CITY OF PORTLAND, MAINE

Department of Building Inspections

Original Receipt

July 17 2011

Received from James + Edward LLC

Location of Work 91 Jones Rd

Cost of Construction \$ _____ Building Fee: _____

Permit Fee \$ _____ Site Fee: _____

Certificate of Occupancy Fee: _____

Total: _____

Building (IL) ____ Plumbing (I5) ____ Electrical (I2) ____ Site Plan (U2) ____

Other _____

CBL: 3100 F010

Check #: 3297 Total Collected \$ 30.00

**No work is to be started until permit issued.
Please keep original receipt for your records.**

Taken by: [Signature]

WHITE - Applicant's Copy
YELLOW - Office Copy
PINK - Permit Copy