

DISPLAY THIS CARD ON PRINCIPAL FRONTAGE OF WORK CITY OF PORTLAND

BUILDING INSPECTION

PERMIT

Permit Number: 090356

Please Read Application And Notes, If Any, Attached

This is to certify that BAY MARK J & SARAH E KOSIK ITS Electric

has permission to install an emergency generator

AT 74 RUSTIC LN

CE 379 F012001

provided that the person or persons, firm or corporation accepting this permit shall comply with all of the provisions of the Statutes of Maine and of the Ordinances of the City of Portland regulating the construction, maintenance and use of buildings and structures, and of the application on file in this department.

Apply to Public Works for street line and grade if nature of work requires such information.

Notification of inspection must be given and written permission procured before this building or part thereof is lathed or otherwise red-in. 24 HOUR NOTICE IS REQUIRED.

A certificate of occupancy must be procured by owner before this building or part thereof is occupied.

OTHER REQUIRED APPROVALS

Fire Dept. _____

Health Dept. _____

Appeal Board _____

Other _____

Department Name

[Signature] 4/27/09
Director - Building & Inspection Services

PENALTY FOR REMOVING THIS CARD

City of Portland, Maine - Building or Use Permit Application

389 Congress Street, 04101 Tel: (207) 874-8703, Fax: (207) 874-8716

Permit No: 09-0356	Issue Date: <i>4/27/09</i>	CBL: 379 F012001
-----------------------	-------------------------------	---------------------

Location of Construction: 74 RUSTIC LN	Owner Name: BAY MARK J & SARAH E KELSI	Owner Address: 74 RUSTIC LN	Phone:
Business Name:	Contractor Name: Rods Electric	Contractor Address: 366 Main Street Biddeford	Phone 2072825398
Lessee/Buyer's Name	Phone:	Permit Type: Generator	Zone:

Past Use: Single Family Home	Proposed Use: Single Family Home - install an emergency generator	Permit Fee: \$60.00	Cost of Work: \$3,206.00	CEO District: 5
		FIRE DEPT: <input type="checkbox"/> Approved <input type="checkbox"/> Denied	INSPECTION: Use Group: <i>R-3</i> Type: <i>Generator only</i> <i>IMC-2003</i> <i>IRC-2003</i>	

Proposed Project Description:
install an emergency generator

Signature: _____ Date: *4/27/09*

Signature: *CL* Date: *4/27/09*

PEDESTRIAN ACTIVITIES DISTRICT (P.A.D.)

Action: Approved Approved w/Conditions Denied

Signature: _____ Date: _____

Permit Taken By: Ldobson	Date Applied For: 04/24/2009	Zoning Approval
-----------------------------	---------------------------------	------------------------

<p>1. This permit application does not preclude the Applicant(s) from meeting applicable State and Federal Rules.</p> <p>2. Building permits do not include plumbing, septic or electrical work.</p> <p>3. Building permits are void if work is not started within six (6) months of the date of issuance. False information may invalidate a building permit and stop all work..</p>	<p>Special Zone or Reviews</p> <p><input type="checkbox"/> Shoreland</p> <p><input type="checkbox"/> Wetland</p> <p><input type="checkbox"/> Flood Zone</p> <p><input type="checkbox"/> Subdivision</p> <p><input type="checkbox"/> Site Plan</p> <p>Maj <input type="checkbox"/> Minor <input type="checkbox"/> MM <input type="checkbox"/></p> <p>Date: <i>4/27/09</i> <i>CL</i></p>	<p>Zoning Appeal</p> <p><input type="checkbox"/> Variance</p> <p><input type="checkbox"/> Miscellaneous</p> <p><input type="checkbox"/> Conditional Use</p> <p><input type="checkbox"/> Interpretation</p> <p><input type="checkbox"/> Approved</p> <p><input type="checkbox"/> Denied</p> <p>Date: _____</p>	<p>Historic Preservation</p> <p><input type="checkbox"/> Not in District or Landmark</p> <p><input checked="" type="checkbox"/> Does Not Require Review</p> <p><input type="checkbox"/> Requires Review</p> <p><input type="checkbox"/> Approved</p> <p><input type="checkbox"/> Approved w/Conditions</p> <p><input type="checkbox"/> Denied</p> <p>Date: _____</p>
	<p><i>5 min Permit OK - 3/24/09</i></p>		

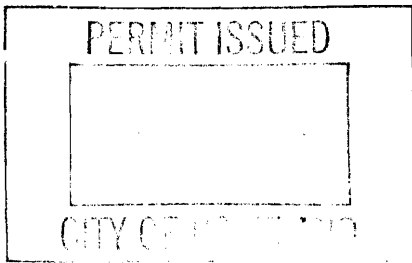

CERTIFICATION

I hereby certify that I am the owner of record of the named property, or that the proposed work is authorized by the owner of record and that I have been authorized by the owner to make this application as his authorized agent and I agree to conform to all applicable laws of this jurisdiction. In addition, if a permit for work described in the application is issued, I certify that the code official's authorized representative shall have the authority to enter all areas covered by such permit at any reasonable hour to enforce the provision of the code(s) applicable to such permit.

SIGNATURE OF APPLICANT	ADDRESS	DATE	PHONE
RESPONSIBLE PERSON IN CHARGE OF WORK, TITLE		DATE	PHONE

City of Portland, Maine - Building or Use Permit

389 Congress Street, 04101 Tel: (207) 874-8703, Fax: (207) 874-8716

Permit No: 09-0356	Date Applied For: 04/24/2009	CBL: 379 F012001
------------------------------	--	----------------------------

Location of Construction: 74 RUSTIC LN	Owner Name: BAY MARK J & SARAH E KELSI	Owner Address: 74 RUSTIC LN	Phone:
Business Name:	Contractor Name: Rods Electric	Contractor Address: 366 Main Street Biddeford	Phone (207) 282-5398
Lessee/Buyer's Name	Phone:	Permit Type: Generator	

Proposed Use: Single Family Home - install an emergency generator	Proposed Project Description: install an emergency generator
---	--

Dept: Zoning **Status:** Approved **Reviewer:** Chris Hanson **Approval Date:** 04/27/2009
Note: **Ok to Issue:**

Dept: Building **Status:** Approved with Conditions **Reviewer:** Chris Hanson **Approval Date:** 04/27/2009
Note: **Ok to Issue:**

- 1) Seperate permit required for propane tank location.
- 2) Equipment must be installed in compliance with the manufacturer's specifications
- 3) Separate permits are required for any electrical, plumbing, sprinkler, fire alarm or HVAC or exhaust systems. Separate plans may need to be submitted for approval as a part of this process.

City of Portland, Maine - Building or Use Permit

389 Congress Street, 04101 Tel: (207) 874-8703, Fax: (207) 874-8716

Permit No: 09-0356	Date Applied For: 04/24/2009	CBL: 379 F012001
------------------------------	--	----------------------------

Location of Construction: 74 RUSTIC LN	Owner Name: BAY MARK J & SARAH E KELSI	Owner Address: 74 RUSTIC LN	Phone:
Business Name:	Contractor Name: Rods Electric	Contractor Address: 366 Main Street Biddeford	Phone (207) 282-5398
Lessee/Buyer's Name	Phone:	Permit Type: Generator	

Proposed Use: Single Family Home - install an emergency generator	Proposed Project Description: install an emergency generator
---	--

Dept: Zoning **Status:** Approved **Reviewer:** Chris Hanson **Approval Date:** 04/27/2009
Note: **Ok to Issue:**

Dept: Building **Status:** Approved with Conditions **Reviewer:** Chris Hanson **Approval Date:** 04/27/2009
Note: **Ok to Issue:**

- 1) Seperate permit required for propane tank location.
- 2) Equipment must be installed in compliance with the manufacturer's specifications
- 3) Separate permits are required for any electrical, plumbing, sprinkler, fire alarm or HVAC or exhaust systems. Separate plans may need to be submitted for approval as a part of this process.

City of Portland, Maine - Building or Use Permit

389 Congress Street, 04101 Tel: (207) 874-8703, Fax: (207) 874-8716

Permit No: 09-0356	Date Applied For: 04/24/2009	CBL: 379 F012001
------------------------------	--	----------------------------

Location of Construction: 74 RUSTIC LN	Owner Name: BAY MARK J & SARAH E KELSI	Owner Address: 74 RUSTIC LN	Phone:
Business Name:	Contractor Name: Rods Electric	Contractor Address: 366 Main Street Biddeford	Phone (207) 282-5398
Lessee/Buyer's Name	Phone:	Permit Type: Generator	

Proposed Use: Single Family Home - install an emergency generator	Proposed Project Description: install an emergency generator
---	--

Dept: Zoning	Status: Approved	Reviewer: Chris Hanson	Approval Date: 04/27/2009
Note:	Ok to Issue: <input checked="" type="checkbox"/>		
Dept: Building	Status: Approved with Conditions	Reviewer: Chris Hanson	Approval Date: 04/27/2009
Note:	Ok to Issue: <input checked="" type="checkbox"/>		
1) Seperate permit required for propane tank location. 2) Equipment must be installed in compliance with the manufacturer's specifications 3) Separate permits are required for any electrical, plumbing, sprinkler, fire alarm or HVAC or exhaust systems. Separate plans may need to be submitted for approval as a part of this process.			

Must have May 13th



General Building Permit Application

If you or the property owner owes real estate or personal property taxes or user charges on any property within the City, payment arrangements must be made before permits of any kind are accepted.

Location/Address of Construction: <u>74 Rustic Lane Portland, ME 04103</u>		
Total Square Footage of Proposed Structure/Area <u>8 sq. ft.</u>	Square Footage of Lot <u>7400 sq. ft.</u>	Number of Stories <u>2</u>
Tax Assessor's Chart, Block & Lot Chart# Block# Lot# <u>379-F-12</u>	Applicant * must be owner, Lessee or Buyer * Name <u>Mark Bay</u> Address <u>74 Rustic Lane</u> City, State & Zip <u>Portland, ME 04103</u>	Telephone: <u>878-6150</u>
Lessee/DBA (If Applicable)	Owner (if different from Applicant) Name Address City, State & Zip	Cost Of Work: \$ <u>3206.70</u> C of O Fee: \$ _____ Total Fee: \$ <u>60</u>
Current legal use (i.e. single family) <u>Single family</u> Number of Residential Units _____ If vacant, what was the previous use? _____ Proposed Specific use: <u>Emergency power supply</u> Is property part of a subdivision? <u>NO</u> If yes, please name _____ Project description: <u>I would like to install an emergency back up generator that will automatically activate in the event of power loss</u>		
Contractor's name: <u>Rod's Electric</u> Address: <u>366 Main St.</u> City, State & Zip <u>Biddeford, ME 04005</u> Telephone: <u>282-5398</u> Who should we contact when the permit is ready: <u>Mark Bay</u> Telephone: <u>878-6150</u> Mailing address: <u>74 Rustic Lane Portland, ME 04103</u>		

Please submit all of the information outlined on the applicable Checklist. Failure to do so will result in the automatic denial of your permit.

In order to be sure the City fully understands the full scope of the project, the Planning and Development Department may request additional information prior to the issuance of a permit. For further information or to download copies of this form and other applications visit the Inspections Division on-line at www.portlandmaine.gov, or stop by the Inspections Division office, room 315 City Hall or call 874-8703. 4/26/09

I hereby certify that I am the Owner of record of the named property, or that the owner of record authorizes the proposed work and that I have been authorized by the owner to make this application as his/her authorized agent. I agree to conform to all applicable laws of this jurisdiction. In addition, if a permit for work described in this application is issued, I certify that the Code Official's authorized representative shall have the authority to enter all areas covered by this permit at any reasonable hour to enforce the provisions of the codes applicable to this permit.

Signature: [Signature] Date: 4/21/09

This is not a permit; you may not commence ANY work until the permit is issue

Home Standby - 8 kW - 10 kW - 14 kW

GUARDIAN
by Generac Power Systems, Inc.

Rated Maximum Continuous Power Capacity (LP)	8,000 Watts*	10,000 Watts*	14,000 Watts*
Rated Maximum Continuous Power Capacity (NG)	7,000 Watts*	9,000 Watts*	13,000 Watts*
Rated Voltage	120/240	120/240	120/240
Rated Maximum Continuous Load Current			
120 Volts	66.6 LP/58.3 NG	83.3 LP/75.0 NG	116.6 LP/108.3 NG
240 Volts	33.3 LP/29.2 NG	41.6 LP/37.5 NG	58.3 LP/54.2 NG
Total Harmonic Distortion	Less than 5%	Less than 5%	Less than 5%
Main Line Circuit Breaker	35 Amp	45 Amp	60 Amp
Phase	1	1	1
Number of Rotor Poles	2	2	2
Rated AC Frequency	60Hz	60Hz	60Hz
Power Factor	1	1	1
Battery Requirement (not included)	Group 26 12 Volts and 350 Cold-cranking Amperes Minimum	Group 26 12 Volts and 525 Cold-cranking Amperes Minimum	Group 26 12 Volts and 525 Cold-cranking Amperes Minimum
Unit Weight	336 Pounds	375 Pounds	425.5 Pounds
Dimensions (L" x W" x H")	48 x 25 x 29	48 x 25 x 29	48 x 25 x 29
Sound output in dB(A) at 23 ft. with generator operating at normal load	62	63	66
Type of Engine	GENERAC OHVI	GENERAC OHVI V-TWIN	GENERAC OHVI V-TWIN
Number of Cylinders	1	2	2
Rated Horsepower	14.8 @ 3,600 rpm	18 @ 3,600 rpm	32 @ 3,600 rpm
Displacement	410cc	530cc	992cc
Cylinder Block	Aluminum w/Cast Iron Sleeve	Aluminum w/Cast Iron Sleeve	Aluminum w/Cast Iron Sleeve
Valve Arrangement	Overhead Valve	Overhead Valve	Overhead Valve
Ignition System	Solid-state w/Magneto	Solid-state w/Magneto	Solid-state w/Magneto
Governor System	Mechanical	Electronic	Electronic
Compression Ratio	8.6:1	9.5:1	9.5:1
Starter	12 Vdc	12 Vdc	12 Vdc
Oil Capacity Including Filter	Approx. 1.5 Qts.	Approx. 1.7 Qts.	Approx. 1.7 Qts.
Operating RPM	3,600	3,600	3,600
Fuel Consumption			
Natural Gas	cu.ft./hr.		
1/2 Load	77	102	156
Full Load	139	156	220
Liquid Propane	ft ³ /hr (gal/hr)		
1/2 Load	34 (0.94)	46 (1.25)	58 (1.56)
Full Load	62 (1.68)	70 (1.93)	84 (2.30)

Required fuel pressure to generator fuel inlet at all load ranges - 5 to 7 inches of water column for natural gas, 11 to 14 inches of water column for LP gas

2-Line Plain Text LCD Display (10 & 14 kW)	Simple user interface for ease of operation
Mode Switch	
-Auto	Automatic Start on Utility failure. 7 day exerciser
-Off	Stops unit. Power is removed. Control and charger still operate.
-Manual/Test (start)	Start with starter control, unit stays on. If utility fails, transfer to load takes place.
Engine Start Sequence	Cyclic cranking: 7 sec. on, 7 rest (90 sec. maximum duration)
Engine Warm-up	10 seconds
Engine Cool-Down	1 minute
Starter Lock-out	Starter cannot re-engage until 5 sec. after engine has stopped.
2.5 Amp Timed Trickle Battery Charger	Standard
Automatic Voltage Regulator w/Overvoltage Protection	Standard
Automatic Low Oil Pressure Shutdown	Standard
Overspeed Shutdown	Standard. 72Hz
High Temperature Shutdown	Standard
Overcrank Protection	Standard
Safety Fuse	Standard

Rating definitions - Standby: Applicable for supplying emergency power for the duration of the utility power outage. No overload capability is available for this rating. (All ratings in accordance with BS5514, ISO3046 and DIN6271). * Maximum wattage and current are subject to and limited by such factors as fuel Btu content, ambient temperature, altitude, engine power and condition, etc. Maximum power decreases about 3.5 percent for each 1,000 feet above sea level; and also will decrease about 1 percent for each 12° C (10° F) above 15.5° C (60 F).

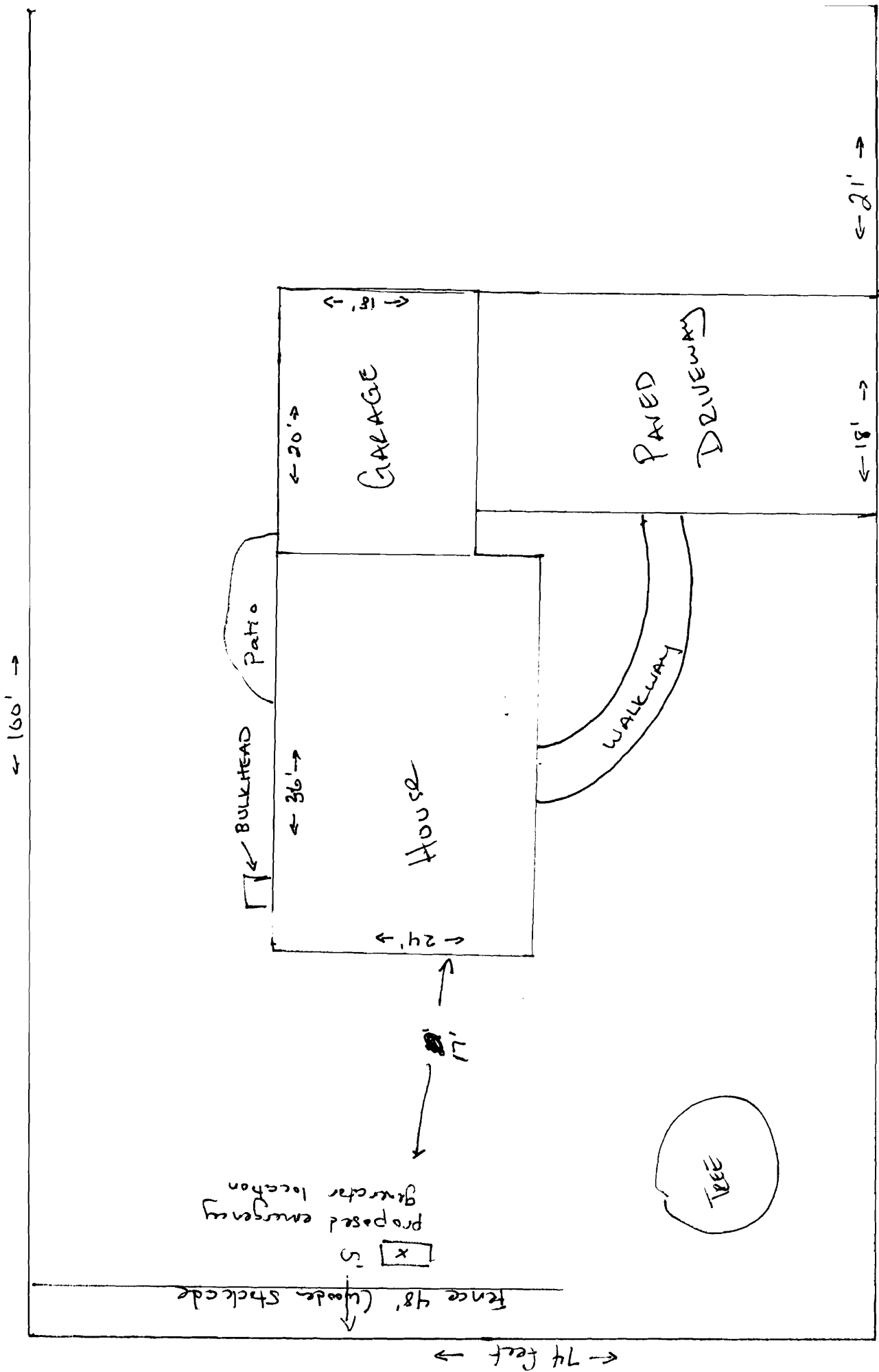

← 160' →
 ← 160' → Rustic Lane →

Home Standby - 8 kW - 10 kW - 14 kW

GUARDIAN
by Generac Power Systems, Inc.



No. of Poles	2	2	2
Current Rating (amps)	100	100	100
Voltage Rating (VAC)	250	250	250
Utility Voltage Monitor (fixed)			
-Pick-up	75%	75%	75%
-Dropout	65%	65%	65%
Return to Utility	approx. 13 sec.	approx. 13 sec.	approx. 13 sec.
Exerciser weekly for 12 minutes	Standard	Standard	Standard
UL Listed	Standard	Standard	Standard
Dimensions (H" x W" x D")	26.5 x 12.5 x 7	26.5 x 12.5 x 7	26.5 x 12.5 x 7
Total of Pre-wired Circuits	8	10	14
No. 15A 120V	5	3	4
No. 20A 120V	1	3	4
No. 20A 240V	-	1	1
No. 30A 240V	1	1	-
No. 40A 240V	-	-	1
No. 50A 240V	-	-	1
Circuit Breaker Protected			
Available RMS Symmetrical Fault Current @ 250 Volts	10,000	10,000	10,000

Transfer Switch Features

- Electrically operated, mechanically-held contacts for fast, positive connections.
- Rated for all classes of load, 100% equipment rated, both inductive and resistive.
- 2 pole, 250 VAC contactors.
- 160 millisecond transfer time.
- Dual coil design.
- Main contacts are silver plated or silver alloy to resist welding and sticking.
- NEMA 1 (indoor rated) enclosure is standard on the 100 amp switch.

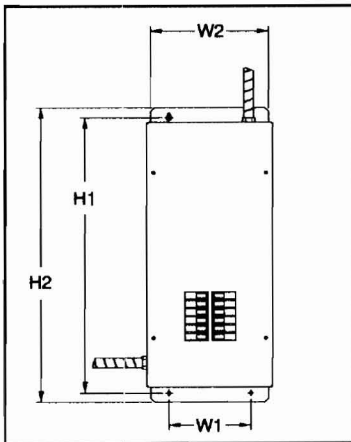

Mechanical Dimensions (in inches)						
Current Rating	No. of Poles	Height		Width		Depth
		H1	H2	W1	W2	
100 UL Listed	2	26.5	29.25	8.14	12.5	7

Terminal Wire Ranges			
ATS Rated Amps	Switch Terminal	Neutral Lug/Stud	Ground Lug
100A 2-Pole UL	1 x 1/0-12	1 x 3/8-16 Stud	1 x 2/0-14

** Composite panel comes with generator*

Design and specifications subject to change without notice. Dimensions shown are approximate. Contact your Generac dealer for certified drawings. DO NOT USE THESE DIMENSIONS FOR INSTALLATION PURPOSES.

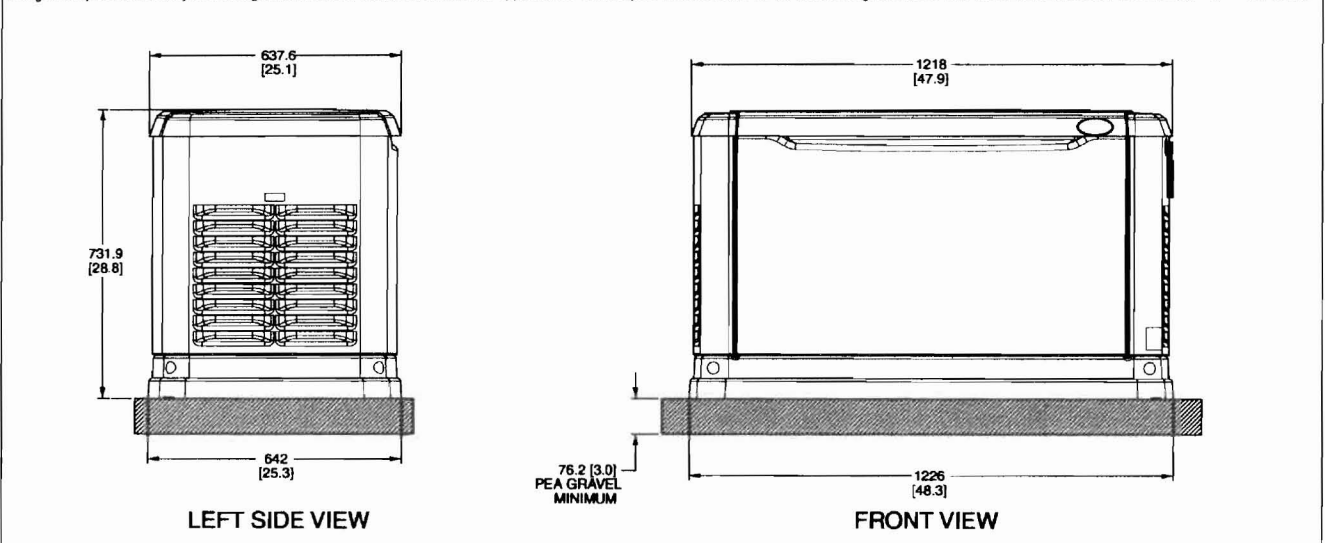

GENERAC POWER SYSTEMS, INC. • P.O. BOX 297 • WHITEWATER, WI 53190
WEBSITE: www.guardiangenerators.com