

R-2 124 Bramblewood  
378-A-0067

S 25° 0' 0" E 91.853'

2 Stories = 14' set back - showing 14' & 15'

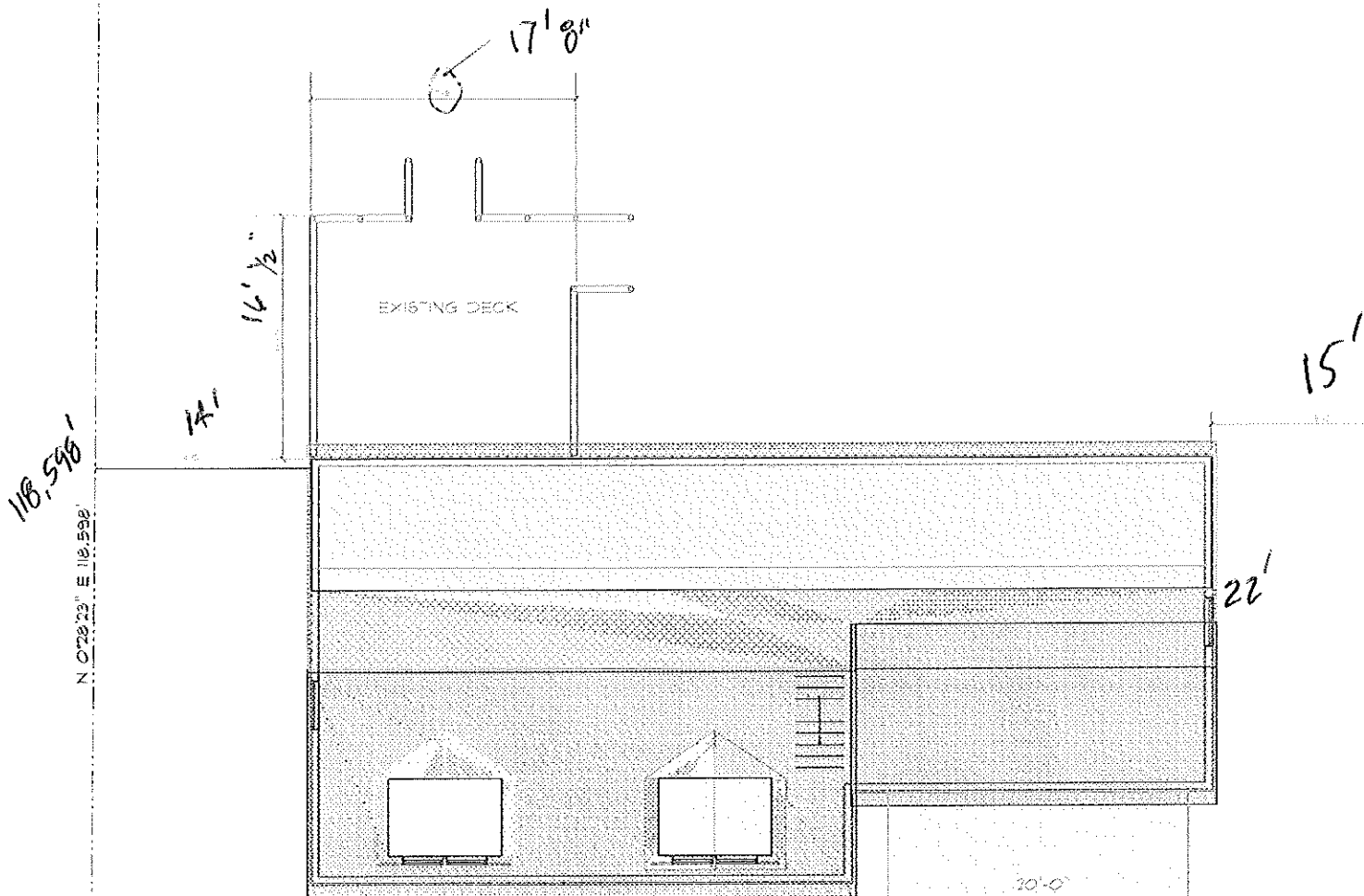

118.598'

N 07° 23' E 18.598'

14'

16' 1/2"

17' 8"

EXISTING DECK

15'

22'

20'-0"

RECEIVED

MAR - 4 2014  
RECEIVED

MAR - 4 2014

Dept. of Building Inspections  
City of Portland Maine

16'  
22'  
46'  
84'

16  
22  
46  
84

118.598  
- 84  
34.598  
A  
Rear Setback

N 90° 0' 0" W 90.003'

124 Bramblewood  
378-A-067

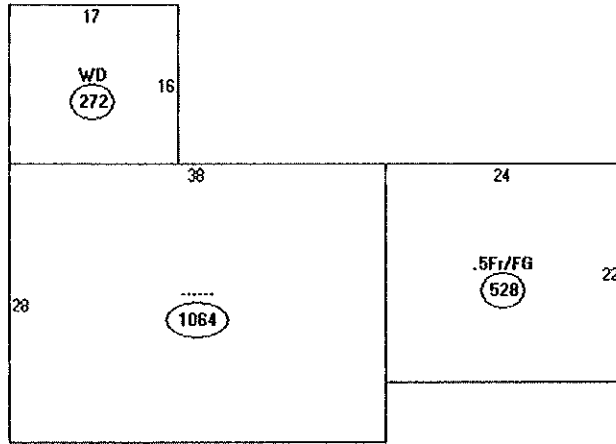

Descriptor/Area

- A:-----  
1064 sqft
- B:WD  
272 sqft
- C: .5Fr/FG  
528 sqft