

DISPLAY THIS CARD ON PRINCIPAL FRONTAGE OF WORK

CITY OF PORTLAND

BUILDING INSPECTION

PERMIT

Permit Number: 090726

Please Read Application And Notes, If Any, Attached

This is to certify that Sethe Ferrante/self

has permission to Amendment to permit #090573 changing the 12' x 28' deck with a double beam support.

AT 97 Bartley Ave CBL 378 A035001

provided that the person or persons, firm or corporation accepting this permit shall comply with all of the provisions of the Statutes of Maine and of the Ordinances of the City of Portland regulating the construction, maintenance and use of buildings and structures, and of the application on file in this department.

Apply to Public Works for street line and grade if nature of work requires such information.
PERMIT ISSUED
JUL 20 2009
CITY OF PORTLAND

Notification of inspection must be given and written permission procured before this building or part thereof is lathed or otherwise closed-in. 24 HOUR NOTICE IS REQUIRED.

A certificate of occupancy must be procured by owner before this building or part thereof is occupied.

OTHER REQUIRED APPROVALS

Fire Dept. _____
Health Dept. _____
Appeal Board _____
Other _____
Department Name

Thomas M. Mullen 7/21/09
Director - Building & Inspection Services

PENALTY FOR REMOVING THIS CARD

CITY OF PORTLAND, MAINE
Department of Building Inspections

Original Receipt

Received from Sethe Ferrante July 13 20 09

Location of Work 97 Bartley Ave

Cost of Construction \$ _____ Building Fee: _____

Permit Fee \$ _____ Site Fee: _____

Certificate of Occupancy Fee: _____

Total: _____

Building (1L) Plumbing (15) _____ Electrical (12) Site Plan (U2) _____

Other _____ Electric 45.00

CBL: 378 A035 2669 50.00

Check #: 66 Total Collected \$ 95.00

**No work is to be started until permit issued.
Please keep original receipt for your records.**

Taken by: [Signature]

WHITE - Applicant's Copy
YELLOW - Office Copy
PINK - Permit Copy

City of Portland, Maine - Building or Use Permit Application

389 Congress Street, 04101 Tel: (207) 874-8703, Fax: (207) 874-8716

Permit No: 09-0726	Issue Date:	CBL: 378 A035001
-----------------------	-------------	---------------------

Location of Construction: 97 Bartley Ave	Owner Name: Sethe Ferrante	Owner Address: 97 Bartley Avenue	Phone: 207-766-6443
Business Name:	Contractor Name: self	Contractor Address: Portland	Phone:
Lessee/Buyer's Name	Phone:	Permit Type: Alterations - Dwellings	Zone: R-2

Past Use: Single Family	Proposed Use: Single Family / Amendment to permit #090573 changing the 12' x 28' deck with a double beam support.	Permit Fee: \$50.00	Cost of Work: \$2,800.00	CEO District: 5	Zone Zone
Proposed Project Description: Amendment to permit #090573 changing the 12' x 28' deck with a double beam support. <i>was previously 12' x 26'</i>		FIRE DEPT: <input type="checkbox"/> Approved <input type="checkbox"/> Denied INSPECTION: Use Group: R3 Type: SB IRC 2003		Signature: <i>Jim 7/21/09</i>	

PEDESTRIAN ACTIVITIES DISTRICT (P.A.D.) Action: <input type="checkbox"/> Approved <input type="checkbox"/> Approved w/Conditions <input type="checkbox"/> Denied Signature: _____ Date: _____	
---	--

Permit Taken By: gg	Date Applied For: 07/13/2009	Zoning Approval	
------------------------	---------------------------------	------------------------	--

1. This permit application does not preclude the Applicant(s) from meeting applicable State and Federal Rules. 2. Building permits do not include plumbing, septic or electrical work. 3. Building permits are void if work is not started within six (6) months of the date of issuance. False information may invalidate a building permit and stop all work..	Special Zone or Reviews <input type="checkbox"/> Shoreland <input type="checkbox"/> Wetland <input type="checkbox"/> Flood Zone <input type="checkbox"/> Subdivision <input type="checkbox"/> Site Plan Maj <input type="checkbox"/> Minor <input type="checkbox"/> MM <input type="checkbox"/>	Zoning Appeal <input type="checkbox"/> Variance <input type="checkbox"/> Miscellaneous <input type="checkbox"/> Conditional Use <input type="checkbox"/> Interpretation <input type="checkbox"/> Approved <input type="checkbox"/> Denied	Historic Preservation <input checked="" type="checkbox"/> Not in District or Landmark <input type="checkbox"/> Does Not Require Review <input type="checkbox"/> Requires Review <input type="checkbox"/> Approved <input type="checkbox"/> Approved w/Conditions <input type="checkbox"/> Denied
	Date: <i>ok with conditions</i> <i>7/15/09</i>	Date: _____	Date: _____



CERTIFICATION

I hereby certify that I am the owner of record of the named property, or that the proposed work is authorized by the owner of record and that I have been authorized by the owner to make this application as his authorized agent and I agree to conform to all applicable laws of this jurisdiction. In addition, if a permit for work described in the application is issued, I certify that the code official's authorized representative shall have the authority to enter all areas covered by such permit at any reasonable hour to enforce the provision of the code(s) applicable to such permit.

SIGNATURE OF APPLICANT ADDRESS DATE PHONE

RESPONSIBLE PERSON IN CHARGE OF WORK, TITLE DATE PHONE



General Building Permit Application

If you or the property owner owes real estate or personal property taxes or user charges on any property within the City, payment arrangements must be made before permits of any kind are accepted.

Location/Address of Construction: <u>97 Bartley Ave, Portland, ME 04103</u>		
Total Square Footage of Proposed Structure/Area <u>12' x 28'</u>		Square Footage of Lot <u>9600</u>
Tax Assessor's Chart, Block & Lot Chart# Block# Lot# <u>378 A035001</u>	Applicant * must be owner, Lessee or Buyer * Name <u>Seth Ferrante</u> Address <u>97 Bartley Ave</u> City, State & Zip <u>Portland, ME, 04103</u>	Telephone: <u>207 766 443</u> <i>X</i> <i>Call</i>
Lessee/DBA (If Applicable)	Owner (if different from Applicant) Name Address City, State & Zip	Cost Of Work: \$ <u>2800</u> C of O Fee: \$ <u>-</u> Total Fee: \$ <u>2800</u> <i>TOTAL \$30.00</i>
Current legal use (i.e. single family) <u>single family</u> If vacant, what was the previous use? _____ Proposed Specific use: <u>same</u> Is property part of a subdivision? _____ If yes, please name _____ Project description: <u>AMENDMENT TO EXISTING PERMIT: Change to a 12' x 28' deck with a double beam support as indicated. Also, the addition of 2 ground faulted receptacles and 2 lights with switches.</u>		
Contractor's name: <u>N/A</u>		
Address: _____		
City, State & Zip _____		Telephone: <u>JUL 13 2009</u>
Who should we contact when the permit is ready: _____		Telephone: _____
Mailing address: _____		

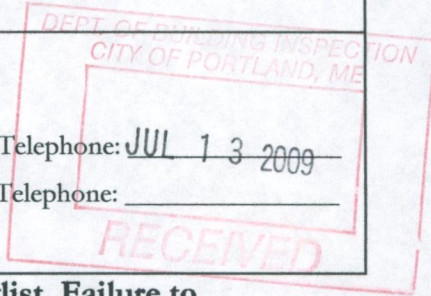

Please submit all of the information outlined on the applicable Checklist. Failure to do so will result in the automatic denial of your permit.

In order to be sure the City fully understands the full scope of the project, the Planning and Development Department may request additional information prior to the issuance of a permit. For further information or to download copies of this form and other applications visit the Inspections Division on-line at www.portlandmaine.gov, or stop by the Inspections Division office, room 315 City Hall or call 874-8703.

I hereby certify that I am the Owner of record of the named property, or that the owner of record authorizes the proposed work and that I have been authorized by the owner to make this application as his/her authorized agent. I agree to conform to all applicable laws of this jurisdiction. In addition, if a permit for work described in this application is issued, I certify that the Code Official's authorized representative shall have the authority to enter all areas covered by this permit at any reasonable hour to enforce the provisions of the codes applicable to this permit.

Signature: Seth Ferrante Date: 7-9-09

This is not a permit; you may not commence ANY work until the permit is issued

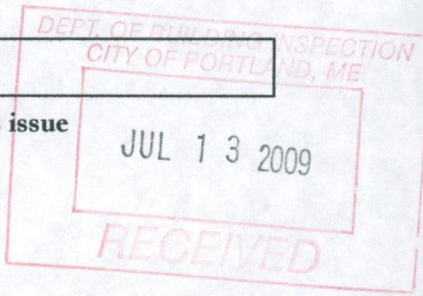

City of Portland, Maine - Building or Use Permit

389 Congress Street, 04101 Tel: (207) 874-8703, Fax: (207) 874-8716

Permit No: 09-0726	Date Applied For: 07/13/2009	CBL: 378 A035001
------------------------------	--	----------------------------

Location of Construction: 97 Bartley Ave	Owner Name: Sethe Ferrante	Owner Address: 97 Bartley Avenue	Phone: 207-766-6443
Business Name:	Contractor Name: self	Contractor Address: Portland	Phone:
Lessee/Buyer's Name	Phone:	Permit Type: Alterations - Dwellings	

Proposed Use: Single Family / Amendment to permit #090573 changing the 12' x 26' deck to 12' x 28' with a double beam support.	Proposed Project Description: Amendment to permit #090573 changing the 12' x 26' deck to 12' x 28' with a double beam support.
--	--

Dept: Zoning	Status: Approved with Conditions	Reviewer: Marge Schmuckal	Approval Date: 07/15/2009
Note:			Ok to Issue: <input checked="" type="checkbox"/>
<p>1) Separate permits shall be required for future decks, sheds, pools, and/or garages.</p> <p>2) This is NOT an approval for an additional dwelling unit. You SHALL NOT add any additional kitchen equipment including, but not limited to items such as stoves, microwaves, refrigerators, or kitchen sinks, etc. Without special approvals.</p> <p>3) This property shall remain a single family dwelling. Any change of use shall require a separate permit application for review and approval.</p> <p>4) This permit is being approved on the basis of plans submitted. Any deviations shall require a separate approval before starting that work.</p>			
Dept: Building	Status: Approved with Conditions	Reviewer: Tom Markley	Approval Date: 07/21/2009
Note:			Ok to Issue: <input checked="" type="checkbox"/>
<p>1) Application approval based upon information provided by applicant. Any deviation from approved plans requires separate review and approval prior to work.</p>			

Comments:
 7/14/2009-mes: The previous permit was zoned wrong - it is an R-2 Zone not an R-3 zone - called owner to confirm the deck is being enlarged from 12' x 26' to 12' x 28'.
 7/15/2009-mes: applicant confirmed the larger deck and the new structural work

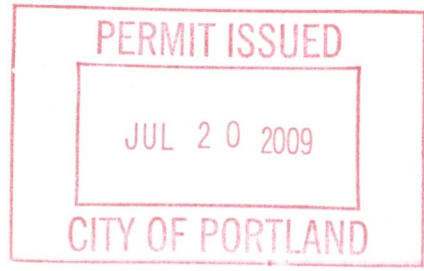

PLOT PLAN

R-2 zone

Front: 25' min - ok
Rear: 25' min 32'6" shown
Side: 12' min - 16' shown
1 story (deck)

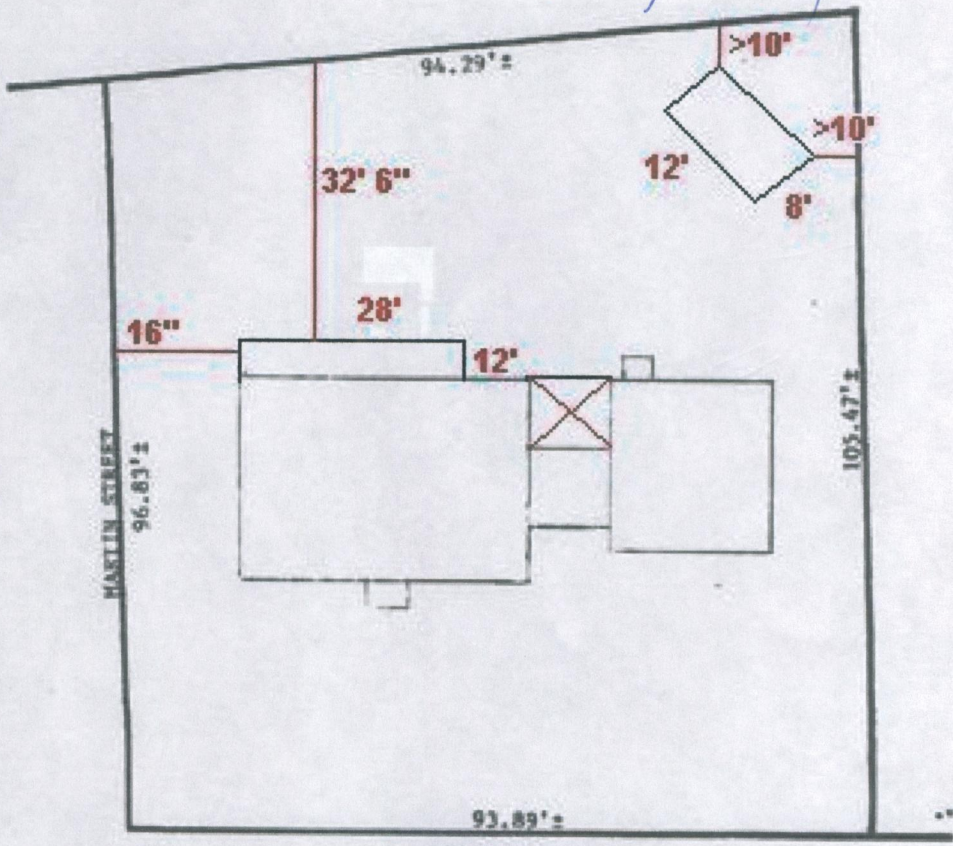

BARTLEY AVENUE

LOT FROM
ASSESSOR'S MAP
SCALE 1" = 20' ±

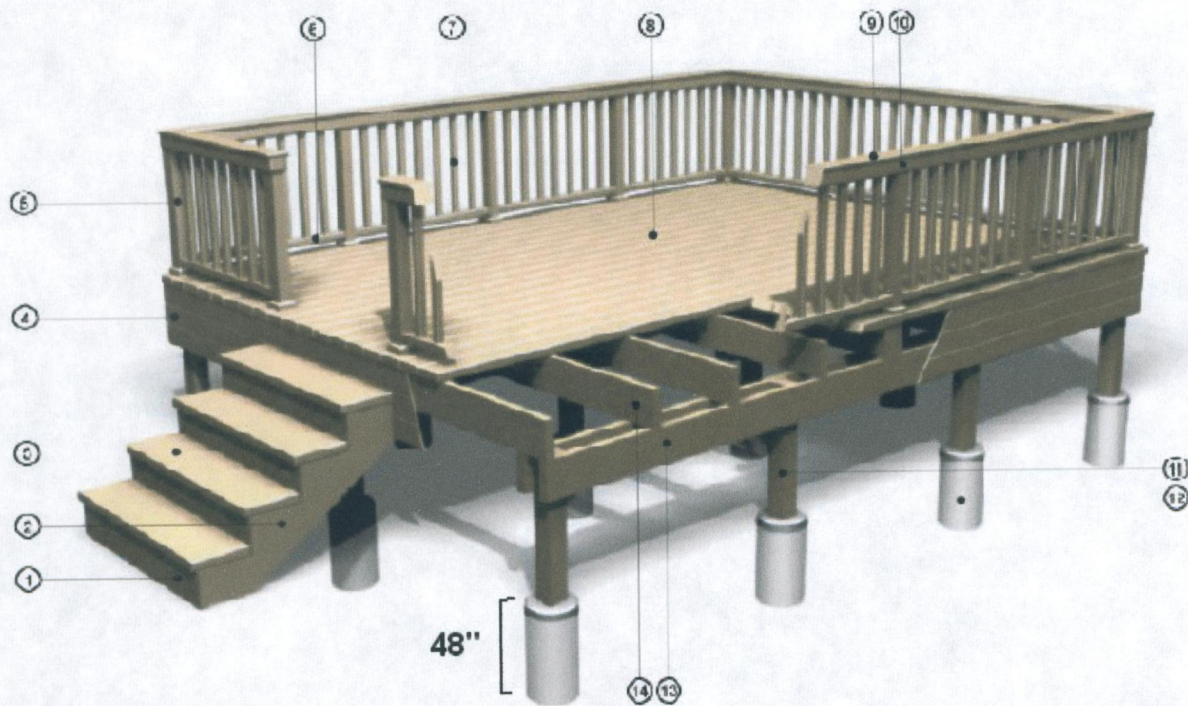
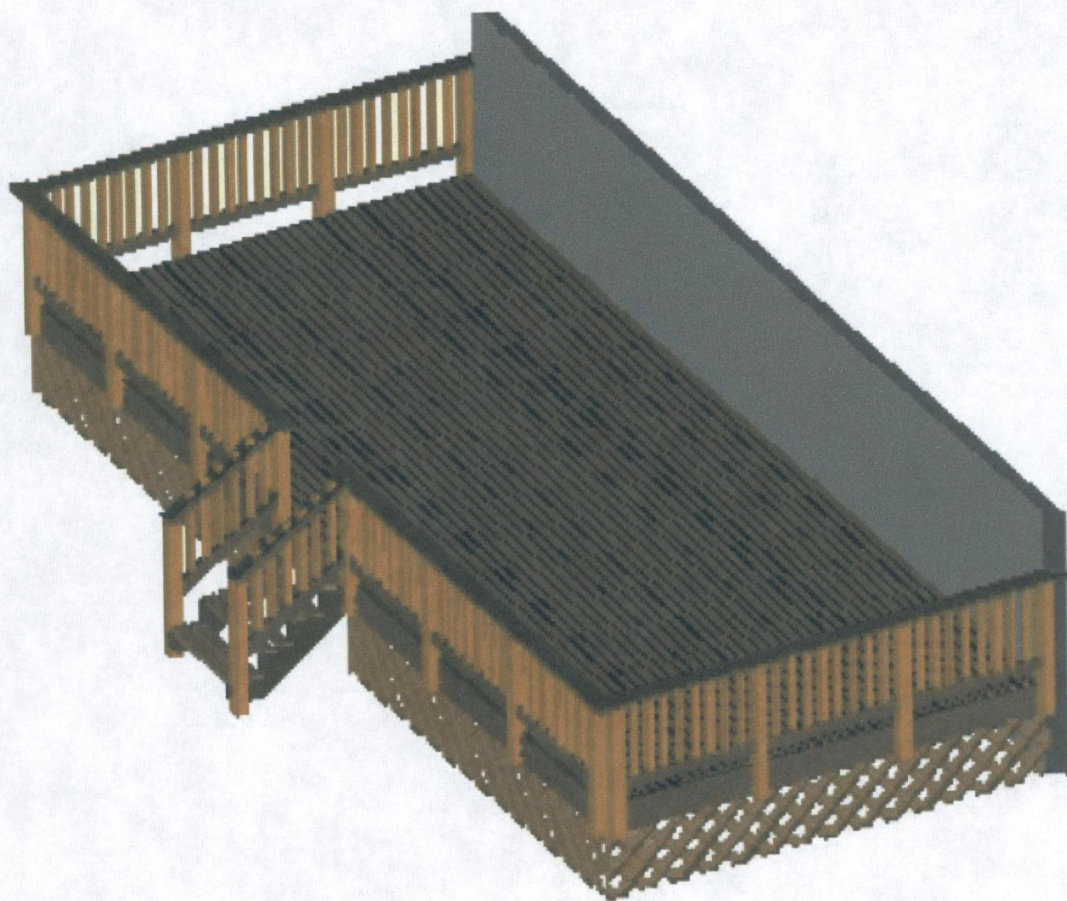

1. Riser	6. Bottom Rail	11. Post
2. Stringer	7. Baluster	12. Post Footer
3. Tread	8. Decking	13. Beam
4. Fascia	9. Rail Cap	14. Joist
5. Rail Post	10. Top Rail	

Major Deck Components

NOTE: Not to scale

©2007 DIY Technologies

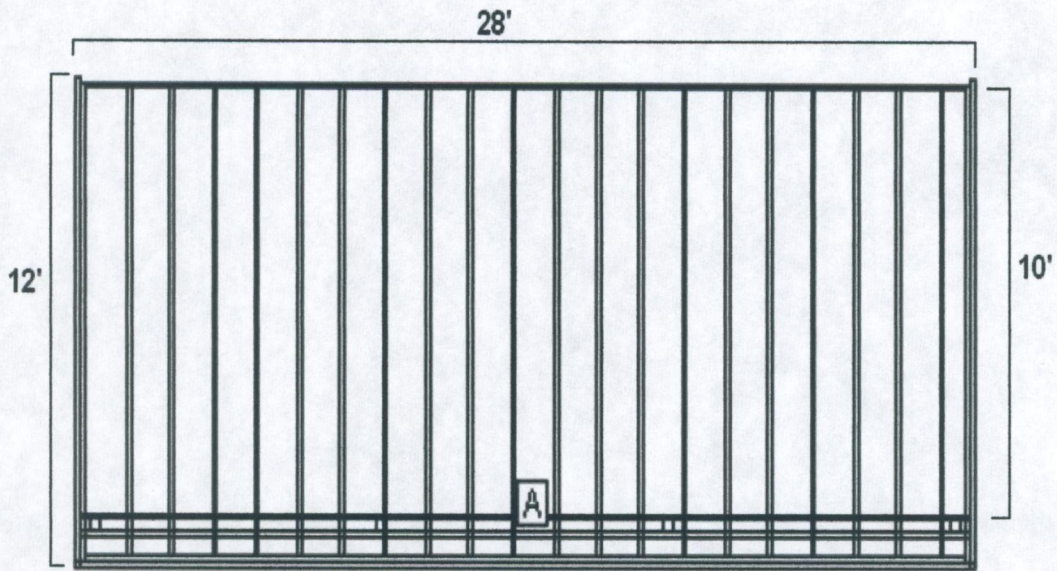

Double 2x10 beams with 4x4 posts between with posts spaced 7' apart.

BEAM LABEL	BEAM LENGTH	POST COUNT	POST SPACING
A - 2x10(double beam)	27' 9"	4	7'

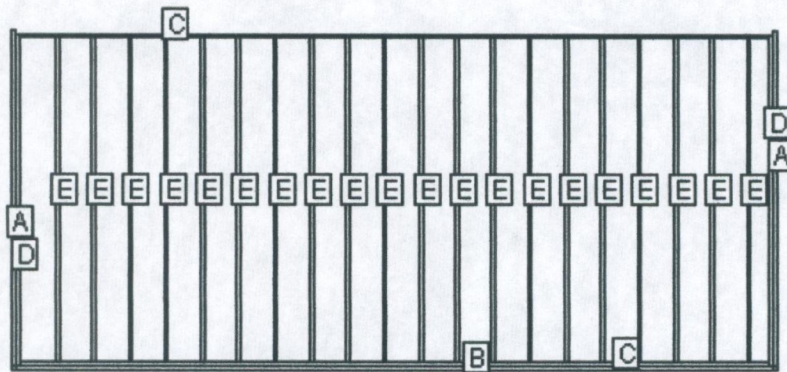

LABEL NAME	QTY	LENGTH	BEVELS	LABEL NAME	QTY	LENGTH	BEVELS
A Fascia	2	12'	F45 S45	D Outer Joist	2	11' 9"	
B Fascia	1	28'	F45 S45	E Joist	20	11' 6"	
C Header	2	27' 6"					

Joists:

Set joists on top of beams, 16"; center to center.

Component	Size	Wood Type
Joists	2 x 10	Pressure Treated
Beams	2 x 10	Pressure Treated
Posts	4 x 4	Pressure Treated
Decking	5/4 x 4	Architectural Knotty

LOAD AND SUPPORT:

Your deck will support a 42 PSF live load.
Posts have 48" below ground support.

DECK AND POST HEIGHT:

You selected a height of 30" from the top of the decking to the ground level. The top of the deck support posts will therefore be 19.25" above ground level.

Joists:

Set joists on top of beams, 16"; center to center.

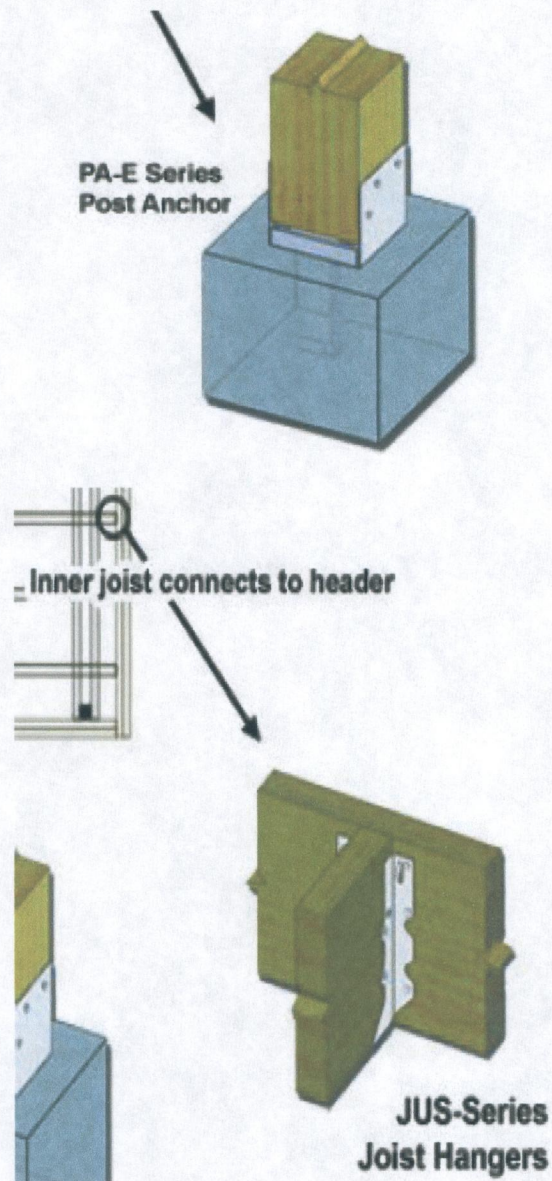

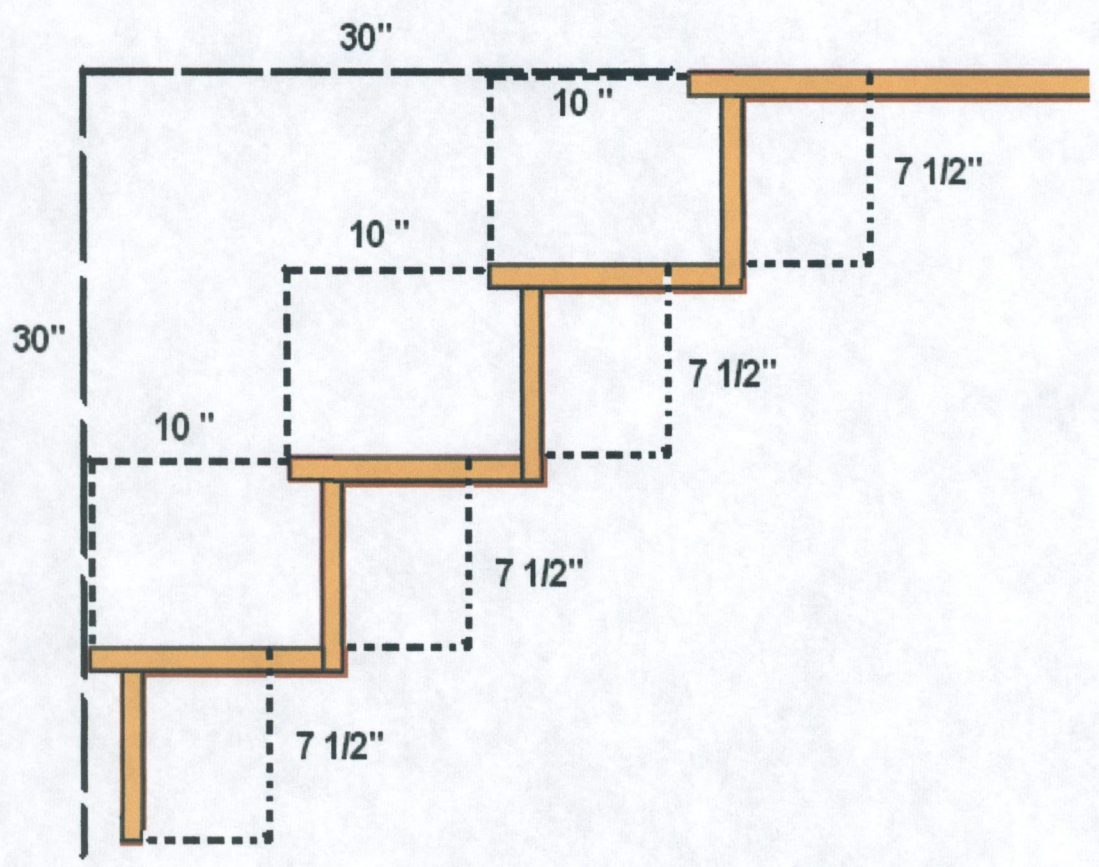
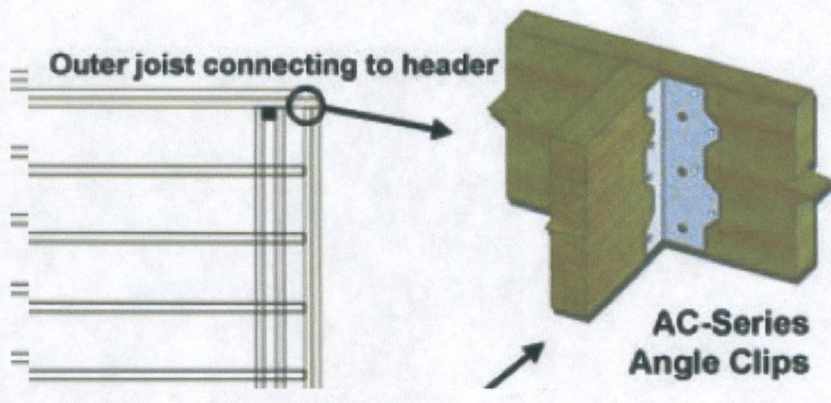

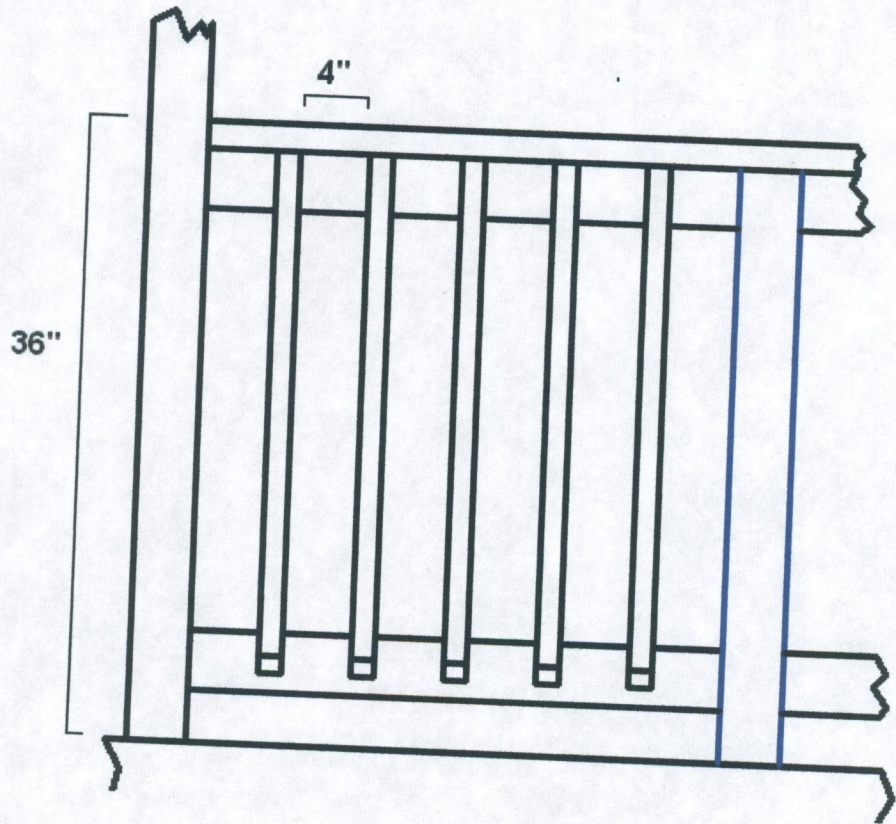
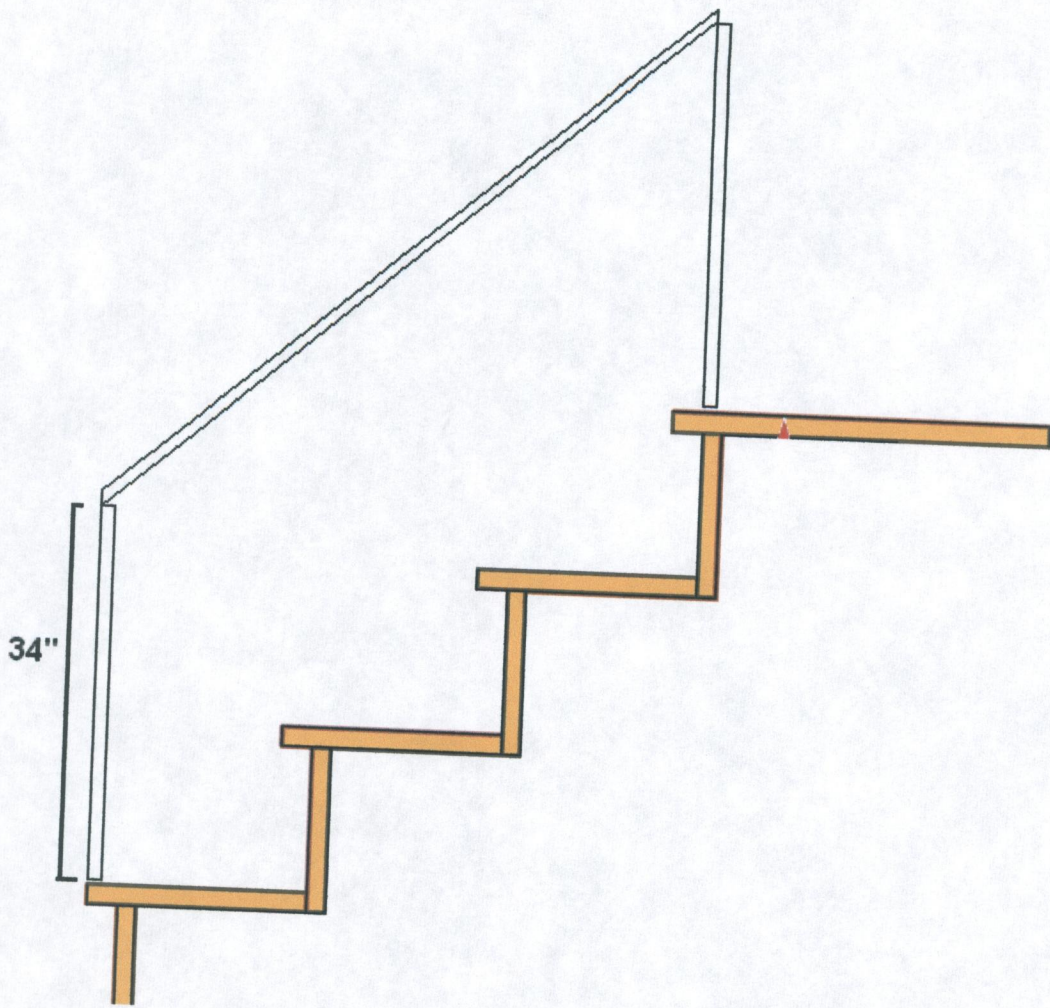

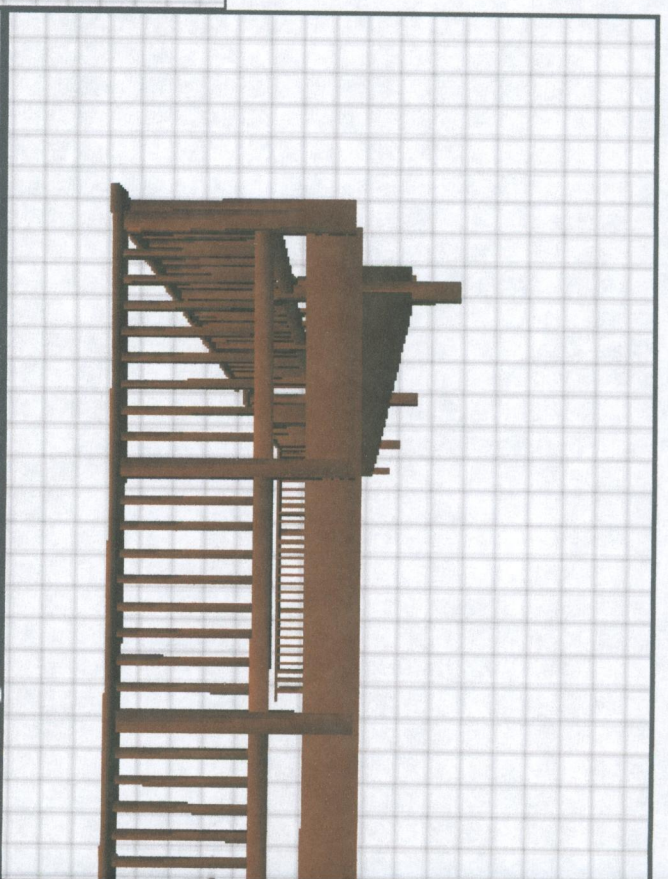
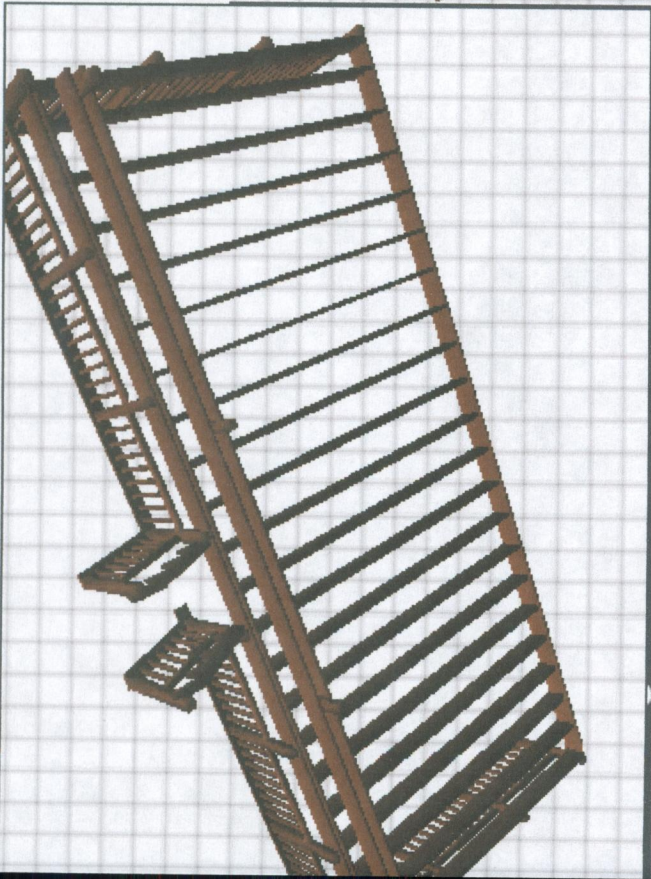
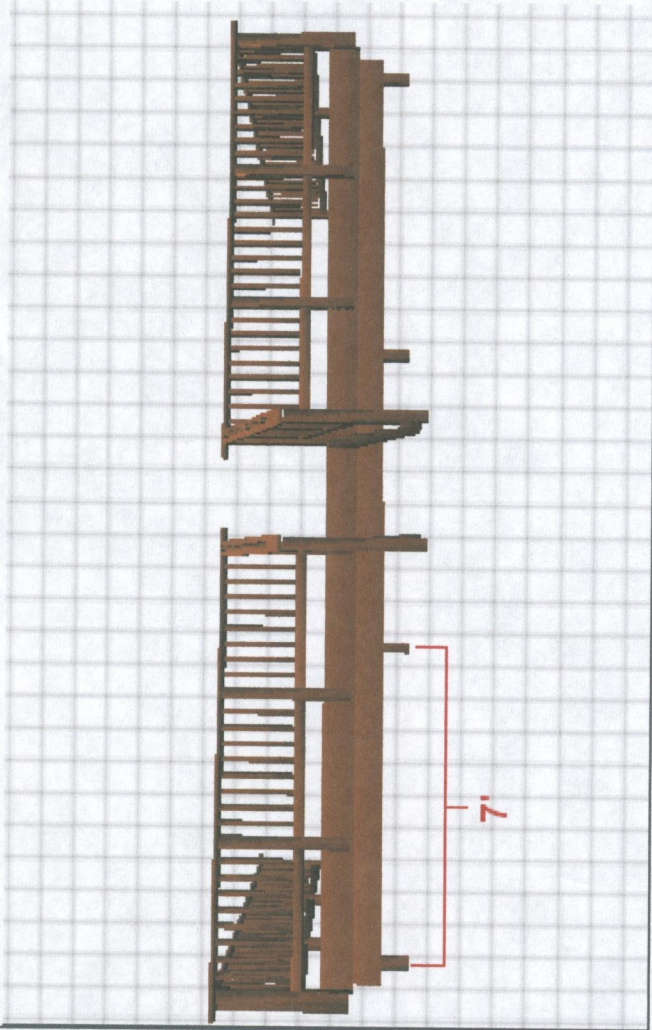

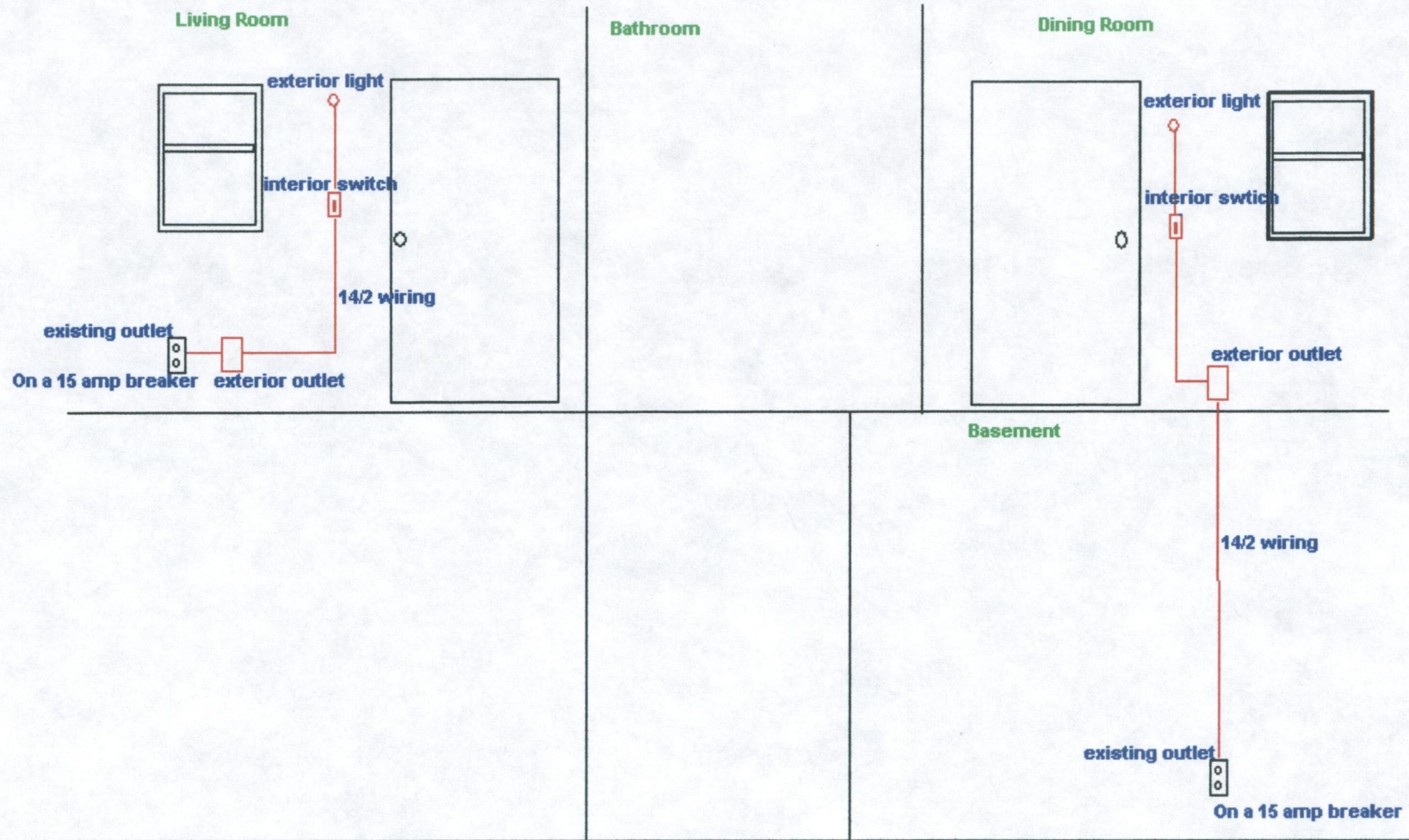



CITY OF PORTLAND, MAINE

Department of Building Inspections

Original Receipt

July 13 20 09

Received from Seth T. Farnsworth

Location of Work 97 Banting Ave

Cost of Construction \$ _____ Building Fee: _____

Permit Fee \$ _____ Site Fee: _____

Certificate of Occupancy Fee: _____

Total: _____

Building (IL) Plumbing (IS) _____ Electrical (I2) Site Plan (U2) _____

Other _____

CBL: 275 A035 electric 45.00
Bldg 50.00

Check #: CC **Total Collected \$** 95.00

**No work is to be started until permit issued.
Please keep original receipt for your records.**

Taken by: [Signature]

WHITE - Applicant's Copy
YELLOW - Office Copy
PINK - Permit Copy