

DISPLAY THIS CARD ON PRINCIPAL FRONTAGE OF WORK



CITY OF PORTLAND

BUILDING PERMIT

This is to certify that SYLVIA A COOMBS

Located At 42 SUMAC ST

Job ID: 2012-05-3937-DRG

CBL: 378- A-025-001

has permission to Build an 8 X 8 shed

provided that the person or persons, firm or corporation accepting this permit shall comply with all of the provisions of the Statutes of Maine and of the Ordinances of the City of Portland regulating the construction, maintenance and use of the buildings and structures, and of the application on file in the department.

Notification of inspection and written permission procured before this building or part thereof is lathed or otherwise closed-in. 48 HOUR NOTICE IS REQUIRED.

A final inspection must be completed by owner before this building or part thereof is occupied. If a certificate of occupancy is required, it must be

N/A

[Signature]

5/16/12

Fire Prevention Officer

Code Enforcement Officer / Plan Reviewer

THIS CARD MUST BE POSTED ON THE STREET SIDE OF THE PROPERTY

PENALTY FOR REMOVING THIS CARD

BUILDING PERMIT INSPECTION PROCEDURES

Please call 874-8703 or 874-8693 (ONLY)

or email: buildinginspections@portlandmaine.gov

With the issuance of this permit, the owner, builder or their designee is required to provide adequate notice to the city of Portland Inspections Services for the following inspections. Appointments must be requested 48 to 72 hours in advance of the required inspection. The inspection date will need to be confirmed by this office.

- **Please read the conditions of approval that is attached to this permit!! Contact this office if you have any questions.**
- **Permits expire in 6 months. If the project is not started or ceases for 6 months.**
- **If the inspection requirements are not followed as stated below additional fees may be incurred due to the issuance of a "Stop Work Order" and subsequent release to continue.**

Final Inspection

The project cannot move to the next phase prior to the required inspection and approval to continue, REGARDLESS OF THE NOTICE OF CIRCUMSTANCES.

IF THE PERMIT REQUIRES A CERTIFICATE OF OCCUPANCY, IT MUST BE PAID FOR AND ISSUED TO THE OWNER OR DESIGNEE BEFORE THE SPACE MAY BE OCCUPIED.



PORTLAND MAINE

Strengthening a Remarkable City, Building a Community for Life • www.portlandmaine.gov

Acting Director of Planning and Urban Development
Gregory Mitchell

Job ID: 2012-05-3937-DRG

Located At: 42 SUMAC ST

CBL: 378- A-025-001

Conditions of Approval:

Zoning

1. This permit is being approved on the basis of plans submitted. Any deviations shall require a separate approval before starting that work.
2. This property shall remain a single family dwelling. Any change of use shall require a separate permit application for review and approval.
3. Section R105.2 of the International Residential Code states that structures 200 square feet or under are exempt from building code review. This structure has not been reviewed for codes or safety under the building codes. The owner takes full responsibility for structural integrity.

City of Portland, Maine - Building or Use Permit Application

389 Congress Street, 04101 Tel: (207) 874-8703, FAX: (207) 8716

Job No: 2012-05-3937-DRG	Date Applied: 5/7/2012	CBL: 378- A-025-001	
Location of Construction: 42 SUMAC ST	Owner Name: SYLVIA A COOMBS	Owner Address: 42 SUMAC ST PORTLAND, ME 04103	Phone: 207-767-3127
Business Name:	Contractor Name: S & S Services – Scott Nadeau	Contractor Address: 284 Elm St., Limerick, ME 04048	Phone: 207-615-3354
Lessee/Buyer's Name:	Phone:	Permit Type: SHED - Shed	Zone: R-2
Past Use: Single family	Proposed Use: Same – single family – build 8' x 8' shed	Cost of Work: 4000.00	CEO District:
		Fire Dept: <input type="checkbox"/> Approved <input type="checkbox"/> Denied <input checked="" type="checkbox"/> N/A	Inspection: Use Group: Type: Signature: <i>N/A</i>
Proposed Project Description: Build an 8 X 8 Shed		Pedestrian Activities District (P.A.D.)	

Permit Taken By:	Zoning Approval		
<p>1. This permit application does not preclude the Applicant(s) from meeting applicable State and Federal Rules.</p> <p>2. Building Permits do not include plumbing, septic or electrical work.</p> <p>3. Building permits are void if work is not started within six (6) months of the date of issuance. False informatin may invalidate a building permit and stop all work.</p>	Special Zone or Reviews <input type="checkbox"/> Shoreland <input type="checkbox"/> Wetlands <input type="checkbox"/> Flood Zone <input type="checkbox"/> Subdivision <input type="checkbox"/> Site Plan <input type="checkbox"/> Maj <input type="checkbox"/> Min <input type="checkbox"/> MM Date: <i>OK w/condition 5/16/12 ABM</i>	Zoning Appeal <input type="checkbox"/> Variance <input type="checkbox"/> Miscellaneous <input type="checkbox"/> Conditional Use <input type="checkbox"/> Interpretation <input type="checkbox"/> Approved <input type="checkbox"/> Denied Date:	Historic Preservation <input checked="" type="checkbox"/> Not in Dist or Landmark <input type="checkbox"/> Does not Require Review <input type="checkbox"/> Requires Review <input type="checkbox"/> Approved <input type="checkbox"/> Approved w/Conditions <input type="checkbox"/> Denied Date: <i>ABM</i>
	CERTIFICATION		

I hereby certify that I am the owner of record of the named property, or that the proposed work is authorized by the owner of record and that I have been authorized by the owner to make this application as his authorized agent and I agree to conform to all applicable laws of this jurisdiction. In addition, if a permit for work described in the application is issued, I certify that the code official's authorized representative shall have the authority to enter all areas covered by such permit at any reasonable hour to enforce the provision of the code(s) applicable to such permit.

SIGNATURE OF APPLICANT	ADDRESS	DATE	PHONE
RESPONSIBLE PERSON IN CHARGE OF WORK, TITLE		DATE	PHONE

R2



General Building Permit Application

2012-05-3137 - DRG

If you or the property owner owes real estate or personal property taxes or user charges on any property within the City, payment arrangements must be made before permits of any kind are accepted.

Location/Address of Construction: <u>42 Sumac St Portland Me 04103</u>		
Total Square Footage of Proposed Structure/Area	Square Footage of Lot	Number of Stories
Tax Assessor's Chart, Block & Lot Chart# Block# Lot# <u>378 A025</u>	Applicant: (must be owner, lessee or buyer) Name <u>Sylvia Coombs</u> Address <u>42 Sumac St</u> City, State & Zip <u>Portland Me 04103</u>	Telephone: <u>767-3127</u> <u>4000</u>
Lessee/DBA RECEIVED MAY 07 2012 Dept of Building Inspections City of Portland Maine	Owner: (if different from applicant) Name Address City, State & Zip	Cost of Work: \$ <u>3781.00</u> C of O Fee: \$ _____ Historic Review: \$ _____ Planning Amin.: \$ _____ Total Fee: \$ <u>601.00</u>
Dept of Building Inspections City of Portland Maine Can legal use (i.e. single family) <input checked="" type="checkbox"/> Number of Residential Units _____ If vacant, what was the previous use? _____ Proposed Specific use: <u>Storage</u> Is property part of a subdivision? <u>NO</u> If yes, please name _____ Project description: <u>Build 8x8 shed pt Deck on crushed stone & cinder blocks 6 walls</u> <u>Approx 5/12 pitch Roughcut shiplap siding.</u>		
Contractor's name: <u>SES Services</u>		Email: _____
Address: <u>284 Elm St</u>		
City, State & Zip: <u>Limerick Me 04048</u>		Telephone: _____
Who should we contact when the permit is ready: <u>Scott</u>		Telephone: <u>615-3554</u>
Mailing address: <u>Same</u>		

Please submit all of the information outlined on the applicable checklist. Failure to do so will result in the automatic denial of your permit.

In order to be sure the City fully understands the full scope of the project, the Planning and Development Department may request additional information prior to the issuance of a permit. For further information or to download copies of this form and other applications visit the Inspections Division on-line at www.portlandmaine.gov, or stop by the Inspections Division office, room 315 City Hall or call 874-8703.

and I hereby certify that I am the Owner of record of the named property, or that the owner of record authorizes the proposed work and that I have been authorized by the owner to make this application as his/her authorized agent. I agree to conform to all applicable laws of this jurisdiction. In addition, if a permit for work described in this application is issued, I certify that the Code Official's authorized representative shall have the authority to enter all areas covered by this permit at any reasonable hour to enforce the provisions of the codes applicable to this permit.

Signature: [Signature] Date: 5-7-12

This is not a permit; you may not commence ANY work until the permit is issued

Sylvia Coombs
42 Sumac St
Portland Me.

Contractor
SES Services
284 Elm St
Limerick Me 04048
615-3354



New shed 8x8 = 64sq'
Same as old

R-2

lot size - 10023 sq'

detached accessory structure ≤ 144 sq'

5' rear setback - 6' min (OP)

5' side setback - 6' min (OP)

lot coverage - 20% = 2004.6 sq'

existing house = 1211

64
1275 (OP)

Back yard



150.58'

Fence

155.7'

House

Garage

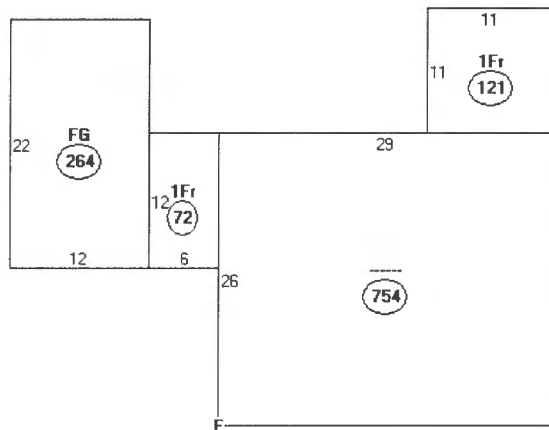

Descriptor/Area

- A: ---
754 sqft
- B: 1Fr
72 sqft
- C: FG
264 sqft
- D: 1Fr
121 sqft
- ~~E: RPA
66 sqft~~
- ~~F: BS
6 sqft~~

= 1211 φ



PORTLAND MAINE

Strengthening a Remarkable City, Building a Community for Life • www.portlandmaine.gov

Receipts Details:

Tender Information: Cash

Tender Amount: 60.00

Receipt Header:

Cashier Id: bsaucier

Receipt Date: 5/7/2012

Receipt Number: 43671

Receipt Details:

Referance ID:	6432	Fee Type:	BP-Constr
Receipt Number:	0	Payment Date:	
Transaction Amount:	60.00	Charge Amount:	60.00
Job ID: Job ID: 2012-05-3937-DRG - Build an 8 X 8 Shed			
Additional Comments: 42 Sumac			

Thank You for your Payment!