

**City of Portland, Maine – Building or Use Permit Application** 389 Congress Street, 04101, Tel: (207) 874-8703, FAX: 874-8716

Location of Construction: 128 Summit St. 04103		Owner: * Eleanor Beal		Phone: 797-3013		Permit No: <b>991257</b>	
Owner Address: *128 Summit St. 04103		Lessee/Buyer's Name:		Phone:		BusinessName:	
Contractor Name:		Address: 184 Summit St. 04103		Phone:		Permit Issued: NOV 12 1999 CITY OF PORTLAND	
Past Use: Single Family		Proposed Use: Same		COST OF WORK: \$ 900.00		PERMIT FEE: \$ 30.00	
				FIRE DEPT. <input type="checkbox"/> Approved <input type="checkbox"/> Denied		INSPECTION: Use Group: Type:	
				Signature:		Signature:	
Proposed Project Description: Tear down an 8x10 shed (shed is located at 112 Summit st.)				PEDESTRIAN ACTIVITIES DISTRICT (P.A.D.) Action: Approved <input type="checkbox"/> Approved with Conditions: <input type="checkbox"/> Denied <input type="checkbox"/>			
Permit Taken By: UB		Date Applied For: GD November 8, 1999					

Zone: CBL: 378-A-001

Zoning Approval:

**Special Zone or Reviews:**

Shoreland  
 Wetland  
 Flood Zone  
 Subdivision  
 Site Plan maj  minor  mm

**Zoning Appeal**

Variance  
 Miscellaneous  
 Conditional Use  
 Interpretation  
 Approved  
 Denied

**Historic Preservation**

Not in District or Landmark  
 Does Not Require Review  
 Requires Review

**Action:**

Appoved  
 Approved with Conditions  
 Denied

Date: \_\_\_\_\_

- This permit application does not preclude the Applicant(s) from meeting applicable State and Federal rules.
- Building permits do not include plumbing, septic or electrical work.
- Building permits are void if work is not started within six (6) months of the date of issuance. False information may invalidate a building permit and stop all work..

**CERTIFICATION**

I hereby certify that I am the owner of record of the named property, or that the proposed work is authorized by the owner of record and that I have been authorized by the owner to make this application as his authorized agent and I agree to conform to all applicable laws of this jurisdiction. In addition, if a permit for work described in the application is issued, I certify that the code official's authorized representative shall have the authority to enter all areas covered by such permit at any reasonable hour to enforce the provisions of the code(s) applicable to such permit

November 9, 1999

SIGNATURE OF APPLICANT \_\_\_\_\_ ADDRESS: \_\_\_\_\_ DATE: \_\_\_\_\_ PHONE: \_\_\_\_\_

RESPONSIBLE PERSON IN CHARGE OF WORK, TITLE \_\_\_\_\_ PHONE: \_\_\_\_\_

CEO DISTRICT 2

COMMENTS

1-7-00- checked site shed has been torn down Close Permit JIL

Inspection Record

Type	Date
Foundation: _____	_____
Framing: _____	_____
Plumbing: _____	_____
Final: _____	_____
Other: _____	_____

**City of Portland  
Inspection Services Division  
Demolition Call List**

Site Address: 112 Summit St Owner: Eleanor Zief  
 Structure Type: Shed 8x10 Contractor: Don Ray

<u>UTILITY APPROVALS</u>	<u>NUMBER</u>	<u>CONTACT NAME/DATE</u>
Central Maine Power	1-800-750-4000	
NYNEX	878-7000	N/A
Northern Utilities	797-8002 X6241	N/A
Portland Water District	761-8310	N/A
Public Cable Co.	775-3431 X257	N/A
Dig Safe***	1-888-344-7233	N/A

\*\*\*(After call, there is a wait of 72 bus hrs before digging can begin)

<u>CITY APPROVALS</u>	<u>NUMBER</u>	<u>CONTACT NAME/DATE</u>
DPW/Sewer Division(J.DiPaolo)	874-8300 X8467	N/A
DPW/Traffic Division(K.Doughty)	874-8300 X8437	N/A
DPW/Forestry Division(J.Tarling)	874-8300 X8389	N/A
DPW/Sealed Drain Permit(C.Merritt)	874-8300 X8822	N/A
Building Inspections(insp required)	874-8300 X8703	N/A
Historic Preservation	874-8300 X8726	N/A
Fire Dispatcher	874-8300 X8676	N/A

Written Notice to Adjoining Owners

<u>ASBESTOS</u>	<u>NUMBER</u>	<u>CONTACT NAME/DATE</u>
DEP - Environmental (Augusta)	287-2651 (Ed Antz)	

U.S. EPA Region 1 - No phone call required. Just mail copy of State notification to:

Demo/Reno Clerk  
 US EPA Region I (SEA)  
 JFK Federal Building  
 Boston, MA 02203

*non-applicable*

I have contacted all of the necessary companies/departments as indicated above.

SIGNED: [Signature] DATE: 11-9-99

*#pictures not needed per main request*

**THIS IS NOT A PERMIT/CONSTRUCTION CANNOT COMMENCE UNTIL THE PERMIT IS ISSUED**

**Building or Use Permit Pre-Application  
Additions/Alterations/Accessory Structures  
To Detached Single Family Dwelling**

In the interest of processing your application in the quickest possible manner, please complete the Information below for a Building or Use Permit.

**NOTE\*\*If you or the property owner owes real estate or personal property taxes or user charges on any property within the City, payment arrangements must be made before permits of any kind are accepted.**

Location/Address of Construction: <del>X 126</del> Summit St. Portland, ME 04103 X 126		
Tax Assessor's Chart, Block & Lot Number Chart# 378 Block# A Lot# 001	Owner: X Eleanor Beal	Telephone#: 797-4013
Owner's Address: X 126 Summit St	Lessee/Buyer's Name (If Applicable)	Cost Of Work: \$ 900.00 Fee \$ 38
Proposed Project Description:(Please be as specific as possible) Tear down shed. No rebuilding. 8x10 shed behind 112 Summit St		
Contractor's Name, Address & Telephone 184 Summit St Portland ME, 04103		Rec'd By: WBS

Separate permits are required for Internal & External Plumbing, HVAC and Electrical installation.

- All construction must be conducted in compliance with the 1996 B.O.C.A. Building Code as amended by Section 6-Art II.
- All plumbing must be conducted in compliance with the State of Maine Plumbing Code.
- All Electrical Installation must comply with the 1996 National Electrical Code as amended by Section 6-Art III.
- HVAC(Heating, Ventilation and Air Conditioning) installation must comply with the 1993 BOCA Mechanical Code.

You must Include the following with you application:

- 1) A Copy of Your Deed or Purchase and Sale Agreement
- 2) A Copy of your Construction Contract, if available
- 3) A Plot Plan (Sample Attached)

If there is expansion to the structure, a complete plot plan (Site Plan) must include:

- The shape and dimension of the lot, all existing buildings (if any), the proposed structure and the distance from the actual property lines. Structures include decks porches, a bow windows cantilever sections and roof overhangs, as well as, sheds, pools, garages and any other accessory structures.
- Scale and required zoning district setbacks

**4) Building Plans (Sample Attached)**

A complete set of construction drawings showing all of the following elements of construction:

- Cross Sections w/Framing details (including porches, decks w/ railings, and accessory structures)
- Floor Plans & Elevations
- Window and door schedules
- Foundation plans with required drainage and dampproofing
- Electrical and plumbing layout. Mechanical drawings for any specialized equipment such as furnaces, chimneys, gas equipment, HVAC equipment (air handling) or other types of work that may require special review must be included.

**Certification**

I hereby certify that I am the Owner of record of the named property, or that the proposed work is authorized by the owner of record and that I have been authorized by the owner to make this application as his/her authorized agent. I agree to conform to all applicable laws of this jurisdiction. In addition, if a permit for work described in this application is issued, I certify that the Code Official's authorized representative shall have the authority to enter all areas covered by this permit at any reasonable hour to enforce the provisions of the codes applicable to this permit.

Signature of applicant: <i>Donald Law</i>	Date: 11-9-99
---	---------------

Building Permit Fee: \$30.00 for the 1st \$1000.cost plus \$6.00 per \$1,000.00 construction cost thereafter.

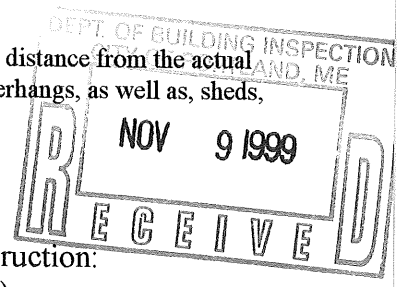

Inspection Services  
Michael J. Nugent  
Manager



Department of Urban Development  
Joseph E. Gray, Jr.  
Director

**CITY OF PORTLAND**

*Congratulations!!!!!!*

**Building or Use Permit Application  
Additions/Alterations/Accessory Structures  
To Detached Single Family Dwelling**

As an applicant for a building permit, you are about to enter into a relationship with our Office. We welcome any questions, comments or suggestions that will make the process more efficient. Attached you will find an application and some samples of the submissions you will provide at application time. Please read **ALL** of the information and if you need any further assistance please call 874-8703 or 874-8693.

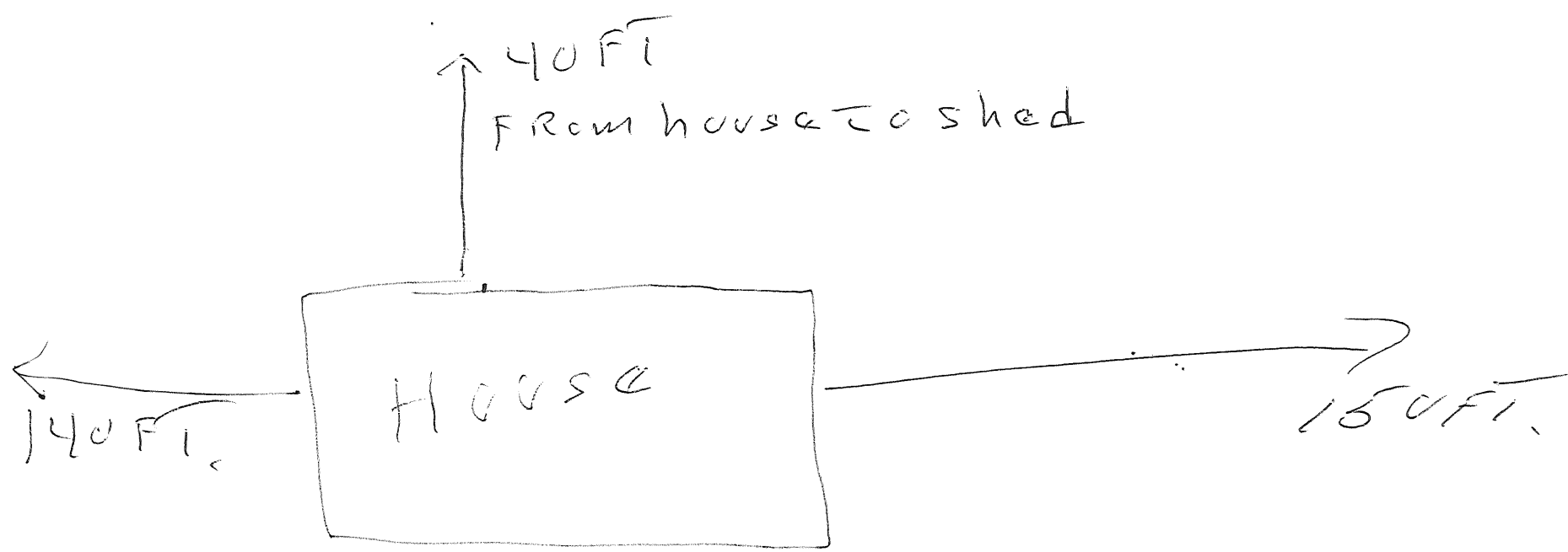
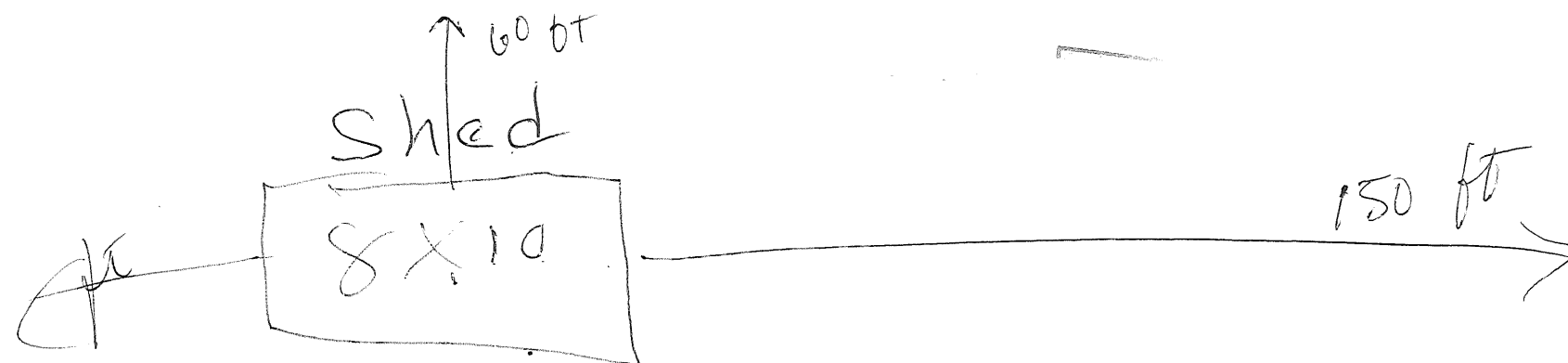

---

112 Summit St.