

**PINKHAM & GREER**  
CIVIL ENGINEERS  
28 WANAHA AVE., PORTLAND, ME. 04103  
TEL: 207.761.5242 FAX: 207.781.4245

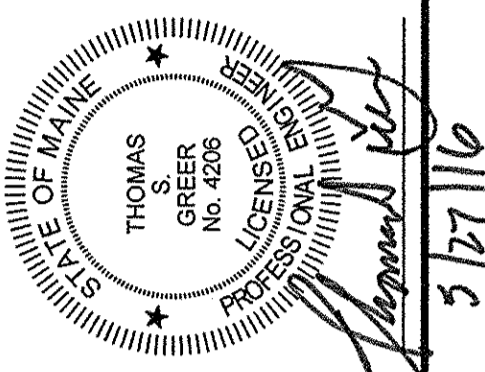

REV.	DATE	DESCRIPTION
1	5/5/16	REV'D PER STAFF COMMENTS
2	5/12/16	REV'D PER STAFF REVIEW
3	5/19/16	ADDED NOTE 4
4	5/27/16	REV'D WALK & PARKING SPACES

ALLEN AVENUE UNITARIAN  
UNIVERSALIST CHURCH  
524 ALLEN AVE., PORTLAND MAINE

SCALE: AS SHOWN  
DATE: APRIL 5, 2016  
PROJECT: 14135

DRN BY: JDC  
DESIGN BY: [Signature]  
CHK BY: [Signature]

PARKING LOT IMPROVEMENTS  
524 ALLEN AVENUE, PORTLAND

**SITE PLAN**

C1.2

MAPLOT: 377 / F / 029

**LEGEND**

EXISTING	PROPOSED
[Symbol]	[Symbol] SLOPED BITUMINOUS CURB
[Symbol]	[Symbol] VERTICAL BITUMINOUS CURB
[Symbol]	[Symbol] PROPERTY LINE
[Symbol]	[Symbol] ABUTTERS PROPERTY EASEMENT
[Symbol]	[Symbol] EDGE OF PAVEMENT
[Symbol]	[Symbol] CONTOURS
[Symbol]	[Symbol] GAS LINE
[Symbol]	[Symbol] SANITARY SEWER
[Symbol]	[Symbol] STORM DRAIN
[Symbol]	[Symbol] UNDERGROUND CONDUIT
[Symbol]	[Symbol] UNDERDRAIN
[Symbol]	[Symbol] CENTERLINE
[Symbol]	[Symbol] HEADWALL
[Symbol]	[Symbol] SPOT GRADE
[Symbol]	[Symbol] CATCH BASIN
[Symbol]	[Symbol] SIGN
[Symbol]	[Symbol] SURFACE DRAINAGE
[Symbol]	[Symbol] RIFRAP
[Symbol]	[Symbol] BITUMINOUS PAVEMENT TYPE 1
[Symbol]	[Symbol] BITUMINOUS PAVEMENT TYPE 2
[Symbol]	[Symbol] BITUMINOUS PAVEMENT TYPE 3
[Symbol]	[Symbol] BUILDING HATCH
[Symbol]	[Symbol] VEGETATION TO BE REMOVED
[Symbol]	[Symbol] SNOW STORAGE AREAS

**EROSION CONTROL LEGEND**

[Symbol]	CATCH BASIN PROTECTION WITH HAYBALES
[Symbol]	EROSION CONTROL BERM
[Symbol]	RIFRAP
[Symbol]	STABILIZED ENTRANCE

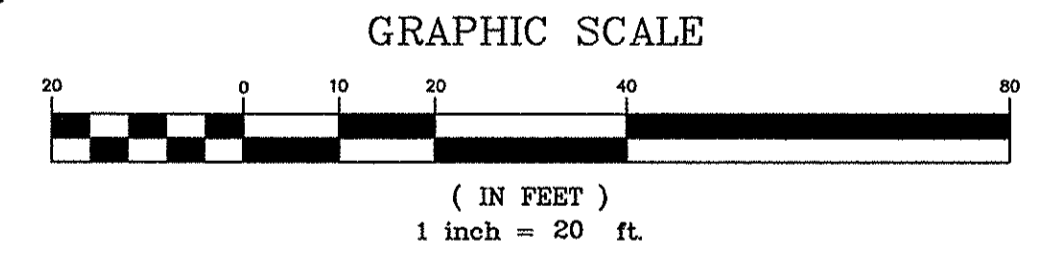

**SITE PLAN - OPTION 2**  
SCALE: 1"=20'

- NOTES**
1. THIS OPTION HAS A REDUCTION IN THE AMOUNT OF IMPERVIOUS AREA FROM THE EXISTING CONDITION OF 43 SQUARE FEET.
  2. TESTPIT REQUIRED TO VERIFY SIZE OF EXISTING SEWER FORCEMAIN. REPLACE WITH THE SAME SIZE.
  3. PLANTINGS TO BE BY OWNER CONTRACTOR TO LOAM AND SEED ALL AREAS DAMAGED BY CONSTRUCTION.
  4. FOR ALL GRAVEL TO GRASS AREAS THE CONTRACTOR IS TO EITHER REMOVE THE GRAVEL AND SCARIFY THE SURFACE BEFORE PLACING 4" OF TOPSOIL OR SCARIFY THE SURFACE AND PLACE 6" OF TOPSOIL.

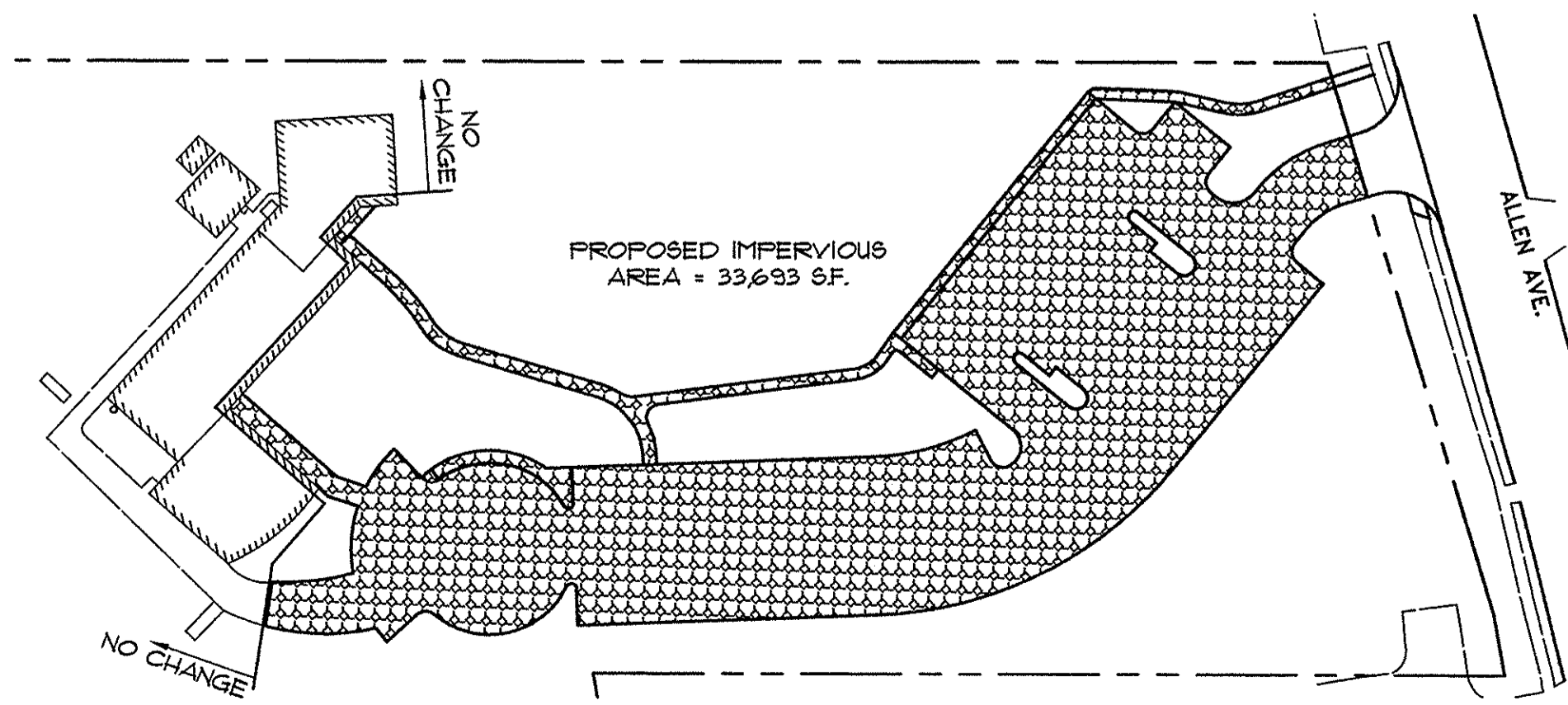
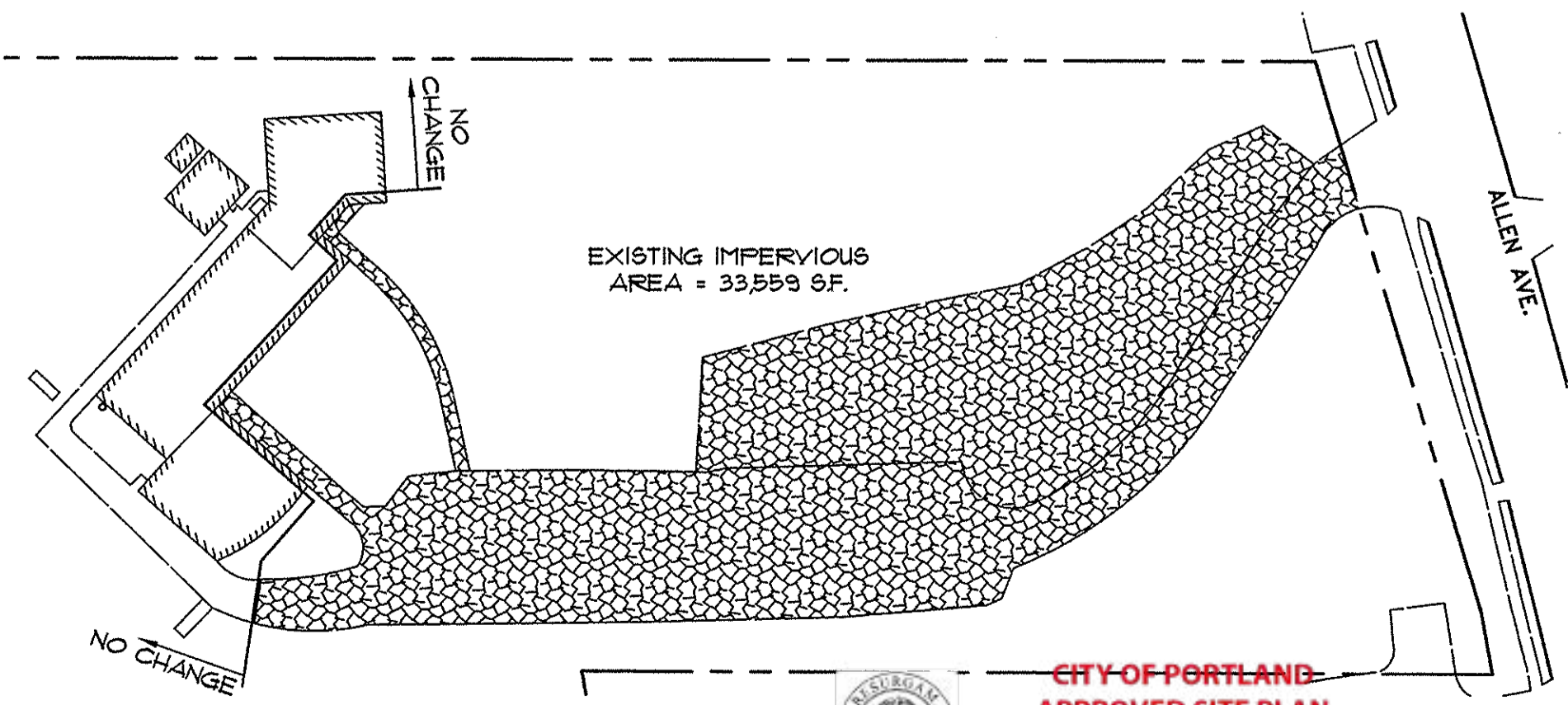

CITY OF PORTLAND  
APPROVED SITE PLAN  
[Signature]  
DATE OF APPROVAL: 6-3-2016  
PLANNER: Jean Fraser  
PROJECT NO.: #2016-077

**IMPERVIOUS SURFACE-PROPOSED**  
SCALE: 1"=20'