

PINKHAM & GREER
CIVIL ENGINEERS

28 WAWANACONNE AVENUE, PORTLAND, ME 04103
TEL: 207.781.5242 FAX: 207.781.4245

THOMAS S. GREER
REGISTERED PROFESSIONAL ENGINEER
LICENSE NO. 10225
STATE OF MAINE

3/27/16

REV.	DATE	DESCRIPTION
1	5/5/16	REV'D PER STAFF COMMENTS
2	5/12/16	REV'D PER STAFF REVIEW
3	5/19/16	ADDED NOTE 4.
4	5/27/16	REV'D WALK & PARKING SPACES

ALLEN AVENUE UNITARIAN
UNIVERSALIST CHURCH
524 ALLEN AVENUE, PORTLAND MAINE

SCALE: AS SHOWN
DATE: APRIL 5, 2016
PROJECT: 141296

DRN BY: JDC
DESIGN BY: [Signature]
CHK BY: [Signature]

LEGEND

EXISTING	PROPOSED
--- PROPERTY LINE	--- SLOPED BITUMINOUS CURB
--- ABUTTERS PROPERTY	--- VERTICAL BITUMINOUS CURB
--- EASEMENT	--- CONTOURS
--- EDGE OF PAVEMENT	--- CLEARING LIMIT
--- CONTOURS	--- GAS LINE
--- BUILDING	--- SANITARY SEWER
--- EDGE OF GRAVEL	--- STORMDRAIN
--- CURB	--- UNDERGROUND CONDUIT
--- WETLAND LIMIT	--- UNDERDRAIN
--- WETLAND	--- CENTERLINE
--- WATERCOURSE	--- HEADWALL
--- SANITARY SEWER	--- SPOT GRADE
--- STORMDRAIN	--- CATCH BASIN
--- OVERHEAD UTILITY	--- SIGN
--- SPOT GRADE	--- SURFACE DRAINAGE
--- WATER VALVE PIT	--- RIFRAP
--- UTILITY POLE	--- BITUMINOUS PAVEMENT TYPE 1
--- TREE	--- BITUMINOUS PAVEMENT TYPE 2
--- TREELINE	--- BITUMINOUS PAVEMENT TYPE 3
	--- BUILDING HATCH
	--- VEGETATION TO BE REMOVED
	--- SNOW STORAGE AREAS
	EROSION CONTROL LEGEND
	--- CATCH BASIN PROTECTION WITH HAYBALES
	--- EROSION CONTROL BERM
	--- RIFRAP
	--- STABILIZED ENTRANCE

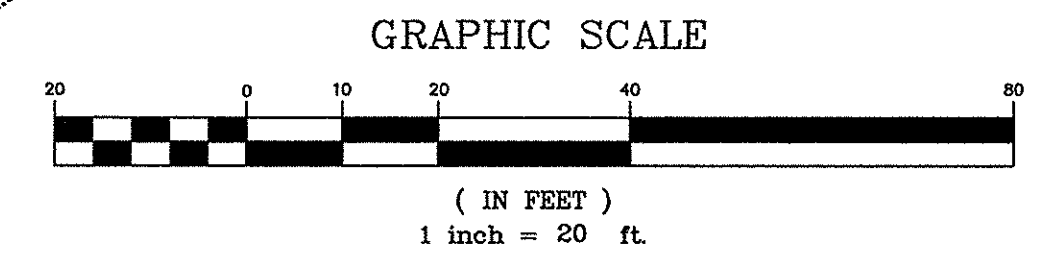

SITE PLAN - OPTION 2
SCALE: 1"=20'

- NOTES**
1. THIS OPTION HAS A REDUCTION IN THE AMOUNT OF IMPERVIOUS AREA FROM THE EXISTING CONDITION OF 43 SQUARE FEET.
 2. TESTPIT REQUIRED TO VERIFY SIZE OF EXISTING SEWER FORCEMAIN. REPLACE WITH THE SAME SIZE.
 3. PLANTINGS TO BE BY OWNER CONTRACTOR TO LOAM AND SEED ALL AREAS DAMAGED BY CONSTRUCTION.
 4. FOR ALL GRAVEL TO GRASS AREAS THE CONTRACTOR IS TO EITHER REMOVE THE GRAVEL AND SCARIFY THE SURFACE BEFORE PLACING 4" OF TOPSOIL OR SCARIFY THE SURFACE AND PLACE 6" OF TOPSOIL.

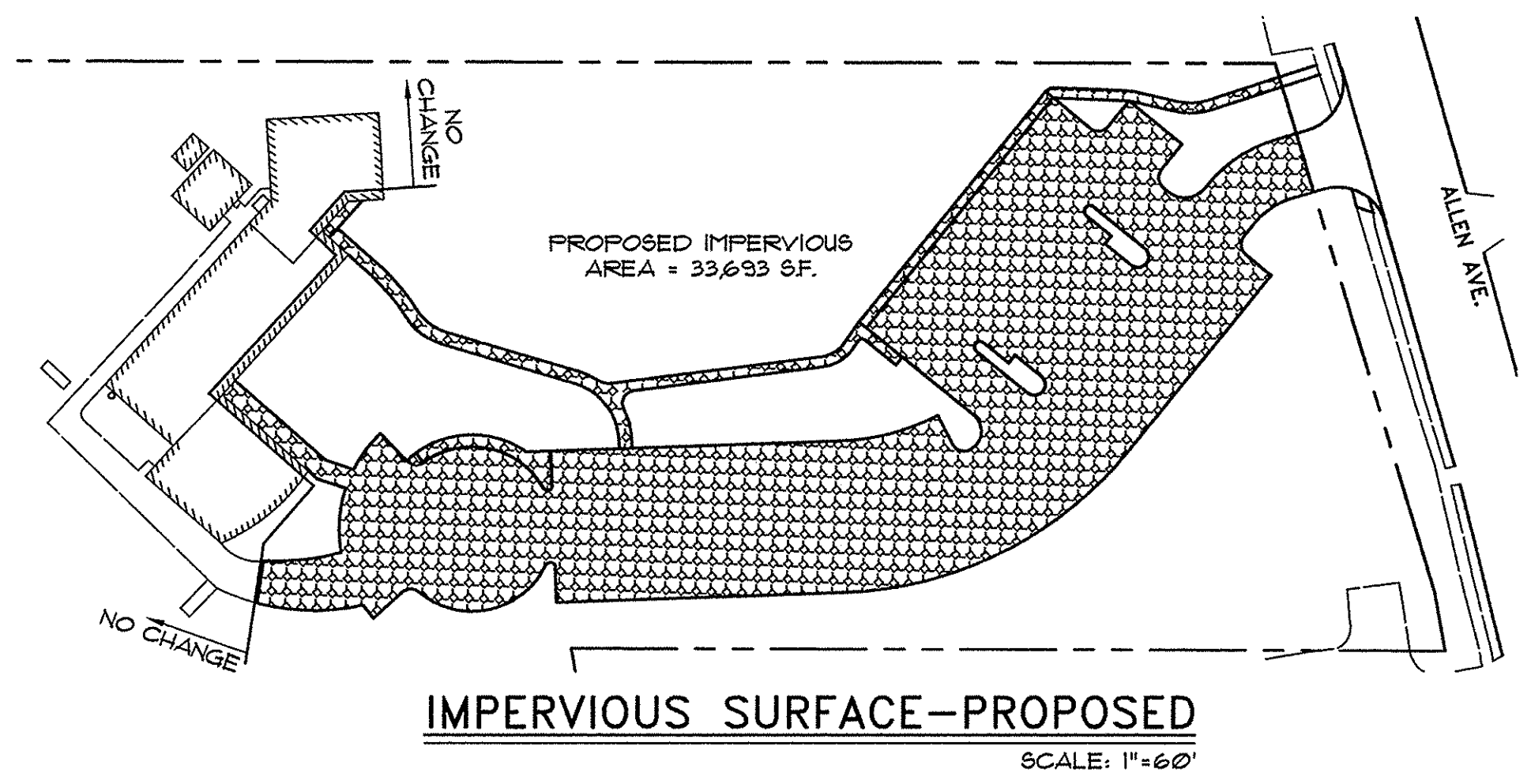
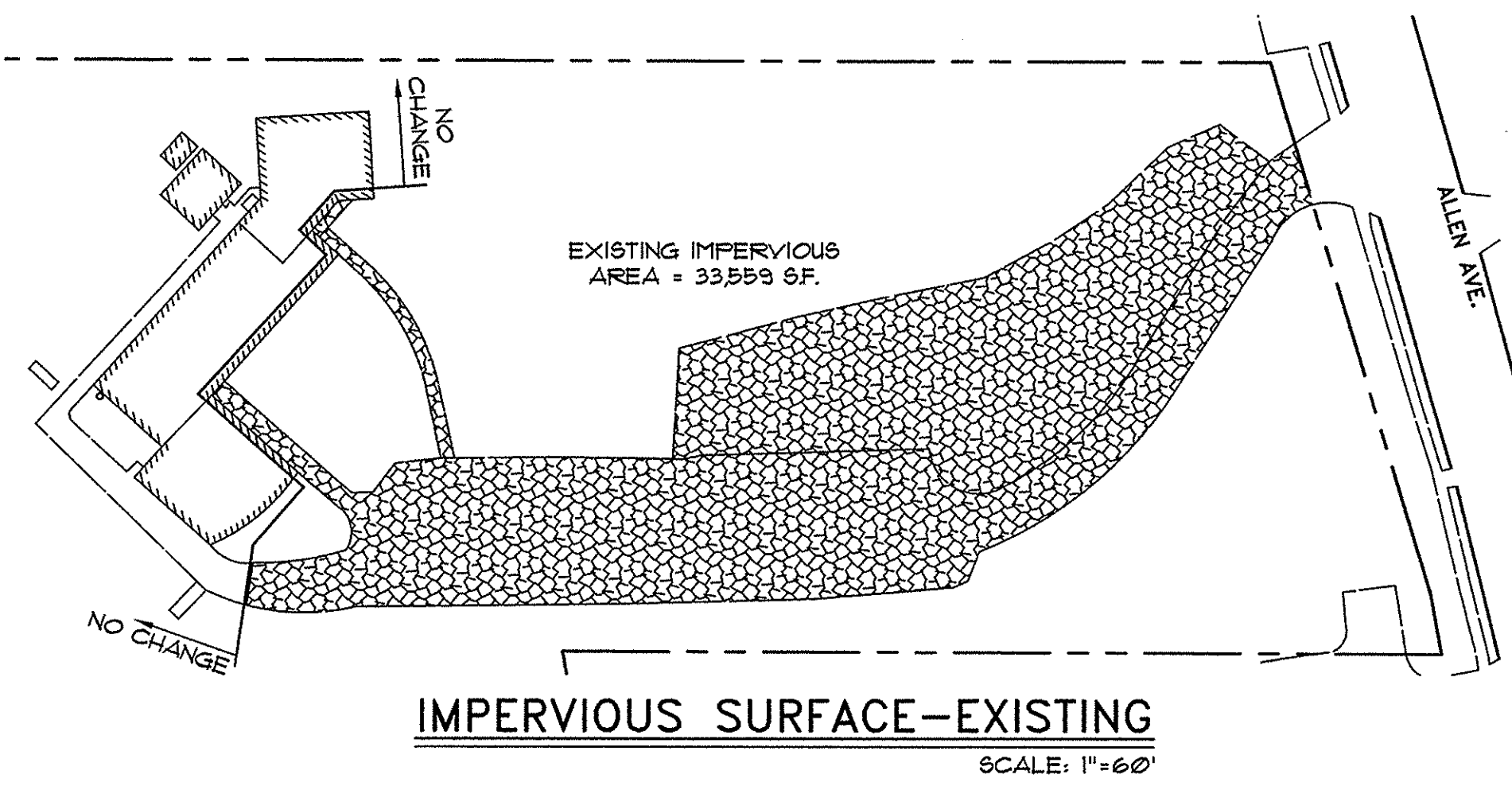

PARKING LOT IMPROVEMENTS
524 ALLEN AVENUE, PORTLAND

C1.2

MAPLOT 377/F/029