



©2011 STARBUCKS COFFEE COMPANY

**STARBUCKS COFFEE COMPANY**  
 2401 UTAH AVENUE SOUTH  
 SEATTLE, WASHINGTON 98134  
 (206) 318-1575

THESE DRAWINGS AND SPECIFICATIONS ARE CONFIDENTIAL AND SHALL REMAIN THE SOLE PROPERTY OF STARBUCKS CORPORATION, WHICH IS THE OWNER OF THE COPYRIGHT IN THIS WORK. THEY SHALL NOT BE REPRODUCED (IN WHOLE OR IN PART), SHARED WITH THIRD PARTIES OR USED IN ANY MANNER ON OTHER PROJECTS OR EXTENSIONS TO THIS PROJECT WITHOUT THE PRIOR WRITTEN CONSENT OF STARBUCKS CORPORATION. THESE DRAWINGS AND SPECIFICATIONS ARE INTENDED TO EXPRESS DESIGN INTENT FOR A PROTOTYPICAL STARBUCKS STORE (WHICH IS SUBJECT TO CHANGE AT ANY TIME) AND DO NOT REFLECT ACTUAL SITE CONDITIONS. NEITHER PARTY SHALL HAVE ANY OBLIGATION NOR LIABILITY TO THE OTHER (EXCEPT STATED ABOVE) UNTIL A WRITTEN AGREEMENT IS FULLY EXECUTED BY BOTH PARTIES.

**T | P | G**  
 ARCHITECTURE  
**TPG Architecture, LLP**  
 360 Park Avenue, South, New York, New York 10010  
 212 768 0800 212 768 1597 fax  
 www.tpgarchitecture.com

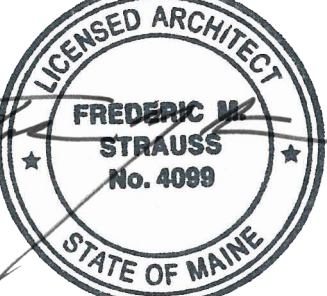
Frederic M. Strauss  
  
 ME License No. 4099  
 Architect of Record

Revision Schedule			
Rev	Date	By	Description

PROJECT NAME:  
**NORTHGATE PLAZA**  
 PROJECT ADDRESS:  
**91 AUBURN STREET,  
 PORTLAND ME 04103**

STORE #: 2830  
 PROJECT #: 22764-021  
 CONCEPT:  
 PALETTE:  
 ISSUE DATE: 12/19/2013  
 DESIGN MANAGER: Eta Kliger  
 LEED® AP:  
 PRODUCTION DESIGNER: AH  
 CHECKED BY: Allison Stadnyck

SHEET TITLE:  
**LIFE SAFETY PLAN**

SCALE: 1/4" = 1'-0"

SHEET NUMBER:  
**G-0003**

**EXIT DIRECTION SIGN LEGEND:**

CODE#	SYMBOL	FACE DESCRIPTION
(E)		EXIT

- NOTES:**
1. Indicates Inscription, Arrows and Single or Double Faced as Shown. Shaded Quadrants indicate direction of Lighted Faces.
  2. All Exit Signs Shall Comply with Local Rules and Ordinances and Meet OSHA Requirements.
  3. GC Shall Verify Type of Mounting with Construction Manager for All Exit Signs Prior to Ordering.

**LEGEND:**

- Travel Distance- Path A  
60' - 0"
- Travel Distance- Path B  
54' - 5"
- Existing Exit Light  
(See Reflected Ceiling Plan)
- Fire Strobe
- Emergency Light
- ADA  
Clear Floor Space for Accessibility

**FLAME SPREAD RATING:**

Flame spread rating for all proposed interior finishes shall comply with local building code.

**INTERIOR FINISH NOTES:**

1. Interior wall and ceiling finish materials shall be Chase C with a flame spread rating less than 200 and smoke developed less than 450.
2. Floor Coverings in the exit path of all common areas shall meet Class A requirements.

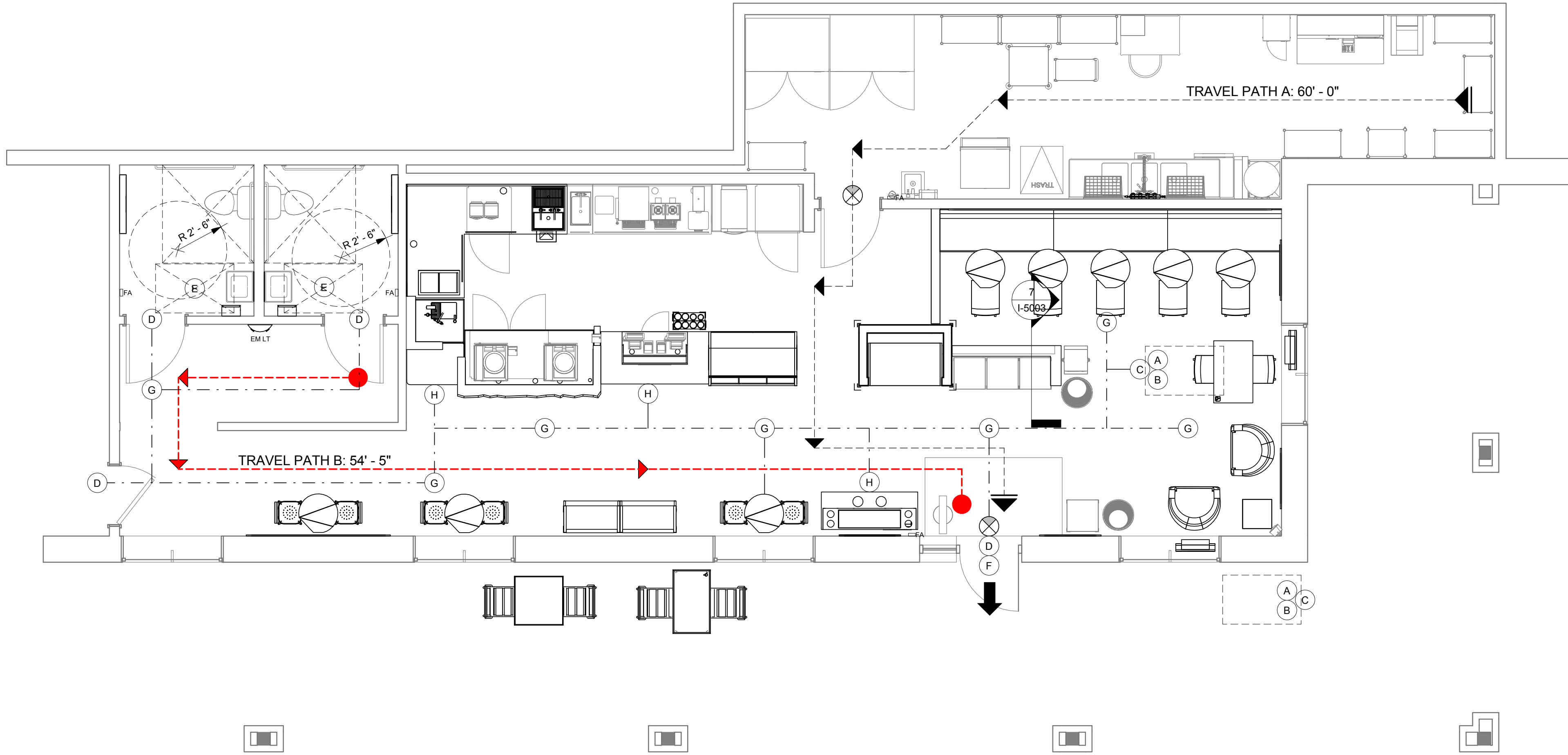

**1 LIFE SAFETY PLAN**  
 Scale: 1/4" = 1'-0"

