

GENERAL DEMOLITION NOTES

1. ALL ELECTRICAL WORK FOR THE PROJECT TO COMPLY WITH THE ELECTRICAL CODE AS OUTLINED IN THE "BUILDING ANALYSIS" CODE DATA, INCLUDING BUT NOT LIMITED TO NEW WIRING INTO EXISTING PANELS.
2. G.C. AND PROJECT MANAGER TO VERIFY ALL PROPOSED WORK AND MEASUREMENTS PRIOR TO CONSTRUCTION AND/OR DEMOLITION.
3. G.C. SHALL BE RESPONSIBLE TO REMOVE FLOOR FINISHES AS INDICATED TO BARE SLAB AND TO LEVEL/PREP SLAB AS REQUIRED FOR NEW FINISHES.
4. HAZARDOUS MATERIALS SHALL BE REMOVED PRIOR TO EXECUTION OF DEMOLITION CONTRACT. IF HAZARDOUS MATERIALS ARE ENCOUNTERED, DO NOT DISTURB; IMMEDIATELY NOTIFY ARCHITECT AND GENERAL CONTRACTOR. MATERIALS WILL BE REMOVED UNDER A SEPARATE CONTRACT.
5. CONTRACTOR IS TO SCHEDULE HIGH NOISE WORK WITH OWNER IN ORDER TO AVOID DISRUPTION DURING BUSINESS HOURS.
6. ALL ELECTRICAL COMPONENTS REMOVED DURING DEMOLITION MUST BE CAPPED AND TAGGED IF NO LONGER USED IN REMODELED STORE LAYOUT. VERIFY ALL ELECTRICAL ITEMS TO BE DEMOLISHED WITH PROJECT MANAGER.
7. ANY PLUMBING FIXTURES REMOVED DURING DEMOLITION MUST BE PROPERLY CAPPED IF NO LONGER USED IN REMODELED STORE LAYOUT. CAPPING OF DRAINS AND SUPPLY LINES SHALL BE MADE BELOW THE FINISHED SURFACE. VERIFY ALL PLUMBING ITEMS TO DEMOLISHED WITH PROJECT MANAGER.

DEMOLITION LEGEND

- WALL TO REMAIN
- VALANCE TO REMAIN
- FLOOR FINISH TO BE REMOVED

NOTE:
ELECTRICIAN SHALL RE-USE EXISTING PHOTO LAB CIRCUITING TO PROPPOSED EQUIPMENT, ELECTRICIAN TO COORDINATE WITH CVS PROVIDED CUT SHEETS.

NOTE:
ELECTRICIAN SHALL RE-USE EXISTING LIGHTING CIRCUITS AND CONNECT RELOCATED AND NEW LIGHT FIXTURES AS REQUIRED.

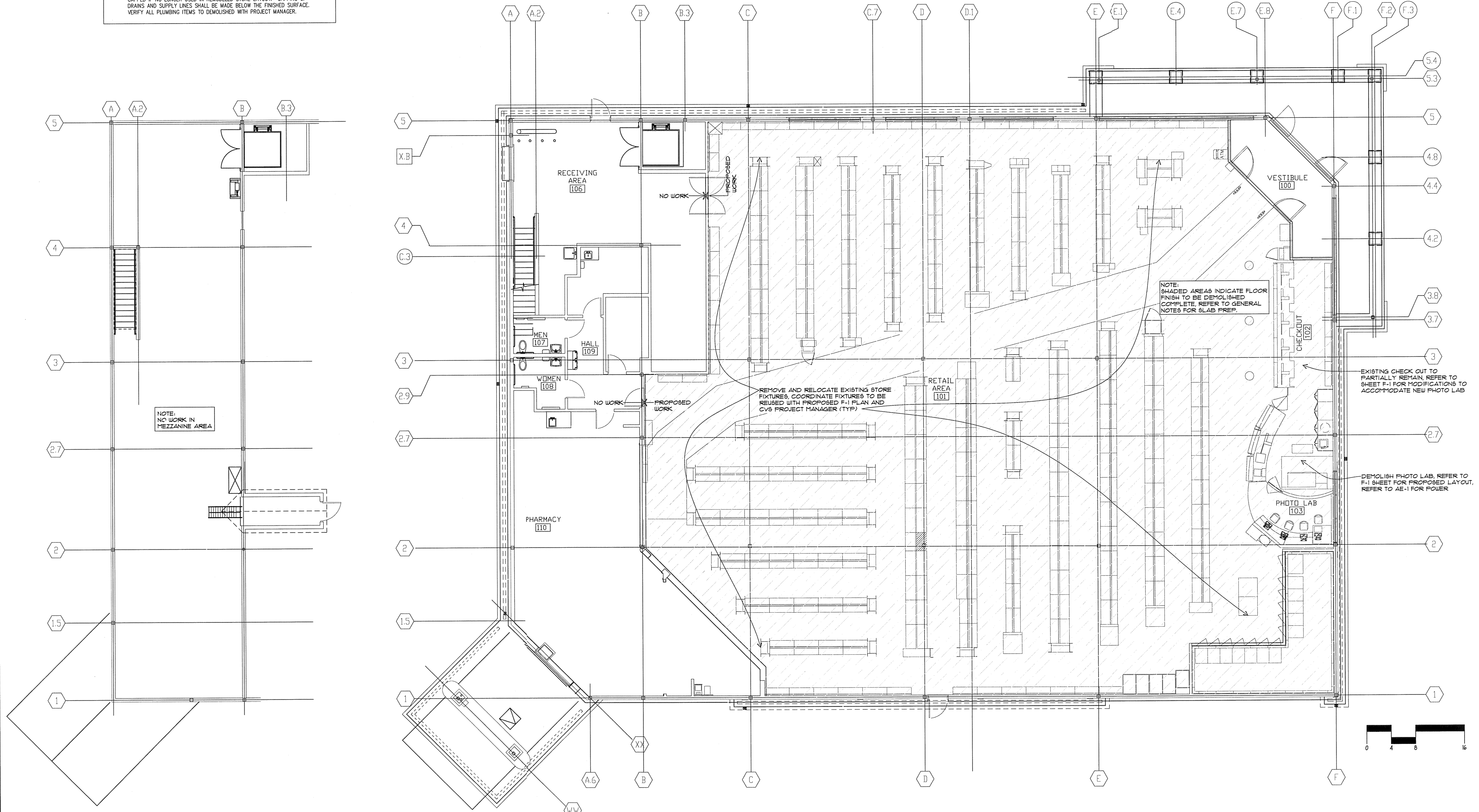

User = Auto Plot
 Date = Friday, August 02, 2013 1:57:29 PM
 Filename = \\WDPartners.com\Global\CVS\CVSB10003\Arch_Eng\Design\Arch_CVS-S01F_Scope_E-F-1_plans\Site Specific\0329 PORTLAND ME_CD_Set\AD-1.dwg