

DISPLAY THIS CARD ON PRINCIPAL FRONTAGE OF WORK



CITY OF PORTLAND

BUILDING PERMIT

This is to certify that ERIN E LANE

Located At 39 SANBORN ST

Job ID: 2012-10-5152-HVAC

CBL: 375- B-001-001

has permission to 2 - 120 gallon Propane Tank

provided that the person or persons, firm or corporation accepting this permit shall comply with all of the provisions of the Statues of Maine and of the Ordinances of the City of Portland regulating the construction, maintenance and use of the buildings and structures, and of the application on file in the department.

Notification of inspection and written permission procured before this building or part thereof is lathed or otherwise closed-in. 48 HOUR NOTICE IS REQUIRED.

A final inspection must be completed by owner before this building or part thereof is occupied. If a certificate of occupancy is required, it must be

Fire Prevention Officer



Code Enforcement Officer / Plan Reviewer

10/17/2012

**THIS CARD MUST BE POSTED ON THE STREET SIDE OF THE PROPERTY
PENALTY FOR REMOVING THIS CARD**

BUILDING PERMIT INSPECTION PROCEDURES

Please call 874-8703 or 874-8693 (ONLY)

or email: buildinginspections@portlandmaine.gov

With the issuance of this permit, the owner, builder or their designee is required to provide adequate notice to the city of Portland Inspections Services for the following inspections. Appointments must be requested 48 to 72 hours in advance of the required inspection. The inspection date will need to be confirmed by this office.

- **Please read the conditions of approval that is attached to this permit!! Contact this office if you have any questions.**
- **Permits expire in 6 months. If the project is not started or ceases for 6 months.**
- **If the inspection requirements are not followed as stated below additional fees may be incurred due to the issuance of a "Stop Work Order" and subsequent release to continue.**

Final Inspection

The project cannot move to the next phase prior to the required inspection and approval to continue, REGARDLESS OF THE NOTICE OF CIRCUMSTANCES.

IF THE PERMIT REQUIRES A CERTIFICATE OF OCCUPANCY, IT MUST BE PAID FOR AND ISSUED TO THE OWNER OR DESIGNEE BEFORE THE SPACE MAY BE OCCUPIED.



PORTLAND MAINE

Strengthening a Remarkable City, Building a Community for Life • www.portlandmaine.gov

Director of Planning and Urban Development
Jeff Levine

Job ID: 2012-10-5152-HVAC

Located At: 39 SANBORN ST

CBL: 375- B-001-001

Conditions of Approval:

Building

The installation must comply with the State of Maine gas regulations.

City of Portland, Maine - Building or Use Permit Application

389 Congress Street, 04101 Tel: (207) 874-8703, FAX: (207) 8716

Job No: 2012-10-5152-HVAC	Date Applied: 10/11/2012	CBL: 375- B-001-001	
Location of Construction: 39 SANBORN ST	Owner Name: ERIN E LANE	Owner Address: 39 SANBORN ST PORTLAND, ME 04103	Phone:
Business Name:	Contractor Name: DownEast Energy	Contractor Address: 172 MAIN ST SOUTH PORTLAND MAINE 04106	Phone: (207) 799-5585
Lessee/Buyer's Name:	Phone:	Permit Type: TANK	Zone: R-3
Past Use: Single family Dwelling	Proposed Use: Same: Single Family Dwelling - to install 2-120 gallon propane tanks in the rear of property	Cost of Work:	CEO District:
		Fire Dept: <input checked="" type="checkbox"/> Approved <input type="checkbox"/> Denied <input type="checkbox"/> N/A	Inspection: Use Group: R-3 Type: HVAC
Proposed Project Description: 2 - 120 gallon Propane tanks		Pedestrian Activities District (P.A.D.)	
Permit Taken By: Lannie		Zoning Approval	

<p>1. This permit application does not preclude the Applicant(s) from meeting applicable State and Federal Rules.</p> <p>2. Building Permits do not include plumbing, septic or electrical work.</p> <p>3. Building permits are void if work is not started within six (6) months of the date of issuance. False informatin may invalidate a building permit and stop all work.</p>	<p>Special Zone or Reviews</p> <p><input type="checkbox"/> Shoreland</p> <p><input type="checkbox"/> Wetlands</p> <p><input type="checkbox"/> Flood Zone</p> <p><input type="checkbox"/> Subdivision</p> <p><input type="checkbox"/> Site Plan</p> <p>___ Maj ___ Min ___ MM</p> <p>Date: <i>10/12/12</i></p>	<p>Zoning Appeal</p> <p><input type="checkbox"/> Variance</p> <p><input type="checkbox"/> Miscellaneous</p> <p><input type="checkbox"/> Conditional Use</p> <p><input type="checkbox"/> Interpretation</p> <p><input type="checkbox"/> Approved</p> <p><input type="checkbox"/> Denied</p> <p>Date:</p>	<p>Historic Preservation</p> <p><input checked="" type="checkbox"/> Not in Dist or Landmark</p> <p><input type="checkbox"/> Does not Require Review</p> <p><input type="checkbox"/> Requires Review</p> <p><input type="checkbox"/> Approved</p> <p><input type="checkbox"/> Approved w/Conditions</p> <p><input type="checkbox"/> Denied</p> <p>Date: <i>[Signature]</i></p>
	CERTIFICATION		

I hereby certify that I am the owner of record of the named property, or that the proposed work is authorized by the owner of record and that I have been authorized by the owner to make this application as his authorized agent and I agree to conform to all applicable laws of this jurisdiction. In addition, if a permit for work described in the appication is issued, I certify that the code official's authorized representative shall have the authority to enter all areas covered by such permit at any reasonable hour to enforce the provision of the code(s) applicable to such permit.

SIGNATURE OF APPLICANT	ADDRESS	DATE	PHONE
RESPONSIBLE PERSON IN CHARGE OF WORK, TITLE		DATE	PHONE



FILL IN AND SIGN WITH INK 2012-10-5152

APPLICATION FOR PERMIT HEATING OR POWER EQUIPMENT

- Propane Tank Set -

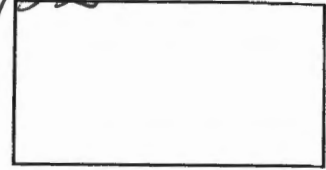

R-3

To the INSPECTOR OF BUILDINGS, PORTLAND, ME.

The undersigned hereby applies for a permit to install the following heating, cooking or power equipment in accordance with the Laws of Maine, the Building Code of the City of Portland, and the following specifications:

Location / CBL 375 B001001 Use of Building Single Family Residential Date 10/10/12
 Name and address of owner of appliance Stephen Melville 39 Sanborn St
Portland ME 04103
 Installer's name and address Downeast Energy 172 Main St
South Portland ME 04106 Telephone 794-5585

Location of appliance:

- Basement
- Attic
- Floor
- Roof

Type of Fuel:

- Gas
- Oil
- Solid

Appliance Name: Installed by others

U.L. Approved Yes No

Will appliance be installed in accordance with the manufacture's installation instructions? Yes No

IF NO Explain: _____

The Type of License of Installer:

- Master Plumber # _____
- Solid Fuel # _____
- Oil # _____
- Gas # PNT 1665
- Other _____

Type of Chimney:

- Masonry Lined
Factory built _____
- Metal
Factory Built U.L. Listing # _____
- Direct Vent
Type _____

Type of Fuel Tank

- Oil
- Gas

Size of Tank 120

Number of Tanks 2

Distance from Tank to Center of Flame 30' feet.

Cost of Work: \$ 94.00

Permit Fee: \$ _____

RECEIVED
 OCT 11 2012
 Dept. of Building Inspections
 City of Portland, Maine

Approved

Approved with Conditions

Fire: _____
 Ele.: _____
 Bldg.: _____

- See attached letter or requirement

Inspector's Signature

Date Approved

Signature of Installer Steve Trudell / Andrea Kerass

White - Inspection Yellow - File Pink - Applicant's Gold - Assessor's Copy

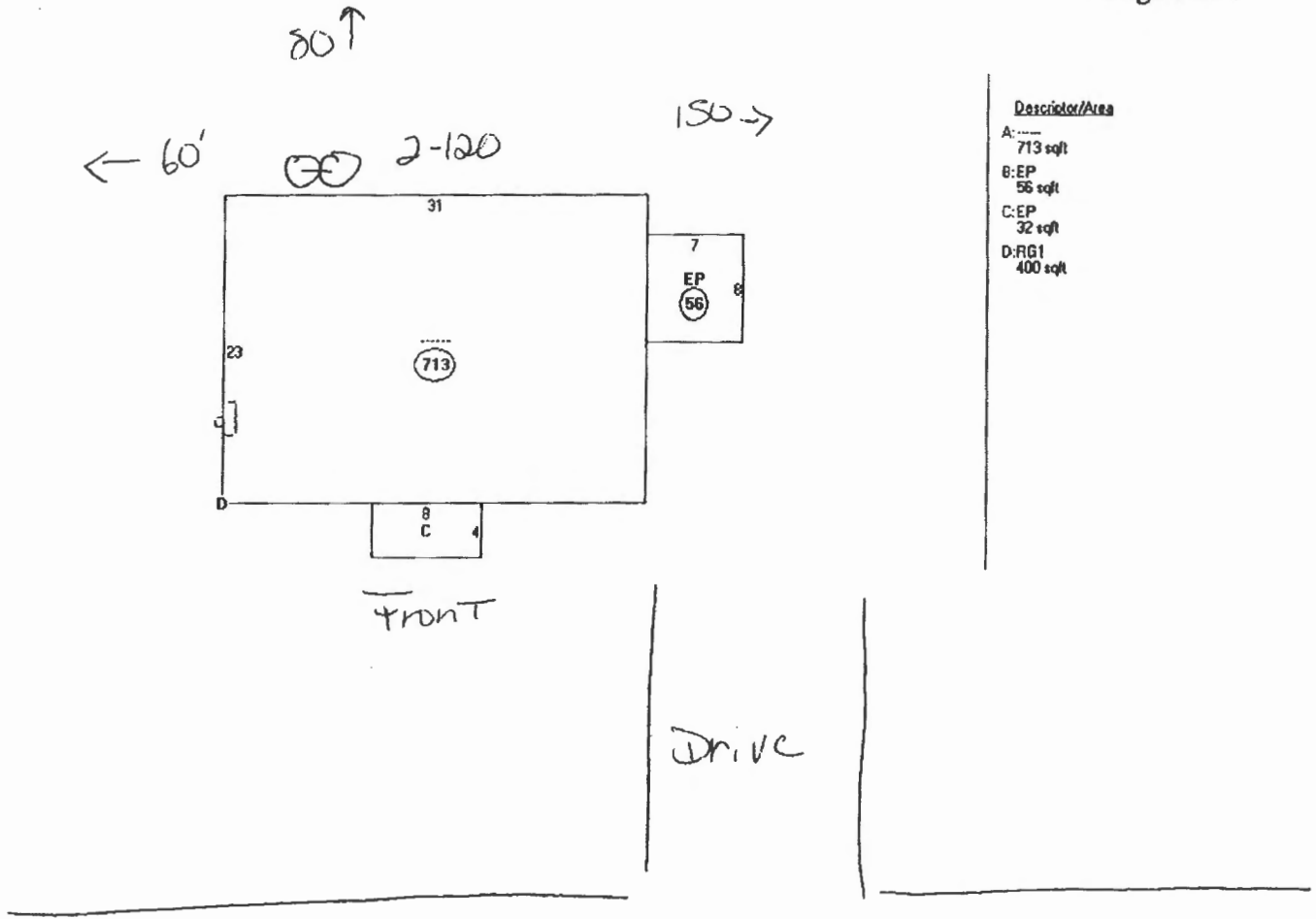

Assessor's Office | 389 Congress Street | Portland, Maine 04101 | Room 115 | (207) 874-8406

City Home Departments City Council E-Services Calendar Jobs

This page contains a detailed description of the Parcel ID you selected. Press the **New Search** button at the bottom of the screen to submit a new query.

Current Owner Information:

Services

Applications

Doing Business

Maps

Tax Relief

Tax Roll

Q & A

CBL 375 B001001
Land Use Type SINGLE FAMILY
Property Location 39 SANBORN ST
Owner Information LANE ERIN E & MATTHEW E LANE JTS
 39 SANBORN ST
 PORTLAND ME 04103
Book and Page 26415/003
Legal Description 375-B-1 WASHINGTON AVE
 1523-1527
 SANBORN ST 35-41
 8250 SF
Acres 0.1894

Current Assessed Valuation:

TAX ACCT NO. 38450 **OWNER OF RECORD AS OF APRIL 2012**
 LANE ERIN E &
 MATTHEW E LANE JTS
 39 SANBORN ST
 PORTLAND ME 04103
LAND VALUE \$68,400.00
BUILDING VALUE \$133,700.00
NET TAXABLE - REAL ESTATE \$202,100.00
TAX AMOUNT \$3,803.52

browse city services a-z

browse facts and links a-z

Any information concerning tax payments should be directed to the Treasury office at 874-8490 or e-mailed.



Best viewed at 800x600, with Internet Explorer

Building Information:

Building 1
Year Built 1950
Style/Structure Type CAPE
Stories 1.5
Units 1
Bedrooms 4
Full Baths 2
Total Rooms 7
Attic NONE
Basement FULL
Square Feet 1248

[View Sketch](#) [View Map](#) [View Picture](#)



Outbuildings/Yard Improvements:

Building 1
Year Built 1950
Structure GARAGE-WD/CB
Size 20X20
Units 1
Grade C
Condition A

Sales Information:

Sale Date	Type	Price	Book/Page
10/24/2008	LAND + BUILDING	\$211,000.00	26415/003
10/1/2003	LAND + BUILDING	\$194,900.00	20322/291
3/20/2000	LAND + BUILDING	\$0.00	15374/290
3/20/2000	LAND + BUILDING	\$115,000.00	15374/291
7/20/1998	LAND + BUILDING	\$0.00	13997/279

[New Search](#)