

DRIVE THRU-TELLER DETAIL  
1" = 5'

- GENERAL NOTES:**
1. SNOW STORAGE SHALL BE DEDICATED TO THE REAR OF THE SITE ALONG WASHINGTON AVENUE. NO STORAGE SHALL BE ALLOWED ON AUBURN STREET OR CONNECTOR STREET EDGES OF THE PROPERTY.
  2. THE SAWCUT LINE SHALL BE OFFSET 12" FROM THE EXISTING ISLAND TO BE REMOVED AS MEASURED FROM THE TOE OF THE EXISTING CURB LINE.
  3. WHEN REMOVING EXISTING SIDEWALK AND CONSTRUCTING GRASS ESPLANADE BETWEEN WASHINGTON AVENUE AND AUBURN STREET ALONG THE CONNECTOR ROAD, CONTRACTOR SHALL RESET ANY CURBING DISPLACED BY THE WORK.
  4. PROMOTE GRANITE CURB TERMINAL END SECTIONS ON BOTH SIDES OF ADA CURB RAMPS.
  5. COORDINATE EXACT LOCATION OF ADA CURB RAMP WITH EXISTING LOCATION OF CROSSWALK. REMOVE AND RESET CURB AND TYPINGS AS REQUIRED.
  6. PROTECT ALL PROPERTY CORNERS.
  7. HEAVY DUTY BITUMINOUS ASPHALT SECTION SHALL MATCH THE EXISTING PAVEMENT SECTION OR SHALL HAVE THE FOLLOWING BUILD-UP:
    - A) 1 1/2" OF 9.5mm HMA MIX
    - B) 3 1/2" OF 12.5mm HMA MIX
    - C) 4" OF TYPE 'A' BASE GRAVEL
    - D) 15" OF TYPE 'D' SUB-BASE GRAVEL
  8. SIGNAL TYPING AND PHASING SHALL BE ADJUSTED AS DIRECTED BY THE ENGINEER.

SITE DATA	
ZONE/ CONTRACT ZONE	
SITE AREA	36,920 SF. = 0.84 ACRES
BUILDING AREA	2,882 SF.
PARKING	REQUIRED PROVIDED
NEW STRUCTURE	
TOTAL PARKING	0 18
(1 SP / 400 SF)	
BARREER FREE SPACES	1 1

SPACE AND BULK STANDARDS	
CONTRACT ZONE	REQUIRED PROVIDED
MIN. LOT SIZE	SEE NOTE 1 36,920 SF.
BUILDING SETBACKS	
FRONT	SEE NOTE 1 > 10'
REAR	SEE NOTE 1 > 35'
MAXIMUM HEIGHT	SEE NOTE 1 < 35'

STRIPING LEGEND	
SIGNAGE, STRIPING AND PAVEMENT MARKINGS SHALL BE IN ACCORDANCE WITH THE MANUAL ON UNIFORM TRAFFIC CONTROL DEVICES (MUTCD) REGARDING SIZE, INSTALLATION, LOCATION & REFLECTIVITY.	
12" SW	- 12" WIDTH STOP LINE
4" SSML	- 4" WIDTH SINGLE SOLID WHITE LANE LINE
4" SYLL	- 4" WIDTH SINGLE SOLID YELLOW LANE LINE
4" OSYLL	- 4" WIDTH DOUBLE SOLID YELLOW LANE LINE
4" SYL	- 4" WIDTH SOLID YELLOW LANE
12" SWL	- 12" WIDTH SOLID WHITE LANE

SIGN LEGEND	
STOP	811-1 30" x 30"
NO PARKING	811-1 30" x 30"
NO STOPPING	811-1 30" x 30"
NO LEFT TURN	811-1 30" x 30"
NO RIGHT TURN	811-1 30" x 30"
NO U-TURN	811-1 30" x 30"
NO THROUGH TRUCKS	811-1 30" x 30"
NO TRUCKS	811-1 30" x 30"
NO MOTORCYCLES	811-1 30" x 30"
NO BICYCLES	811-1 30" x 30"
NO PEDESTRIANS	811-1 30" x 30"
NO HORSEDRAGS	811-1 30" x 30"
NO TRUCKS	811-1 30" x 30"
NO MOTORCYCLES	811-1 30" x 30"
NO BICYCLES	811-1 30" x 30"
NO PEDESTRIANS	811-1 30" x 30"
NO HORSEDRAGS	811-1 30" x 30"

PAVEMENT LEGEND	
ALL PAVEMENT SHALL BE STANDARD DUTY EXCEPT AS FOLLOWS:	
[Pattern]	STANDARD DUTY BITUMINOUS ASPHALT
[Pattern]	HEAVY DUTY BITUMINOUS ASPHALT (NOTE 7)
[Pattern]	CONCRETE PAVERS
[Pattern]	CONCRETE WITH BROOM FINISH

CURBING LEGEND	
[Pattern]	VERTICAL GRANITE CURB

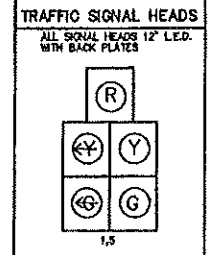

**PLATZ ASSOCIATES**  
Architects - Engineers  
Construction Managers  
Tel 207-794-2941  
Fax 207-794-3856  
Two Great Falls Plaza, Auburn, Maine 04210

**Bath Savings Institution**  
Portland, Maine



- DESIGNED BY: [ ]  
 OWNER REVIEW  
 CLIENT REVIEW  
 PERMIT REVIEW  
 BID SET  
 CONTRACT DOCUMENTS  
 CONSTRUCTION

**SITE LAYOUT PLAN**

JOB NO. 22003  
 SP. JOB NO. 587.1

DRAWN BY: SGB  
 CHECKED BY: WCH

SCALE: 1" = 20'

ISSUE DATE: 14 JUL 2003

REVISED DATE:

SHEET

**C102**

**GP** Gorrill-Palmer Consulting Engineers, Inc.  
 PO Box 1237 Traffic and Civil Engineering Services 207-657-6910  
 15 Shaker Road FAX: 207-657-6912  
 Gray, ME 04039 E-Mail: mo@box.gorrillpalmer.com

Rev.	Date	Revision	Issued For	Date	By



66'-8"

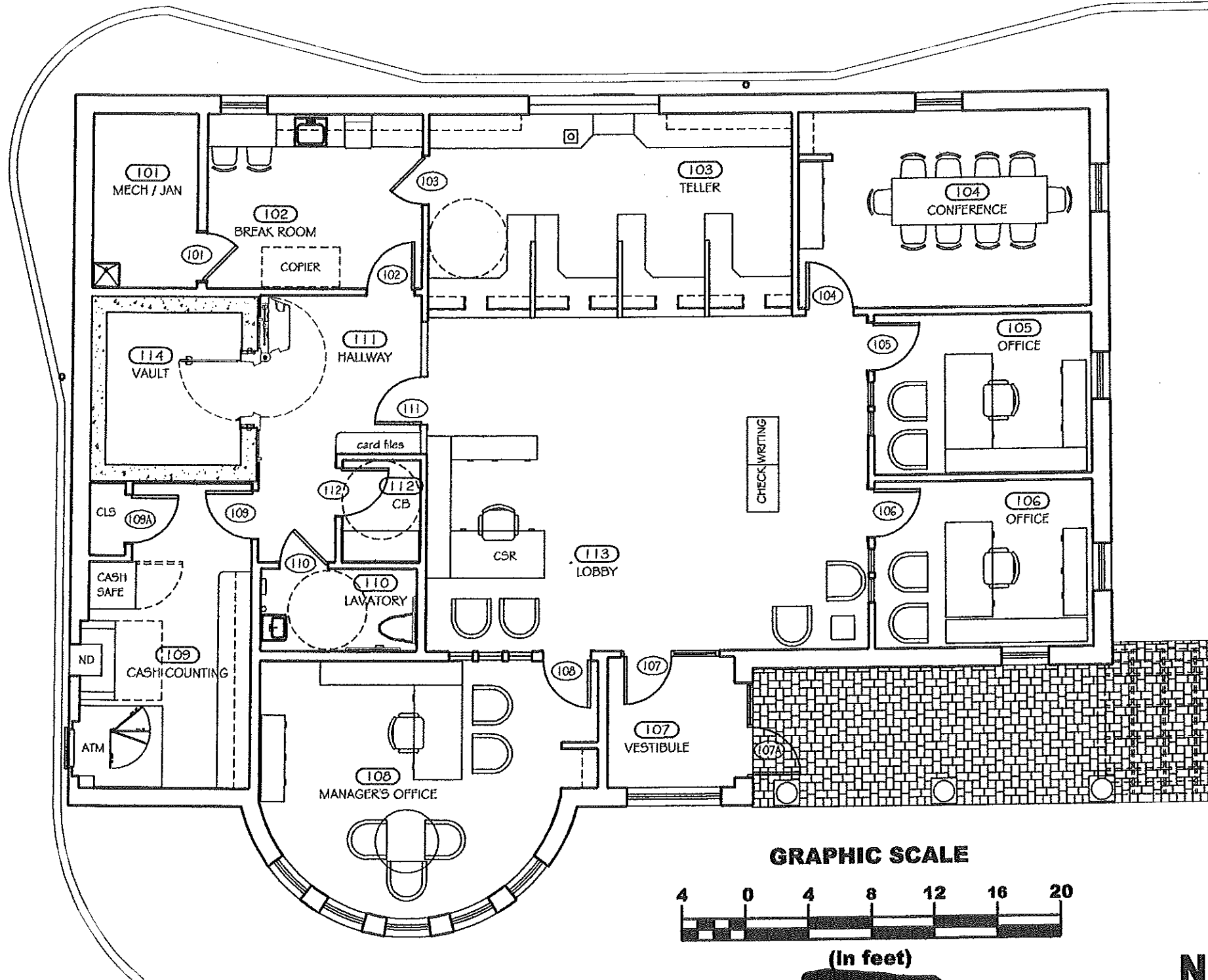

75'-4"

GRAPHIC SCALE

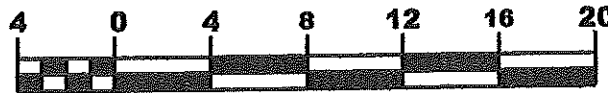

(In feet)

**NOT FOR CONSTRUCTION**

**Floor Plan**

**Bath Savings Institution  
Branch Bank - Auburn St.  
Portland, Maine**

**PLATZ ASSOCIATES**  
Architects - Engineers  
Construction Managers  
Two Great Falls Plaza, Auburn, Maine 04210

DRAWN BY:	5LS / CDW
CHECKED BY:	
DATE:	22 AUG 02
SCALE:	NOTED
JOB NO.:	22003
	SK-A101b