

**WHIPPLE
CALLENDER
ARCHITECTS**

136 PLEASANT AVE.
PORTLAND, ME 04103
P 207.775.3696
F 207.775.3631
www.whipplecallender.com

DATE	DESCRIPTION
2-28-2017	ISSUED FOR STATE FIRE MARSHAL
3-6-2017	ISSUED FOR PERMIT W/ SURVEY
4-6-2017	REVISION # 1 - PLAN REVISIONS
4-10-2017	REVISION # 2
4-25-2017	REVISION # 3
5-1-2017	SECOND FLOOR TENANT FIT-UP

DATE: 5/9/17
CHECKED BY: AEC
DRAWN BY: CLL
JOB: NEF
SHEET TITLE: SECOND FLOOR PLAN & DEMO PLAN

A1.2

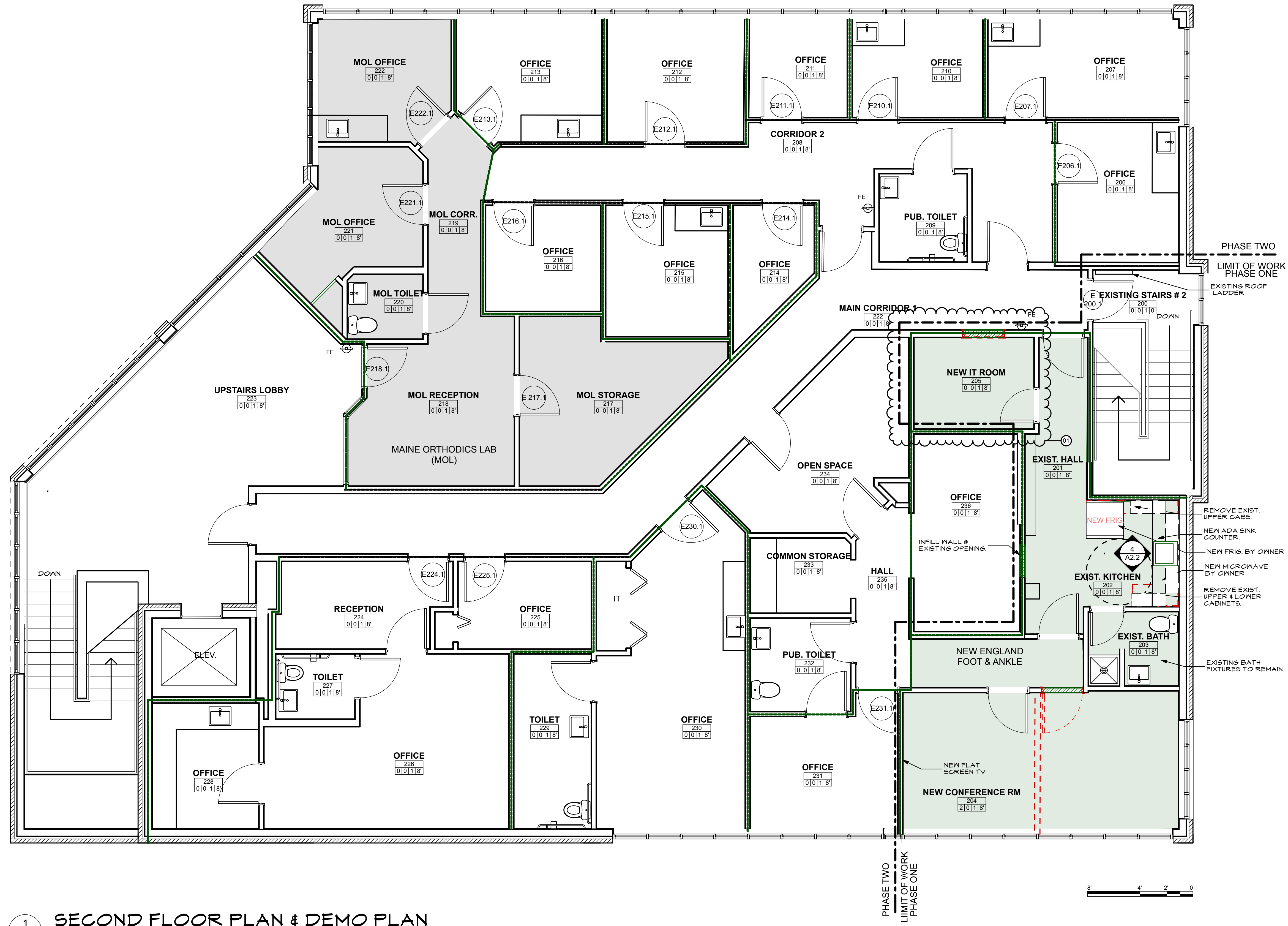

- PHASE TWO NOTES:**
- EXISTING TO REMAIN:
WALLS, BASE & TRIM
FLOORING
SINKS & CASEWORK
DOORS & FRAMES
TOILET FIXTURES
FIRE EXTINGUISHERS & CABINETS
CEILING TILE & GRID
LIGHTS
ELECTRICAL OUTLETS
PHONE
DATA
SPRINKLER HEADS
 - REPLACE DAMAGED CEILING TILE & HVAC GRILLES AS NEEDED.
 - NEW EXIT LIGHTS, FIRE ALARM & EMERGENCY LIGHTING- SEE LS2.2
 - REPLACE DOOR HARDWARE TO INDIVIDUALLY KEYPED, LEVER HANDLE (ADA) TYP. AT EACH SUITE OR OFFICE.

LEGEND:

WALL TYPE 1 TYPICAL
SEE SHEET NO. A4.1

NEW WALL

DIMENSION TO THE FACE OF STUD UNLESS OTHERWISE NOTED

EXISTING WALL TO REMAIN

EXISTING CONSTRUCTION TO BE REMOVED

DOOR & FRAME SCHEDULE
SEE SHEET A4.1

INTERIOR ELEVATIONS

PAGE

DENOTES TENANT SEPARATION
@ EXISTING WALLS

ROOM FINISH LEGEND

FLOORING MATERIAL FIRST NO. OF 4	BASEBOARD MATERIAL SECOND NO. OF 4	WALL FINISH THIRD NO. OF 4
0 NO CHANGE	0 NO CHANGE	0 NO CHANGE
1 V.C.T.	1 4" VINYL	1 PAINT
2 CARPET		

GENERAL LEGEND

ROOM NAME
RM. #

CEILING HEIGHT
WALL MATERIAL #
BASEBOARD MATERIAL #
FLOORING MATERIAL #

1 SECOND FLOOR PLAN & DEMO PLAN
A1.2 SCALE: 1/4" = 1'-0"

- GENERAL NOTES:**
- VERIFY ALL DIMENSIONS IN THE FIELD. REPORT ALL DISCREPANCIES TO ARCHITECT PRIOR TO COMMENCEMENT WITH WORK.
 - NOTED DIMENSIONS TAKE PRECEDENT OVER SCALED DIMENSIONS. LARGE DETAILS TAKE PRECEDENT OVER SMALL SCALED DETAILS.
 - ALL NEW CONSTRUCTION DIMENSIONS ARE ROUGH OPENINGS UNLESS NOTED OTHERWISE. DIMENSIONS TO EXISTING WALL CONSTRUCTION ARE TO FINISH SURFACE.
 - PROVIDE SOLID BLOCKING FOR ALL CABINETRY AND ACCESSORIES. REVIEW INTERIOR ELEVATIONS AND DETAILS FOR LOCATIONS.