

**City of Portland, Maine - Building or Use Permit Application**

389 Congress Street, 04101 Tel: (207) 874-8703, Fax: (207) 874-8716

Permit No: 04-0031	Issue Date: Jan 16 2004	CBL: 375 C036001
-----------------------	----------------------------	---------------------

Location of Construction: 1397 Washington Ave	Owner Name: Mobil Oil Corp Property Tax	Owner Address: Po Box 4973 CITY OF PORTLAND	Phone: 207-797-4077
Business Name: n/a	Contractor Name: Stephen-Marginis Associates, Inc	Contractor Address: 8030 Willow St. Manchester	Phone: 6036441664
Lessee/Buyer's Name n/a	Phone: n/a	Permit Type: Signs - Permanent	Zone: B2

Past Use: Commercial / Gas Station	Proposed Use: Gas Station / Relocate existing 180 sq. Ft. ground sign due to DOT road widening.	Permit Fee: \$390.00	Cost of Work: \$0.00	CEO District: 5
Proposed Project Description: Relocate existing 180 sq. Ft. ground sign due to DOT road widening.		FIRE DEPT: <i>N/A</i>	INSPECTION: Use Group: <i>V</i> Type: <i>Sign</i> <i>BOLA 1999</i>	
		Signature: <i>[Signature]</i>		Signature: <i>[Signature]</i>
PEDESTRIAN ACTIVITIES DISTRICT (P.A.D.)				
Action: <input type="checkbox"/> Approved <input type="checkbox"/> Approved w/Conditions <input type="checkbox"/> Denied				
Signature: _____ Date: _____				

Permit Taken By: gg	Date Applied For: 01/12/2004	<b>Zoning Approval</b>		
<ol style="list-style-type: none"> <li>This permit application does not preclude the Applicant(s) from meeting applicable State and Federal Rules.</li> <li>Building permits do not include plumbing, septic or electrical work.</li> <li>Building permits are void if work is not started within six (6) months of the date of issuance. False information may invalidate a building permit and stop all work..</li> </ol>	<b>Special Zone or Reviews</b> <input type="checkbox"/> Shoreland <input type="checkbox"/> Wetland <input type="checkbox"/> Flood Zone <input type="checkbox"/> Subdivision <input type="checkbox"/> Site Plan Maj <input type="checkbox"/> Minor <input type="checkbox"/> MM <input type="checkbox"/> Date: <i>1/13/04</i>	<b>Zoning Appeal</b> <input type="checkbox"/> Variance <input type="checkbox"/> Miscellaneous <input type="checkbox"/> Conditional Use <input type="checkbox"/> Interpretation <input type="checkbox"/> Approved <input type="checkbox"/> Denied Date: _____	<b>Historic Preservation</b> <input checked="" type="checkbox"/> Not in District or Landmark <input type="checkbox"/> Does Not Require Review <input type="checkbox"/> Requires Review <input type="checkbox"/> Approved <input type="checkbox"/> Approved w/Conditions <input type="checkbox"/> Denied Date: _____	
	<i>Special Note: Same sign only Relocating due to DOT because of TAP-6</i>			

**CERTIFICATION**

I hereby certify that I am the owner of record of the named property, or that the proposed work is authorized by the owner of record and that I have been authorized by the owner to make this application as his authorized agent and I agree to conform to all applicable laws of this jurisdiction. In addition, if a permit for work described in the application is issued, I certify that the code official's authorized representative shall have the authority to enter all areas covered by such permit at any reasonable hour to enforce the provision of the code(s) applicable to such permit.

SIGNATURE OF APPLICANT	ADDRESS	DATE	PHONE
RESPONSIBLE PERSON IN CHARGE OF WORK, TITLE		DATE	PHONE

# DISPLAY THIS CARD ON PRINCIPAL FRONTAGE OF WORK CITY OF PORTLAND

Please Read Application And Notes, if Any, Attached

## PERMIT

Permit Number: 040031

This is to certify that Mobil Oil Corp Property Tax Relocate existing 180 sq. Ft. At 1397 Washington Ave

JAN 15 1984

375 C036001

CITY OF PORTLAND

provided that the person or persons of the provisions of the Statutes of the construction, maintenance and use of this department.

Apply to Public Works for street line and grade if nature of work requires such information.

### OTHER REQUIRED APPROVALS

Fire Dept. \_\_\_\_\_  
Health Dept. \_\_\_\_\_  
Appeal Board \_\_\_\_\_  
Other \_\_\_\_\_

Department Name

Notice of Occupancy must be procured by owner before this building or part thereof is occupied. A certificate of occupancy must be procured by owner before this building or part thereof is occupied.

A certificate of occupancy must be procured by owner before this building or part thereof is occupied.

PENALTY FOR REMOVING THIS CARD

Director - Building & Inspection Services

**City of Portland, Maine - Building or Use Permit**

389 Congress Street, 04101 Tel: (207) 874-8703, Fax: (207) 874-8716

Permit No: 04-0031	Date Applied For: 01/12/2004	CBL: 375 C036001
-----------------------	---------------------------------	---------------------

Location of Construction: 1397 Washington Ave	Owner Name: Mobil Oil Corp Property Tax	Owner Address: Po Box 4973	Phone: 207-797-4077
Business Name: n/a	Contractor Name: Stephen-Marginis Associates, Inc	Contractor Address: 8030 Willow St. Manchester	Phone: (603) 644-1664
Lessee/Buyer's Name n/a	Phone: n/a	Permit Type: Signs - Permanent	

Proposed Use: Gas Station / Relocate existing 180 sq. Ft. ground sign due to DOT road widening.	Proposed Project Description: Relocate existing 180 sq. Ft. ground sign due to DOT road widening.
--	--

<b>Dept:</b> Zoning	<b>Status:</b> Approved	<b>Reviewer:</b> Marge Schmuckal	<b>Approval Date:</b> 01/13/2004
<b>Note:</b> for the existing sign only - no change in size			<b>Ok to Issue:</b> <input checked="" type="checkbox"/>

<b>Dept:</b> Building	<b>Status:</b> Approved with Conditions	<b>Reviewer:</b> Tammy Munson	<b>Approval Date:</b> 01/16/2004
<b>Note:</b> 1) Signage Installation to comply with Chapter 31 BOCA 1999			<b>Ok to Issue:</b> <input checked="" type="checkbox"/>

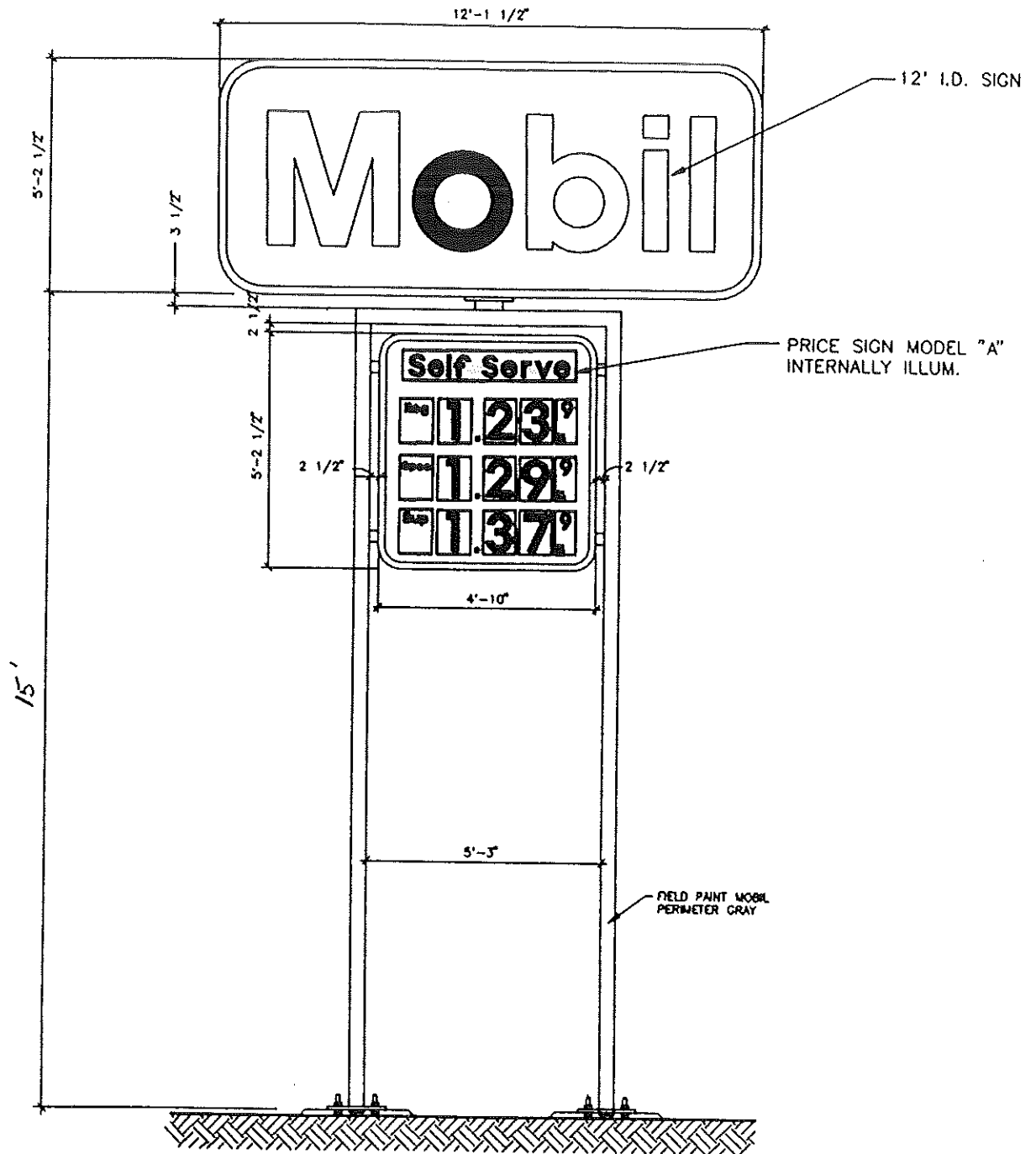

TWIN POLE 12' IDENTIFICATION SIGN  
 NOT TO SCALE 63.2 sq. ft.

PRICE I.D. SIGN  
 NOT TO SCALE 25.2 sq. ft.

# Signage/Awning Permit Application

If you or the property owner owes real estate or personal property taxes or user charges on any property with the City, payment arrangements must be made before permits of any kind are accepted.

Location/Address of Construction: <u>1397 Washington Ave.</u>		
Total Square Footage of Proposed Structure <u>90 SF</u>	Square Footage of Lot <u>28,000 ±</u>	
Tax Assessor's Chart, Block & Lot Chart# <u>375</u> Block# <u>C</u> Lot# <u>36</u>	Owner: <u>Mobil Oil Corp</u> <u>ExxonMobil Corp.</u>	Telephone: <u>514</u> <u>(207) 797-4077</u>
Lessee/Buyer's Name (if Applicable) <u>ExxonMobil Corp.</u> <u>Mobil Oil Corp</u>	Applicant name, address & telephone: <u>Stephens-Manginis Assoc.</u> <u>(603) 644-1664</u> <u>see below</u>	Total s.f. of signage x <u>90 x 2</u> <u>\$1.00 per s.f. plus \$30.00 = 180</u> = Total Fee: <u>360</u> <u>\$ 390.00</u> <u>+30</u> = <u>390</u> Awning Fee = Cost Of Work: \$ _____ Total Fee: \$ _____
Current use: <u>Gas Station</u>		
If the location is currently vacant, what was prior use: <u>N/A</u>		
Approximately how long has it been vacant: _____		
Proposed use: <u>Gas Station</u>		
Project description: <u>Relocate existing ground sign due to DOT road widening</u>		
Contractor's name, address & telephone: <u>Stephens-Manginis Associates, Inc.</u>		
Who should we contact when the permit is ready: <u>Attn: Art Strinsfellow (603) 644-1664</u>		
Mailing address: <u>Bks 3, Unit 2 / 8030 S. Willow St.</u> <u>Manchester, NH 03103</u>		
We will contact you by phone when the permit is ready. You must come in and pick up the permit and review the requirements before starting any work, with a Plan Reviewer. A stop work order will be issued and a \$100.00 fee if any work starts before the permit is picked up. PHONE: <u>603-644-1664</u>		

**IF THE REQUIRED INFORMATION IS NOT INCLUDED IN THE SUBMISSIONS THE PERMIT WILL BE AUTOMATICALLY DENIED AT THE DISCRETION OF THE BUILDING/PLANNING DEPARTMENT. WE MAY REQUIRE ADDITIONAL INFORMATION IN ORDER TO APPROVE THIS PERMIT.**

*I hereby certify that I am the Owner of record of the named property, or that the owner of record authorizes the proposed work and that I have been authorized by the owner to make this application as his/her authorized agent. I agree to conform to all applicable laws of this jurisdiction. In addition, if a permit for work described in this application is issued, I certify that the Code Official's authorized representative shall have the authority to enter all areas covered by this permit at any reasonable hour to enforce the provisions of the codes applicable to this permit.*

Signature of applicant: 	Date: <u>JAN 12 2004</u> <u>1/9/04</u>
---	---

**This is NOT a permit, you may not commence ANY work until the permit is issued**

## CHECKLIST FOR SIGN/AWNING APPLICATION

Applicants for a sign or awning permit are required to submit the following information to the Code Enforcement Office at the time of application:

- N/A Certificate of Liability listing the City as additional insured if any portion of the sign abuts or encroaches on any public right of way, or can fall into any public right of way. Amount must equal \$400,000.00.
- N/A Letter of permission from the owner indicating the permissions granted and the tenant/space building frontage.
- ✓ A sketch plan of lot, indicating location of buildings, driveways, and any abutting streets or rights of way, lengths of building frontages, street frontages, and all existing setbacks. Indicate on the plan all existing and proposed signs with their dimensions and specific locations. Relocate existing Ground Sign - DOT Taking Property.
- ✓ A sketch or photo of any proposed sign(s) indicating content, dimensions, materials, source of illumination, and construction method, as well as specifics of installation/attachment.
- N/A Certificate of Flammability required for awning or canopy at time of application.
- ✓ UL# required for lighted signs at the time of Final Inspection. Failure to provide this information will invalidate the Sign Permit.
- ✓ Pre-Application Questionnaire completed and attached. Photos of existing signage attached.

**Permit Fee for signage or awning-with-signage:**  
\$30.00 plus \$1.00 per square foot of sign.

**Permit Fee for awning-without-signage is based on cost of work:**  
\$30.00 for the first \$1,000.00, plus \$7.00 for each additional \$1,000.00.

29.00

10+300

+280 +287.2

10 FEET RIGHT

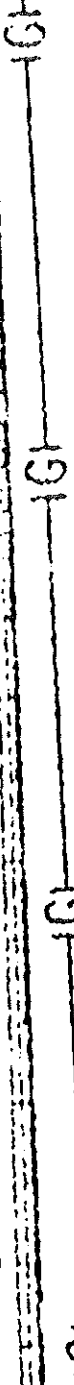

+282.0  
(45.00')  
13.716 m

40.238 m  
(132.01')

New Property Line

PAVED SAND

Proposed Relocation  
2" setback (0.17 ft.)

Relocated Ground Sign

1397 Washington Ave

#/PL

Mobil Oil Corporation

WALK

6.6±

m

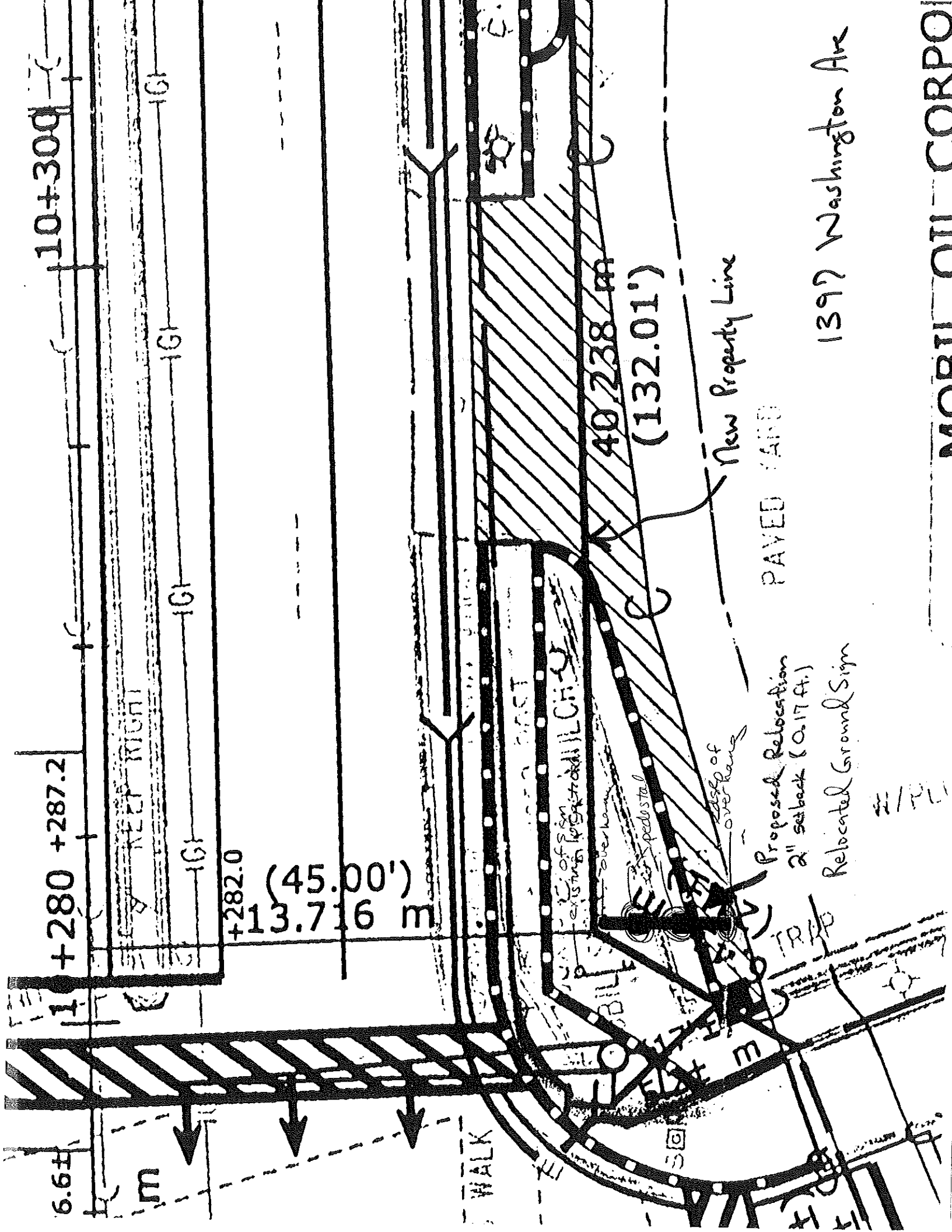





# ELECTRICAL PERMIT

## City of Portland, Me.

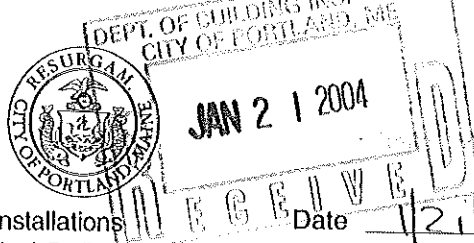

To the Chief Electrical Inspector, Portland Maine:  
 The undersigned hereby applies for a permit to make electrical installations in accordance with the laws of Maine, the City of Portland Electrical Ordinance, National Electrical Code and the following specifications:

Date 1/21/04  
 Permit # 2004-4842  
 CBL# 375-C036

LOCATION: 1397 Washington Ave. METER MAKE & # \_\_\_\_\_  
 CMP ACCOUNT # \_\_\_\_\_ OWNER Wah Oil Corp.  
 TENANT Sam's 25 Currier PHONE # \_\_\_\_\_

				TOTAL EACH FEE
OUTLETS	Receptacles	Switches	Smoke Detector	.20
FIXTURES	Incandescent	Fluorescent	Strips	.20
SERVICES	Overhead	Underground	TTL AMPS <800	15.00
	Overhead	Underground	>800	25.00
Temporary Service	Overhead	Underground	TTL AMPS	25.00
				25.00
METERS	(number of)			1.00
MOTORS	(number of)			2.00
RESID/COM	Electric units			1.00
HEATING	oil/gas units	Interior	Exterior	5.00
APPLIANCES	Ranges	Cook Tops	Wall Ovens	2.00
	Insta-Hot	Water heaters	Fans	2.00
	Dryers	Disposals	Dishwasher	2.00
	Compactors	Spa	Washing Machine	2.00
	Others (denote)			2.00
MISC. (number of)	Air Cond/win			3.00
	Air Cond/cent		Pools	10.00
	HVAC	EMS	Thermostat	5.00
<u>TD Sign</u>	1 Signs			10.00
	Alarms/res			5.00
	Alarms/com			15.00
	Heavy Duty(CRKT)			2.00
	Circus/Carnv			25.00
	Alterations			5.00
	Fire Repairs			15.00
	E Lights			1.00
	E Generators			20.00
PANELS	Service	Remote	Main	4.00
TRANSFORMER	0-25 Kva			5.00
	25-200 Kva			8.00
	Over 200 Kva			10.00
			TOTAL AMOUNT DUE	
			MINIMUM FEE/COMMERCIAL 45.00	
			MINIMUM FEE	35.00

CONTRACTORS NAME Gilbride Electric Inc MASTER LIC. # ME60016895  
 ADDRESS 21 Payless Dr Columbia ME 04224 LIMITED LIC. # \_\_\_\_\_  
 TELEPHONE 978 256 5576

SIGNATURE OF CONTRACTOR [Signature] ck # 7418

# ELECTRICAL PERMIT City of Portland, Me.

*Commercial  
Gas Station*



*Area #2  
dhr*

To the Chief Electrical Inspector, Portland Maine:  
The undersigned hereby applies for a permit to make electrical installations in accordance with the laws of Maine, the City of Portland Electrical Ordinance, National Electrical Code and the following specifications:

Date 3/13/00  
Permit # 201  
CBL# 375-C-036

SITE LOCATION: 1397 Washington Ave

OWNER Mobil Oil Corp. TENANT \_\_\_\_\_

OUTLETS	Receptacles	Switches	Smoke Detectors	TOTAL EACH FEE	
				.20	
FIXTURES	incandescent	fluorescent	Strips	.20	
SERVICES	Overhead	Underground	TTL AMPS <800	15.00	
	Overhead	Underground	TTL AMPS >800	25.00	
Temporary Service	Overhead	Underground	TTL AMPS	25.00	
				25.00	
METERS	(number of)			1.00	
MOTORS	(number of)			2.00	
RESID/COM	Electric units			1.00	
HEATING	oil/gas units	Interior	Exterior	5.00	
APPLIANCES	Ranges	Cook Tops	Wall Ovens	2.00	
	Insta-Hot	Water heaters	Fans	2.00	
	Dryers	Disposals	Dishwasher	2.00	
	Compactors	Spa	Washing Machine	2.00	
	Others (denote)			2.00	
	MISC. (number of)	Air Cond/win			3.00
		Air Cond/cent			10.00
		HVAC	EMS	Pools	5.00
	Signs		Thermostat	10.00	
	Alarms/res			5.00	
	Alarms/com			15.00	
	Heavy Duty(CRKT)			2.00	
	Circus/Carnv			25.00	
	Alterations			5.00	
	Fire Repairs			15.00	
	E Lights			1.00	
	E Generators			20.00	
<i>Replacem Condy Hts</i>					
PANELS	Service	Remote	Main	16	
TRANSFORMER	0-25 Kva			4.00	
	25-200 Kva			5.00	
	Over 200 Kva			8.00	
				10.00	
			TOTAL AMOUNT DUE	35.00	
			MINIMUM FEE	25.00	

INSPECTION: Will be ready \_\_\_\_\_ or will call

CONTRACTORS NAME Pro-Electric MASTER LIC. # MC 60017929  
 ADDRESS 25 Chestnut St. Saco, Me. LIMITED LIC. # \_\_\_\_\_  
 TELEPHONE 781-277-6558 01970

SIGNATURE OF CONTRACTOR [Signature] (Zarro)

# ELECTRICAL PERMIT

## City of Portland, Me.

*Commercial*  
*Gas Station*



*Area #2*  
*dlr*

To the Chief Electrical Inspector, Portland Maine:  
The undersigned hereby applies for a permit to make electrical installations in accordance with the laws of Maine, the City of Portland Electrical Ordinance, National Electrical Code and the following specifications:

Date 3/13/00  
Permit # 1201  
CBL# 375-C-036

SITE LOCATION: 1397 Washington Ave

OWNER Mobil Oil Corp. TENANT \_\_\_\_\_

OUTLETS	Receptacles	Switches	Smoke Detectors	TOTAL EACH FEE	
				.20	
FIXTURES	incandescent	fluorescent	Strips	.20	
SERVICES	Overhead	Underground	TTL AMPS <800	15.00	
	Overhead	Underground	TTL AMPS >800	25.00	
Temporary Service	Overhead	Underground	TTL AMPS	25.00	
METERS	(number of)			25.00	
MOTORS	(number of)			1.00	
RESID/COM	Electric units			2.00	
HEATING	oil/gas units	Interior	Exterior	1.00	
				5.00	
APPLIANCES	Ranges	Cook Tops	Wall Ovens	2.00	
	Insta-Hot	Water heaters	Fans	2.00	
	Dryers	Disposals	Dishwasher	2.00	
	Compactors	Spa	Washing Machine	2.00	
	Others (denote)			2.00	
	MISC. (number of)	Air Cond/win			3.00
		Air Cond/cent			10.00
	HVAC	EMS	Pools	5.00	
	Signs		Thermostat	10.00	
	Alarms/res			5.00	
	Alarms/com			15.00	
	Heavy Duty(CRKT)			2.00	
	Circus/Carnv			25.00	
	Alterations			5.00	
	Fire Repairs			15.00	
	E Lights			1.00	
	E Generators			20.00	
<i>Replacement Conduit</i>					
PANELS	Service	Remote	Main	16 4.00	
TRANSFORMER	0-25 Kva			5.00	
	25-200 Kva			8.00	
	Over 200 Kva			10.00	
MINIMUM FEE/COMMERCIAL 35.00			TOTAL AMOUNT DUE	35.00	
			MINIMUM FEE	25.00	

INSPECTION: Will be ready \_\_\_\_\_ or will call

CONTRACTORS NAME Pro-Electric MASTER LIC. # MC 60017929  
ADDRESS 25 Chestnut St. Searsville Mo. LIMITED LIC. # \_\_\_\_\_  
TELEPHONE 781-273-6558 01970

SIGNATURE OF CONTRACTOR [Signature] (2000)

