

DISPLAY THIS CARD ON PRINCIPAL FRONTAGE OF WORK
CITY OF PORTLAND PERMIT ISSUED

Please Read
Application And
Notes, If Any,
Attached

BUILDING DEPARTMENT

PERMIT

Permit Number: 091301

This is to certify that 125 AUBURN STREET LLC (Solely Sign) Inc.

has permission to install a 3' x 8' Sign

City of Portland

AT 125 AUBURN ST

City 375 C023001

provided that the person or persons, firm or corporation accepting this permit shall comply with all of the provisions of the Statutes of Maine and of the Ordinances of the City of Portland regulating the construction, maintenance and use of buildings and structures, and of the application on file in this department.

Apply to Public Works for street line and grade if nature of work requires such information.

Notification of inspection must be given and written permission procured before this building or part thereof is lathed or otherwise used-in. 24 HOUR NOTICE IS REQUIRED.

A certificate of occupancy must be procured by owner before this building or part thereof is occupied.

OTHER REQUIRED APPROVALS

Fire Dept. _____

Health Dept. _____

Appeal Board _____

Other _____

Department Name

Director - Building & Inspection Services

PENALTY FOR REMOVING THIS CARD

City of Portland, Maine - Building or Use Permit Application
 389 Congress Street, 04101 Tel: (207) 874-8703, Fax: (207) 874-8716

Permit No: 09-1301	Issue Date:	CBL: 375 C023001
-----------------------	-------------	---------------------

Location of Construction: 125 AUBURN ST	Owner Name: 125 AUBURN STREET LLC	Owner Address: 5 MILITIA DR	Phone:
Business Name:	Contractor Name: Bailey Sign Company Inc.	Contractor Address: 9 Thomas Drive Westbrook	Phone: 2077742843
Lessee/Buyer's Name	Phone:	Permit Type: Signs - Permanent	Zone: R-P

Past Use: Commercial Office "H & R Block" Connected w/ permit# 09-0829	Proposed Use: Commercial Office "H & R Block" - install a 3' x 8' Sign - <i>free standing.</i>	Permit Fee: \$78.00	Cost of Work: \$78.00	CEO District: 5
--	--	------------------------	--------------------------	--------------------

Proposed Project Description: install a 3' x 8' Sign - <i>free standing</i>	FIRE DEPT: <input type="checkbox"/> Approved <input type="checkbox"/> Denied <i>N/A</i>	INSPECTION: Use Group: <i>U</i> Type: <i>Sign</i> <i>IBC 2003</i>
	Signature: _____	Signature: _____
	PEDESTRIAN ACTIVITIES DISTRICT (P.A.D.)	
	Action: <input type="checkbox"/> Approved <input type="checkbox"/> Approved w/Conditions <input type="checkbox"/> Denied	
	Signature: _____	Date: _____

Permit Taken By: Ldobson	Date Applied For: 11/12/2009	Zoning Approval
-----------------------------	---------------------------------	------------------------

1. This permit application does not preclude the Applicant(s) from meeting applicable State and Federal Rules. 2. Building permits do not include plumbing, septic or electrical work. 3. Building permits are void if work is not started within six (6) months of the date of issuance. False information may invalidate a building permit and stop all work..	Special Zone or Reviews <input type="checkbox"/> Shoreland <input type="checkbox"/> Wetland <input type="checkbox"/> Flood Zone <input type="checkbox"/> Subdivision <input type="checkbox"/> Site Plan Maj <input type="checkbox"/> Minor <input type="checkbox"/> MM <input type="checkbox"/> <i>OK</i> Date: <i>11/23/09 ABU</i>	Zoning Appeal <input type="checkbox"/> Variance <input type="checkbox"/> Miscellaneous <input type="checkbox"/> Conditional Use <input type="checkbox"/> Interpretation <input type="checkbox"/> Approved <input type="checkbox"/> Denied Date: _____	Historic Preservation <input type="checkbox"/> Not in District or Landmark <input type="checkbox"/> Does Not Require Review <input type="checkbox"/> Requires Review <input type="checkbox"/> Approved <input type="checkbox"/> Approved w/Conditions <input type="checkbox"/> Denied Date: _____
--	---	--	--

CERTIFICATION

I hereby certify that I am the owner of record of the named property, or that the proposed work is authorized by the owner of record and that I have been authorized by the owner to make this application as his authorized agent and I agree to conform to all applicable laws of this jurisdiction. In addition, if a permit for work described in the application is issued, I certify that the code official's authorized representative shall have the authority to enter all areas covered by such permit at any reasonable hour to enforce the provision of the code(s) applicable to such permit.

PERMIT ISSUED

SIGNATURE OF APPLICANT _____ ADDRESS _____ DATE **DEC 1** PHONE _____

RESPONSIBLE PERSON IN CHARGE OF WORK, TITLE _____ DATE **City of Portland** PHONE _____

City of Portland, Maine - Building or Use Permit

389 Congress Street, 04101 Tel: (207) 874-8703, Fax: (207) 874-8716

Permit No: 09-1301	Date Applied For: 11/12/2009	CBL: 375 C023001
-----------------------	---------------------------------	---------------------

Location of Construction: 125 AUBURN ST	Owner Name: 125 AUBURN STREET LLC	Owner Address: 5 MILITIA DR	Phone:
Business Name:	Contractor Name: Bailey Sign Company Inc.	Contractor Address: 9 Thomas Drive Westbrook	Phone: (207) 774-2843
Lessee/Buyer's Name	Phone:	Permit Type: Signs - Permanent	

Proposed Use: Commercial Office "H & R Block" - install a 3' x 8' freestanding Sign	Proposed Project Description: install a 3' x 8' freestanding Sign
--	--

Dept: Zoning	Status: Approved	Reviewer: Ann Machado	Approval Date: 11/23/2009	Ok to Issue: <input checked="" type="checkbox"/>
Note:				
Dept: Building	Status: Approved with Conditions	Reviewer: Tammy Munson	Approval Date: 12/01/2009	Ok to Issue: <input checked="" type="checkbox"/>
Note:	1) Signage Installation to comply with Chapters 31 & 32 of the IBC 2003 building code.			

Comments:
11/17/2009-amachado: Spoke to Deanna Emery at Bailey Signs. Need a better sketch plan that shows how far the sign is located from the property lines.
11/23/2009-amachado: Received siteplan that shows 5' setback & location.

PERMIT ISSUED

DEC 1 2009

City of Portland

BUILDING PERMIT INSPECTION PROCEDURES

Please call 874-8703 or 874-8693 (ONLY)

to schedule your inspections as agreed upon

Permits expire in 6 months, if the project is not started or ceases for 6 months.

The Owner or their designee is required to notify the inspections office for the following inspections and provide adequate notice. Notice must be called in 48-72 hours in advance in order to schedule an inspection:

By initializing at each inspection time, you are agreeing that you understand the inspection procedure and additional fees from a "Stop Work Order" and "Stop Work Order Release" will be incurred if the procedure is not followed as stated below.

A Pre-construction Meeting will take place upon receipt of your building permit.

 X Final inspection required at completion of work.

Certificate of Occupancy is not required for certain projects. Your inspector can advise you if your project requires a Certificate of Occupancy. All projects DO require a final inspection.

If any of the inspections do not occur, the project cannot go on to the next phase, REGARDLESS OF THE NOTICE OR CIRCUMSTANCES.

CERIFICATE OF OCCUPANICES MUST BE ISSUED AND PAID FOR, BEFORE THE SPACE MAY BE OCCUPIED.

Signature of Applicant/Designee

Date

Signature of Inspections Official

Date

PERMIT ISSUED

DEC 1 2009

City of Portland



Signage/Awning Permit Application

If you or the property owner owes real estate or personal property taxes or user charges on any property within the City, payment arrangements must be made before permits of any kind are accepted.

Location/Address of Construction: <u>125 Auburn St.</u>		
Tax Assessor's Chart, Block & Lot Chart# Block# Lot#	Owner: <u>125 Auburn St. LLC</u> <u>c/o Winslow Property Mngt.</u>	Telephone: <u>(781) 674-2020</u>
Lessee/Buyer's Name (If Applicable) <u>HER Block</u>	Contractor name, address & telephone: <u>Bailey Sign, Inc</u> <u>9 Thomas Dr.</u> <u>Westbrook, ME 04092</u> <u>(207) 774-2843</u>	Total s.f. of signage x \$2.00 Per s.f. plus \$30.00/\$65.00 For H.D. signage = Total Fee: \$ <u>78</u> <u>24 sq ft</u> Awning Fee = cost of work _____ Total Fee: \$ _____
Who should we contact when the permit is ready: <u>Deanna@BaileySign</u> phone: <u>7742843 x115</u>		
Tenant/allocated building space frontage (feet): Length: <u>80'-</u> Height: <u>16'-</u> Lot Frontage (feet) <u>110'-</u> Single Tenant or Multi Tenant Lot <u>Single</u>		
Current Specific use: <u>Offices</u> If vacant, what was prior use: <u>Mercy Hospital Annex, Garisours before that</u> Proposed Use: _____		
Information on proposed sign(s): Freestanding (e.g., pole) sign? Yes <input checked="" type="checkbox"/> No <input type="checkbox"/> Dimensions proposed: <u>3'x8'</u> Height from grade: <u>7'3"</u> Bldg. wall sign? (attached to bldg) Yes <input type="checkbox"/> No <input checked="" type="checkbox"/> Dimensions proposed: _____		
Proposed awning? Yes <input type="checkbox"/> No <input checked="" type="checkbox"/> Is awning backlit? Yes <input type="checkbox"/> No <input type="checkbox"/> Height of awning: _____ Length of awning: _____ Depth: _____ Is there any communication, message, trademark or symbol on it? Yes <input type="checkbox"/> No <input type="checkbox"/> If yes, total s.f. of panels w/communications, message, trademark or symbol: _____ s.f.		
Information on existing and previously permitted sign(s): Freestanding (e.g., pole) sign? Yes <input type="checkbox"/> No <input checked="" type="checkbox"/> Dimensions: _____ Bldg. wall sign? (attached to bldg) Yes <input type="checkbox"/> No <input checked="" type="checkbox"/> Dimensions: _____ Awning? Yes <input type="checkbox"/> No <input type="checkbox"/> Sq. ft. area of awning w/communication: _____		
A site sketch and building sketch showing exactly where existing and new signage is located must be provided. Sketches and/or pictures of proposed signage and existing building are also required.		

RECEIVED

NOV 12 2009

Dept. of Building Inspections
City of Portland Maine

Please submit all of the information outlined in the Sign/Awning Application Checklist.
Failure to do so may result in the automatic denial of your permit.

In order to be sure the City fully understands the full scope of the project, the Planning and Development Department may request additional information prior to the issuance of a permit. For further information visit us on-line at www.portlandmaine.gov, stop by the Building Inspections office, room 315 City Hall or call 874-8703.

I hereby certify that I am the Owner of record of the named property, or that the owner of record authorizes the proposed work and that I have been authorized by the owner to make this application as his/her authorized agent. I agree to conform to all applicable laws of this jurisdiction. In addition, if a permit for work described in this application is issued, I certify that the Code Official's authorized representative shall have the authority to enter all areas covered by this permit at any reasonable hour to enforce the provisions of the codes applicable to this permit.

Signature of applicant:

Deanna Emery / Bailey Sign Inc.

Date:

11-10-09

RP zone

max area 300
max height 8'
setback 5'

This is not a permit; you may not commence ANY work until the permit is issued.

proposed 3' x 8' = 24 sq ft
" 7'3" (OK)



Signage/Awning Permit Application Checklist

All of the following information is required and must be submitted. Checking off each item as you prepare your application package will ensure your package is complete and will help to expedite the permitting process.

- Certificate of Liability listing the City as additional insured if any portion of the sign abuts or encroaches on any public right of way, or can fall into any public right of way.
- Letter of permission from the owner indicating the permissions granted and the tenant/space building frontage.
- A sketch plan of lot indicating location of buildings, driveways and any abutting streets or rights of way, lengths of building frontages, street frontages and all existing setbacks. Please indicate on the plan all existing and proposed signs with their dimensions and specific locations. Be sure to include distance from the ground and building façade dimensions for any signage attached to the building.
- A sketch or photo of any proposed sign(s) indicating content, dimensions, materials, source of illumination, construction method as well as specifics of installation/attachment.
- Certificate of flammability required for awning or canopy. *n/a*
- A UL# is required for lighted signs at the time of final inspection.
- Pre-application questionnaire completed and attached.
- Photos of existing signage *- No longer there*
- Details for sign fastening, attachment or mounting in the ground. *- Single steel pole Direct set 4' Deep*

Permit fee for signage or awning-with-signage: \$30.00 plus \$2.00 per square foot of sign.

Permit fee for awning-without-signage is based on cost of work:
\$30.00 for the first \$1,000.00, \$10.00 per additional \$1,000.00 of cost.

Base application fee for any Historic District signage is \$65.00.

NOV 23 2018

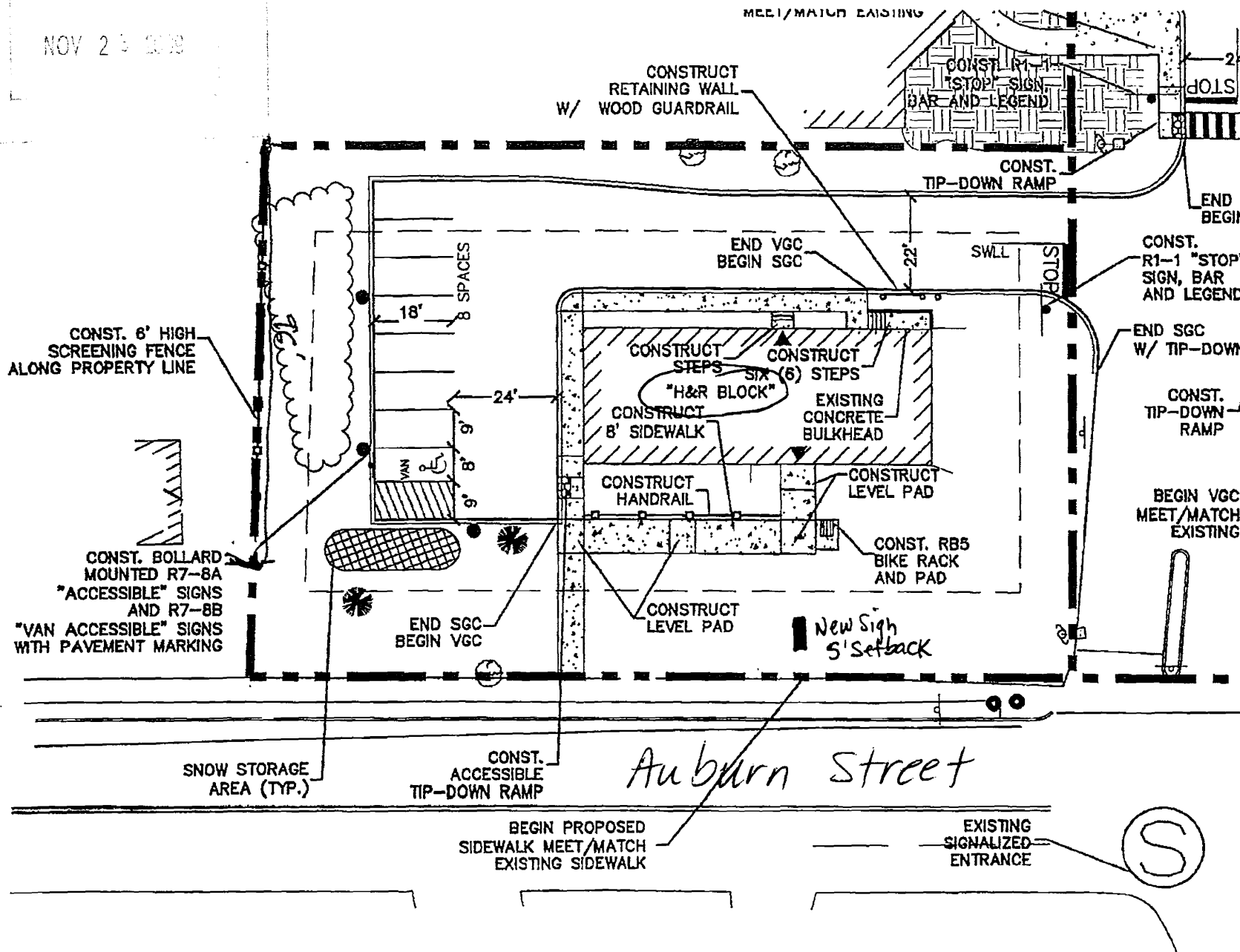

WRITTEN CONSENT AND AGREEMENT relating to a certain sign(s) proposed to be erected at/on a

building located at 125 AUBURN ST in PORTLAND, ME.
(Street Address) (City & State)

125 AUBURN ST, LLC being the owner of the premises hereby
(Property Owner)

gives consent to the erection of a certain sign(s) by Bailey Sign, Inc. of Westbrook, ME.

In witness whereof, the owner of said premises has signed this consent and agreement this

10TH day of NOVEMBER, 2009.
(Day) (Month) (Year)

[Signature] Agent 125 [Signature]
(Property Owner) Auburn ST, LLC (Witness)

JONATHAN SMITH DEBORAH LOZIER
print print

ACORD CERTIFICATE OF LIABILITY INSURANCE		OP ID SG 125AU-1	DATE (MM/DD/YYYY) 11/09/09
PRODUCER NorthStar Ins. Services, Inc. 300 First Ave, Suite 100 Needham MA 02494 Phone: 781-431-2500 Fax: 781-431-6134		THIS CERTIFICATE IS ISSUED AS A MATTER OF INFORMATION ONLY AND CONFERS NO RIGHTS UPON THE CERTIFICATE HOLDER. THIS CERTIFICATE DOES NOT AMEND, EXTEND OR ALTER THE COVERAGE AFFORDED BY THE POLICIES BELOW.	
INSURED 125 Auburn Street LLC Frank Normandin 5 Militia Dr. Lexington MA 02421		INSURERS AFFORDING COVERAGE	NAIC #
		INSURER A: OneBeacon Insurance	21970
		INSURER B:	
		INSURER C:	
		INSURER D:	
		INSURER E:	

COVERAGES

THE POLICIES OF INSURANCE LISTED BELOW HAVE BEEN ISSUED TO THE INSURED NAMED ABOVE FOR THE POLICY PERIOD INDICATED. NOTWITHSTANDING ANY REQUIREMENT, TERM OR CONDITION OF ANY CONTRACT OR OTHER DOCUMENT WITH RESPECT TO WHICH THIS CERTIFICATE MAY BE ISSUED OR MAY PERTAIN, THE INSURANCE AFFORDED BY THE POLICIES DESCRIBED HEREIN IS SUBJECT TO ALL THE TERMS, EXCLUSIONS AND CONDITIONS OF SUCH POLICIES. AGGREGATE LIMITS SHOWN MAY HAVE BEEN REDUCED BY PAID CLAIMS.

INSR LTR	ADD'L INSRD	TYPE OF INSURANCE	POLICY NUMBER	POLICY EFFECTIVE DATE (MM/DD/YY)	POLICY EXPIRATION DATE (MM/DD/YY)	LIMITS	
A		GENERAL LIABILITY <input checked="" type="checkbox"/> COMMERCIAL GENERAL LIABILITY <input type="checkbox"/> CLAIMS MADE <input type="checkbox"/> OCCUR GEN'L AGGREGATE LIMIT APPLIES PER: <input type="checkbox"/> POLICY <input type="checkbox"/> PRO-JECT <input type="checkbox"/> LOC	7900074300000	06/12/09	12/12/09	EACH OCCURRENCE	\$ 1,000,000
						DAMAGE TO RENTED PREMISES (Ea occurrence)	\$ 300,000
						MED EXP (Any one person)	\$ 10,000
						PERSONAL & ADV INJURY	\$ 1,000,000
						GENERAL AGGREGATE	\$ 2,000,000
						PRODUCTS - COMP/OP AGG	\$ 2,000,000
						Emp Ben.	1,000,000
		AUTOMOBILE LIABILITY <input type="checkbox"/> ANY AUTO <input type="checkbox"/> ALL OWNED AUTOS <input type="checkbox"/> SCHEDULED AUTOS <input type="checkbox"/> HIRED AUTOS <input type="checkbox"/> NON-OWNED AUTOS				COMBINED SINGLE LIMIT (Ea accident)	\$
						BODILY INJURY (Per person)	\$
						BODILY INJURY (Per accident)	\$
						PROPERTY DAMAGE (Per accident)	\$
		GARAGE LIABILITY <input type="checkbox"/> ANY AUTO				AUTO ONLY - EA ACCIDENT	\$
						OTHER THAN EA ACC	\$
						AUTO ONLY: AGG	\$
		EXCESS/UMBRELLA LIABILITY <input type="checkbox"/> OCCUR <input type="checkbox"/> CLAIMS MADE DEDUCTIBLE RETENTION \$				EACH OCCURRENCE	\$
						AGGREGATE	\$
							\$
							\$
							\$
		WORKERS COMPENSATION AND EMPLOYERS' LIABILITY ANY PROPRIETOR/PARTNER/EXECUTIVE OFFICER/MEMBER EXCLUDED? If yes, describe under SPECIAL PROVISIONS below				WC STATU-TORY LIMITS	OTH-ER
						E.L. EACH ACCIDENT	\$
						E.L. DISEASE - EA EMPLOYEE	\$
						E.L. DISEASE - POLICY LIMIT	\$
		OTHER					
DESCRIPTION OF OPERATIONS / LOCATIONS / VEHICLES / EXCLUSIONS ADDED BY ENDORSEMENT / SPECIAL PROVISIONS City of Portland is included as additional insured as required by written contract with respect to general liability with regard to work performed by 125 Auburn Street, LLC.							

CERTIFICATE HOLDER PORTLA3 City of Portland 389 Congress Street Portland ME 04101	CANCELLATION SHOULD ANY OF THE ABOVE DESCRIBED POLICIES BE CANCELLED BEFORE THE EXPIRATION DATE THEREOF, THE ISSUING INSURER WILL ENDEAVOR TO MAIL <u>10</u> DAYS WRITTEN NOTICE TO THE CERTIFICATE HOLDER NAMED TO THE LEFT, BUT FAILURE TO DO SO SHALL IMPOSE NO OBLIGATION OR LIABILITY OF ANY KIND UPON THE INSURER, ITS AGENTS OR REPRESENTATIVES. AUTHORIZED REPRESENTATIVE Joseph Flynn
--	---

FREESTANDING PYLON OPTION A



H&R BLOCK
BUILDING

NORTHGATE SHOPPING CTR
PARKING

NEW D.F.
FREESTANDING SIGN

AUBURN STREET

(1) D.F. 3'-0" X 8'-0" INTERNALLY ILLUMINATED SIGN CABINET

CABINET AND 1 1/2" RETAINER: BLACK
FACE: WHITE LEXAN
B/G: 3M TRANS 3630-22 BLACK VINYL
LOGO SYMBOL: 3M TRANS 3630-106 BRILLIANT GREEN VINYL
LOGOTYPE: WHITE

6"

3" X 93" METAL REVEAL T.B.C. MP55840 GREY

4' X 8' METAL WRAP: BLACK

ADDRESS COPY: 3M OPAQUE WHITE VINYL

NOTES

PLEASE NOTE:

THIS IS A PROGRESS PRINT - FIELD MEASUREMENTS MAY OR MAY NOT NEED TO BE VERIFIED.

THIS DESIGN IS THE EXCLUSIVE PROPERTY OF BAILEY SIGN INCORPORATED AND ALL RIGHTS TO ITS USE OR REPRODUCTION ARE RESERVED.

THE ACCURACY OF THIS COLOR RENDERING IS LIMITED BY MEDIA AND OUTPUT DEVICES AND IS INTENDED FOR REPRESENTATIONAL USE ONLY. ACTUAL MANUFACTURING GRAPHIC COLORS ALSO VARY DEPENDING ON PROCESSES & MATERIALS USED. 100% COLOR MATCHES OF SUBMITTED SPECIFICATIONS CAN NOT BE GUARANTEED.

IF AN ELECTRIC SIGN, THEN INSTALLATION MUST BE ACCOMPLISHED IN TOTAL COMPLIANCE WITH ARTICLE 600 OF THE NATIONAL ELECTRIC CODE, THE REQUIREMENTS OF UNDERWRITERS LABORATORY CANADIAN STANDARDS ASSOCIATION AND/OR ANY APPLICABLE LOCAL CODES. THIS INCLUDES PROPER GROUNDING AND BONDING OF THE SIGN.

ALL ELECTRICAL SIGNS REQUIRE ROUTINE MAINTENANCE.

CLIENT

ACCEPTANCE SIGNATURE _____ DATE _____

BAILEY SIGN SALES REPRESENTATIVE

APPROVED _____ DATE _____

www.baileysign.com
9 Thomas Drive
Col. Westbrook Executive Park
Westbrook, ME 04092
207-774-2843 / 1-800-539-SIGN
Fax: 774-1193
E-Mail: sales@baileysign.com
© COPYRIGHT 2009

CUSTOMER / SIGN LOCATION

H&R BLOCK

NORTHGATE SHOPPING CENTER
PORTLAND, MAINE

SALESPERSON: _____ DRAWN BY: LWM

PS. # _____ W.O. # _____

SCALE 3/4" = 1' DATE 11/2/09

REVISION # / DATE / NOTES / INITIALS

R1 11/9/09 ADD PLOT PLAN



DRAWING #

06314 AA R1

SHEET _____ OF _____