

Location of Construction: 9-11 Sanborn Street		Owner: Robert A. DeRice		Phone: 878-3100		Permit No: <b>960383</b>
Owner Address:		Leasee/Buyer's Name:		Phone:		
Contractor Name: Glen Leo		Address:		Phone:		<b>PERMIT ISSUED</b> Permit Issued: <b>MAY 15 1996</b> <b>CITY OF PORTLAND</b>
Past Use: Office w/sign		Proposed Use: Same w/new signage		COST OF WORK: \$ PERMIT FEE: \$ 30.98 FIRE DEPT. <input type="checkbox"/> Approved <input type="checkbox"/> Denied INSPECTION: Use Group: Type: Signature: <i>POC 093</i> Signature: <i>[Signature]</i>		
Proposed Project Description:  Erect a 29.88 sq. ft. sign		PEDESTRIAN ACTIVITIES DISTRICT (P.O.D.) Action: Approved <input type="checkbox"/> Approved with Conditions: <input type="checkbox"/> Denied <input type="checkbox"/> Signature: _____ Date: _____		Zoning Approval: <i>OK</i> Special Zone or Reviews: <i>[Signature]</i> <input type="checkbox"/> Shoreland <input type="checkbox"/> Wetland <input type="checkbox"/> Flood Zone <input type="checkbox"/> Subdivision <input type="checkbox"/> Site Plan maj <input type="checkbox"/> minor <input type="checkbox"/> mm <input type="checkbox"/>		Zone: CBL: RP 375-B-8&9 <b>Zoning Appeal</b> <input type="checkbox"/> Variance <input type="checkbox"/> Miscellaneous <input type="checkbox"/> Conditional Use <input type="checkbox"/> Interpretation <input type="checkbox"/> Approved <input type="checkbox"/> Denied <b>Historic Preservation</b> <input type="checkbox"/> Not in District or Landmark <input checked="" type="checkbox"/> Does Not Require Review <input type="checkbox"/> Requires Review <b>Action:</b> <input type="checkbox"/> Approved <input type="checkbox"/> Approved with Conditions <input type="checkbox"/> Denied Date: <i>5/11/96</i>
Permit Taken By: Vicki Dover		Date Applied For: May 8, 1996				

1. This permit application doesn't preclude the Applicant(s) from meeting applicable State and Federal rules.
2. Building permits do not include plumbing, septic or electrical work.
3. Building permits are void if work is not started within six (6) months of the date of issuance. False information may invalidate a building permit and stop all work..

Mail to: R. DeRice  
222 Auburn St.  
Portland 04103

**CERTIFICATION**

I hereby certify that I am the owner of record of the named property, or that the proposed work is authorized by the owner of record and that I have been authorized by the owner to make this application as his authorized agent and I agree to conform to all applicable laws of this jurisdiction. In addition, if a permit for work described in the application issued, I certify that the code official's authorized representative shall have the authority to enter all areas covered by such permit at any reasonable hour to enforce the provisions of the code(s) applicable to such permit

*Robert A. DeRice*  
 SIGNATURE OF APPLICANT Robert A. DeRice ADDRESS: 222 Auburn St. Portland 04103 DATE: 5/8/96 PHONE: 878-3100

RESPONSIBLE PERSON IN CHARGE OF WORK, TITLE PHONE:

White-Permit Desk Green-Assessor's Canary-D.P.W. Pink-Public File Ivory Card-Inspector

CEO DISTRICT **7**  
*D. Jordan*

Location of Construction: 9-11 Saaborn Street		Owner: Robert A. DeRice		Phone: 678-3100		Permit No: <b>960383</b>	
Owner Address:		Leasee/Buyer's Name:		Phone:		BusinessName:	
Contractor Name: Glen Leo		Address:		Phone:		<div style="border: 2px solid black; padding: 5px; text-align: center;"> <b>PERMIT ISSUED</b>                  Permit Issued:  <b>MAY 15 1996</b>  <b>CITY OF PORTLAND</b> </div>	
Past Use: Office w/sign		Proposed Use: Same w/new signage		COST OF WORK: \$ _____ PERMIT FEE: \$30.98			
Proposed Project Description: Erect a 29.88 sq. ft. sign		Signature:		Signature:		Zoning Approval: Zone: CBL: RP 375-B-869	
		PEDESTRIAN ACTIVITIES DISTRICT (P.U.D.) Action: Approved <input type="checkbox"/> Approved with Conditions: <input type="checkbox"/> Denied <input type="checkbox"/>		Signature:		Special Zone or Reviews: <input type="checkbox"/> Shoreland <input type="checkbox"/> Wetland <input type="checkbox"/> Flood Zone <input type="checkbox"/> Subdivision <input type="checkbox"/> Site Plan maj <input type="checkbox"/> minor <input type="checkbox"/> mm <input type="checkbox"/>	

Permit Taken By: Vicki Dover	Date Applied For: May 8, 1996
---------------------------------	----------------------------------

1. This permit application doesn't preclude the Applicant(s) from meeting applicable State and Federal rules.
2. Building permits do not include plumbing, septic or electrical work.
3. Building permits are void if work is not started within six (6) months of the date of issuance. False information may invalidate a building permit and stop all work..

Mail to: R. DeRice  
222 Auburn St.  
Portland 04103

**CERTIFICATION**

I hereby certify that I am the owner of record of the named property, or that the proposed work is authorized by the owner of record and that I have been authorized by the owner to make this application as his authorized agent and I agree to conform to all applicable laws of this jurisdiction. In addition, if a permit for work described in the application issued, I certify that the code official's authorized representative shall have the authority to enter all areas covered by such permit at any reasonable hour to enforce the provisions of the code(s) applicable to such permit

SIGNATURE OF APPLICANT <i>Robert A. DeRice</i>	ADDRESS: 222 Auburn St. Portland 04103	DATE: 5/8/96	PHONE: 878-3100
---	---	-----------------	--------------------

RESPONSIBLE PERSON IN CHARGE OF WORK, TITLE	PHONE:
---	--------

White-Permit Desk Green-Assessor's Canary-D.P.W. Pink-Public File Ivory Card-Inspector

CEO DISTRICT 7  
D. Jordan

COMMENTS

5-31-96 - Structure is up/new Signage lettering not yet on/ 5' setback appears OK  
6-4-96 Completed Close X

Inspection Record

Type	Date
Foundation: _____	_____
Framing: _____	_____
Plumbing: _____	_____
Final: _____	_____
Other: _____	_____

SIGNAGE

PLEASE ANSWER ALL QUESTIONS

ADDRESS: 9-11 Sanborn St. - Corner of Auburn ZONE: RP

OWNER: Robert A. DeRice

APPLICANT: Robert A. DeRice

ASSESSOR NO.: 375-B-8&9

SINGLE TENANT LOT? YES \_\_\_\_\_ NO

MULTI TENANT LOT? YES  NO \_\_\_\_\_

FREESTANDING SIGN? YES  NO \_\_\_\_\_  
(ex. pole sign..)

MORE THAN ONE SIGN? YES \_\_\_\_\_ NO

BLDG. WALL SIGN? YES  NO   
(attached to bldg)

MORE THAN ONE SIGN? YES \_\_\_\_\_ NO

LIST ALL EXISTING SIGNAGE AND THEIR DIMENSIONS:

2 - 12" x 70"

LOT FRONTAGE (FEET) 230'

BLDG FRONTAGE (FEET) 112'

AWNING YES \_\_\_\_\_ NO  IS AWNING BACKLIT? YES \_\_\_\_\_ NO \_\_\_\_\_

HEIGHT OF AWNING: \_\_\_\_\_

IS THERE ANY COMMUNICATION, MESSAGE, TRADEMARK OR SYMBOL ON IT? \_\_\_\_\_

**A SITE SKETCH AND BUILDING SKETCH SHOWING EXACTLY WHERE EXISTING AND NEW SIGNAGE IS LOCATED MUST BE PROVIDED. SKETCHES AND/OR PICTURES OF THE PROPOSED SIGNS ARE ALSO REQUIRED.**

*Handwritten notes:*  
30' MAX  
0' MAX  
5' setback  
RP Zone req.  
his panel is 18" x 6.66  
TOTAL sign is 4.25' x 6.66' = 28.305'

*Handwritten note:* Existing free standing sign

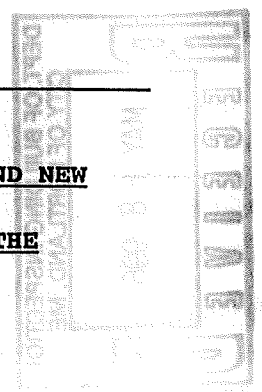

INFORMATION REQUIREMENTS FOR SIGN PERMIT APPLICATION

APPLICANTS FOR A SIGN PERMIT WILL BE ASKED TO SUBMIT THE FOLLOWING INFORMATION TO THE CODE ENFORCEMENT OFFICE:

1. PROOF OF INSURANCE
2. LETTER OF PERMISSION FROM THE OWNER
3. A SKETCH PLAN OF THE LOT, INDICATING LOCATION OF BUILDINGS, DRIVEWAYS AND ANY ABUTTING STREETS OR RIGHT OF WAYS. LENGTHS OF BUILDING FRONTAGES AND STREET FRONTAGES SHOULD BE NOTED (SEE ATTACHED)
4. INDICATE ON THE PLAN ALL EXISTING AND PROPOSED SIGNS
5. COMPUTATION OF THE FOLLOWING:
  - A) SIGN AREA OF EACH EXISTING AND PROPOSED BUILDING SIGN
  - B) SIGN AREA HEIGHT AND SETBACK OF EACH EXISTING AND PROPOSED FREESTANDING SIGN

A SKETCH OF ANY PROPOSED SIGN(S), INDICATING DIMENSIONS, MATERIALS, SOURCE OF ILLUMINATION AND CONSTRUCTION METHOD (SEE ATTACHED)

FEE FOR PERMIT - \$25.00 PLUS \$0.20 PER SQUARE FOOT

NOTE: ONCE A SKETCH PLAN HAS BEEN FILED FOR A PROPERTY, THE CODE ENFORCEMENT OFFICE WILL KEEP A RECORD OF THE PLAN SO THAT A NEW SKETCH PLAN WILL NOT BE REQUIRED FOR LATER CHANGES TO SIGNAGE ON THE PROPERTY. IN SUCH AN INSTANCE, APPLICANTS WILL ONLY BE REQUIRED TO SUBMIT INFORMATION APPLICABLE TO THE NEW SIGNS.

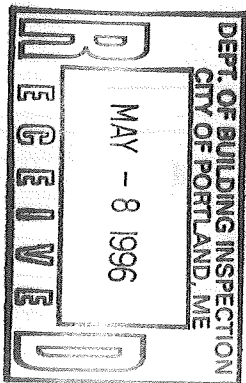

Panel

A

9-11 Sanborn Street

B

18"

Portland North Dental Associates  
**R. DeRice DMD P. LeBourdais DMD**  
*Family, Cosmetic and Reconstructive Dentistry*

C

11"

**Charles G. Drew - Orthodontist**

D

11"

**North Deering Beauty Salon**

E

11"

Blank for now

all panels 6'8" wide

6.66'

4,25' x 6.66' =  
28,305 #

4.25'

81'

Auburn Street

9-11 Sanborn St

Existing & proposed  
Sign location

149'

Drive

Sanborn Street

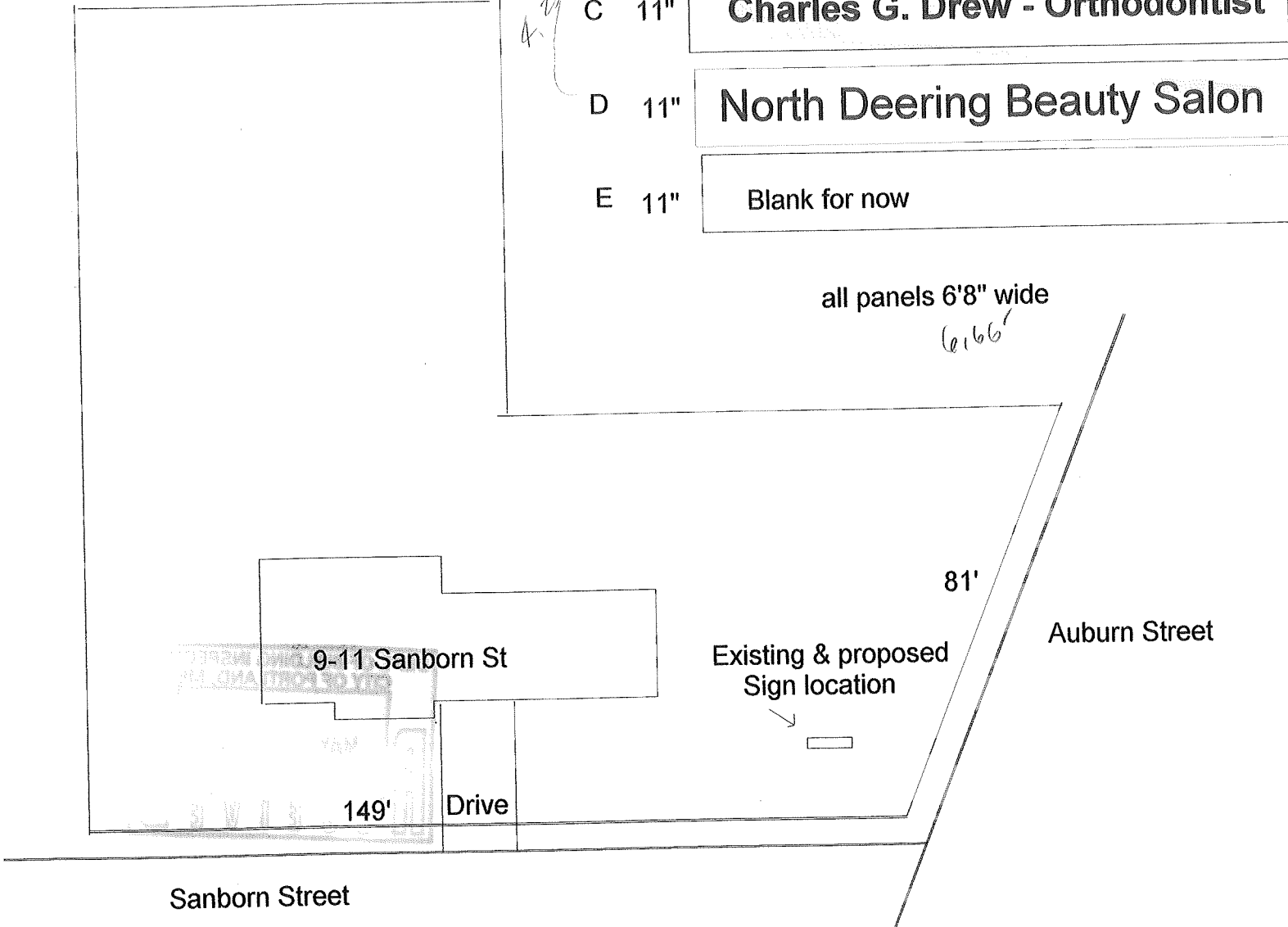

CONTINENTAL CASUALTY COMPANY



For All the Commitments You Make®

CNA Insurance Companies  
CNA Plaza  
Chicago, Illinois 60685

018462  
PRODUCER NUMBER

039717  
ST. ADM. NUMBER  
(95) 0481-33-45  
POLICY NUMBER

CHANGE AND ATTACHING CLAUSE ENDORSEMENT

Named Insured	ROBERT A DERICE DMD	Inception Date	07/08/95	Expiration Date	07/08/96
And Mailing Address	222 AUBURN STREET PORTLAND ME 04103	Endorsement Effective Date	03/08/96		

THIS POLICY IS AMENDED TO ADD THE FOLLOWING:

LOCATION NO. 2 9 SANBORN STREET  
PORTLAND, ME 04103

BUILDING INSURANCE	LIMIT \$ 250,000
RENTS	LIMIT \$ 55,800

INFLATION GUARD

IN CONSIDERATION OF AN ADDITIONAL PREMIUM OF \$ 2.00, IT IS AGREED THAT THE BUILDING INFLATION GUARD ON LOCATION NUMBER 2 IS AMENDED AS STATED BELOW :

.5 %

TOTAL ADDITIONAL PREMIUM

\$ 261.00

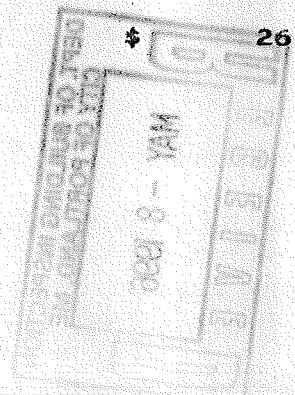

National Administrator, Name and Address

Countersignature

POE & BROWN, INC.  
P.O. BOX 3268  
TAMPA, FL. 33601-3268

By: *Leta L. Bryant*  
Authorized Representative

Acct. No. 04813345

Issue Date: 03/07/96

Materials:

Oak Frame - Painted light gray

Plexiglass signs - white with blue letters

Source of Illumination - internal fluorescent tubes - 5 @ 6 ft. 40 watts  
1 @ 30" 20 watts

TOTAL SIGN AREA 29.88 SQ FT.

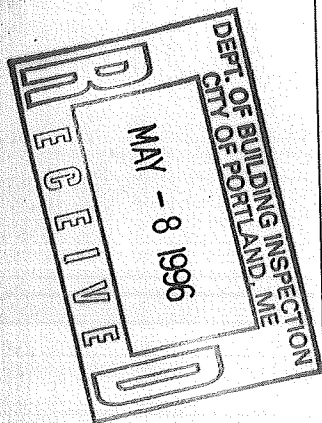
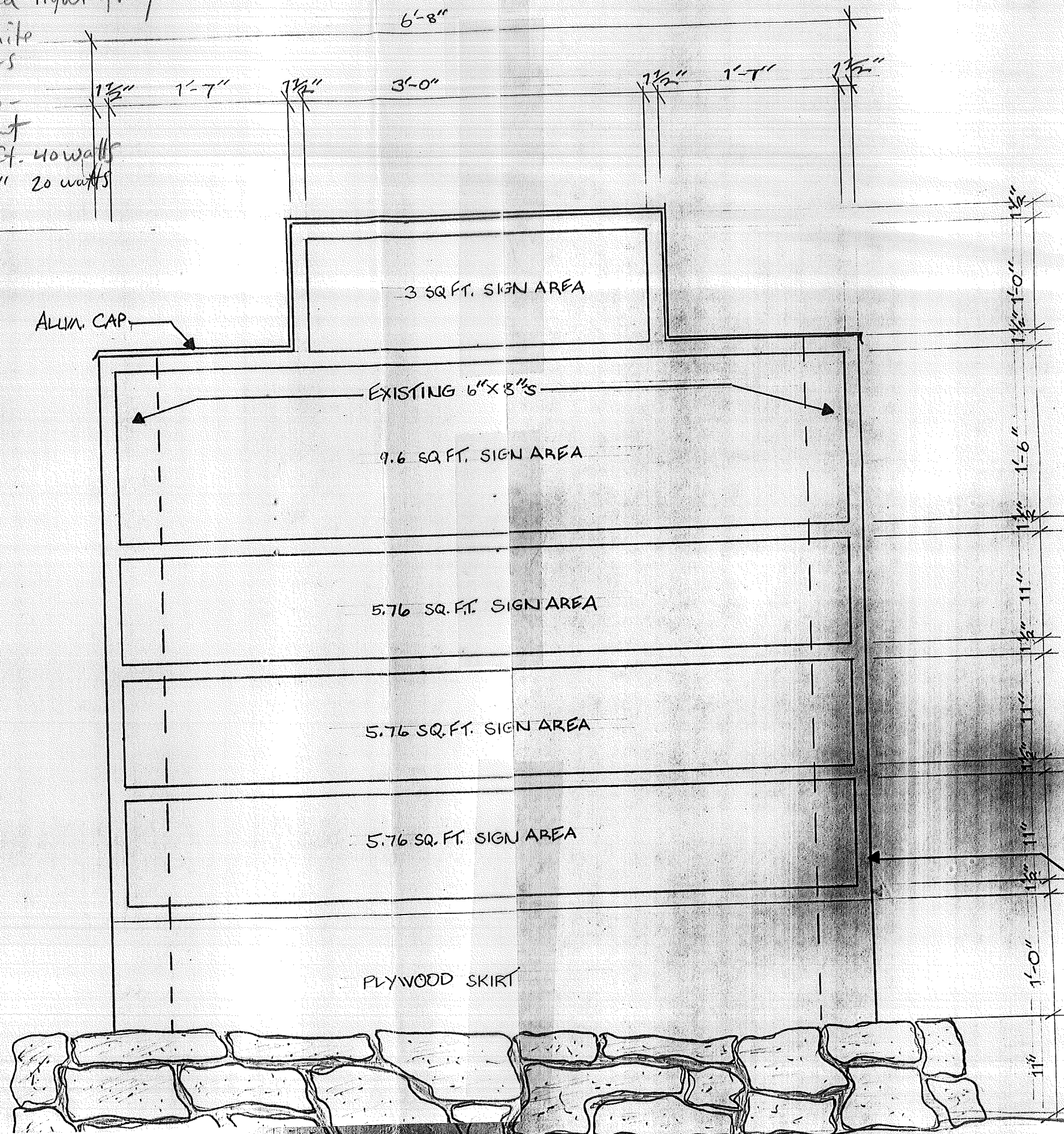

EXISTING GRADE

OAK NOTE: 1 1/2" WIDE PAINTED