

Critical Access Ramp Program Installation Form

CONTINUATION SHEET, PAGE 2

RE: Evelyn A. MURPHY, 72 Croquet Lane, Portland, Maine 04103

DATE: March 29, 2013

APARTMENT UNITS

APARTMENT UNITS

APARTMENT UNITS

APARTMENT UNITS

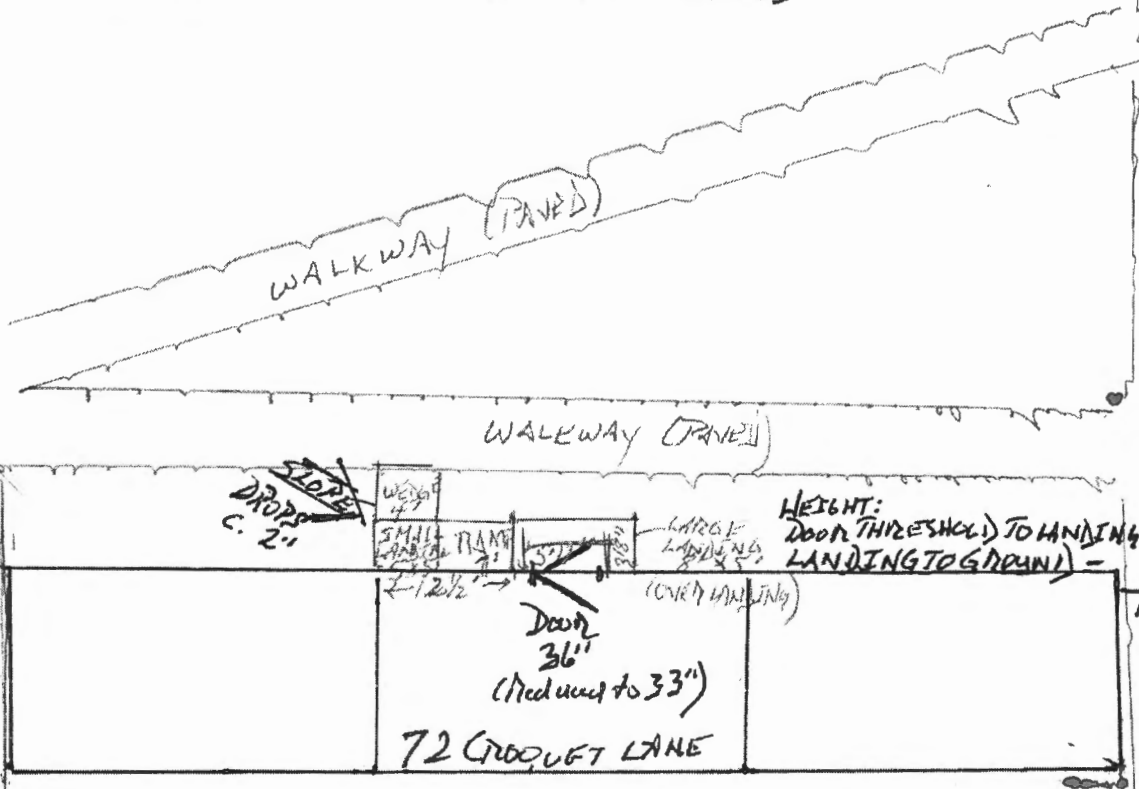

← 3 APARTMENTS →

COMPONENTS SUGGESTED:

- Long Ramp (7' built on side) - (1)
- Large landing (8' x 5' from inventory) - (1)
- Small landing (5' x 5' built on site) - (1)
- Wedge (4' built on site) - (1)

PARKING

CROQUET LANE