



GRASER RESIDENCE  
1691 WASHINGTON AVENUE  
PORTLAND, MAINE



93 Pitt Street  
Portland, Maine 04103  
207.747.5975 voice/fax

822 Grover Hill Rd.  
Bethel, ME 04217  
207.824.7237 voice/fax

info@smithreuter.com

PROPOSED  
FIRST FLOOR PLAN

3-2-16 | 284-1

A1.3

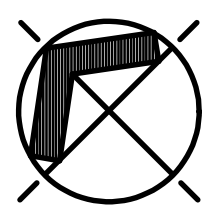
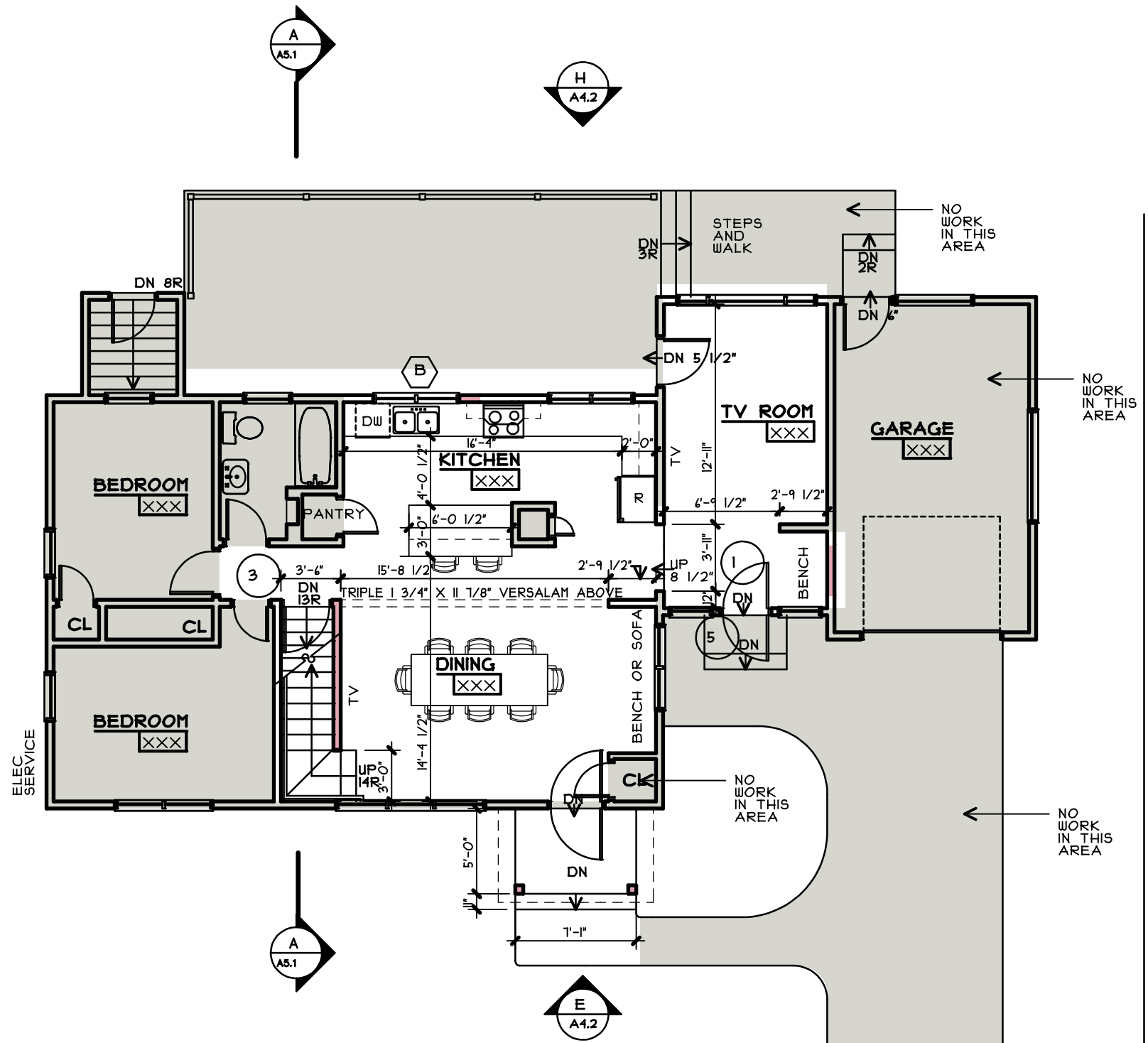

# PROPOSED FIRST FLOOR PLAN

EXISTING WALLS  
NEW WALLS  
1/8" = 1'-0"