

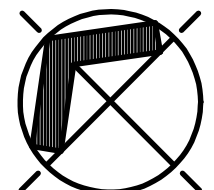

GRASER RESIDENCE
1691 WASHINGTON AVENUE
PORTLAND, MAINE

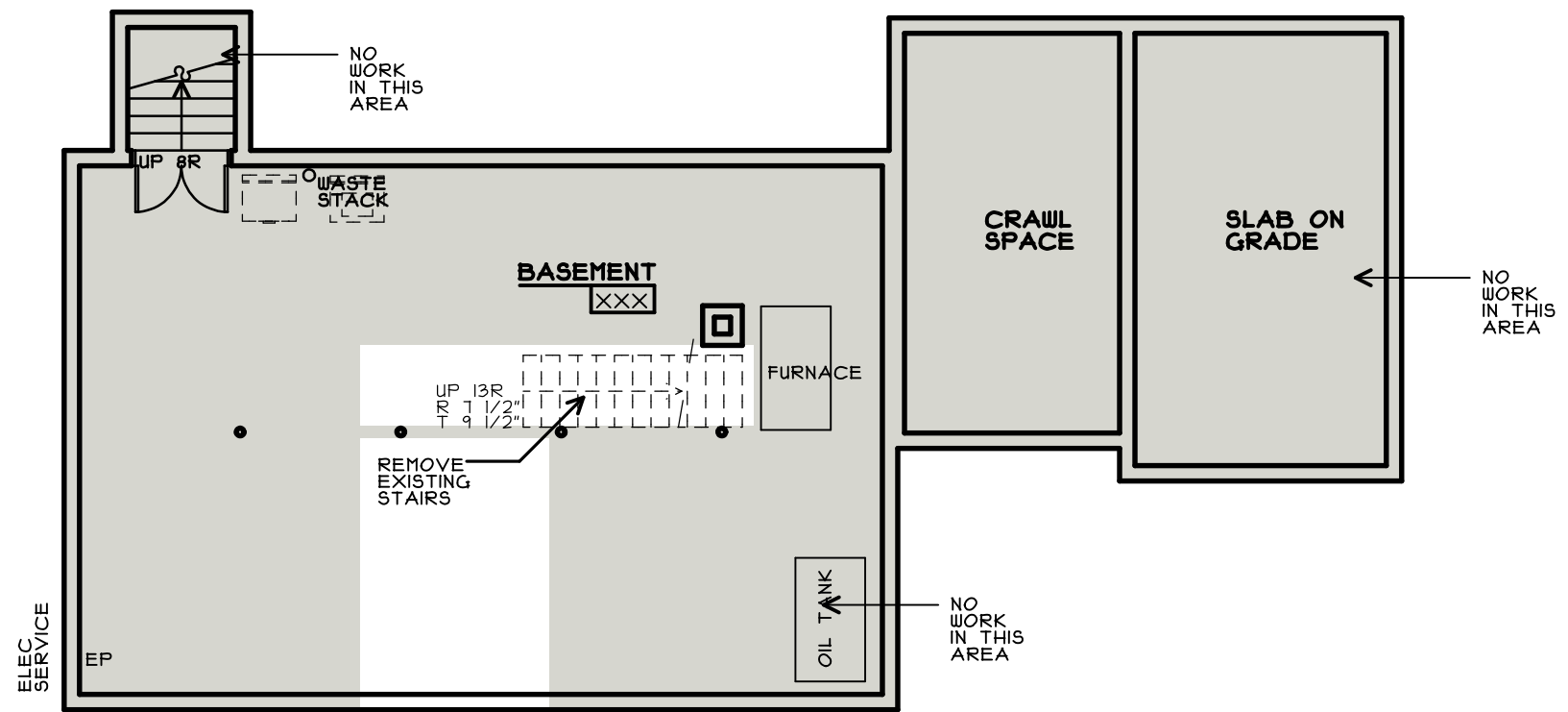

EXISTING BASEMENT PLAN

1/8" = 1'-0"



93 Pitt Street
Portland, Maine 04103
207.747.5975 voice/fax
822 Grover Hill Rd.
Bethel, ME 04217
207.824.7237 voice/fax
info@smithreuter.com

EXISTING
BASEMENT PLAN

3-2-16 | 284-1

A1.0