

**Littlefield
5 Wakely Court
Portland**

Second Floor Finish

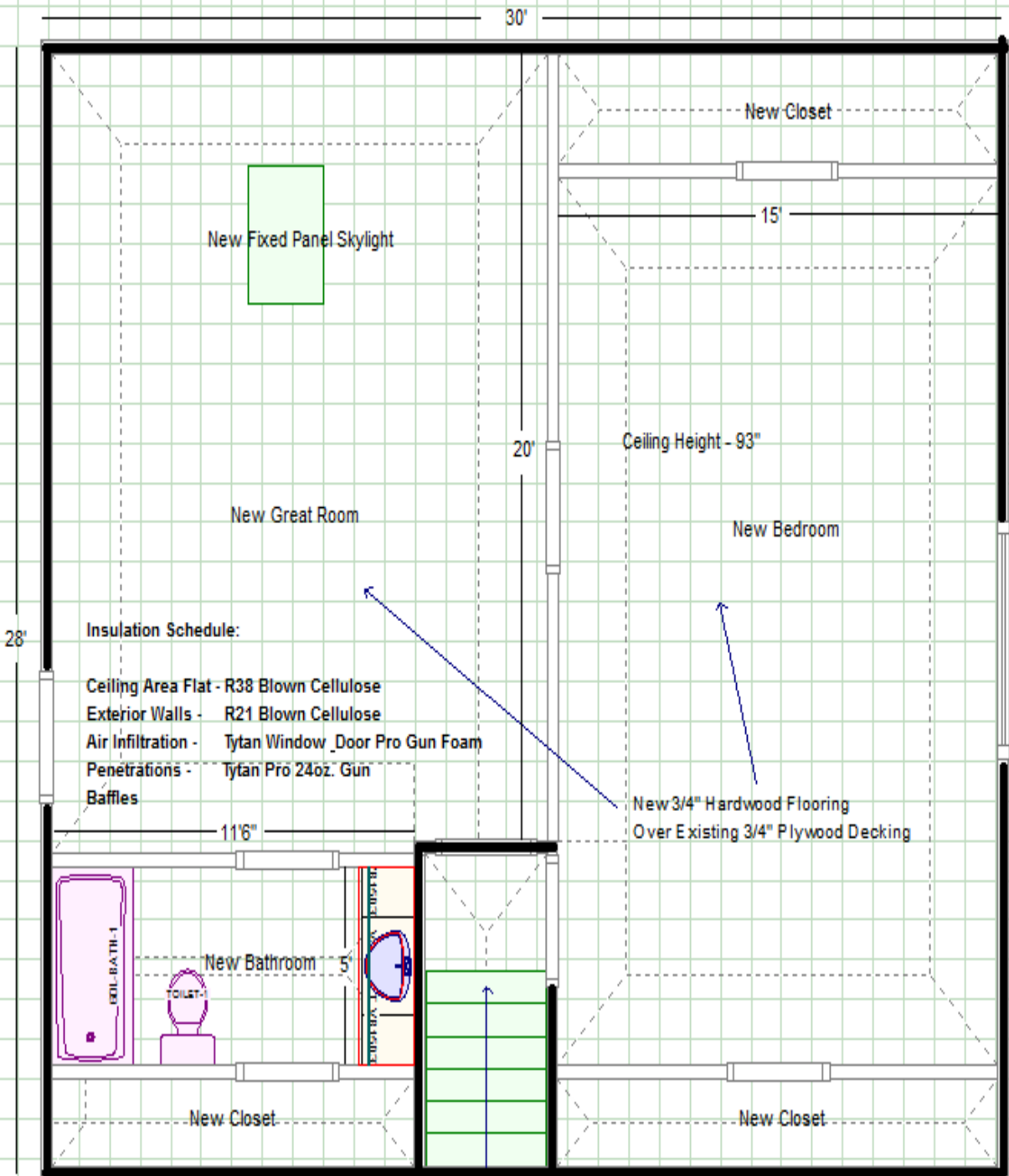

Insulation Schedule:

- Ceiling Area Flat - R38 Blown Cellulose
- Exterior Walls - R21 Blown Cellulose
- Air Infiltration - Tytan Window_Door Pro Gun Foam
- Penetrations - Tytan Pro 24oz. Gun Baffles

New Double Casement
Tempered Glass
Egress Window

New Interior Wall Framing:
Typical 2"x 4" - 24" OC

Wall and Ceiling Covering:
1/2" Drywall

New Interior Doors:
2'6" - 6 Panel Hollow Core

- Existing Walls
- New Walls