



Administrative Authorization Application

Portland, Maine

Planning and Urban Development Department, Planning Division

PROJECT NAME: _____

PROJECT ADDRESS: 12 Quaker Lane, Portland ME CHART/BLOCK/LOT: 372-A-60

APPLICATION FEE: _____ (\$50.00)

PROJECT DESCRIPTION: (Please Attach Sketch/Plan of the Proposal/Development)

replace & enlarge deck

CONTACT INFORMATION:

OWNER/APPLICANT

Name: Robert L. Webster
Address: 12 Quaker Lane
Portland, ME 04103
Work #: _____
Cell #: 207-809-9695
Fax #: _____
Home #: _____
E-mail: blwebby@yahoo.com

CONSULTANT/AGENT

Name: _____
Address: _____
Work #: _____
Cell #: _____
Fax #: _____
Home #: _____
E-mail: _____

Criteria for an Administrative Authorizations:
(see section 14-523(4) on pg .2 of this appl.)

Applicant's Assessment Planning Division
Y(yes), N(no), N/A

Y(yes), N(no), N/A

- a) Is the proposal within existing structures? _____
- b) Are there any new buildings, additions, or demolitions? _____
- c) Is the footprint increase less than 500 sq. ft.? Y
- d) Are there any new curb cuts, driveways or parking areas? N
- e) Are the curbs and sidewalks in sound condition? Y
- f) Do the curbs and sidewalks comply with ADA? _____
- g) Is there any additional parking? _____
- h) Is there an increase in traffic? N
- i) Are there any known stormwater problems? N
- j) Does sufficient property screening exist? Y
- k) Are there adequate utilities? Y
- l) Are there any zoning violations? N
- m) Is an emergency generator located to minimize noise? N
- n) Are there any noise, vibration, glare, fumes or other impacts? N

N
expanding deck
yes
N
Y
N/A
N
N
N
N
Y
N
N/A
N/A

Signature of Applicant: _____

Date: _____

Planning Division Use Only

Authorization Granted _____ Partial Exemption _____ Exemption Denied _____

Standard Condition of Approval: The applicant shall obtain all required City Permits, including building permits from the Inspection Division (Room 315, City Hall (874-8703)) prior to the start of any construction.

IMPORTANT NOTICE TO APPLICANT: The granting of an Administrative Authorization to exempt a development from site plan review does not exempt this proposal from other approvals or permits, nor is it an authorization for construction. You should first check with the Building Inspections Office, Room 315, City Hall (207)874-8703, to determine what other City permits, such as a building permit, will be required.

**PROVISION OF PORTLAND CITY CODE
14-523 (SITE PLAN ORDINANCE)
RE: Administrative Authorization**

Sec. 14-523 (b). Applicability

No person shall undertake any development identified in Section 14-523 without obtaining a site plan improvement permit under this article. (c) Administrative Authorization. Administrative Authorization means the Planning Authority may grant administrative authorization to exempt a development proposal from complete or partial site plan review that meets the standards below, as demonstrated by the applicant.

1. The proposed development will be located within existing structures, and there will be no new buildings, demolitions, or building additions other than those permitted by subsection b of this section;
2. Any building addition shall have a new building footprint expansion of less than five hundred (500) square feet;
3. The proposed site plan does not add any new curb cuts, driveways, or parking areas; the existing site has no more than one (1) curb cut and will not disrupt the circulation flows and parking on-site; and there will be no drive-through services provided;
4. The curbs and sidewalks adjacent to the lot are complete and in sound condition, as determined by the public works authority, with granite curb with at least four (4) inch reveal, and sidewalks are in good repair with uniform material and level surface and meet accessibility requirements of the Americans with Disabilities Act;
5. The use does not require additional or reduce existing parking, either on or off the site, and the project does not significantly increase traffic generation;
6. There are no known stormwater impacts from the proposed use or any existing deficient conditions of stormwater management on the site;
7. There are no evident deficiencies in existing screening from adjoining properties; and
8. Existing utility connections are adequate to serve the proposed development and there will be no disturbance to or improvements within the public right-of-way.
9. There are no current zoning violations;
10. Any emergency generators are to be located to minimize noise impacts to adjoining properties and documentation that routine testing of the generators occur on weekdays between the hours of 9 a.m. to 5 p.m. Documentation pertaining to the noise impacts of the emergency generator shall be submitted; and
11. There is no anticipated noise, vibration, glare, fumes or other foreseeable impacts associated with the project.

- a. **Filing the Application.** An applicant seeking an administrative authorization under this subsection shall submit an administrative authorization application for review, detailing the site plan with dimensions of proposed improvements and distances from all property lines, and stating that the proposal meets all of the provisions in standards 1-11 of Section 14-423 (b)1. **The application must be accompanied by an application fee of \$50.**
- b. **Review.** Upon receipt of such a complete application, the Planning Authority will process it and render a written decision of approval, approval with conditions or denial, with all associated findings.
- c. **Decision.** If a full administrative authorization is granted, the application shall be approved without further review under this article, and no performance guarantee shall be required. In the event that the Planning Authority determines that standards a and b of Section 14-523 (b) (1) and at least four (4) of the remaining standards have been met, the Planning Authority shall review the site plan according to all applicable review standards of Section 14-526 that are affected by the standards in this subsection that have not been met. If an exemption or partial exemption from site plan review is not granted, the applicant must submit a site plan application that will undergo a full review by the Planning Board or Planning Authority according to the standards of Section 14-526.

Criteria for an Administrative Authorizations:
(See Section 14-523 (4) on page 2 of this application)

Applicant's Assessment
Y(yes), N(no), N/A

Planning Division
Use Only

a) Is the proposal within existing structures?	n/a	no
b) Are there any new buildings, additions, or demolitions?	n/a	Expanding deck
c) Is the footprint increase less than 500 sq. ft.?	Yes	yes
d) Are there any new curb cuts, driveways or parking areas?	No	no
e) Are the curbs and sidewalks in sound condition?	Yes	yes
f) Do the curbs and sidewalks comply with ADA?	n/a	n/a
g) Is there any additional parking?	n/a	no
h) Is there an increase in traffic?	No	no
i) Are there any known stormwater problems?	No	no
j) Does sufficient property screening exist?	Yes	yes
k) Are there adequate utilities?	Yes	yes
l) Are there any zoning violations?	No	no
m) Is an emergency generator located to minimize noise?	No	n/a
n) Are there any noise, vibration, glare, fumes or other impacts?	No	n/a

The Administrative Authorization for 12 Quaker Lane was approved by Barbara Barhydt, Development Review Services Manager on November 25 with the following Standard Condition of Approval listed below:

1. **Standard Condition of Approval:** The applicant shall obtain all required City Permits, including building permits from the Inspection Division (874-8703) and any other permits required from the Department of Public Services (874-8801) prior to the start of any construction.

TVK Construction
Terry V. Keezer
29 Pine St.
Portland, ME 04102
252-7375

Job Description:

1. Contractor to remove existing pressure treated deck and break down the top of existing footings to allow installation of the new deck.
2. Contractor to remove any siding or trim needed to allow proper flashing of deck and save for re-use.
3. Contractor to dig two new 12" sauna tubes and big foot footings and pour with sakrete high strength concrete. *48" below grade; 9' from building, (West Room sides)*
2 max 6x6 stand off
4. Contractor to frame new deck using pressure treated lumber and using grk star head screws for framing fasteners.
1x12 ledger attach w/ 1/2 lag or 5/8" screw
5. Contractor to use joist-hangers along back of house for deck supports.
2x10 headers & joists
6. Contractor to flash new deck using grace ice and water shield and aluminum where needed.
7. Contractor to fasten new deck boards using deck-mate screws for pressure treated or color matched screws if engineered decking is used.
8. Contractor to install new railing with square balusters 42" high and screwed to match the deck. *spaced 4" or less*
stairs - 48" wide 11" tread; 7" riser nosing 3/4" - 1"
9. Contractor to re-install any siding or trim re-moved for deck installation and use new pieces if needed.
10. Contractor to remove all debris created from this project.

Job cost:

Deck #1 framed using 2x8's and decked with pressure treated: \$2,257.00

Deck #2 bigger foot plan and framed with 2x10's: \$2,775.00

Deck #3 bigger foot plan, framed with 2x10's, decked with engineered decking (color picked by customer): \$4,183.00

Top
Webster deck
#12

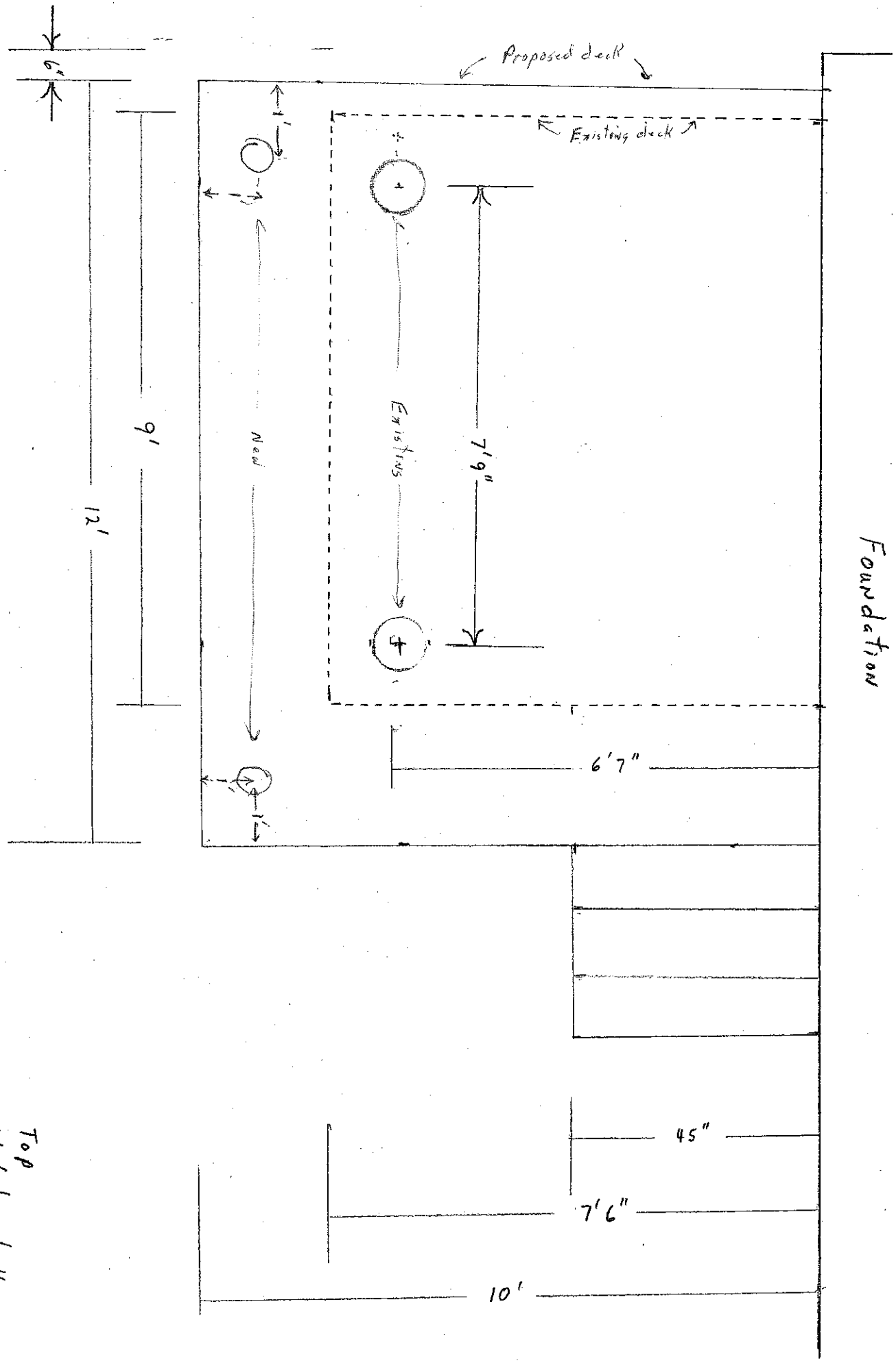

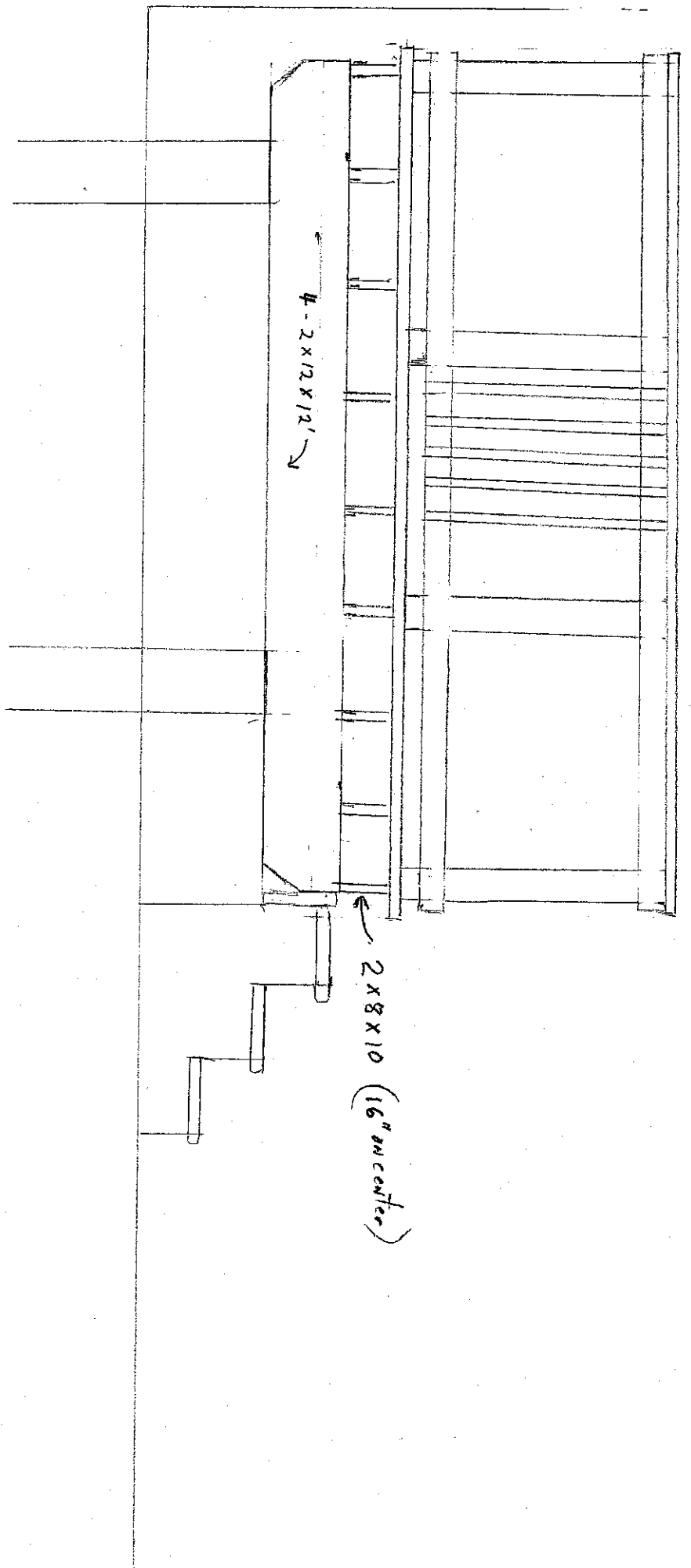

Elevation
Webster deck
#12