

MORTGAGE INSPECTION OF: DEED BOOK 11852 PAGE 213 COUNTY Cumberland
PLAN BOOK --- -PAGE --- LOT ---

ADDRESS: 1863 Washington Avenue, Portland, Maine

Job Number: 839-16

Inspection Date: 02-20-15

Buyers: Harold A. & Marilyn C. McWilliams

Scale: 1" = 50'

Client File #: 2015-024466

Seller: Estate of H. Michael Alpren

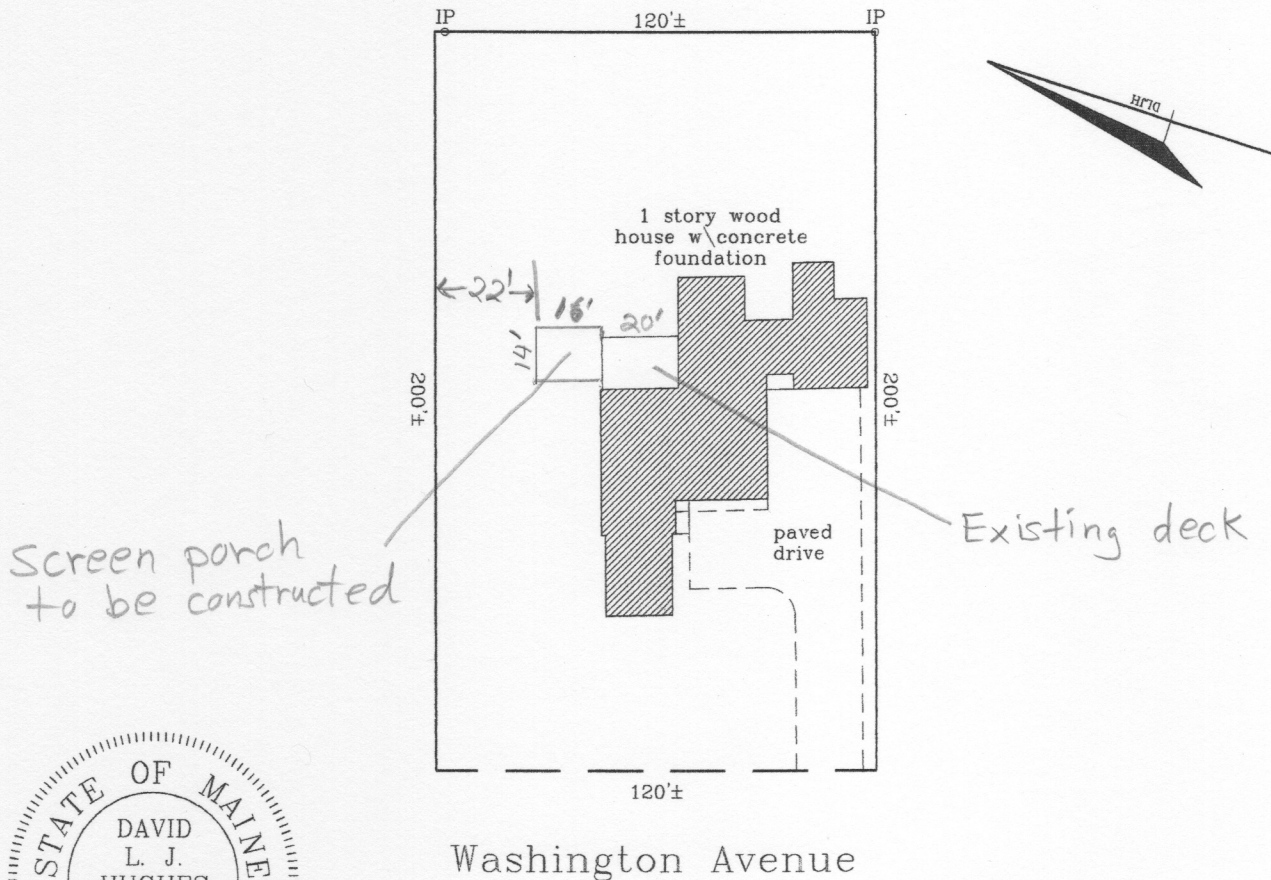

Screen porch to be constructed

Existing deck

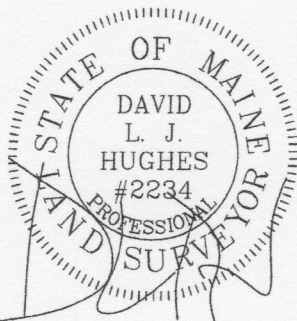

Washington Avenue

I HEREBY CERTIFY TO: Cumberland Title Services, Northeast Bank

APPARENT EASEMENTS AND RIGHTS OF WAY ARE SHOWN. OTHER ENCUMBRANCES, RECORDED OR NOT, MAY EXIST. THIS SKETCH WILL NOT REVEAL ABUTTING DEED CONFLICTS, IF ANY.

- Monuments found did not conflict with the deed description.
- The dwelling setbacks do not violate town zoning requirements.
- As delineated on the Federal Emergency Management Agency Community Panel 230051 0002C:
- The structure does not fall within the special flood hazard zone.
- The land does not fall within the special flood hazard zone.
- A wetlands study has not been performed.

Livingston-Hughes
Professional Land Surveyors
88 Guinea Road
Kennebunkport, Maine 04046
207-967-9761 phone 207-967-4831 fax
www.livingstonhughes.com