

**City of Portland, Maine - Building or Use Permit Application**

389 Congress Street, 04101 Tel: (207) 874-8703, Fax: (207) 874-8716

Permit No: 06-1224	Issue Date:	CBL: 370A A003001
-----------------------	-------------	----------------------

Location of Construction: 500 RIVERSIDE IND PKWY	Owner Name: 500 RIVERSIDE ASSOCIATES	Owner Address: PO BOX 382	Phone:
Business Name:	Contractor Name: HardyPond Construction	Contractor Address: 1039 Riverside St Suite 11 Portland	Phone 2077976066
Lessee/Buyer's Name	Phone:	Permit Type: Alterations - Commercial	Zone: I-M

Past Use: Commercial	Proposed Use: Commercial/ Tenant Fit-up	Permit Fee: \$60.00	Cost of Work: \$3,100.00	CEO District: 5
-------------------------	--	------------------------	-----------------------------	--------------------

Proposed Project Description: Commercial/ Tenant Fit-up	FIRE DEPT: <input checked="" type="checkbox"/> Approved <input type="checkbox"/> Denied	INSPECTION: Use Group: B Type: 2B IBC 2003
	Signature: <i>Greg Co...</i>	Signature: <i>MMB 09/05/06</i>
PEDESTRIAN ACTIVITIES DISTRICT (P.A.D.)		
Action: <input type="checkbox"/> Approved <input type="checkbox"/> Approved w/Conditions <input type="checkbox"/> Denied		
Signature: _____ Date: _____		

Permit Taken By: Idobson	Date Applied For: 08/21/2006	<b>Zoning Approval</b>
-----------------------------	---------------------------------	------------------------

<p>1. This permit application does not preclude the Applicant(s) from meeting applicable State and Federal Rules.</p> <p>2. Building permits do not include plumbing, septic or electrical work.</p> <p>3. Building permits are void if work is not started within six (6) months of the date of issuance. False information may invalidate a building permit and stop all work..</p>	<p>Special Zone or Reviews</p> <input type="checkbox"/> Shoreland <input type="checkbox"/> Wetland <input type="checkbox"/> Flood Zone <input type="checkbox"/> Subdivision <input type="checkbox"/> Site Plan <p>Maj <input type="checkbox"/> Minor <input type="checkbox"/> MM <input type="checkbox"/></p> <p>Date: <i>8/31/06</i></p>	<p>Zoning Appeal</p> <input type="checkbox"/> Variance <input type="checkbox"/> Miscellaneous <input type="checkbox"/> Conditional Use <input type="checkbox"/> Interpretation <input type="checkbox"/> Approved <input type="checkbox"/> Denied <p>Date: _____</p>	<p>Historic Preservation</p> <input checked="" type="checkbox"/> Not in District or Landmark <input type="checkbox"/> Does Not Require Review <input type="checkbox"/> Requires Review <input type="checkbox"/> Approved <input type="checkbox"/> Approved w/Conditions <input type="checkbox"/> Denied <p>Date: _____</p>
---	--	---	--

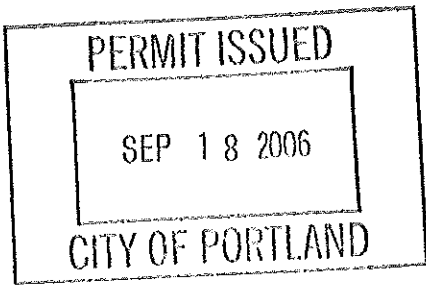

**CERTIFICATION**

I hereby certify that I am the owner of record of the named property, or that the proposed work is authorized by the owner of record and that I have been authorized by the owner to make this application as his authorized agent and I agree to conform to all applicable laws of this jurisdiction. In addition, if a permit for work described in the application is issued, I certify that the code official's authorized representative shall have the authority to enter all areas covered by such permit at any reasonable hour to enforce the provision of the code(s) applicable to such permit.

SIGNATURE OF APPLICANT \_\_\_\_\_ ADDRESS \_\_\_\_\_ DATE \_\_\_\_\_ PHONE \_\_\_\_\_

RESPONSIBLE PERSON IN CHARGE OF WORK, TITLE \_\_\_\_\_ DATE \_\_\_\_\_ PHONE \_\_\_\_\_

# All Purpose Building Permit Application

If you or the property owner owes real estate or personal property taxes or user charges on any property within the City, payment arrangements must be made before permits of any kind are accepted.

Location/Address of Construction: <u>500 RIVERSIDE INDUSTRIAL PARKWAY</u>		
Total Square Footage of Proposed Structure —	Square Footage of Lot —	
Tax Assessor's Chart, Block & Lot Chart#      Block#      Lot# <u>370      AA      003</u>	Owner: <u>500 RIVERSIDE INDUSTRIAL ASSOC 16 COUNTRY CHASE RD CUMBERLAND, ME 04021</u>	Telephone: <u>773-7100</u>
Lessee/Buyer's Name (if Applicable) <u>ENVIRONMENTAL 500 RIVERSIDE INDUSTRIAL PARKWAY PORTLAND, ME 04103</u>	Applicant name, address & telephone: <u>HARDYBOND CONST 1039 RIVERSIDE ST SUITE 11 PORTLAND, ME 04103</u>	Cost Of Work: <u>\$ 3,100.00</u> Fee: \$
Current use: <u>BIOTECH</u>		
If the location is currently vacant, what was prior use: —		
Approximately how long has it been vacant: —		
Proposed use: Project description: <u>ADD ADDITIONAL LAB SPACE (12'x16) INSIDE. LARGE OPEN AREA</u>		
Contractor's name, address & telephone: <u>HARDYBOND CONSTRUCTION 1039 RIVERSIDE ST SUITE 11 PORTLAND, ME 04103</u>		
Who should we contact when the permit is ready: <u>BOB GAUDREAU</u>		
Mailing address: <u>797-6066</u>		
<p>We will contact you by phone when the permit is ready. You must come in and pick up the permit and review the requirements before starting any work, with a Plan Reviewer. A stop work order will be issued and a \$100.00 fee if any work starts before the permit is picked up.      PHONE: <u>797-6066</u></p>		

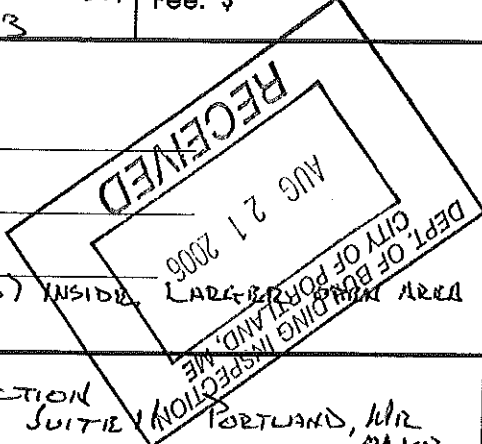

**IF THE REQUIRED INFORMATION IS NOT INCLUDED IN THE SUBMISSIONS THE PERMIT WILL BE AUTOMATICALLY DENIED AT THE DISCRETION OF THE BUILDING/PLANNING DEPARTMENT, WE MAY REQUIRE ADDITIONAL INFORMATION IN ORDER TO APPROVE THIS PERMIT.**

*I hereby certify that I am the Owner of record of the named property, or that the owner of record authorizes the proposed work and that I have been authorized by the owner to make this application as his/her authorized agent. I agree to conform to all applicable laws of this jurisdiction. In addition, if a permit for work described in this application is issued, I certify that the Code Official's authorized representative shall have the authority to enter all areas covered by this permit at any reasonable hour to enforce the provisions of the codes applicable to this permit.*

Signature of applicant: <u>[Handwritten Signature]</u>	Date: <u>8/19/06</u>
--	----------------------

**This is NOT a permit, you may not commence ANY work until the permit is issued.  
If you are in a Historic District you may be subject to additional permitting and fees with the  
Planning Department on the 4<sup>th</sup> floor of City Hall**

# RIVERSIDE INDUSTRIAL PARKWAY

HARDY ROAD CONSTRUCTION  
 1039 Riverside St Suite 11  
 Portland, ME 04103

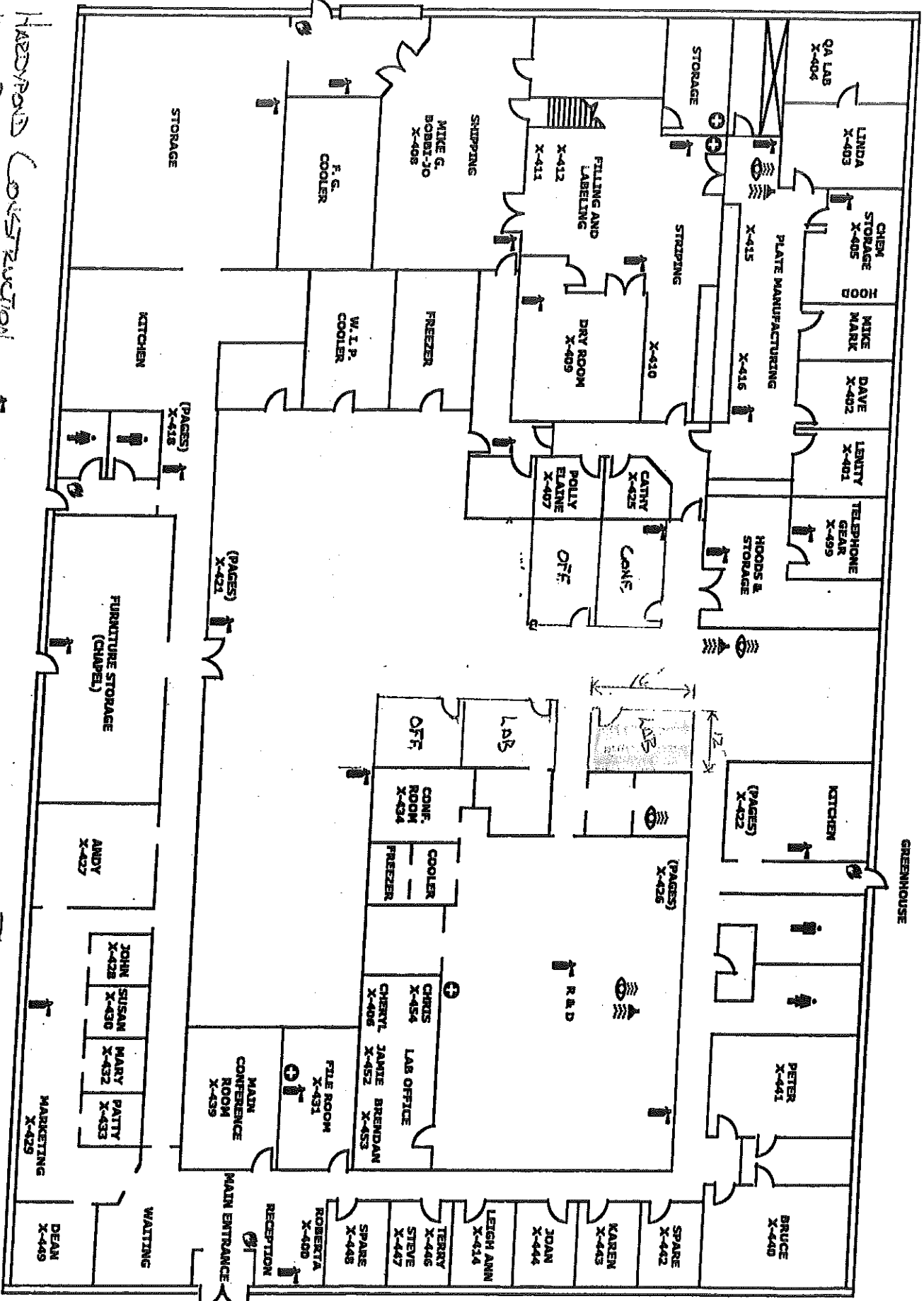

ENROLLOX  
 500 Riverside Industrial Parkway

# WALL SECTION

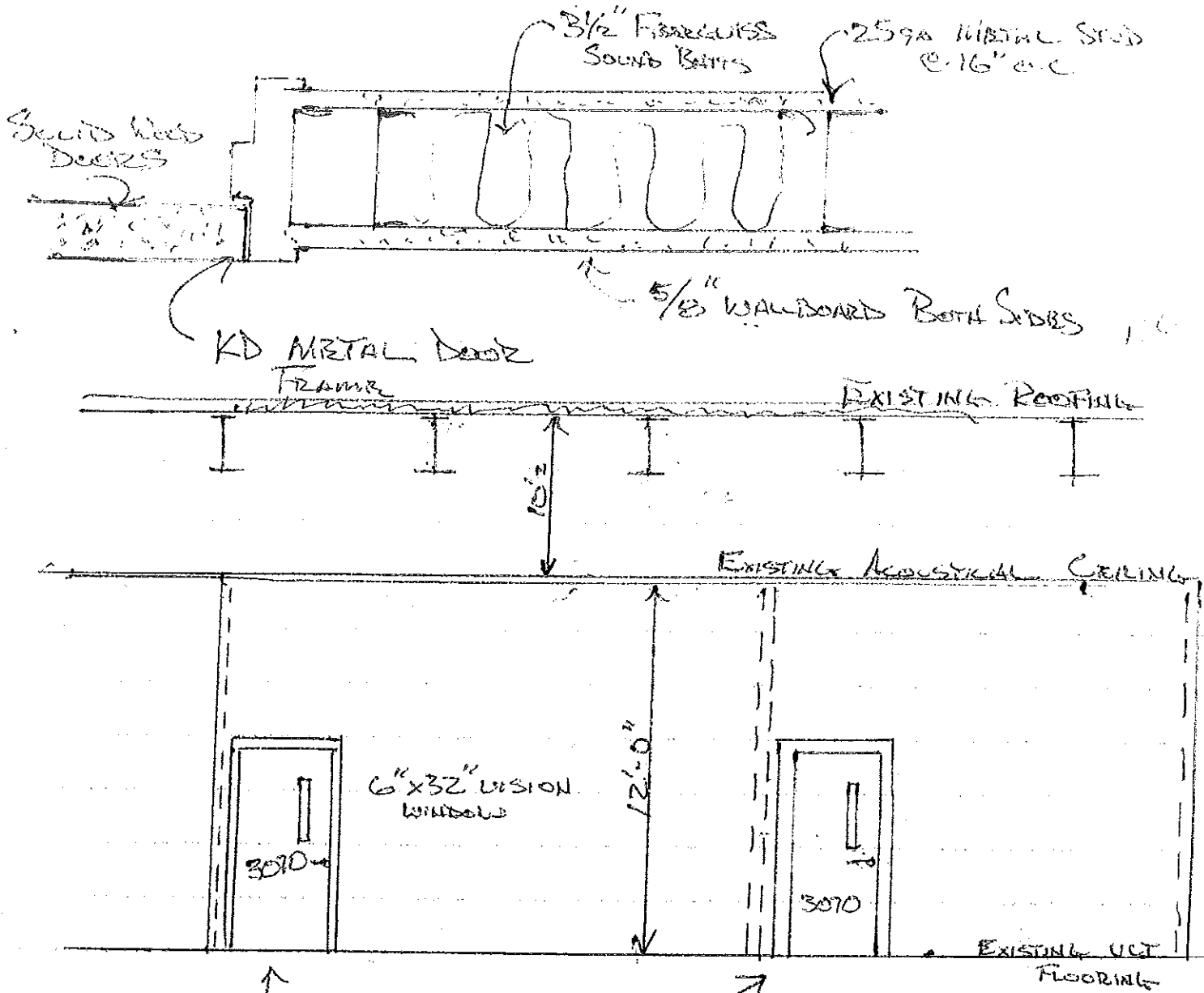

"A"

BUILDING WALL ELEVATION

HARDYFOND CONST.  
1039 RIVERSIDE ST SUITE 11  
PORTLAND, ME 04103

BUILDING DETAILS  
PAURELOHIX

**City of Portland, Maine - Building or Use Permit**

389 Congress Street, 04101 Tel: (207) 874-8703, Fax: (207) 874-8716

Permit No: 06-1224	Date Applied For: 08/21/2006	CBL: 370A A003001
-----------------------	---------------------------------	----------------------

Location of Construction: 500 RIVERSIDE IND PKWY	Owner Name: 500 RIVERSIDE ASSOCIATES	Owner Address: PO BOX 382	Phone:
Business Name:	Contractor Name: HardyPond Construction	Contractor Address: 1039 Riverside St Suite 11 Portland	Phone (207) 797-6066
Lessee/Buyer's Name	Phone:	Permit Type: Alterations - Commercial	

Proposed Use: Commercial/ Tenant Fit-up	Proposed Project Description: Commercial/ Tenant Fit-up
--	--

**Dept:** Zoning      **Status:** Approved      **Reviewer:** Marge Schmuckal      **Approval Date:** 08/31/2006  
**Note:**      **Ok to Issue:**

**Dept:** Building      **Status:** Approved with Conditions      **Reviewer:** Michael A. Collins      **Approval Date:** 09/08/2006  
**Note:** Received on 09/08/06. Review in progress.      **Ok to Issue:**   
 1) Application approval based upon information provided by applicant. Any deviation from approved plans requires separate review and approval prior to work.

**Dept:** Fire      **Status:** Approved      **Reviewer:** Cptn Greg Cass      **Approval Date:** 09/01/2006  
**Note:**      **Ok to Issue:**

# ELECTRICAL PERMIT

## City of Portland, Me.



To the Chief Electrical Inspector, Portland Maine:  
 The undersigned hereby applies for a permit to make electrical installations in accordance with the laws of Maine, the City of Portland Electrical Ordinance, National Electrical Code and the following specifications:

Date 9.25.06  
 Permit # 2006-4850  
 CBL# 370AA3

LOCATION: 500 Riverside Industrial PK METER MAKE & # \_\_\_\_\_  
 CMP ACCOUNT # \_\_\_\_\_ OWNER \_\_\_\_\_  
 TENANT Envirologix PHONE # \_\_\_\_\_

							TOTAL EACH FEE			
OUTLETS	12	Receptacles	1	Switches		Smoke Detector		13	.20	2.60
FIXTURES		Incandescent	4	Fluorescent		Strips		4	.20	.80
SERVICES		Overhead		Underground		TTL AMPS	<800		15.00	
		Overhead		Underground			>800		25.00	
Temporary Service		Overhead		Underground		TTL AMPS			25.00	
									25.00	
METERS		(number of)							1.00	
MOTORS		(number of)							2.00	
RESID/COM		Electric units							1.00	
HEATING		oil/gas units		Interior		Exterior			5.00	
APPLIANCES		Ranges		Cook Tops		Wall Ovens			2.00	
		Insta-Hot		Water heaters		Fans			2.00	
		Dryers		Disposals		Dishwasher			2.00	
		Compactors		Spa		Washing Machine			2.00	
		Others (denote)							2.00	
MISC. (number of)		Air Cond/win							3.00	
		Air Cond/cent				Pools			10.00	
		HVAC		EMS		Thermostat			5.00	
		Signs							10.00	
		Alarms/res							5.00	
		Alarms/com							15.00	
		Heavy Duty(CRKT)							2.00	
		Circus/Carnv							25.00	
		Alterations							5.00	
		Fire Repairs							15.00	
		E Lights							1.00	
		E Generators							20.00	
PANELS		Service		Remote		Main			4.00	
TRANSFORMER		0-25 Kva							5.00	
		25-200 Kva							8.00	
		Over 200 Kva							10.00	
							TOTAL AMOUNT DUE			
MINIMUM FEE/COMMERCIAL 45.00							MINIMUM FEE 35.00			

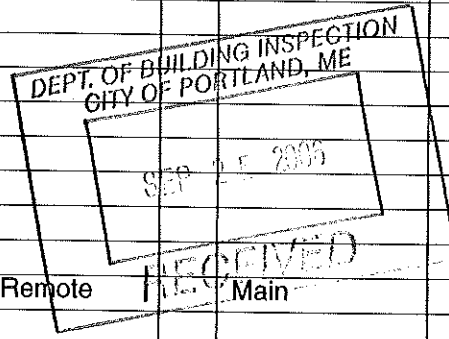

CONTRACTORS NAME Seabee Electric MASTER LIC. # 17768  
 ADDRESS 84 Pleasant Hill Rd. Scarborough LIMITED LIC. # \_\_\_\_\_  
 TELEPHONE 883-5448

SIGNATURE OF CONTRACTOR [Signature] CK# 8189

\_\_\_\_\_

\_\_\_\_\_