

CWS ARCHITECTS
ARCHITECTURE | INTERIOR DESIGN
264 US ROUTE ONE
BOX 6, SUITE 100-2A
SCARBOROUGH, MAINE 04074
T: 207.774.4441
WWW.CWSARCH.COM

DESIGNER

OWNER

PROJECT

DRAWING

REVISIONS

FAIRPOINT COMMUNICATIONS

5 DAVIS FARM ROAD MERGER

SECOND FLOOR LIFE SAFETY PLAN

DRAWING NUMBER
LS1.02

SCALE: AS NOTED
DATE: 1-2-2018
ISSUED FOR PERMITTING

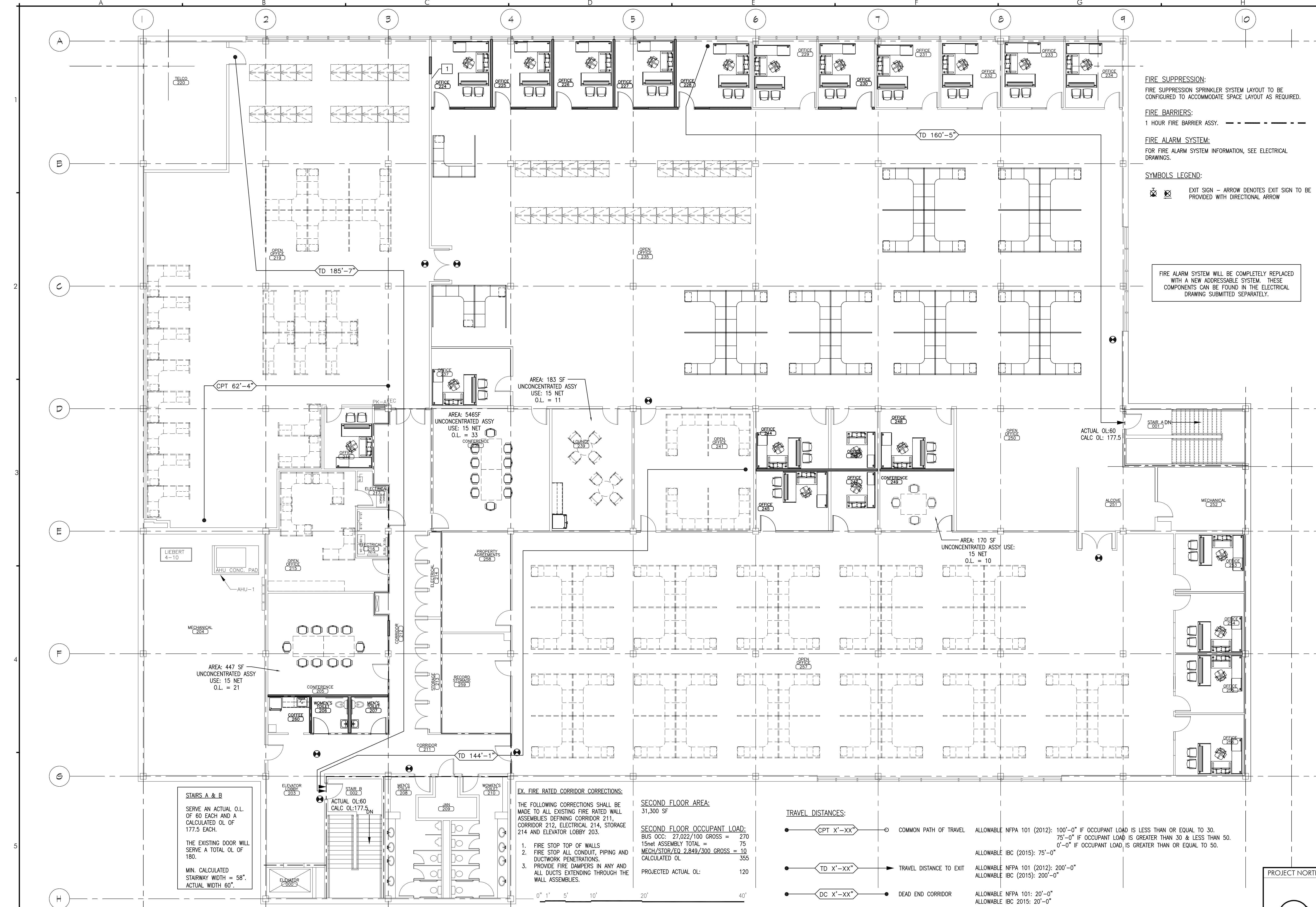

FIRE SUPPRESSION:
FIRE SUPPRESSION SPRINKLER SYSTEM LAYOUT TO BE CONFIGURED TO ACCOMMODATE SPACE LAYOUT AS REQUIRED.

FIRE BARRIERS:
1 HOUR FIRE BARRIER ASSY.

FIRE ALARM SYSTEM:
FOR FIRE ALARM SYSTEM INFORMATION, SEE ELECTRICAL DRAWINGS.

SYMBOLS LEGEND:

EXIT SIGN - ARROW DENOTES EXIT SIGN TO BE PROVIDED WITH DIRECTIONAL ARROW

FIRE ALARM SYSTEM WILL BE COMPLETELY REPLACED WITH A NEW ADDRESSABLE SYSTEM. THESE COMPONENTS CAN BE FOUND IN THE ELECTRICAL DRAWING SUBMITTED SEPARATELY.

EX. FIRE RATED CORRIDOR CORRECTIONS:

THE FOLLOWING CORRECTIONS SHALL BE MADE TO ALL EXISTING FIRE RATED WALL ASSEMBLIES DEFINING CORRIDOR 211, CORRIDOR 212, ELECTRICAL 214, STORAGE 214 AND ELEVATOR LOBBY 203.

1. FIRE STOP TOP OF WALLS
2. FIRE STOP ALL CONDUIT, PIPING AND DUCTWORK PENETRATIONS.
3. PROVIDE FIRE DAMPERS IN ANY AND ALL DUCTS EXTENDING THROUGH THE WALL ASSEMBLIES.

SECOND FLOOR AREA:
31,300 SF

SECOND FLOOR OCCUPANT LOAD:
BUS OCC: 27,022/100 GROSS = 270
15net ASSEMBLY TOTAL = 75
MECH/STOR/EQ 2,849/300 GROSS = 10
CALCULATED OL 355
PROJECTED ACTUAL OL: 120

TRAVEL DISTANCES:

- CPT X'-XX' COMMON PATH OF TRAVEL
- TD X'-XX' TRAVEL DISTANCE TO EXIT
- DC X'-XX' DEAD END CORRIDOR

ALLOWABLE NFPA 101 (2012): 100'-0" IF OCCUPANT LOAD IS LESS THAN OR EQUAL TO 30.
75'-0" IF OCCUPANT LOAD IS GREATER THAN 30 & LESS THAN 50.
0'-0" IF OCCUPANT LOAD IS GREATER THAN OR EQUAL TO 50.

ALLOWABLE IBC (2015): 75'-0"

ALLOWABLE NFPA 101 (2012): 200'-0"
ALLOWABLE IBC (2015): 200'-0"

ALLOWABLE NFPA 101: 20'-0"
ALLOWABLE IBC 2015: 20'-0"

STAIRS A & B
SERVE AN ACTUAL O.L. OF 60 EACH AND A CALCULATED OL OF 177.5 EACH.
THE EXISTING DOOR WILL SERVE A TOTAL OL OF 180.
MIN. CALCULATED STAIRWAY WIDTH = 58".
ACTUAL WIDTH 60".

