

GENERAL SITE PLAN/ROOF PLAN NOTES:

- SEE 10/A301 FOR RETAINING WALL DETAIL
- CONFIRM REQUIRED TURNING RADIUS FOR PPL'S BOOKMOBILE & GRADE CHANGE BETWEEN EXISTING ROAD AND LOADING DOCK AT NEW OVERHEAD DOOR 117C PRIOR TO CONSTRUCTION OF RAMP
- AT BUILDING 1 & LOADING DOCK:
 - EXISTING DECKING, FLUTE FILLER AND 1" INSULATION BOARD TO REMAIN
 - REMOVE EXISTING MEMBRANE ROOFING
 - ADD (2) LAYERS 2" RIGID FOAM
 - ADD 1/2" ROOF BOARD
 - ADD TPO MEMBRANE ROOFING
- AT BUILDING 2:
 - EXISTING METAL ROOFING TO REMAIN
 - ADD FLUTE FILLER
 - ADD (2) LAYERS 2" RIGID FOAM
 - ADD 1/2" ROOF BOARD
 - ADD TPO MEMBRANE ROOFING
- EXISTING ROOF DECK AT BUILDING 1 TO BE CUT BACK AT PERIMETER TO ALLOW ROOF EDGE TO BE FLUSH WITH EXTERIOR FACE OF NEW SIP WALL PANELS. SEE 4/A301
- ENTIRE PERIMETER OF ROOFING AT BUILDINGS 1, 2 & LOADING DOCK TO BE RE-FLASHED

1 SITE PLAN/ROOF PLAN
SCALE: 1/32" = 1'-0"

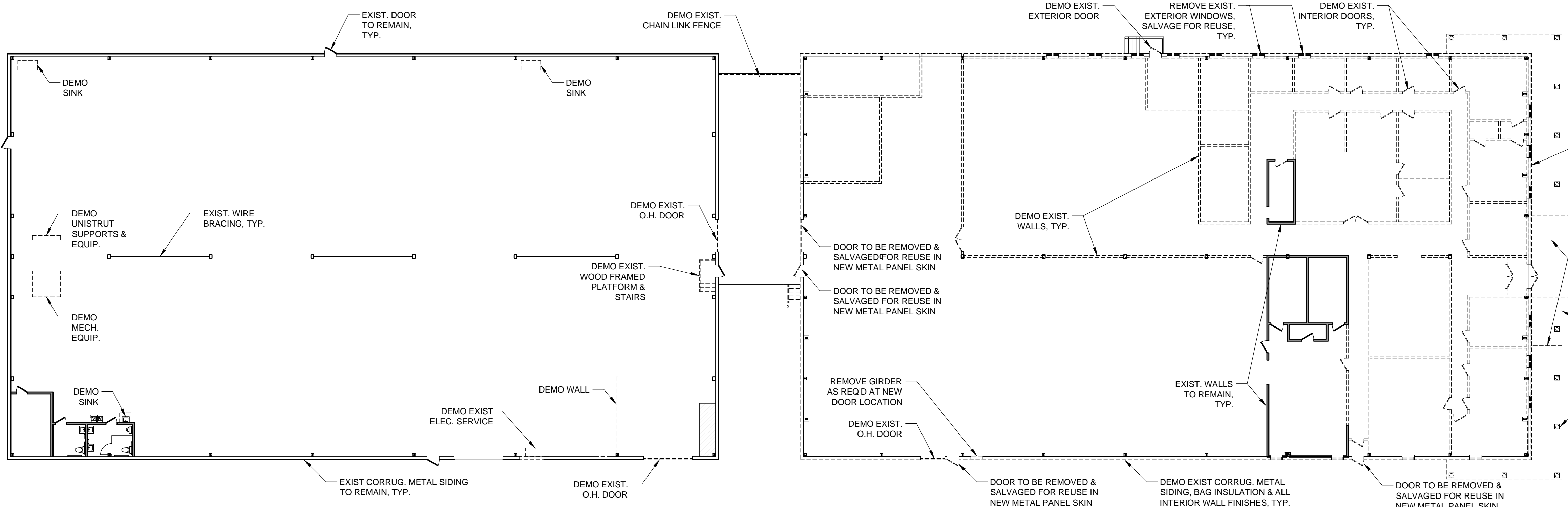

GENERAL DEMOLITION NOTES:

- REMOVE ALL EXISTING FLOOR FINISHES UNLESS OTHERWISE NOTED.
- REMOVE ALL EXISTING FABRIC CANOPIES & SUPPORT STRUCTURES AT ENTRY DOORS.
- REMOVE ALL EXISTING CEILING FINISHES UNLESS OTHERWISE NOTED.
- REMOVE ALL EXISTING WINDOWS & DOORS AT BUILDING 1, TYP. SALVAGE ALL DOORS & 3'x4' DOUBLE HUNG WINDOW UNITS FOR REUSE & REINSTALLATION IN NEW SKIN, UNLESS OTHERWISE NOTED.
- REMOVE ALL EXISTING LIGHT FIXTURES, WIRING & MECHANICAL EQUIPMENT IN BUILDING 1 UNLESS OTHERWISE NOTED. ALL EXISTING LIGHTING & MECHANICAL EQUIPMENT TO REMAIN IN BUILDING 2, TYP.
- REMOVE ALL EXTRANEOUS HVAC, MECHANICAL, ELECTRICAL & PLUMBING EQUIPMENT FROM LOADING DOCK & BUILDING 2, TYP.
- EXISTING BATHROOMS IN BUILDINGS 1 & 2 TO REMAIN.
- EXISTING CORRUGATED METAL SIDING & BAG INSULATION TO BE REMOVED BY SIP INSTALLER

2 DEMOLITION PLAN
SCALE: 1/16" = 1'-0"

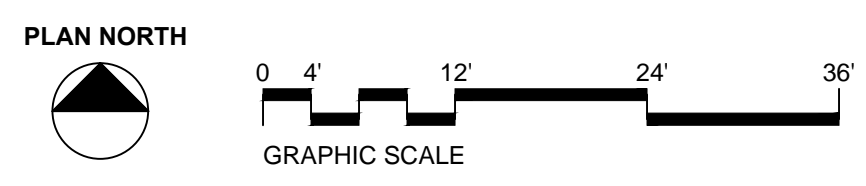

PROJECT NAME:
1000 RIVERSIDE

RENOVATIONS
PORTLAND, MAINE

SEAL:

THIS DRAWING IS THE PROPERTY OF SCOTT SIMONS ARCHITECTS (SSA) AND IS NOT TO BE COPIED OR REPRODUCED IN PART OR WHOLE.
2012 © SCOTT SIMONS ARCHITECTS, LLC

REVISION:

DATE OF ISSUE: NOVEMBER 13, 2013
PROJECT NUMBER: 2013-0190 1000 RIVERSIDE
STATUS: ISSUE FOR PERMITTING

SITE PLAN & DEMOLITION PLAN