

357-C-5

1340 Riverside St.

Cellular Telephone

Atlantic Cellular

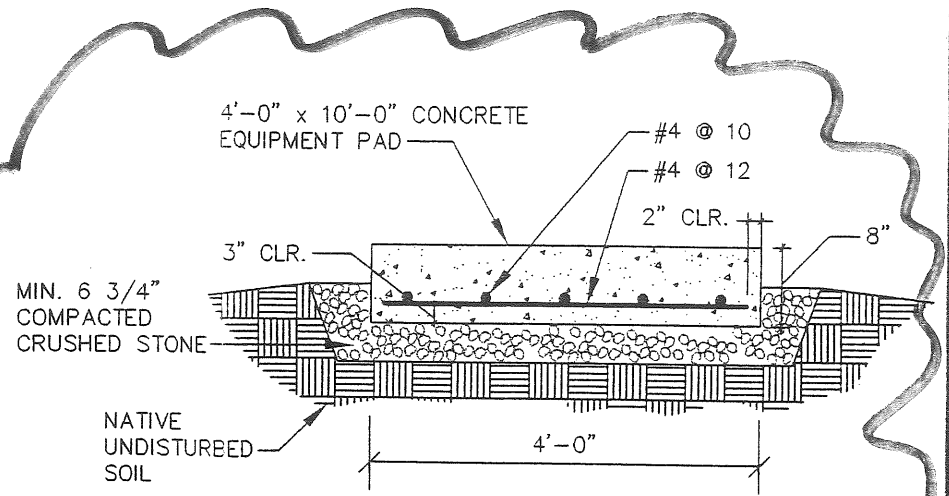
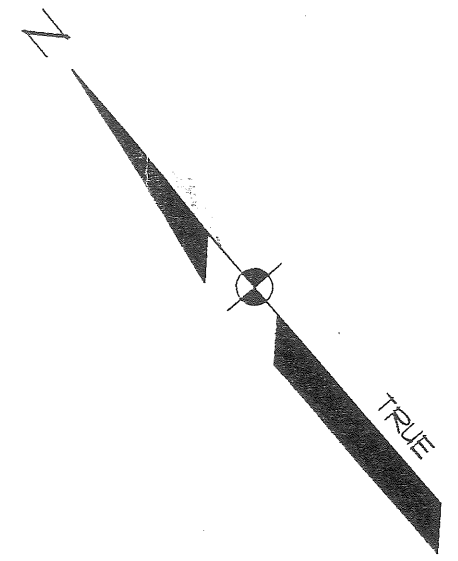
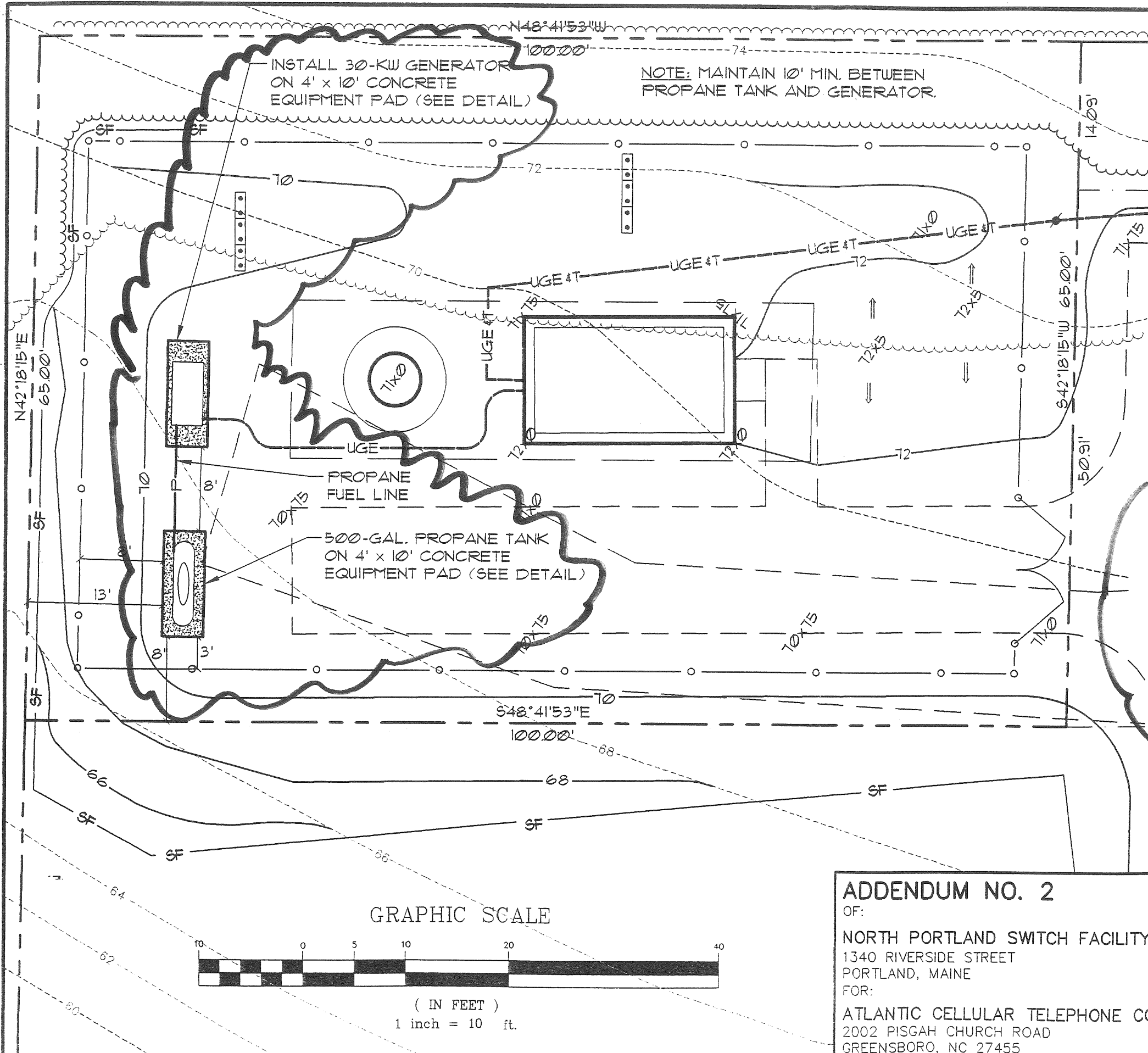

ANCHOR ALL EQUIPMENT TO CONCRETE PAD PER MANUFACTURER'S RECOMMENDATIONS.
TYPICAL CONCRETE EQUIPMENT PAD
 NOT TO SCALE

ADDENDUM NO. 1 — ADD CONCRETE PADS, GENERATOR, PROPANE TANK AND UNDERGROUND UTILITIES.

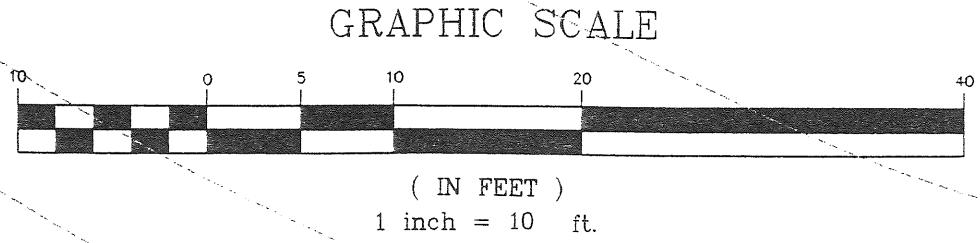

ADDENDUM NO. 2
 OF:
 NORTH PORTLAND SWITCH FACILITY
 1340 RIVERSIDE STREET
 PORTLAND, MAINE
 FOR:
 ATLANTIC CELLULAR TELEPHONE CORP.
 2002 PISGAH CHURCH ROAD
 GREENSBORO, NC 27455

Sebago Technics
Engineering & Planning for the Future
 12 WESTBROOK COMMON
 WESTBROOK, ME 04098-1339
 TEL (207) 856-0277

DESIGN BY:	MSL
DRAWN BY:	MAL
CHECKED BY:	CLB
DATE:	4/8/97
SCALE:	1"=10'
FIELD BK:	510
PROJ. NO:	96369
DRAWING:	96369ADD
SHEET 1 OF 1	

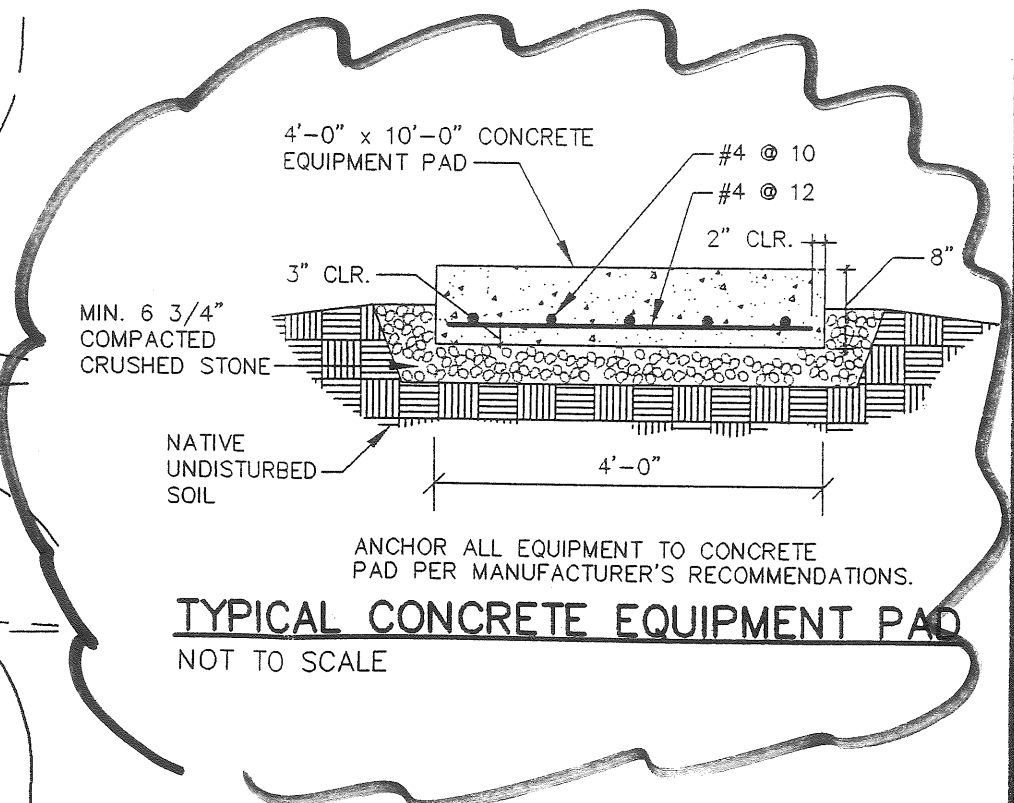
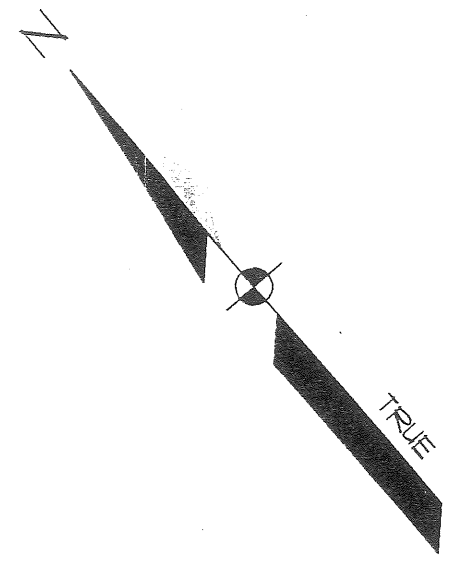
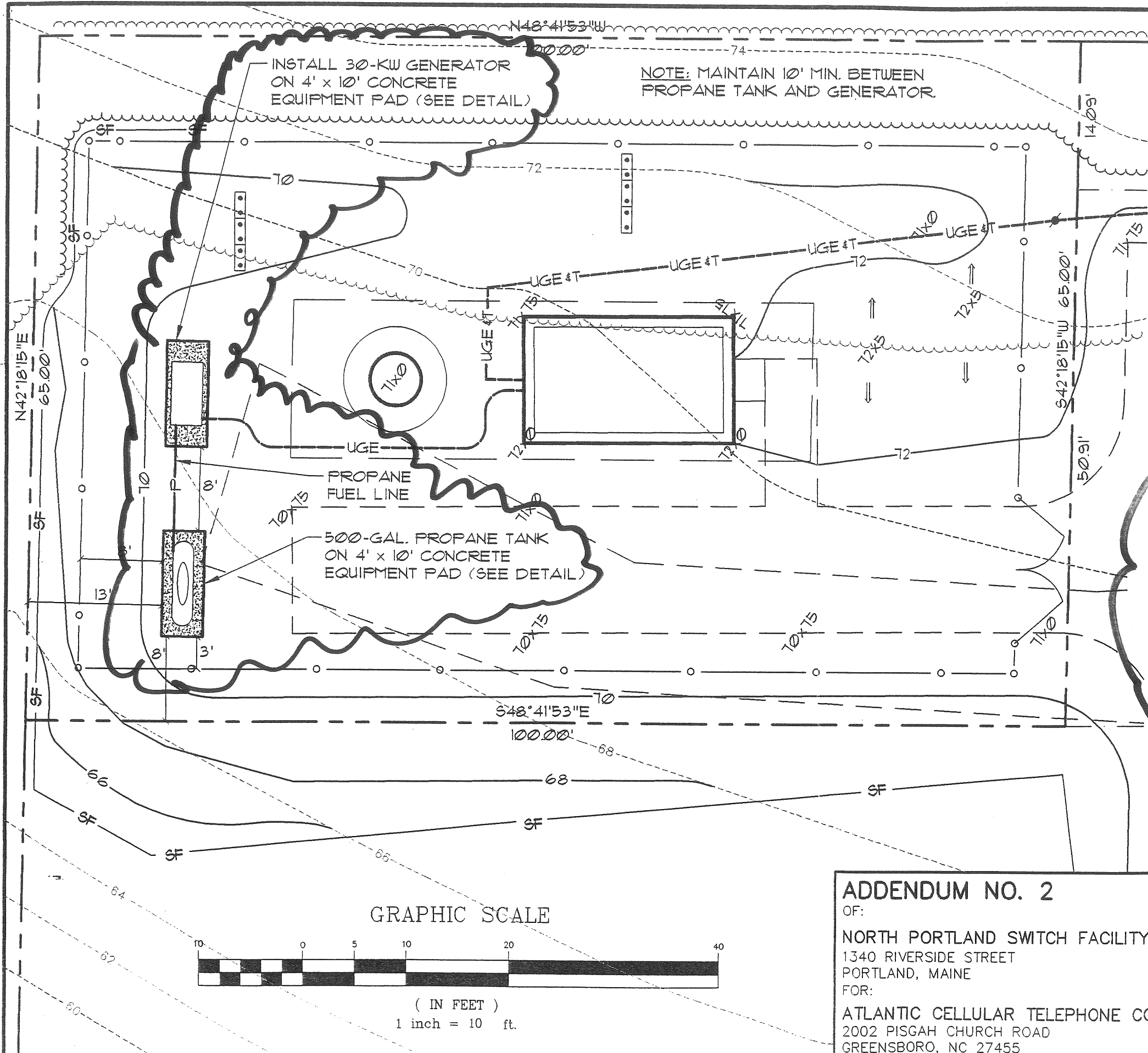

TYPICAL CONCRETE EQUIPMENT PAD
NOT TO SCALE

ADDENDUM NO. 1 - ADD CONCRETE PADS, GENERATOR, PROPANE TANK AND UNDERGROUND UTILITIES.

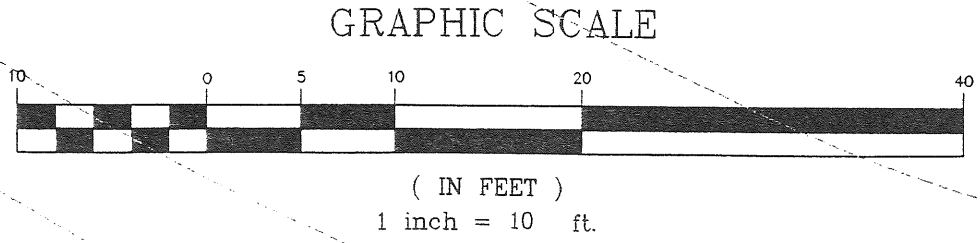

ADDENDUM NO. 2
OF:
NORTH PORTLAND SWITCH FACILITY
1340 RIVERSIDE STREET
PORTLAND, MAINE
FOR:
ATLANTIC CELLULAR TELEPHONE CORP.
2002 PISGAH CHURCH ROAD
GREENSBORO, NC 27455

Sebago Technics
Engineering & Planning for the Future
12 WESTBROOK COMMON
WESTBROOK, ME 04098-1339
TEL (207) 856-0277

DESIGN BY:	MSL
DRAWN BY:	MAL
CHECKED BY:	CLB
DATE:	4/8/97
SCALE:	1"=10'
FIELD BK:	510
PROJ. NO:	96369
DRAWING:	96369ADD
SHEET 1 OF 1	

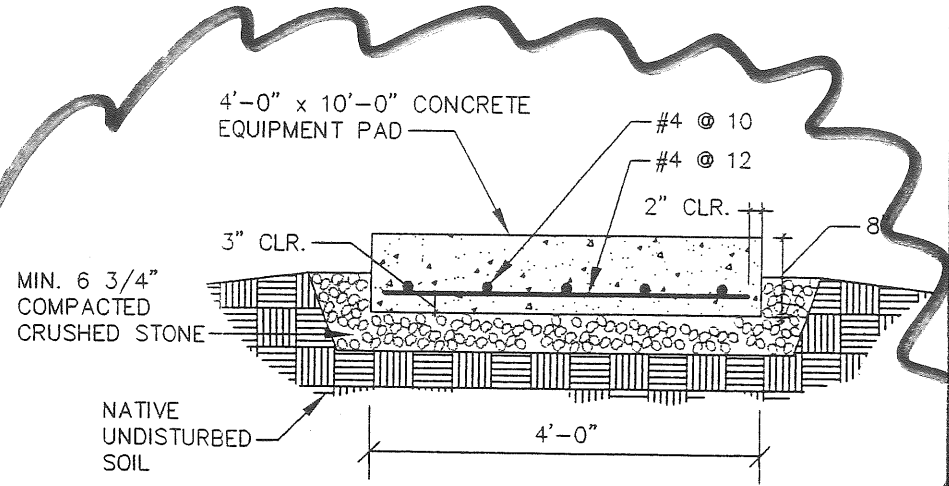
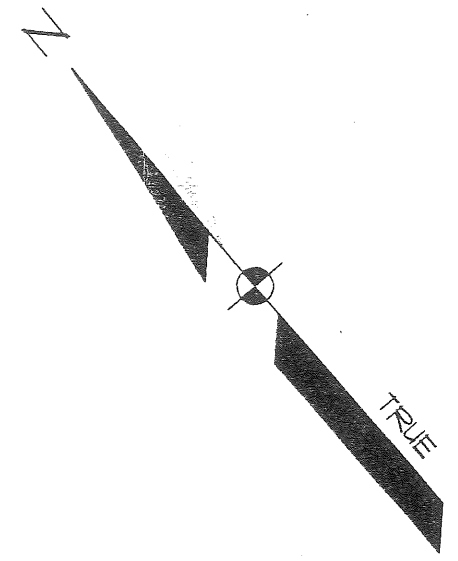
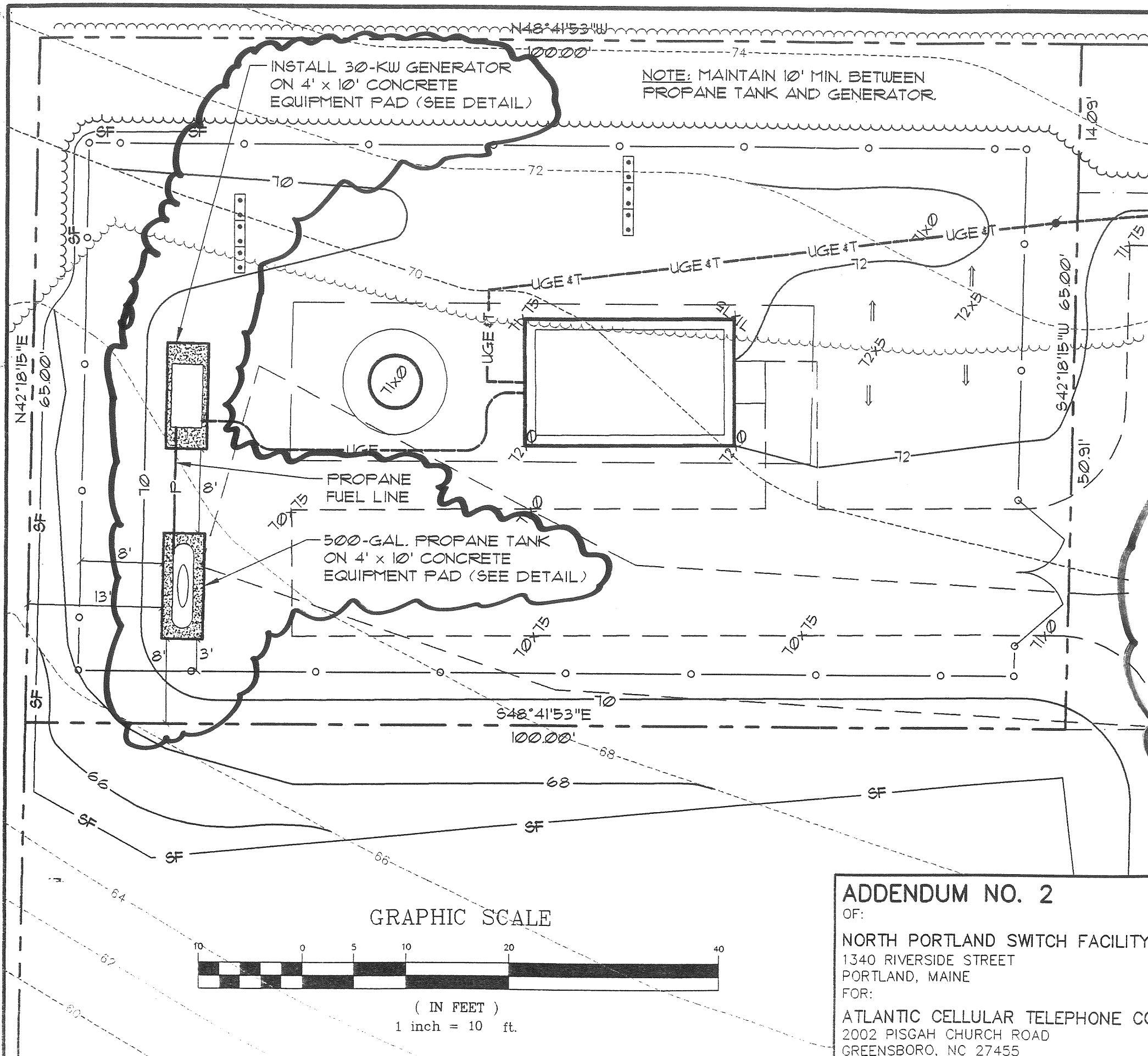

ANCHOR ALL EQUIPMENT TO CONCRETE PAD PER MANUFACTURER'S RECOMMENDATIONS.
TYPICAL CONCRETE EQUIPMENT PAD
 NOT TO SCALE

ADDENDUM NO. 1 - ADD CONCRETE PADS, GENERATOR, PROPANE TANK AND UNDERGROUND UTILITIES.

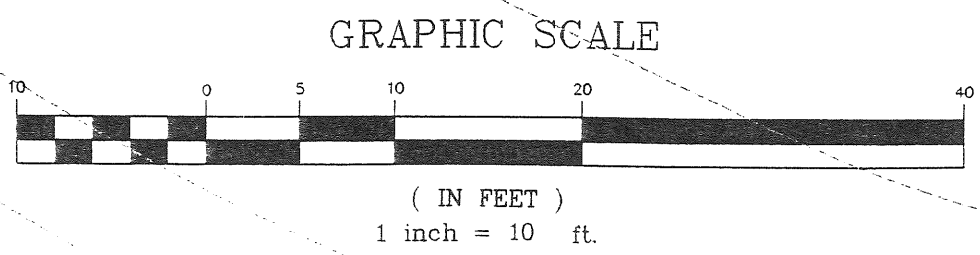

ADDENDUM NO. 2
 OF:
 NORTH PORTLAND SWITCH FACILITY
 1340 RIVERSIDE STREET
 PORTLAND, MAINE
 FOR:
 ATLANTIC CELLULAR TELEPHONE CORP.
 2002 PISGAH CHURCH ROAD
 GREENSBORO, NC 27455

Sebago Technics
Engineering & Planning for the Future
 12 WESTBROOK COMMON
 WESTBROOK, ME 04098-1339
 TEL (207) 856-0277

DESIGN BY:	MSL
DRAWN BY:	MAL
CHECKED BY:	CLB
DATE:	4/8/97
SCALE:	1"=10'
FIELD BK:	510
PROJ. NO:	96369
DRAWING:	96369ADD
SHEET 1 OF 1	

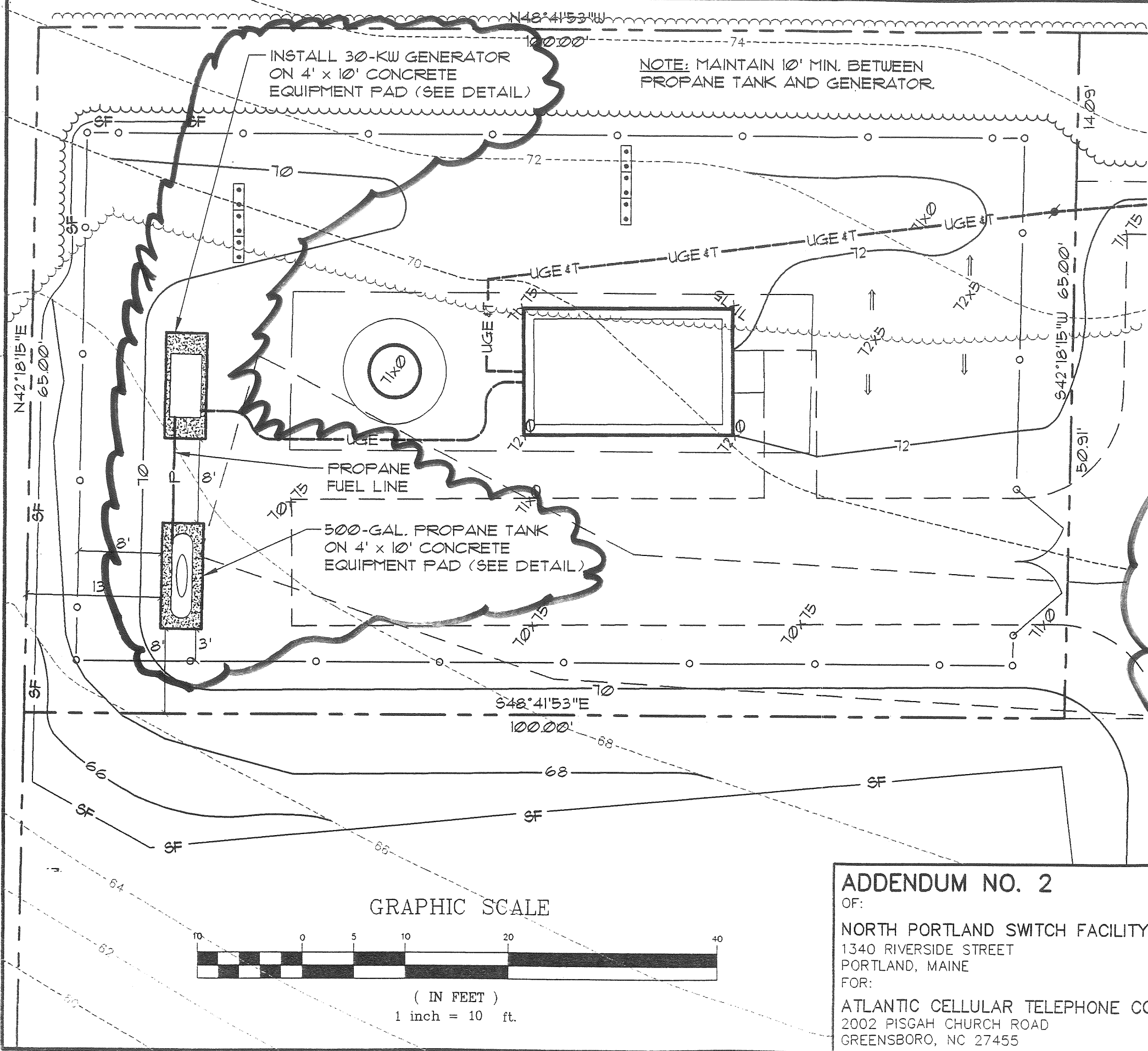

INSTALL 30-KW GENERATOR ON 4' x 10' CONCRETE EQUIPMENT PAD (SEE DETAIL)

NOTE: MAINTAIN 10' MIN. BETWEEN PROPANE TANK AND GENERATOR.

PROPANE FUEL LINE
500-GAL. PROPANE TANK ON 4' x 10' CONCRETE EQUIPMENT PAD (SEE DETAIL)

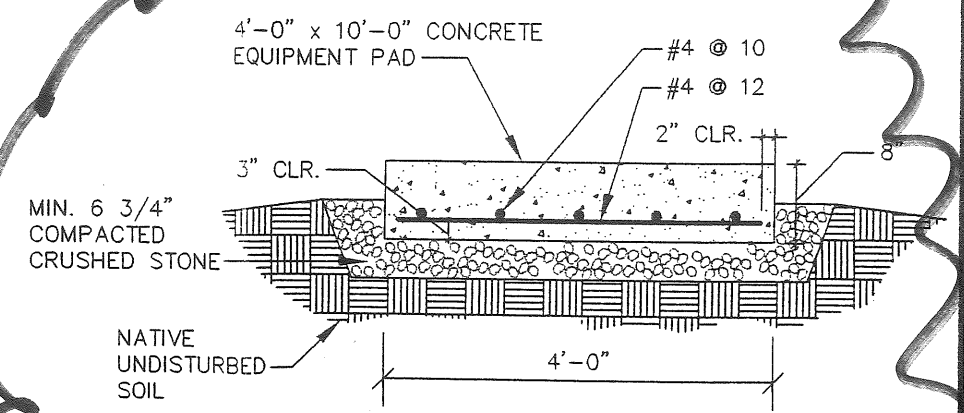
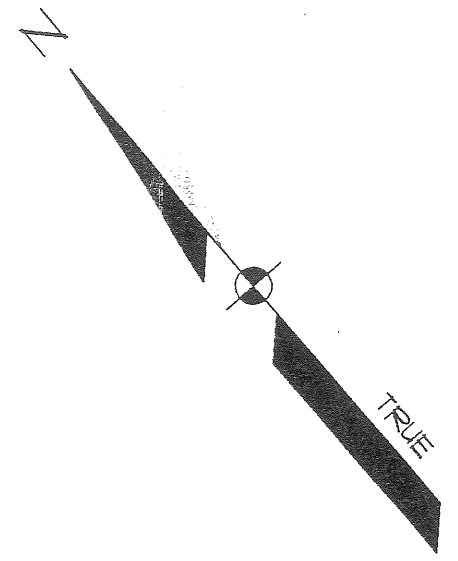

ANCHOR ALL EQUIPMENT TO CONCRETE PAD PER MANUFACTURER'S RECOMMENDATIONS.
TYPICAL CONCRETE EQUIPMENT PAD
NOT TO SCALE

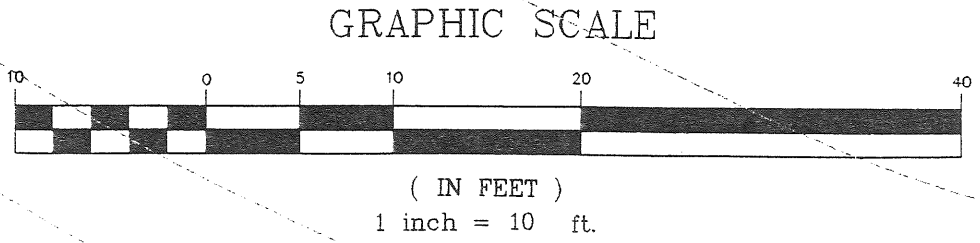

ADDENDUM NO. 1 - ADD CONCRETE PADS, GENERATOR, PROPANE TANK AND UNDERGROUND UTILITIES.

ADDENDUM NO. 2
OF:
NORTH PORTLAND SWITCH FACILITY
1340 RIVERSIDE STREET
PORTLAND, MAINE
FOR:
ATLANTIC CELLULAR TELEPHONE CORP.
2002 PISGAH CHURCH ROAD
GREENSBORO, NC 27455

Sebago Technics
Engineering & Planning for the Future
12 WESTBROOK COMMON
WESTBROOK, ME 04098-1339
TEL (207) 856-0277

DESIGN BY:	MSL
DRAWN BY:	MAL
CHECKED BY:	CLB
DATE:	4/8/97
SCALE:	1"=10'
FIELD BK:	510
PROJ. NO:	96369
DRAWING:	96369ADD
SHEET 1 OF 1	

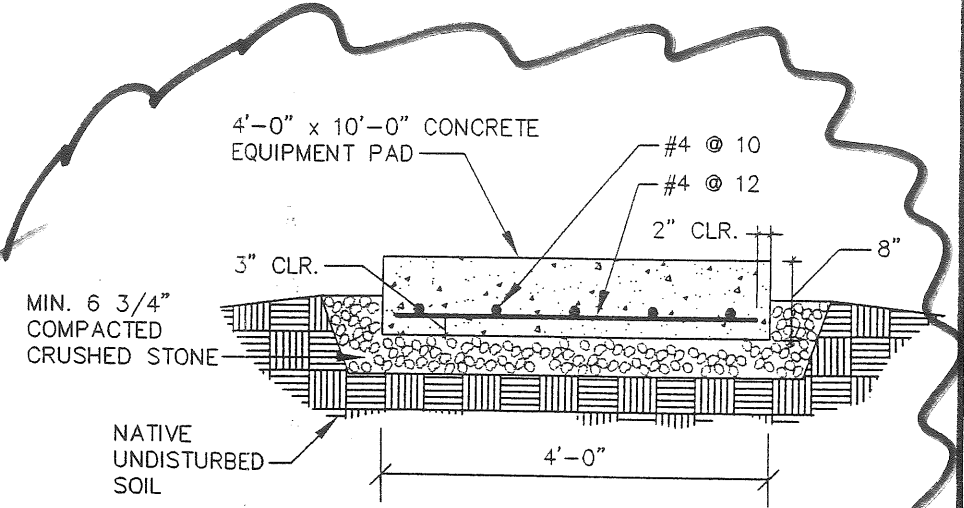
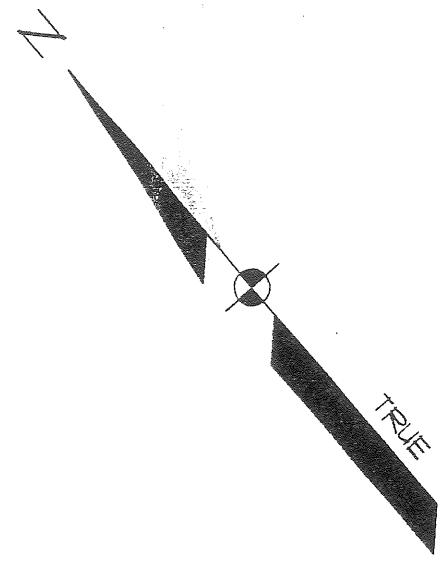
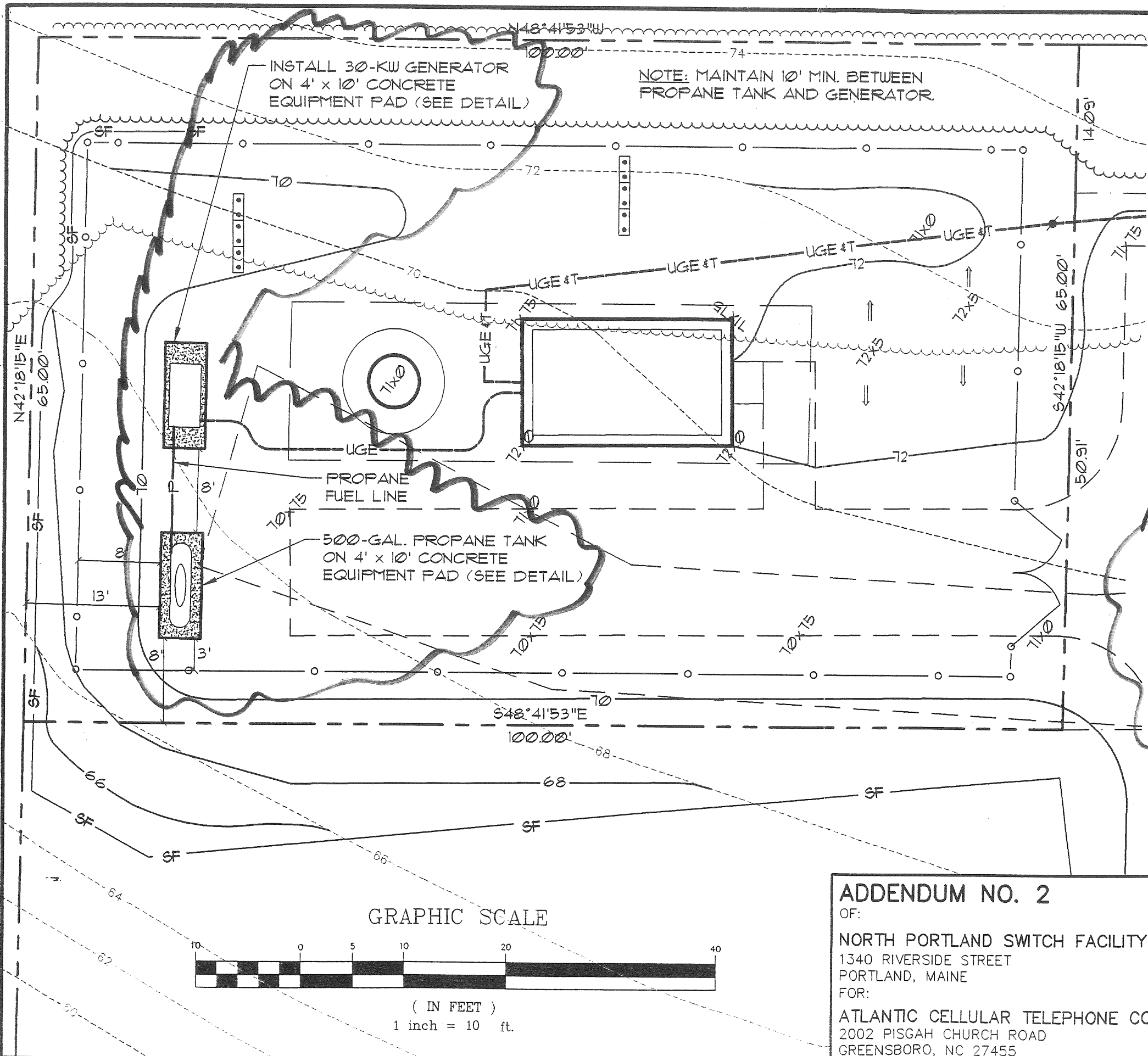

ANCHOR ALL EQUIPMENT TO CONCRETE PAD PER MANUFACTURER'S RECOMMENDATIONS.

TYPICAL CONCRETE EQUIPMENT PAD

NOT TO SCALE

ADDENDUM NO. 1 — ADD CONCRETE PADS, GENERATOR, PROPANE TANK AND UNDERGROUND UTILITIES.

ADDENDUM NO. 2
OF:
NORTH PORTLAND SWITCH FACILITY
1340 RIVERSIDE STREET
PORTLAND, MAINE
FOR:
ATLANTIC CELLULAR TELEPHONE CORP.
2002 PISGAH CHURCH ROAD
GREENSBORO, NC 27455

Sebago Technics
Engineering & Planning for the Future
12 WESTBROOK COMMON
WESTBROOK, ME 04098-1339
TEL (207) 856-0277

DESIGN BY:	MSL
DRAWN BY:	MAL
CHECKED BY:	CLB
DATE:	4/8/97
SCALE:	1"=10'
FIELD BK:	510
PROJ. NO:	96369
DRAWING:	96369ADD
SHEET 1 OF 1	

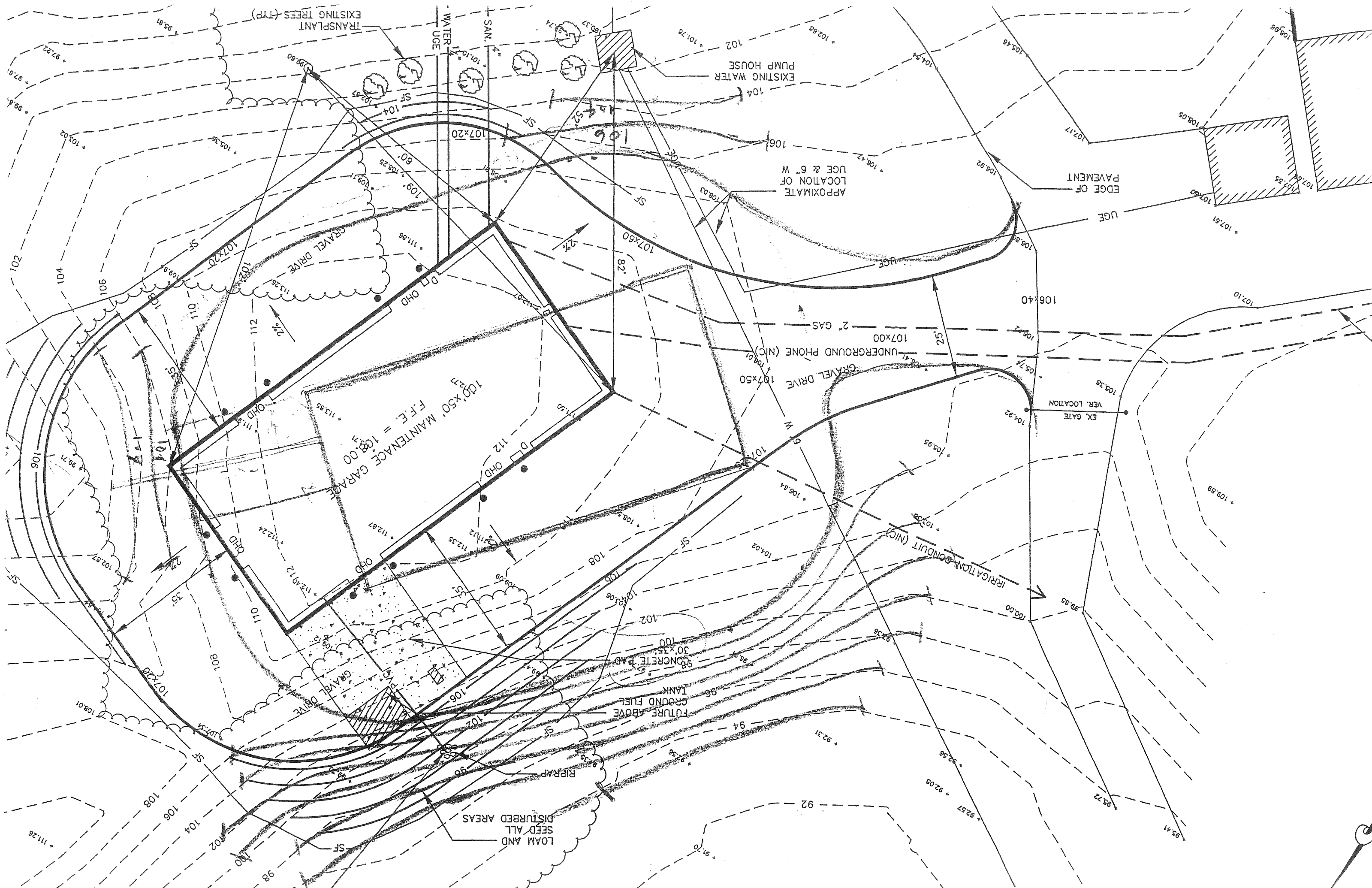

DESIGN BY:	MSL
DRAWN BY:	MAL
CHECKED BY:	CLB
DATE:	4/8/97
SCALE:	1"=10'
FIELD BK:	510
PROJ. NO.:	96369
DRAWING:	96369ADD

Sebago Technics
Engineering & Planning for the Future

12 WESTBROOK COMMON
 WESTBROOK, ME 04098-1339
 TEL (207) 856-0277

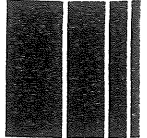

ADDENDUM NO. 1 - ADD CONCRETE PADS, GENERATOR,
 PROPAANE TANK AND UNDERGROUND UTILITIES.

ADDENDUM NO. 2
 OF:
 NORTH PORTLAND SWITCH FACILITY
 1340 RIVERSIDE STREET
 PORTLAND, MAINE
 FOR:
 ATLANTIC CELLULAR TELEPHONE CORP.
 2002 PISGAH CHURCH ROAD
 GREENSBORO, NC 27455



GRAPHIC SCALE

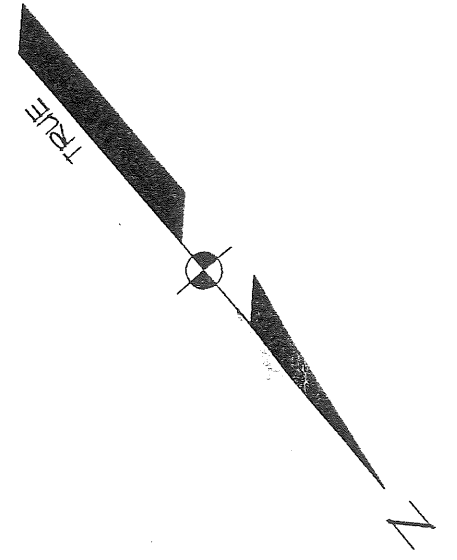
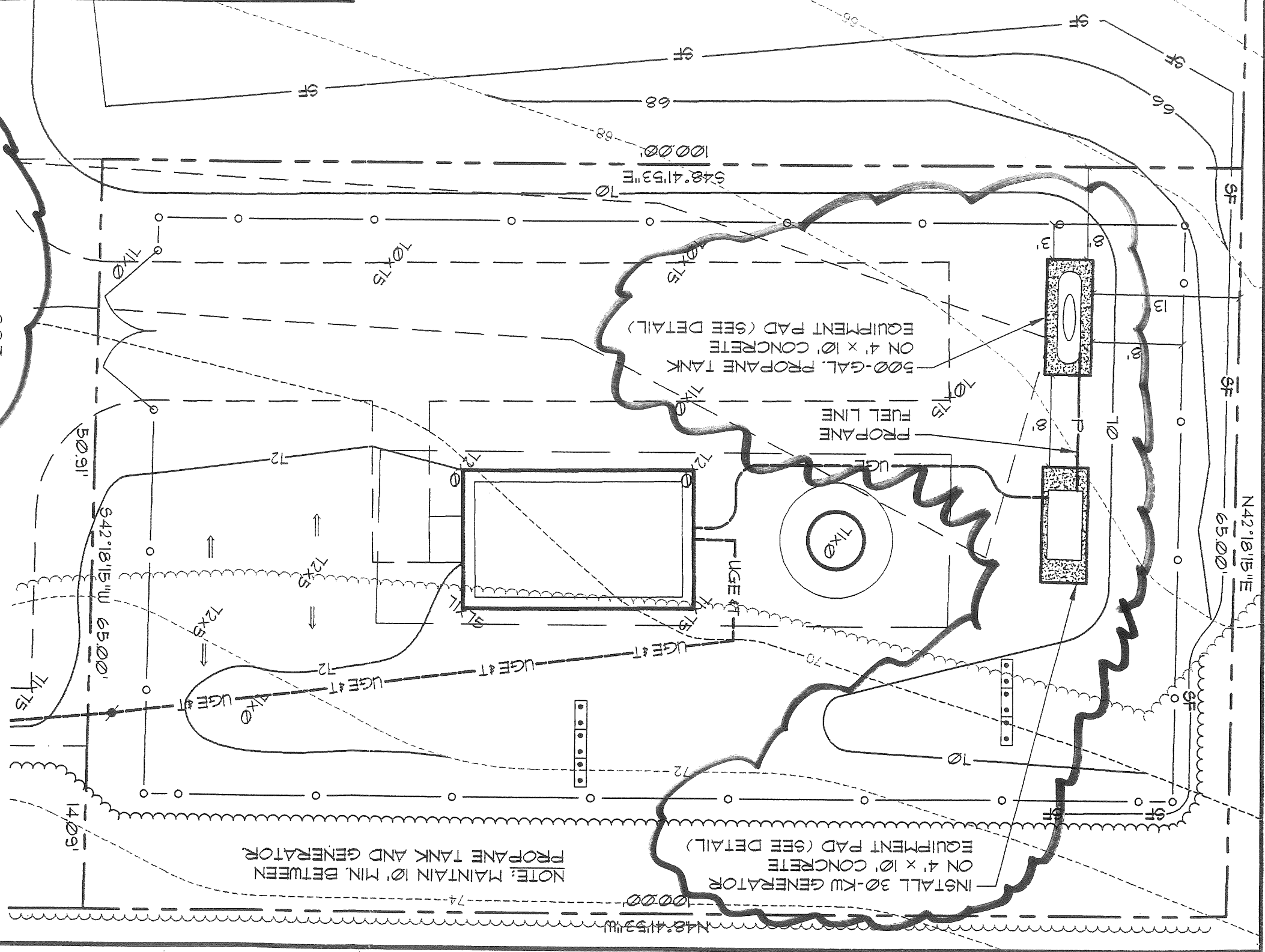
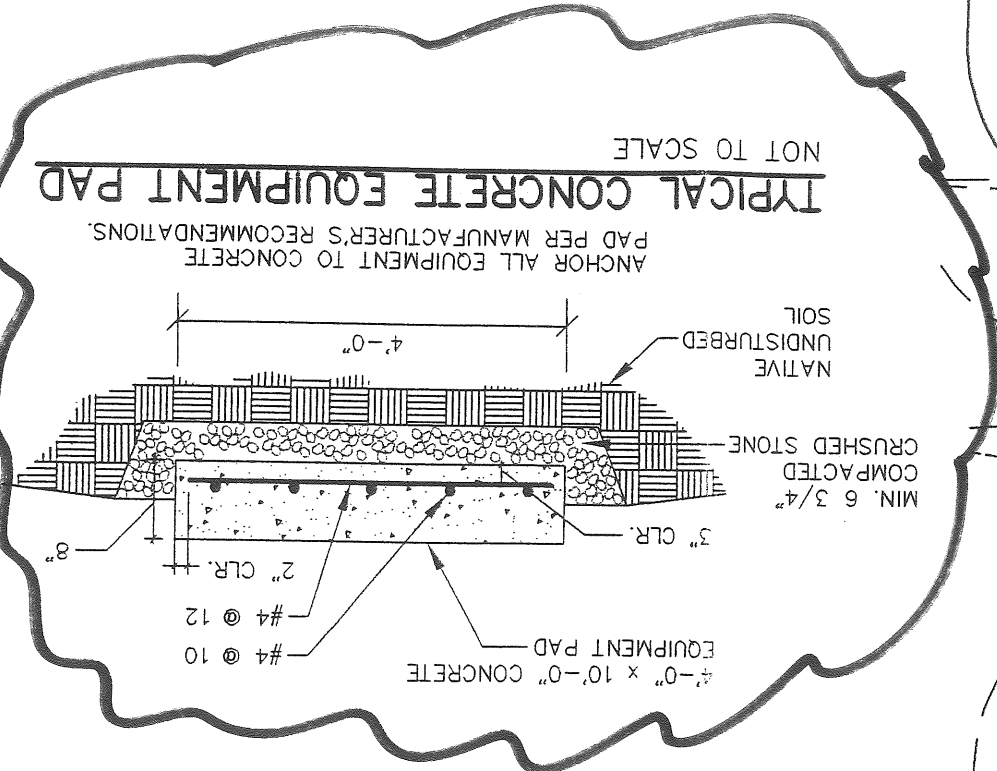

ADDENDUM NO. 2
 OF:
 NORTH PORTLAND SWITCH FACILITY
 1340 RIVERSIDE STREET
 PORTLAND, MAINE
 FOR:
 ATLANTIC CELLULAR TELEPHONE CORP.
 2002 PISGAH CHURCH ROAD
 GREENSBORO, NC 27455

Sebago Technics
Engineering & Planning for the Future
 12 WESTBROOK COMMON
 WESTBROOK, ME 04098-1339
 TEL (207) 856-0277

DESIGN BY: MSL
DRAWN BY: MAL
CHECKED BY: CLB
DATE: 4/8/97
SCALE: 1"=10'
FIELD BK: 510
PROJ. NO: 96369
DRAWING: 96369ADD

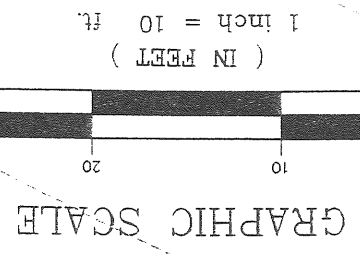

ADDENDUM NO. 1 - ADD CONCRETE PADS, GENERATOR,
 PROpane TANK AND UNDERGROUND UTILITIES.

