



Structural Engineering  
**BECKER STRUCTURAL ENGINEERS, INC.**  
 1144 E. Portland Avenue  
 Portland, ME 04101  
 MECHANICAL SYSTEMS ENGINEERS  
 Electrical Engineering  
**SWIFT CURRENT ENGINEERING**

**Riverside Golf Course - North Course Club House Renovations PHASE II**  
 Riverside Street  
 Portland, Maine

REVISIONS

3 REMOVE EXISTING STOREFRONT FRAMING AND ENTRANCE IN PREPARATION FOR REPLACEMENT.

2 REMOVE PORTIONS OF EXTERIOR WALLS AS REQUIRED TO CREATE ROUGH OPENINGS FOR NEW WINDOW AND DOOR UNITS.

1 REMOVE ALL PARTITIONS, CEILINGS, LIGHTING, DUCTWORK, FINISHES, ETC. IN PREPARATION FOR NEW FIT UP WORK

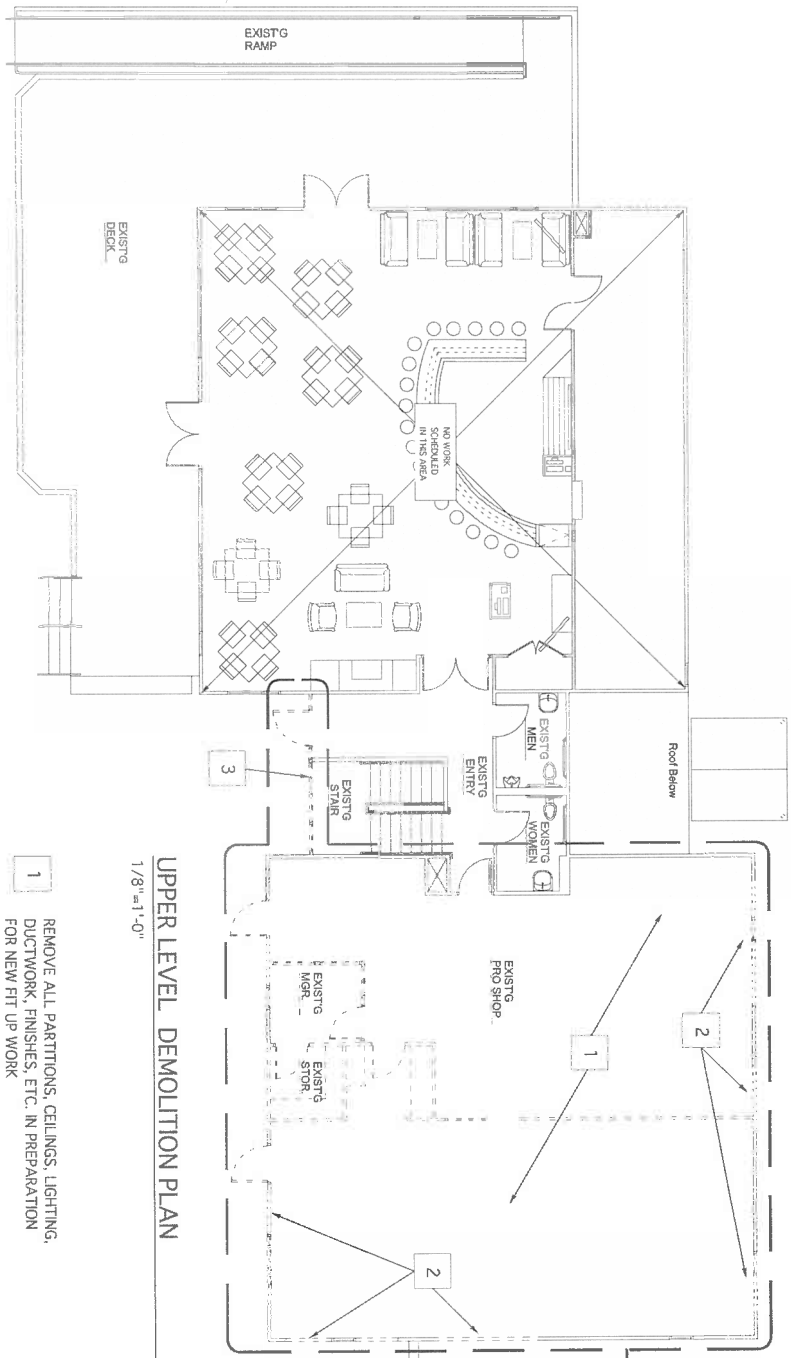

UPPER LEVEL DEMOLITION PLAN  
 1/8"=1'-0"