

SECTION VIEW - MODEL 4824VHB-C
HOOD - #2 (Dishwasher)

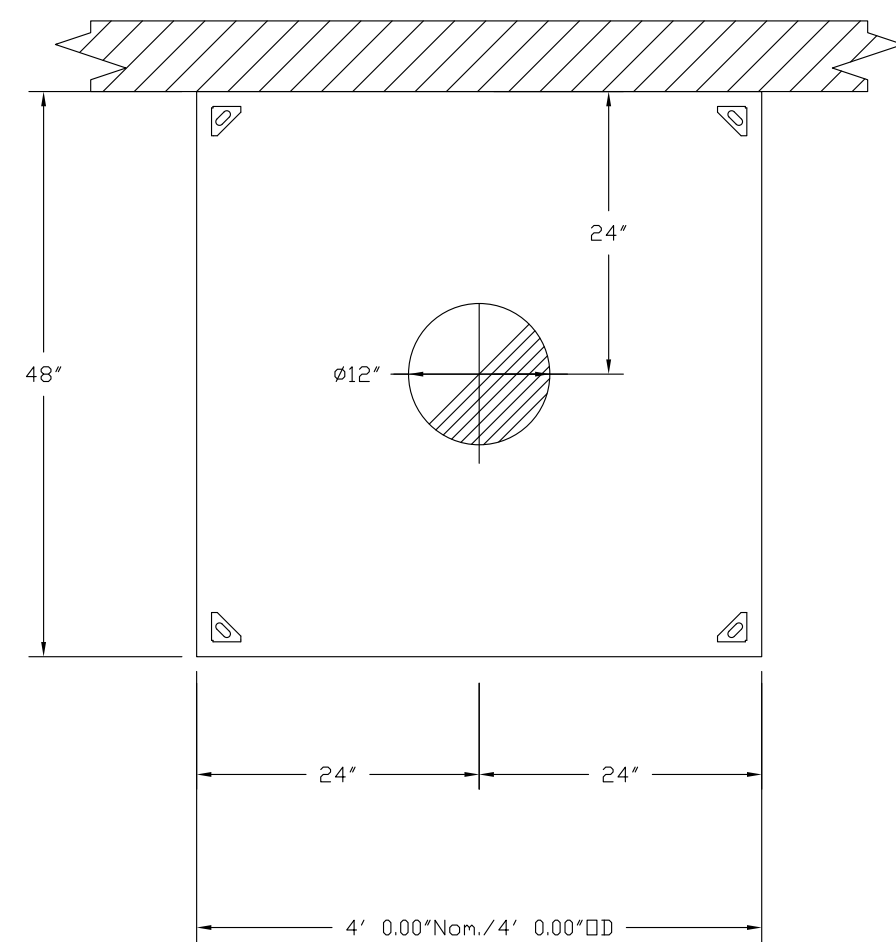

PLAN VIEW - Hood #2 (Dishwasher)
4' 0.00" LONG 4824VHB-C

EXHAUST FAN INFORMATION - Job#1978265

FAN UNIT NO.	TAG	FAN UNIT MODEL #	CFM	ESP.	RPM	H.P.	Ø	VOLT	FLA	WEIGHT (LBS.)	SONES
1		NCA16FA	3000	1.000	1070	1.500	1	230	10.2	203	12.5
3	Dishwasher	DU30HFA	600	0.350	1119	0.250	1	115	4.0	98	6.7

MUA FAN INFORMATION - Job#1978265

FAN UNIT NO.	TAG	FAN UNIT MODEL #	BLOWER	HOUSING	CFM	ESP.	RPM	H.P.	Ø	VOLT	FLA	WEIGHT (LBS.)	SONES
2		A1-G10	G10	A1	2700	0.400	892	2.000	1	230	12.5	301	19.2

FAN OPTIONS

FAN UNIT NO.	TAG	OPTION (Qty. - Descr.)
1		1 - Grease Box
		1 - Fan Base Ceramic Seal - For Grease Ducts
		1 - Full Crating For Exhaust Fans
2		1 - Full Crating For Untempered Fans
		1 - Gravity Backdraft Damper for Size 1 Housing
3	Dishwasher	1 - 1 15-BDD Damper
		1 - SCR-11 Bird Screen
		1 - Full Crating For Exhaust Fans

FAN ACCESSORIES

FAN UNIT NO.	TAG	EXHAUST				SUPPLY			
		GREASE CUP	GRAVITY DAMPER	WALL MOUNT	SIDE DISCHARGE	GRAVITY DAMPER	MOTORIZED DAMPER	WALL MOUNT	
2					YES	YES			
3	Dishwasher								

CURB ASSEMBLIES

NO.	DN FAN	WEIGHT	ITEM	SIZE		
1	# 1	41 LBS	Curb	26.500"W x 26.500"L x 20.000"H	SPECIFY Pitch	Vented Hinged
2	# 2	29 LBS	Curb	21.000"W x 21.000"L x 20.000"H	SPECIFY Pitch	
3	# 3	34 LBS	Curb	19.500"W x 19.500"L x 22.000"H	SPECIFY Pitch	Vented Hinged

REVISIONS

DESCRIPTION	DATE

CAPTIVE AIR

MAINE OFFICE

www.captiveair.com

PO Box 86, 179 South Rd., Topshfield, ME, 04430 PHONE: (207) 796-2690 FAX: (919) 227-5946 EMAIL: reg2@captiveair.com

Riverside Golf Course r1
WINTHROP, ME

DATE: 2/26/2014

DWG.#: 1978265

DRAWN BY: BFC-21

SCALE: 3/4" = 1'-0"

MASTER DRAWING

SHEET NO. 2