

NOTES:

- SEE E000 FOR LEGEND, ABBREVIATIONS AND GENERAL NOTES.

KEYED NOTES:

- MOUNT AND CATV JACK RECEPTACLE 80" AFF
- 2#10AWG & #10GND, 3/4"C
- 3#12AWG & #12GND, 3/4"C
- 3#6AWG & #8GND, 1"C

Structural Engineering:
BECKER STRUCTURAL ENGINEERS, INC.

HVAC & plumbing Engineering:
MECHANICAL SYSTEMS ENGINEERS

Electrical Engineering:
SWIFTCURRENT ENGINEERING

Food Service Design Consultant:
TJM CONSULTING

Riverside Golf Course - North Course Club House Design Study

Riverside Street
Portland, Maine

REVISIONS

PERMIT
DOCUMENTS
January 14, 2013

Electrical Power &
Systems Plans
Scale: As Noted

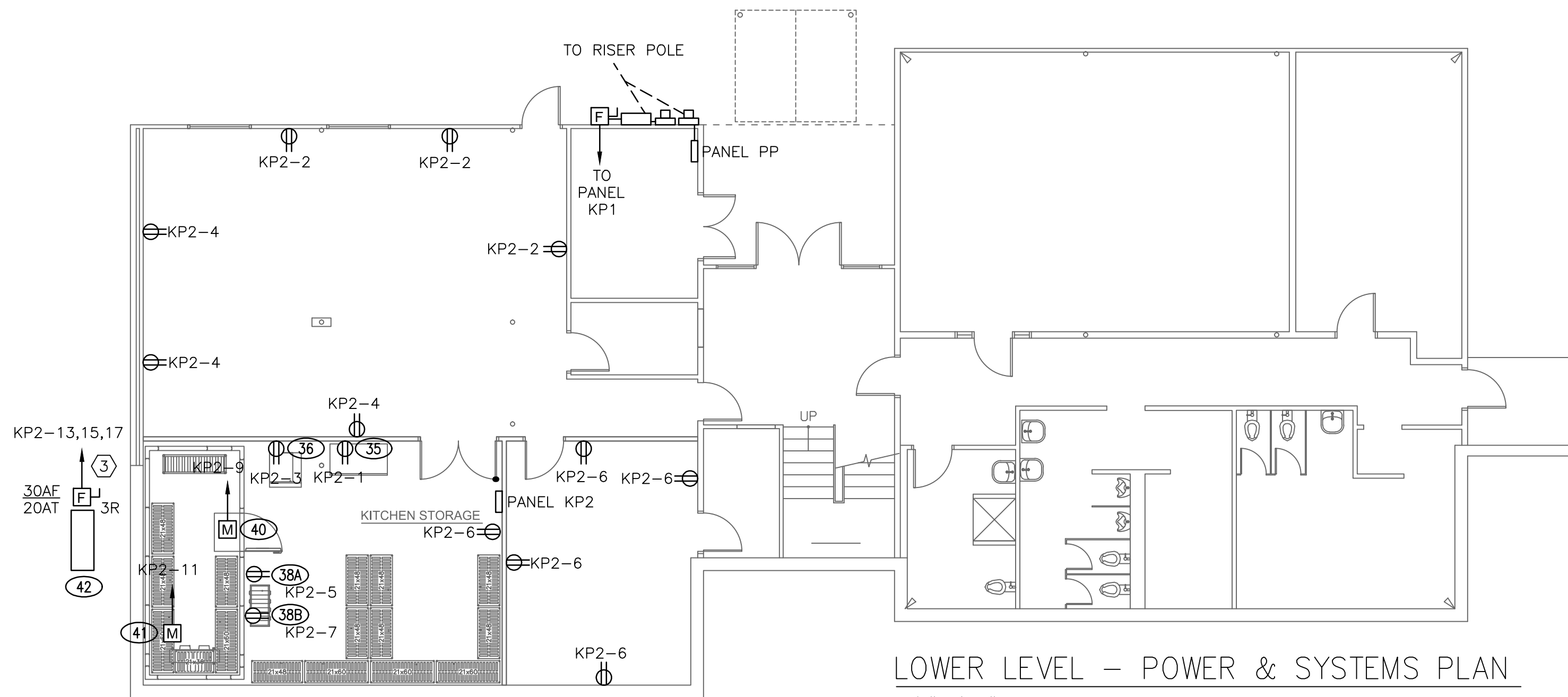

LOWER LEVEL - POWER & SYSTEMS PLAN
1/8"=1'-0"

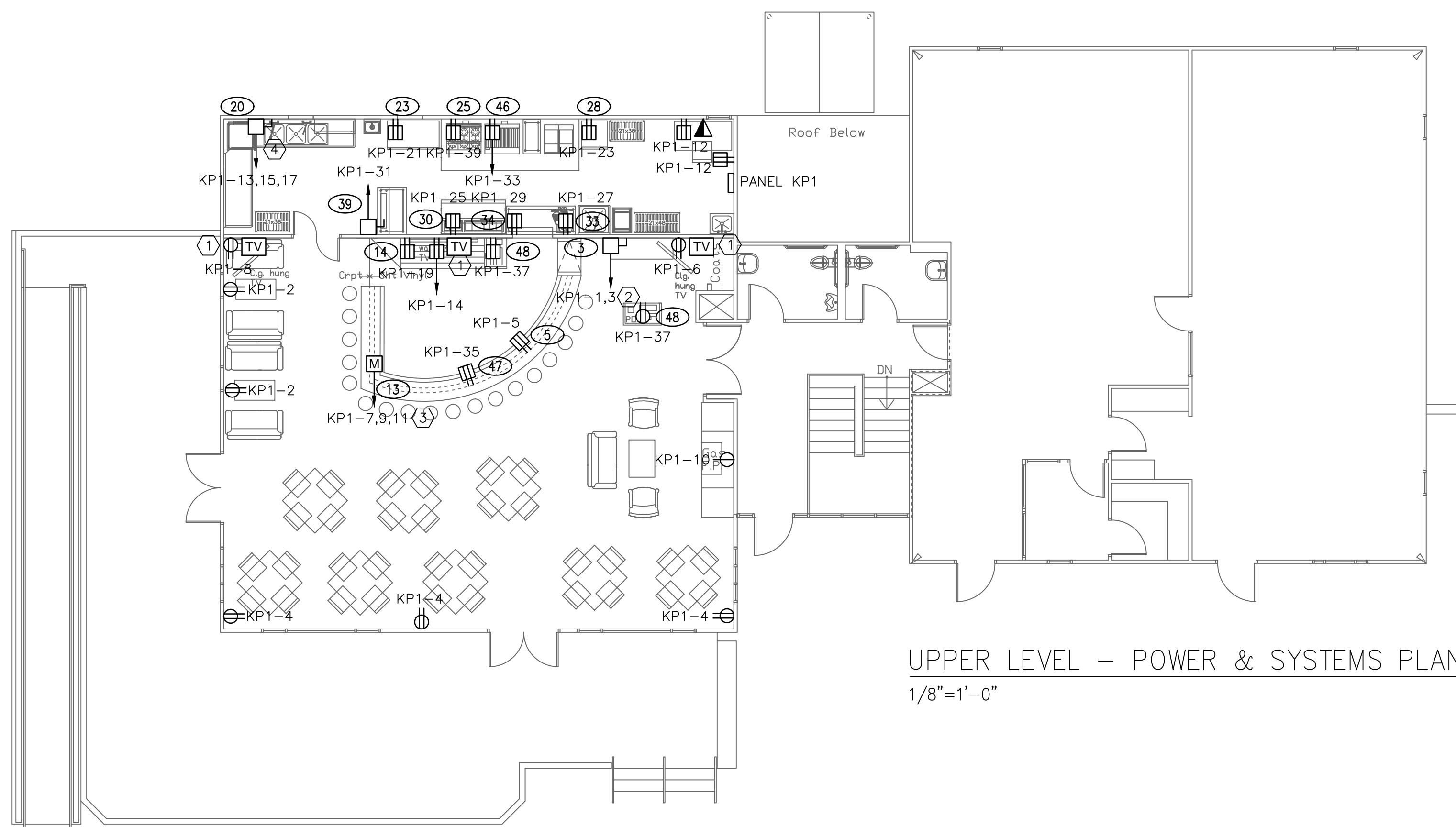

UPPER LEVEL - POWER & SYSTEMS PLAN
1/8"=1'-0"

FOR REVIEW
NOT FOR CONSTRUCTION