

Location of Construction: 1173 Riverside St.		Owner: Factors Financial		Phone:		Permit No:	
Owner Address:		Lessee/Buyer's Name: Maine Indoor Sports		Phone: 797-9940		Business Name:	
Contractor Name: Sign Pro		Address:		Phone:		Permit Issued:	
Past Use: Indoor Recreation Facility		Proposed Use: Same w/signage		COST OF WORK: \$XXXXX		PERMIT FEE: \$31.40	
				FIRE DEPT. <input type="checkbox"/> Approved <input type="checkbox"/> Denied		INSPECTION: Use Group: Type:	
				Signature:		Signature:	
Proposed Project Description: Erect signage - lighted				PEDESTRIAN ACTIVITIES DISTRICT (P.A.D.)			
				Action: Approved <input type="checkbox"/> Approved with Conditions: <input type="checkbox"/> Denied <input type="checkbox"/>			
				Signature:		Date:	
Permit Taken By: Vicki Dover		Date Applied For: 12/22/97					

Zone: I-M **CBL:** 355-A-012

Zoning Approval:

Special Zone or Reviews:

Shoreland
 Wetland
 Flood Zone
 Subdivision
 Site Plan maj minor mm

Zoning Appeal

Variance
 Miscellaneous
 Conditional Use
 Interpretation
 Approved
 Denied

Historic Preservation

Not in District or Landmark
 Does Not Require Review
 Requires Review

Action:

Approved
 Approved with Conditions
 Denied

Date: _____

1. This permit application does not preclude the Applicant(s) from meeting applicable State and Federal rules.
2. Building permits do not include plumbing, septic or electrical work.
3. Building permits are void if work is not started within six (6) months of the date of issuance. False information may invalidate a building permit and stop all work..

UL# BB-312139

MAIL TO: MAINE INDOOR SPORTS
 1173 RIVERSIDE ST.
 PORTLAND, ME 04103

CERTIFICATION

I hereby certify that I am the owner of record of the named property, or that the proposed work is authorized by the owner of record and that I have been authorized by the owner to make this application as his authorized agent and I agree to conform to all applicable laws of this jurisdiction. In addition, if a permit for work described in the application is issued, I certify that the code official's authorized representative shall have the authority to enter all areas covered by such permit at any reasonable hour to enforce the provisions of the code(s) applicable to such permit

SIGNATURE OF APPLICANT 		ADDRESS:		DATE: 12/22/97		PHONE:	
RESPONSIBLE PERSON IN CHARGE OF WORK, TITLE David Massaro Maine Indoor Sports						PHONE:	

CEO DISTRICT

BUILDING PERMIT REPORT

DATE: 31 Dec. 97 ADDRESS: 1173 Riverside ST.
REASON FOR PERMIT: To erect signage
BUILDING OWNER: Factors Financial
CONTRACTOR: Sign Pro
PERMIT APPLICANT: David Massaro APPROVAL: *1, *2 ~~PERMITS~~
USE GROUP U BOCA 1996 CONSTRUCTION TYPE _____

CONDITION(S) OF APPROVAL

1. This permit does not excuse the applicant from meeting applicable State and Federal rules and laws.
2. Before concrete for foundation is placed, approvals from ~~the Development Review Coordinator and~~ Inspection Services must be obtained. (A 24 hour notice is required prior to inspection)
3. Precaution must be taken to protect concrete from freezing.
4. It is strongly recommended that a registered land surveyor check all foundation forms before concrete is placed. This is done to verify that the proper setbacks are maintained.
5. Private garages located beneath habitable rooms in occupancies in Use Group R-1, R-2, R-3 or I-1 shall be separated from adjacent interior spaces by fire partitions and floor/ceiling assembly which are constructed with not less than 1-hour fire resisting rating. Private garages attached side-by-side to rooms in the above occupancies shall be completely separated from the interior spaces and the attic area by means of ½ inch gypsum board or the equivalent applied to the garage means of ½ inch gypsum board or the equivalent applied to the garage side. (Chapter 4 Section 407.0 of the BOCA/1996)
6. All chimneys and vents shall be installed and maintained as per Chapter 12 of the City's Mechanical Code. (The BOCA National Mechanical Code/1993).
7. Sound transmission control in residential building shall be done in accordance with Chapter 12 section 1214.0 of the city's building code.
8. Guardrails & Handrails: A guardrail system is a system of building components located near the open sides of elevated walking surfaces for the purpose of minimizing the possibility of an accidental fall from the walking surface to the lower level. Minimum height all Use Groups 42", except Use Group R which is 36". In occupancies in Use Group A, B, I-4, I-1, I-2 M and R and public garages and open parking structures, open guards shall have balusters or be of solid material such that a sphere with a diameter of 4" cannot pass through any opening. Guards shall not have an ornamental pattern that would provide a ladder effect. (Handrails shall be a minimum of 34" but not more than 38". Use Group R-3 shall not be less than 30", but not more than 38".)
9. Headroom in habitable space is a minimum of 7'6".
10. Stair construction in Use Group R-3 & R-4 is a minimum of 10" tread and 7 3/4" maximum rise. All other Use group minimum 11" tread, 7" maximum rise.
11. The minimum headroom in all parts of a stairway shall not be less than 80 inches. (6' 8")
12. Every sleeping room below the fourth story in buildings of use Groups R and I-1 shall have at least one operable window or exterior door approved for emergency egress or rescue. The units must be operable from the inside without the use of special knowledge or separate tools. Where windows are provided as means of egress or rescue they shall have a sill height not more than 44 inches (1118mm) above the floor. All egress or rescue windows from sleeping rooms shall have a minimum net clear opening height dimension of 24 inches (610mm). The minimum net clear opening width dimension shall be 20 inches (508mm), and a minimum net clear opening of 5.7 sq. ft.
13. Each apartment shall have access to two (2) separate, remote and approved means of egress. A single exit is acceptable when it exits directly from the apartment to the building exterior with no communications to other apartment units.
14. All vertical openings shall be enclosed with construction having a fire rating of at least one (1) hour, including fire doors with self closer's.
15. The boiler shall be protected by enclosing with (1) hour fire-rated construction including fire doors and ceiling, or by providing automatic extinguishment.
16. All single and multiple station smoke detectors shall be of an approved type and shall be installed in accordance with the provisions of the City's Building Code Chapter 9, Section 19, 920.3.2 (BOCA National Building Code/1996), and NFPA 101 Chapter 18 & 19. (Smoke detectors shall be installed and maintained at the following locations):
 - In the immediate vicinity of bedrooms
 - In all bedrooms

PLANS OF RIVERSIDE STREET RECONSTRUCTION

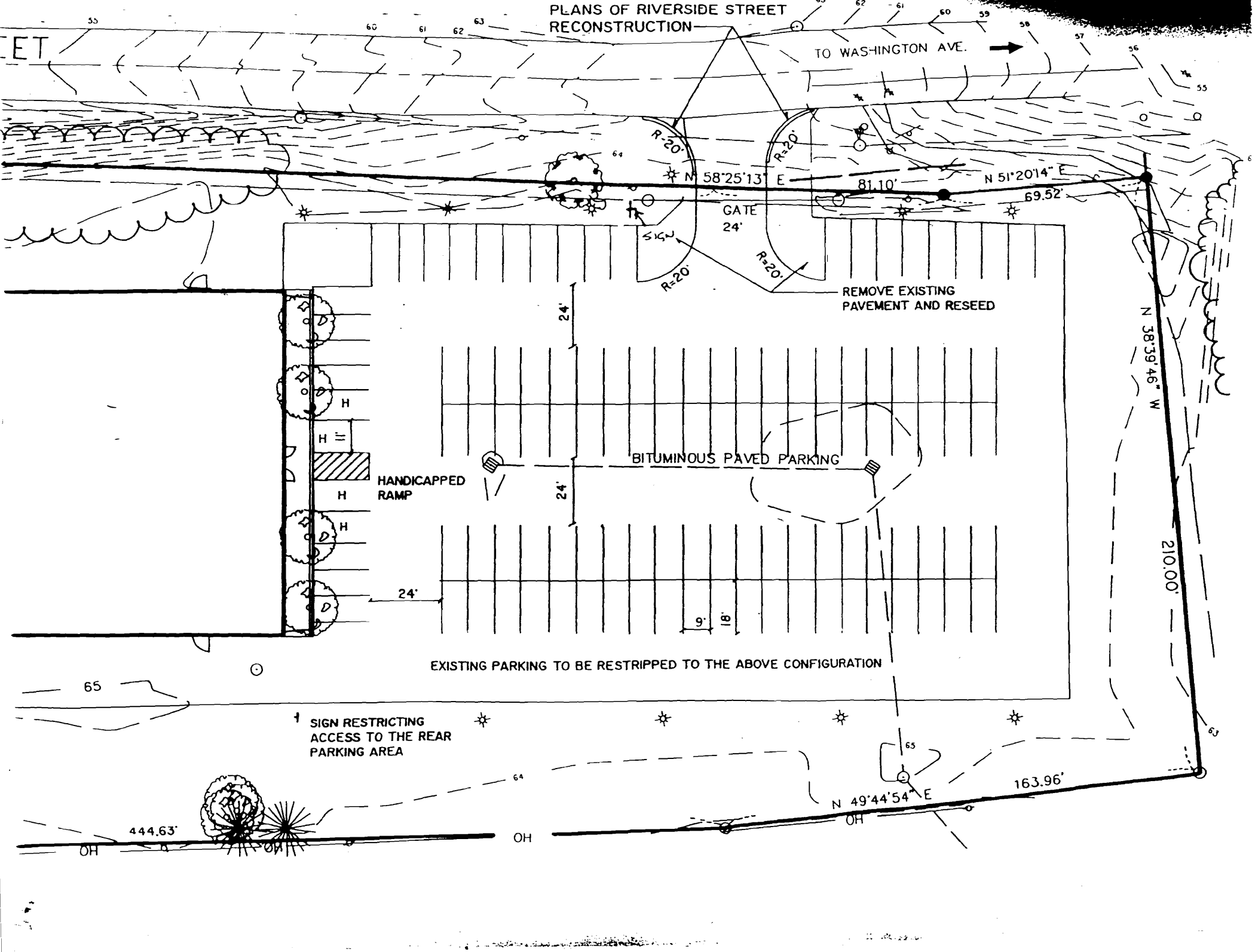

ET

TO WASHINGTON AVE. →

R=20'

N 58°25'13" E

SIGN

GATE 24'

R=20'

R=20'

REMOVE EXISTING PAVEMENT AND RESEED

BITUMINOUS PAVED PARKING

HANDICAPPED RAMP

EXISTING PARKING TO BE RESTRIPTED TO THE ABOVE CONFIGURATION

1 SIGN RESTRICTING ACCESS TO THE REAR PARKING AREA

N 38°39'46" W

210.00'

N 49°44'54" E

163.96'

444.63'

OH

OH

Single tenant Bldg
 35 # max
 10' high max
 5' franchises -
 ~ 15 # shown
 ~ 7' high shown
 unclutter, make it a condition

SIGNAGE

PLEASE ANSWER ALL QUESTIONS

ADDRESS: 1173 Riverside St., Portland ZONE: _____

OWNER: Indoor Sports Management

APPLICANT: Ron Pollard / Maine Indoor Sports Center

ASSESSOR NO.: _____

SINGLE TENANT LOT? YES NO _____

MULTI TENANT LOT? YES _____ NO

FREESTANDING SIGN? YES NO _____ DIMENSIONS 49" x 44"
 (ex. pole sign..) 3.66 x 4.083 = 14.94

MORE THAN ONE SIGN? YES _____ NO DIMENSIONS _____

BLDG. WALL SIGN? YES _____ NO DIMENSIONS _____
 (attached to bldg)

MORE THAN ONE SIGN? YES _____ NO DIMENSIONS _____

LIST ALL EXISTING SIGNAGE AND THEIR DIMENSIONS: NONE

LOT FRONTAGE (FEET) 168' x 220'

BLDG FRONTAGE (FEET) 108' x 28'

AWNING YES _____ NO IS AWNING BACKLIT? YES _____ NO _____

HEIGHT OF AWNING: _____

IS THERE ANY COMMUNICATION, MESSAGE, TRADEMARK OR SYMBOL ON IT? NO

A SITE SKETCH AND BUILDING SKETCH SHOWING EXACTLY WHERE EXISTING AND NEW

SIGNAGE IS LOCATED MUST BE PROVIDED. SKETCHES AND/OR PICTURES OF THE

PROPOSED SIGNS ARE ALSO REQUIRED.