

- NOTES:**
1. CONCRETE: 4,000 PSI MINIMUM AFTER 28 DAYS.
 2. CONSTRUCTION OF TRAINING PIT CONFORMS WITH DEP TITLE 5 REGS, 310 CMR, SECTION 15.226
 3. ALL REINFORCEMENT PER ASTM C1227..
 4. TEES AND GAS BAFFLE SOLD SEPARATELY.
 5. TONGUE & GROOVE JOINT SEALED WITH BUTYL RESIN.

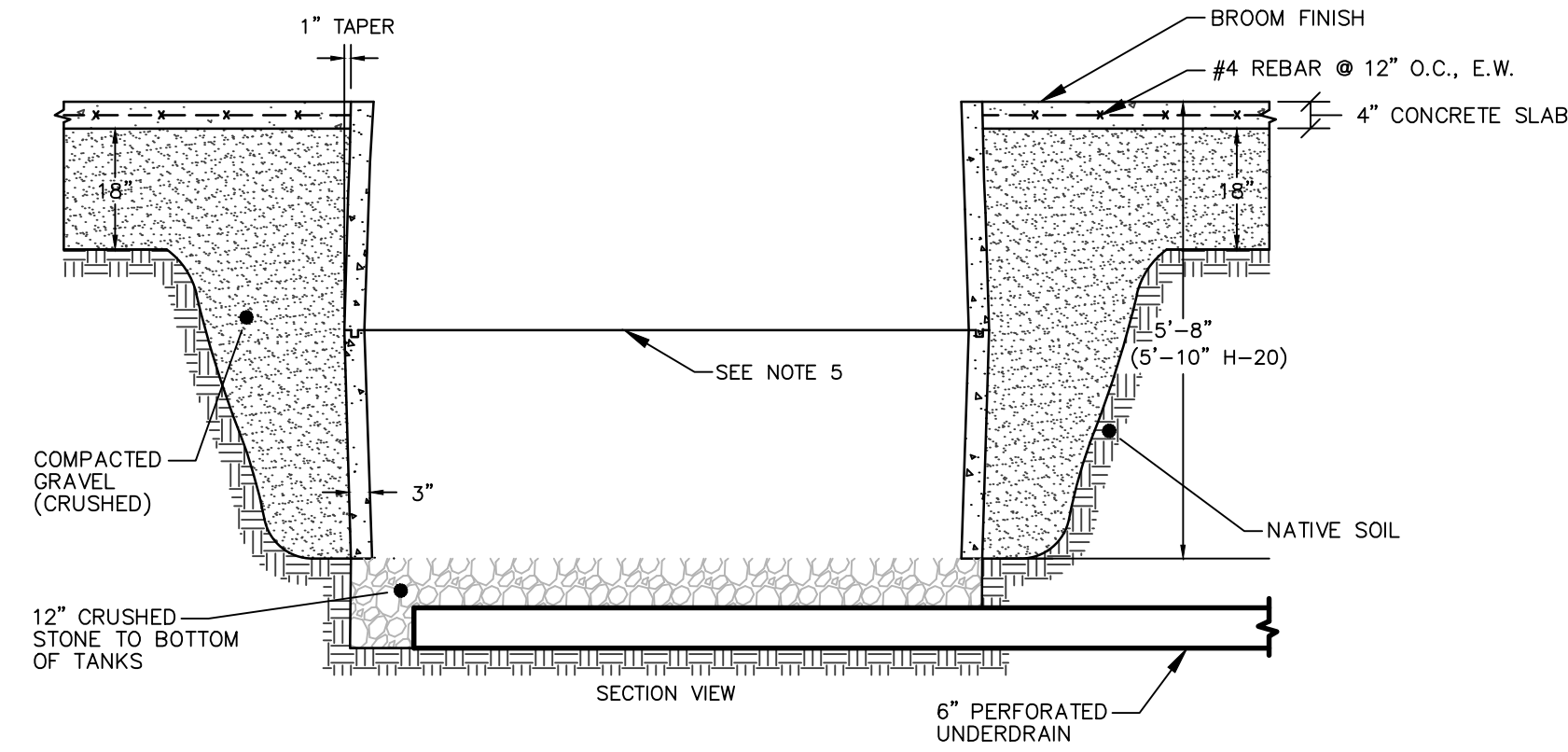

1000 GALLON TRAINING PIT
NOT TO SCALE

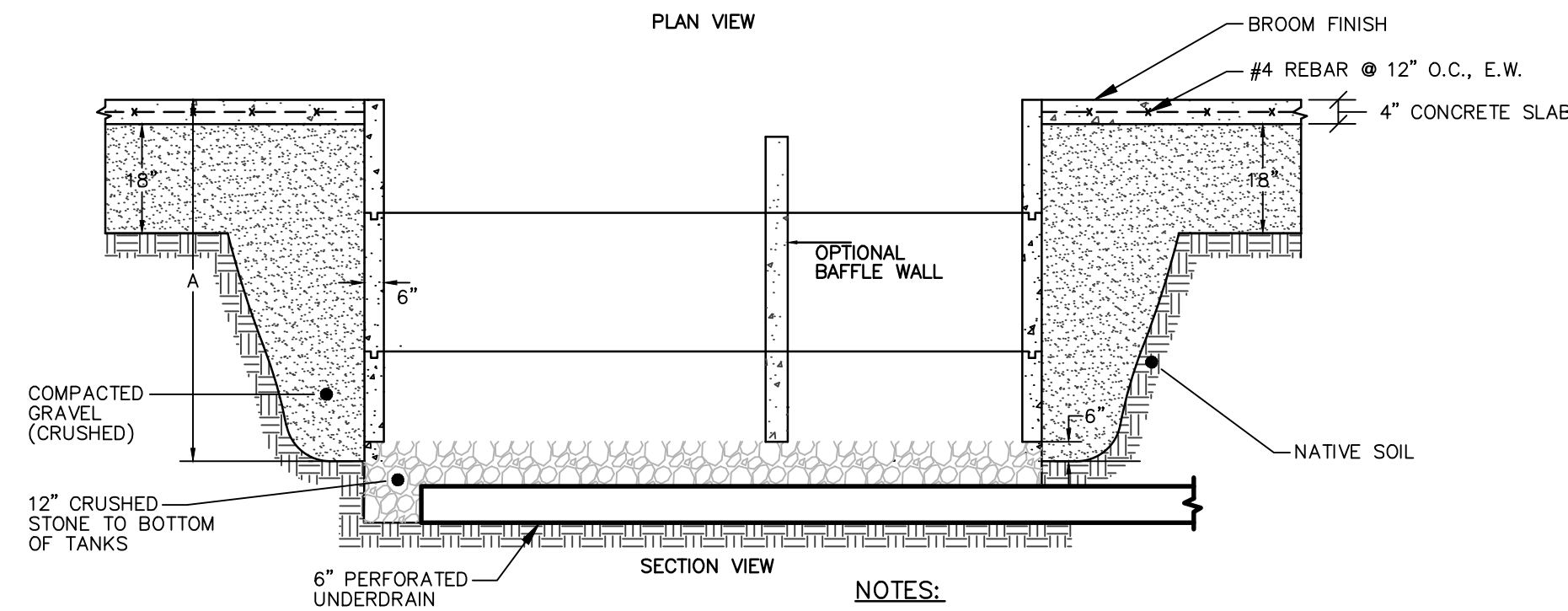
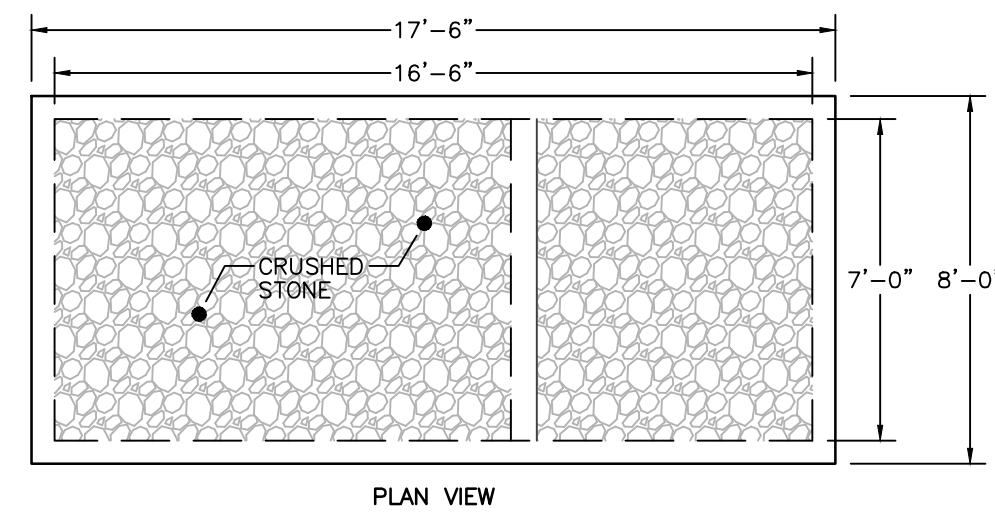

- NOTES:**
1. CONCRETE: 5,000 PSI MINIMUM AFTER 28 DAYS.
 2. CONSTRUCTION OF TRAINING PIT CONFORMS WITH DEP TITLE 5 REGS, 310 CMR, SECTION 15.226
 3. ALL REINFORCEMENT PER ASTM C1227..
 4. TEES AND GAS BAFFLE SOLD SEPARATELY.
 5. TONGUE & GROOVE JOINT SEALED WITH BUTYL RESIN. INLET HEIGHT MAY INCREASE SLIGHTLY DUE TO THE BUTYL RESIN USED.

2500 TO 3000 GALLON TRAINING PIT
NOT TO SCALE

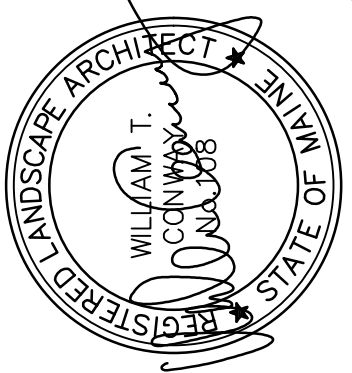

DESIGNED	CHECKED
WTC	WTC
B WTC 08-05-16 ISSUED FOR CITY OF PORTLAND PERMITTING (PHASE 2) A WTC 04-17-15 ISSUED FOR CITY OF PORTLAND PERMITTING (PHASE 1) REV. BY: DATE: STATUS: THIS PLAN SHALL NOT BE MODIFIED WITHOUT WRITTEN PERMISSION FROM SEBAGO TECHNIQS, INC. ANY ALTERATIONS AUTHORIZED OR OTHERWISE, SHALL BE AT THE USER'S SOLE RISK AND WITHOUT LIABILITY TO SEBAGO TECHNIQS, INC.	

SEBAGO
TECHNICS
WWW.SEBAGOTECHNIQS.COM
250 Goddard Rd.
Suite B
Leicester, MA 04106
Tel. 207-783-5656

DETAILS OF: **NORTHERN UTILITIES, INC. PORTLAND DOC FIT-UP**
400 RIVERSIDE INDUSTRIAL PARKWAY
PORTLAND, MAINE
FOR: **UNITIL**
6 LIBERTY LANE, WEST
HAMPTON, NH 03842

PROJECT NO.	SCALE
14453	NTS

SHEET C1.3