

NOTES:
REMOVE ALL "NOT AN EXIT" SIGNS FROM ALL EXISTING DOORS THROUGHOUT ENTIRE BUILDING.

PROPOSED USE:
IBC 2009:
BUSINESS GROUP B
LOW-HAZARD STORAGE, GROUP S-2

NFPA 101 (2009):
EXISTING BUSINESS
STORAGE

OVERALL BUILDING AREA:
FIRST FLOOR: 59,410 SF
SECOND FLOOR: 5,960 SF
TOTAL BUILDING: APPROXIMATELY 65,370 SF

TOTAL OCCUPANT LOAD:
BUSINESS USE:
AREA "A": 60
AREA "B": 43
SECOND FLOOR: 60
TOTAL: 163
STORAGE USE: 99
TOTAL BUILDING O.L.: 262

FIRE SUPPRESSION:
FIRE SUPPRESSION SPRINKLER SYSTEM LAYOUT TO BE RECONFIGURED AS REQUIRED TO ACCOMMODATE SPACE LAYOUT.

FIRE PARTITIONS:
1 HOUR FIRE RATED ——— 1HR-FP ———

- SYMBOLS LEGEND:**
- EXIT SIGN - ARROW DENOTES EXIT SIGN TO BE PROVIDED WITH DIRECTIONAL ARROW
 - SEMI-RECESSED FIRE EXTINGUISHER CABINET AND FIRE EXTINGUISHER
 - WALL MOUNTED FIRE EXTINGUISHER
 - SMOKE DETECTOR
 - PULL STATION
 - HORN/STROBE DEVICE W/ CANDELLA RATING
 - STROBE DEVICE W/ CANDELLA RATING
 - EMERGENCY LIGHT FIXTURE
 - FIRE ALARM CONTROL PANEL
 - FIRE ALARM ANNUNCIATOR PANEL
 - KNOX-BOX

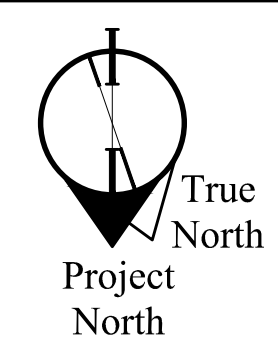
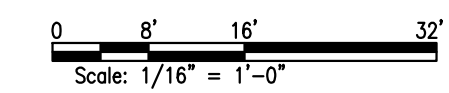
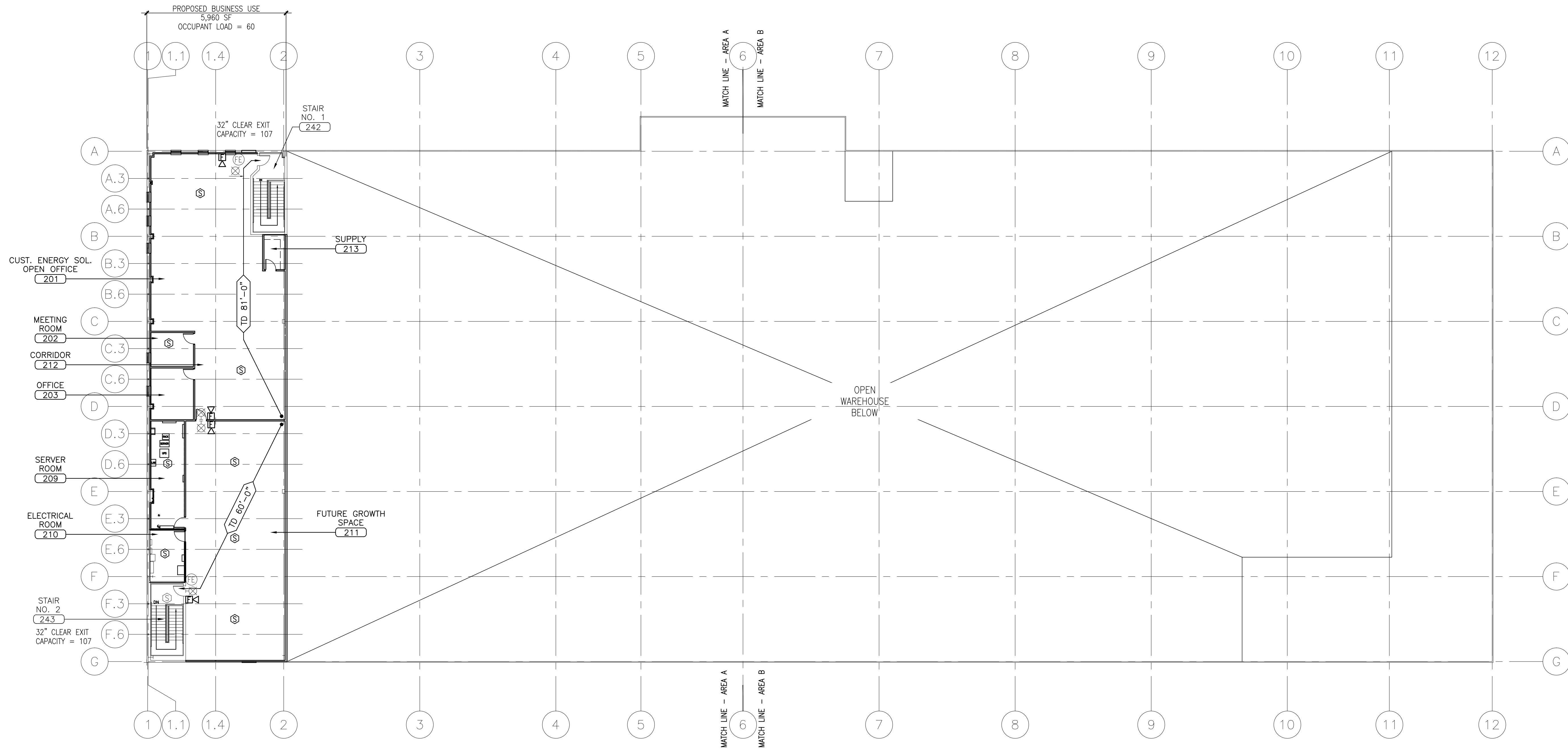

CWS ARCHITECTS

DESIGNER
GUY T. LABRECQUE, JR.
LICENSED ARCHITECT
STATE OF MAINE
CWS ARCHITECTS
ARCHITECTURE | INTERIOR DESIGN
434 CUMBERLAND AVENUE
PORTLAND, MAINE 04101
P: 207.774.4016
WWW.CWSARCH.COM

OWNER
UNITIL
6 LIBERTY LANE WEST
HAMPTON, NEW HAMPSHIRE
03842

PROJECT
NORTHERN UTILITIES, INC.
FIT-UP
400 RIVERSIDE INDUSTRIAL PARKWAY
PORTLAND, MAINE 04101

DRAWING
SECOND FLOOR LIFE SAFETY PLAN, NOTES AND LEGEND

REVISIONS

NO.	DATE	DESCRIPTION

DRAWING NUMBER
LS1.20
SCALE: 1/16" = 1'-0"
DATE: 04/17/15

A5 SECOND FLOOR LIFE SAFETY PLAN
REFERENCED FROM: SCALE: 1/16" = 1'-0"