

6:\CLIENTS\UNIVERSITY\Portland - Riverside\DRAWINGS\CURRENT\SASHEETS\SHEET 4/17/2015 11:41 AM

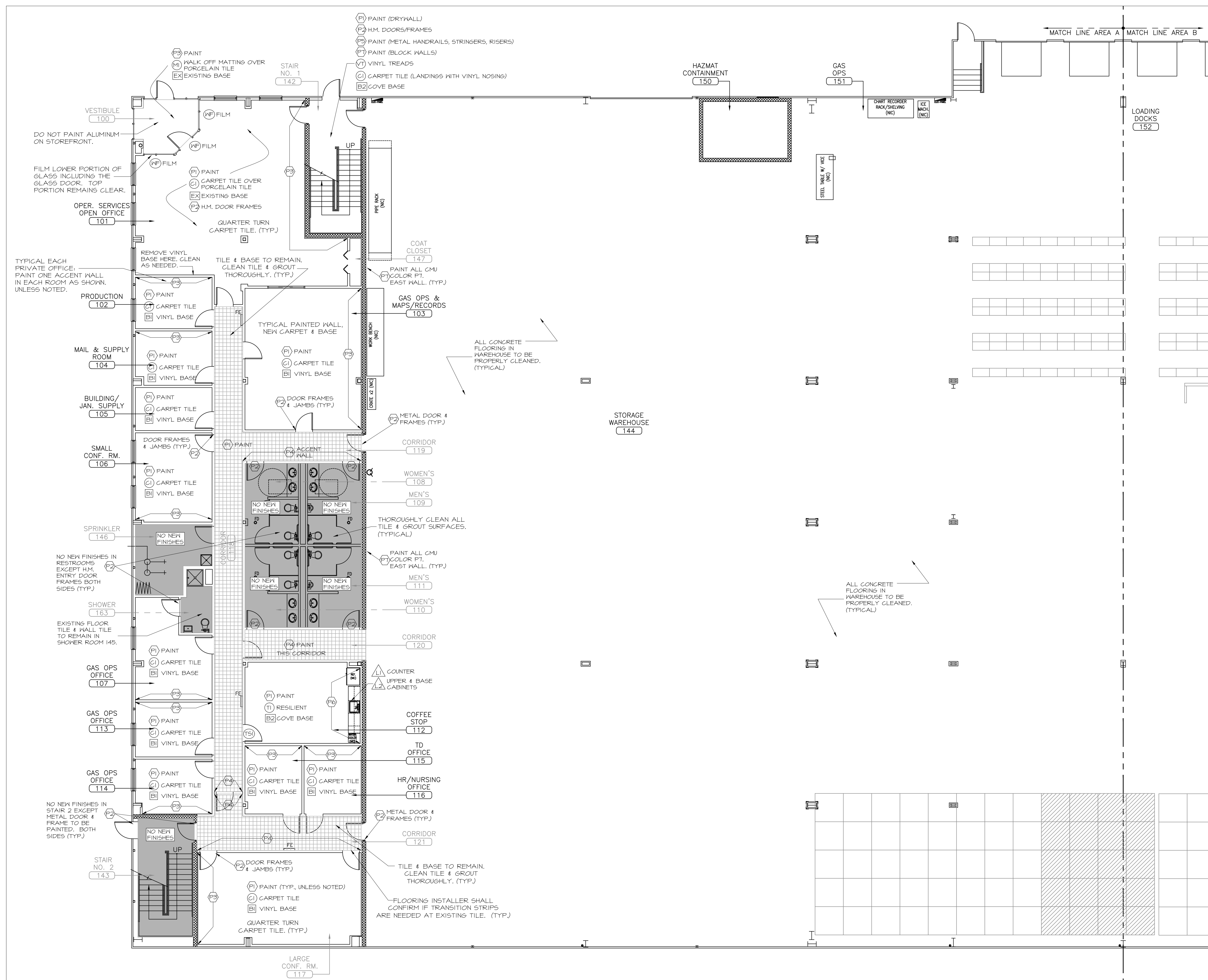

A FINISH PLAN - PARTIAL FRONT (AREA A)
1/8" = 1'-0"

NOTE: ROOMS ARE KEYED TO MASTER FINISH SCHEDULE ON ID.3

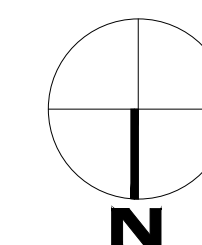

306 Highlander Way
Manchester, New Hampshire 03103
P. 603.623.8952 ■ F. 603.623.0593
www.stibler.com

Copyright © 2011 by Stibler Associates
No reproduction without permission.

UNITIL NORTHERN UTILITIES, INC.

400 RIVERSIDE
INDUSTRIAL PARKWAY
PORTLAND, ME

INFORMATION CONTAINED ON THIS DRAWING SHALL BE VERIFIED BY EACH VENDOR OR CONSULTANT PRIOR TO STARTING WORK. STIBLER ASSOCIATES IS NOT RESPONSIBLE FOR DISCREPANCIES OF FIELD DIMENSIONS OR CONDITIONS.

"ISSUED FOR CITY OF
PORTLAND PERMITTING"
DATE: 04 - 17 - 2015

REVISIONS:

1st FLOOR FINISH PLANS PART A

SCALE: 1/8" = 1'-0"
DRAWN BY: DH

ID.4A