

MATCHLINE RIGHT

MATCHLINE LEFT

EXISTING BUILDING

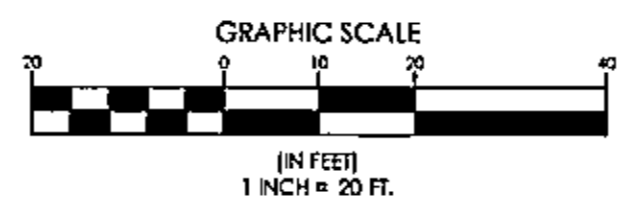
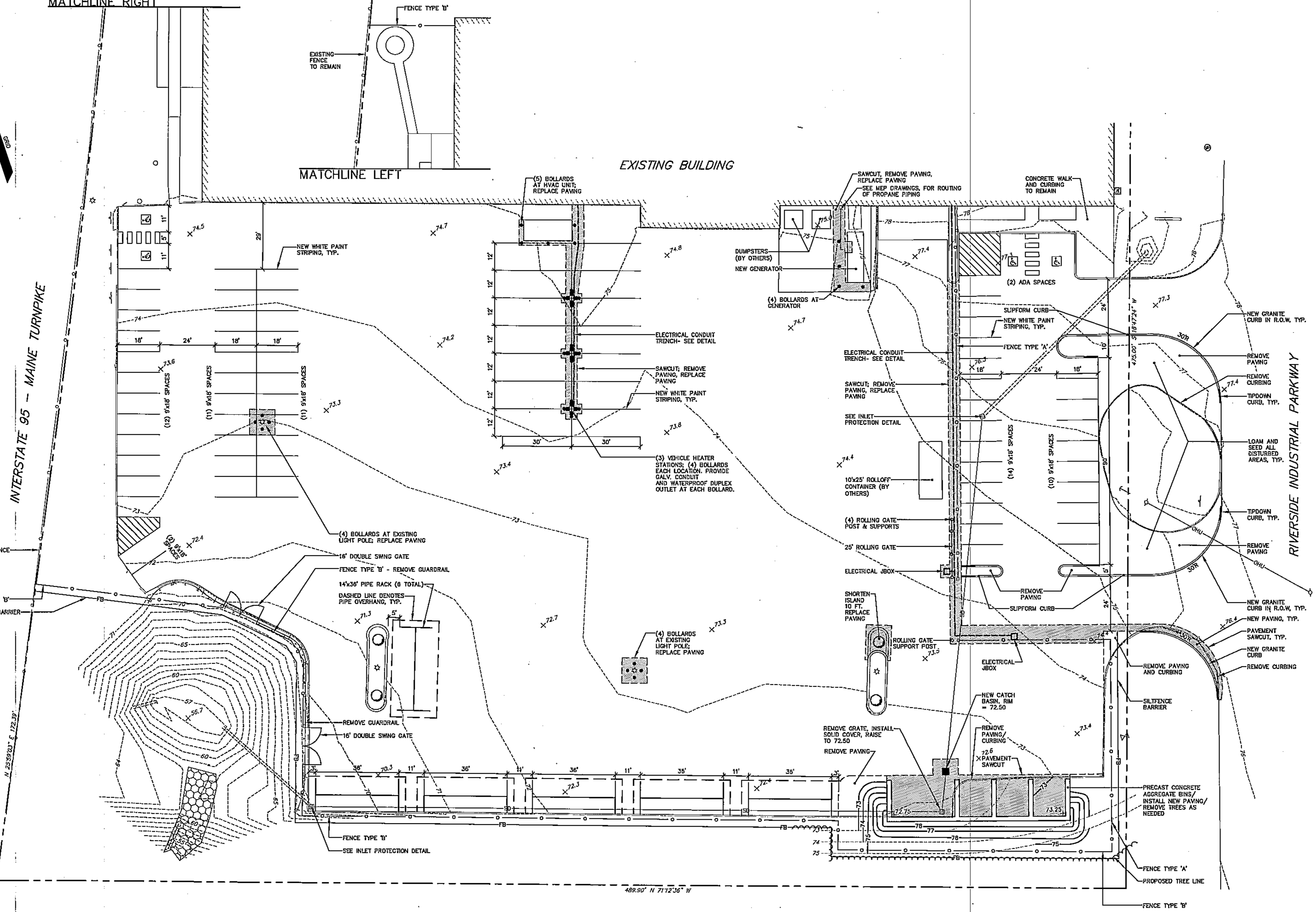

NOTES:

- PER THIS PLAN, THE IMPERVIOUS AREA ON THE SITE WILL BE REDUCED BY 572 S.F.
- ALL EXTERIOR SIGNS WILL BE FURNISHED AND INSTALLED BY OWNER.

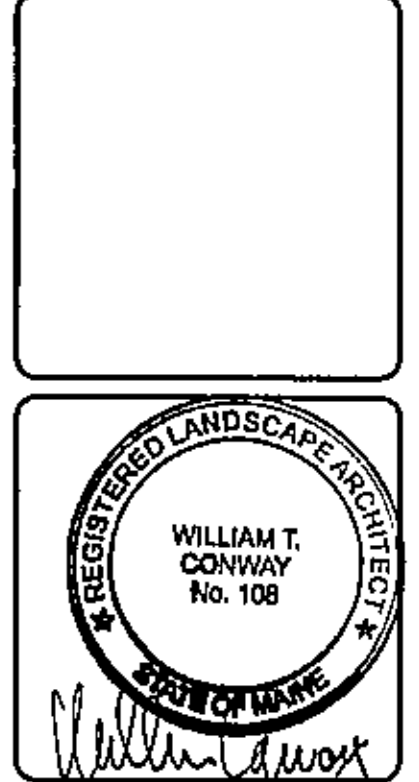

| DESIGNED | CHECKED |
|----------|---------|
| WTC | WTC |

A WTC 4-17-15 ISSUED FOR CITY OF PORTLAND PERMITTING
 REV. BY: DATE: STATUS:
 THIS PLAN SHALL NOT BE LOCATED WITHOUT WRITTEN PERMISSION FROM SEBAGO TECHNICS, INC. ANY ALTERATIONS, AUTHORIZED OR OTHERWISE, SHALL BE AT THE USER'S SOLE RISK AND WITHOUT LIABILITY TO SEBAGO TECHNICS, INC.

SEBAGO
TECHNICS

WWW.SEBAGOTECHNICS.COM
 75 John Roberts Rd. Suite B 04240
 South Portland, ME 04106
 Phone: 207-783-5658
 Fax: 207-783-5658

SITE PLAN OF: **NORTHERN UTILITIES, INC. PORTLAND DOC FIT-UP**

400 RIVERSIDE INDUSTRIAL PARKWAY
 PORTLAND, MAINE

FOR: **UNITIL**
 100 N. MAIN ST.
 HAMPTON, NH 03842

| | |
|-------------|----------|
| PROJECT NO. | SCALE |
| 14453 | 1" = 20' |

SHEET C1.1