

GOODWILL INDUSTRIES
FIT-UP - PLAN, DETAILS

Date: July 30, 2001
Scale: As Noted

ARCHITECTS, P.A.
ARCHITECTS
18 EIGHTH STREET, PORTLAND, MAINE 04101
(207) 772-6122 FAX (207) 772-4056

GOODWILL INDUSTRIES
1 RICE STREET
PORTLAND, MAINE

ALPINE REALTY
120 EXCHANGE STREET
PORTLAND, MAINE

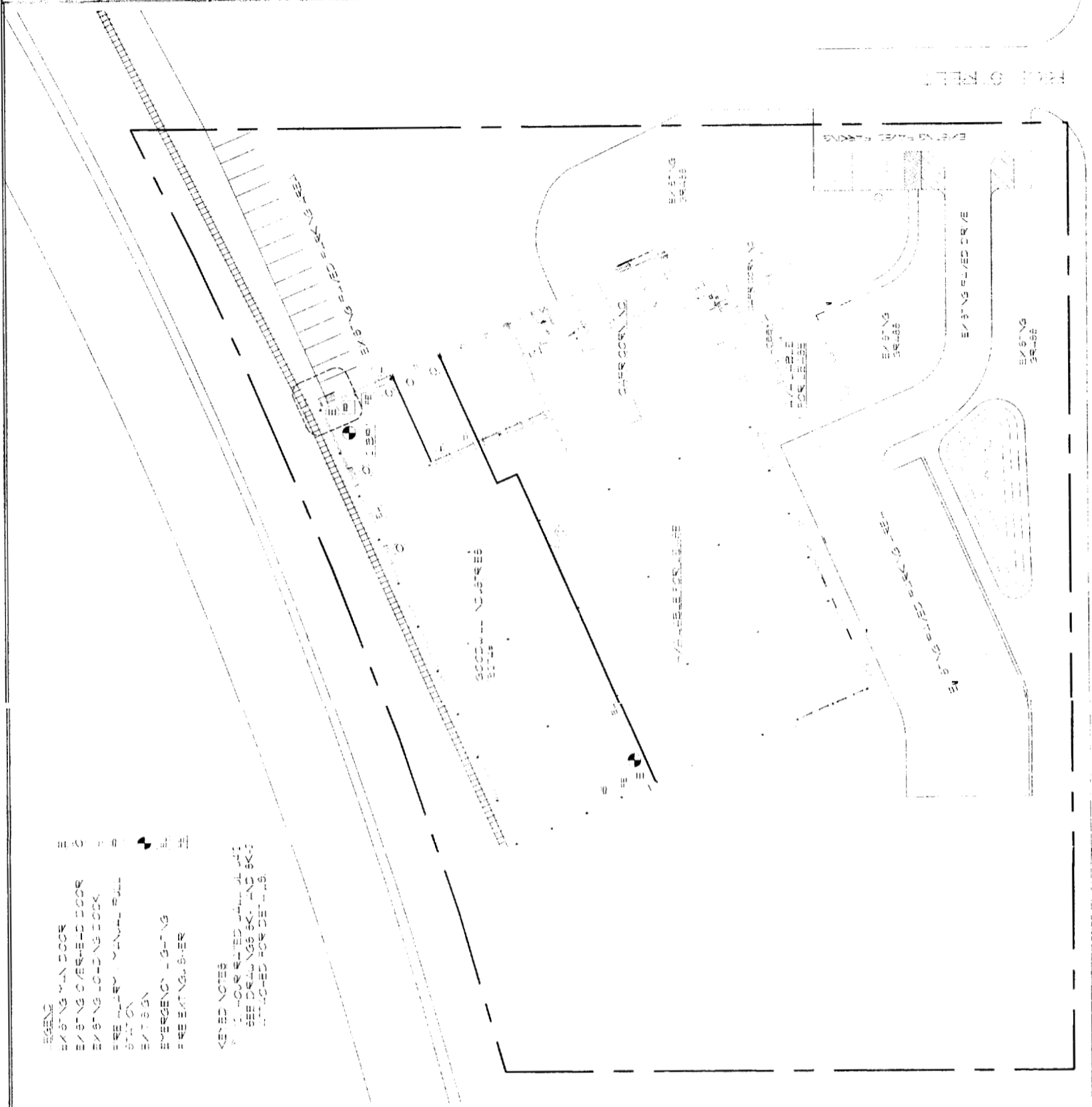
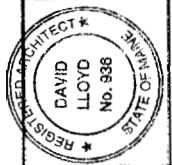

NO. 10 W. PARK ST.

FOOT OF FIELD

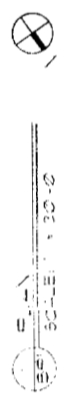

- LEGEND
- EXISTING MAIN DOOR
- EXISTING OVERHEAD DOOR
- EXISTING LOADING DOCK
- EXISTING VERTICAL CURB
- STATION
- EMERGENCY LIGHTING
- FIRE EXTINGUISHER

GENERAL NOTES
1. ALL WORK SHOWN SHALL BE IN ACCORDANCE WITH THE 2000 MAINE BUILDING CODE AND ALL APPLICABLE REGULATIONS.
2. SEE DRAWINGS 64 AND 65 FOR DETAILS FOR DETAILING.

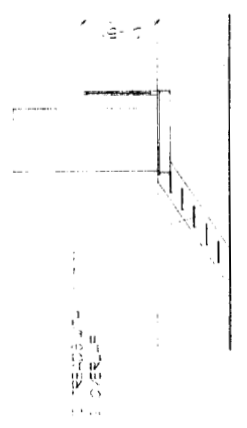

EXISTING STAIR - SECTION
SCALE: 1/4" = 1'-0"

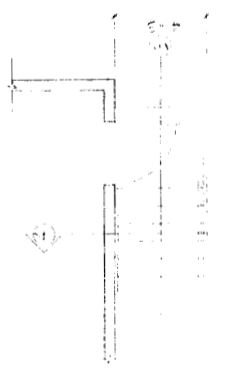

EXISTING VERTICAL CURB
SCALE: 1/4" = 1'-0"

NOTE:
1. ALL AREAS COVERED BY THIS SHEET SHALL BE REFINISHED TO MATCH EXISTING FLOOR FINISH.
2. ALL OPENINGS THROUGH ROOF AND FLOOR SHALL BE REFINISHED TO MATCH EXISTING FLOOR FINISH.

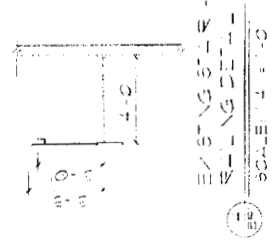

EXISTING STAIR - SECTION
SCALE: 1/4" = 1'-0"

EXISTING STAIR - PLAN
SCALE: 1/4" = 1'-0"