

# DISPLAY THIS CARD ON PRINCIPAL FRONTAGE OF WORK CITY OF PORTLAND

Please Read Application And Notes, If Any, Attached

## BUILDING INSPECTION

### PERMIT

Permit Number: 080909

PERMIT ISSUED

APR 25 2008

This is to certify that GRANT PAUL W & PAMELA J JTS /Ricks Swimming Pool Inc.

has permission to install 16" x 37' Inground pool

AT 80 DEERING RUN DR

353 E009001

provided that the person or persons who accept this permit shall comply with all of the provisions of the Statutes of the State and of the Ordinances of the City of Portland regulating the construction, maintenance and use of buildings and structures, and of the application on file in this department.

Apply to Public Works for street line and grade if nature of work requires such information.

Notification of inspection must be given and when permission is procured before this building or part thereof is occupied or otherwise closed-in. 4 HOUR NOTIFICATION REQUIRED.

A certificate of occupancy must be procured by owner before this building or part thereof is occupied.

#### OTHER REQUIRED APPROVALS

Fire Dept. \_\_\_\_\_

Health Dept. \_\_\_\_\_

Appeal Board \_\_\_\_\_

Other \_\_\_\_\_  
Department Name

*[Handwritten Signature]*  
1/29/08  
Director - Building & Inspection Services

**PENALTY FOR REMOVING THIS CARD**

**City of Portland, Maine - Building or Use Permit Application**

389 Congress Street, 04101 Tel: (207) 874-8703, Fax: (207) 874-8716

|                       |             |                     |
|-----------------------|-------------|---------------------|
| Permit No:<br>08-0909 | Issue Date: | CBL:<br>353 E009001 |
|-----------------------|-------------|---------------------|

|  |   |   |                     |
|--|---|---|---------------------|
| Location of Construction:<br>80 DEERING RUN DR | Owner Name:<br>GRANT PAUL W & PAMELA J JT     | Owner Address:<br>80 DEERING RUN DR             | Phone:              |
| Business Name:                                 | Contractor Name:<br>Ricks Swimming Pool, Inc. | Contractor Address:<br>1057 Sabatus St Lewiston | Phone<br>2077864556 |
| Lessee/Buyer's Name                            | Phone:  | Permit Type:<br>Swimming Pools                  | Zone:<br>R-2        |

|                                 |  |             |                              |                    |
|---------------------------------|--|-------------|------------------------------|--------------------|
| Past Use:<br>Single Family Home | Proposed Use:<br>Single Family Home - 16" x 37'<br>Inground pool | Permit Fee: | Cost of Work:<br>\$24,489.00 | CEO District:<br>5 |
|---------------------------------|--|-------------|------------------------------|--------------------|

**Proposed Project Description:**  
install 16" x 37' Inground pool

|  |  |
|--|--|
| <b>FIRE DEPT:</b><br><input type="checkbox"/> Approved<br><input type="checkbox"/> Denied<br>Signature: <i>[Signature]</i> | <b>INSPECTION:</b><br>Use Group: R-3/V Type: Pool<br>IRC 2003<br>Signature: <i>[Signature]</i> |
|--|--|

**PEDESTRIAN ACTIVITIES DISTRICT (P.A.D.)**

Action:  Approved  Approved w/Conditions  Denied

Signature: \_\_\_\_\_ Date: \_\_\_\_\_

|                             |                                 |                        |  |
|-----------------------------|---------------------------------|------------------------|--|
| Permit Taken By:<br>Idobson | Date Applied For:<br>07/22/2008 | <b>Zoning Approval</b> |  |
|-----------------------------|---------------------------------|------------------------|--|

- This permit application does not preclude the Applicant(s) from meeting applicable State and Federal Rules.
- Building permits do not include plumbing, septic or electrical work.
- Building permits are void if work is not started within six (6) months of the date of issuance. False information may invalidate a building permit and stop all work..

| Special Zone or Reviews   | Zoning Appeal   | Historic-Preservation  |
|---|---|--|
| <input type="checkbox"/> Shoreland<br><input type="checkbox"/> Wetland<br><input type="checkbox"/> Flood Zone<br><input type="checkbox"/> Subdivision<br><input type="checkbox"/> Site Plan<br>Maj <input type="checkbox"/> Minor <input type="checkbox"/> MM <input type="checkbox"/><br>Date: 7/29/08 | <input type="checkbox"/> Variance<br><input type="checkbox"/> Miscellaneous<br><input type="checkbox"/> Conditional Use<br><input type="checkbox"/> Interpretation<br><input type="checkbox"/> Approved<br><input type="checkbox"/> Denied<br>Date: | <input checked="" type="checkbox"/> Not in District or Landmark<br><input type="checkbox"/> Does Not Require Review<br><input type="checkbox"/> Requires Review<br><input type="checkbox"/> Approved<br><input type="checkbox"/> Approved w/Conditions<br><input type="checkbox"/> Denied<br>Date: 7/29/08 |

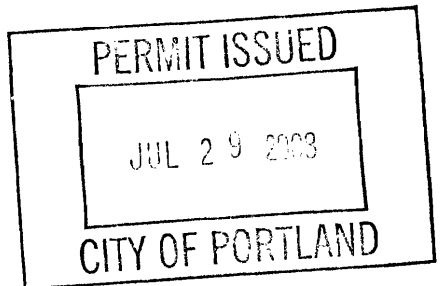

**CERTIFICATION**

I hereby certify that I am the owner of record of the named property, or that the proposed work is authorized by the owner of record and that I have been authorized by the owner to make this application as his authorized agent and I agree to conform to all applicable laws of this jurisdiction. In addition, if a permit for work described in the application is issued, I certify that the code official's authorized representative shall have the authority to enter all areas covered by such permit at any reasonable hour to enforce the provision of the code(s) applicable to such permit.

|   |         |      |       |
|---|---------|------|-------|
| SIGNATURE OF APPLICANT                      | ADDRESS | DATE | PHONE |
| RESPONSIBLE PERSON IN CHARGE OF WORK, TITLE |         | DATE | PHONE |

7/30/08

Setback's O.K.

Cl

\* Fence in rear is not  
Back line. - 4' beyond.

8/7/08 - checked electrical for pond - all OK.  
Jim M



# Pool Installation/Construction Permit Application

HANNIE  
874 8693

If you or the property owner owes real estate or personal property taxes or user charges on any property within the City, payment arrangements must be made before permits of any kind are accepted.

|   |   |   |
|---|---|---|
| Location/Address of Construction: <u>80 Deering Run Dr.</u>   |   |   |
| Total Square Footage of Proposed Structure<br><u>592 sq ft.</u>   |   | Square Footage of Lot<br><u>10,530 sq ft.</u>               |
| Tax Assessor's Chart, Block & Lot<br>Chart#      Block#      Lot#<br><u>353          Σ          9</u>                                 | Owner:<br><u>Paul &amp; Pamela Grant</u>  | Telephone:<br><u>207-797-2227</u>                           |
| Lessee/Buyer's Name (If Applicable)   | Applicant name, address & telephone:<br><u>Pamela J Grant<br/>80 Deering Run Dr<br/>Portland, ME 04103<br/>207-797-2227</u> | Cost Of Work: \$ <u>24,489</u><br>Fee: \$ _____             |
| Dimensions of pool: <u>16' x 37'</u> above or below ground: <u>Below ground</u>   |   |   |
| Dimensions of decking and/or any platforms, sheds, or other structures:   |   |   |
| Contractor's name, address & telephone:<br><u>Ricks Swimming Pool, Inc      207-786-4256<br/>1057 Sabattus St, Lewiston, ME 04240</u> |   |   |
| Who should we contact when the permit is ready: <u>Pamela J Grant</u>   |   | Phone: <u>207-415-8574 cell</u><br><u>207-797-2227 Home</u> |
| Mailing address:  |   |   |
| <u>JUL 22 2008</u>  |   |   |

Please submit all of the information outlined in the pool application checklist. Failure to do so could result in the automatic denial of your permit.

In order to be sure the City fully understands the full scope of the project, the Planning and Development Department may request additional information prior to the issuance of a permit. For further information visit us on-line at [www.portlandmaine.gov](http://www.portlandmaine.gov), stop by the Building Inspections office, room 315 City Hall or call 874-8703.

I hereby certify that I am the Owner of record of the named property, or that the owner of record authorizes the proposed work and that I have been authorized by the owner to make this application as his/her authorized agent. I agree to conform to all applicable laws of this jurisdiction. In addition, if a permit for work described in this application is issued, I certify that the Code Official's authorized representative shall have the authority to enter all areas covered by this permit at any reasonable hour to enforce the provisions of the codes applicable to this permit.

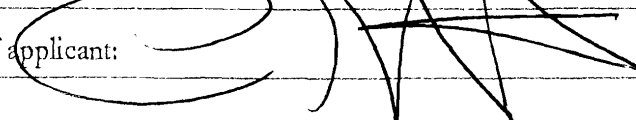
|   |                      |
|---|----------------------|
| Signature of applicant:  | Date: <u>7/21/08</u> |
|---|----------------------|

This is not a permit; you may not commence ANY work until the permit is issued.

7/20/08

# Plot Plan

Pool 10' OK

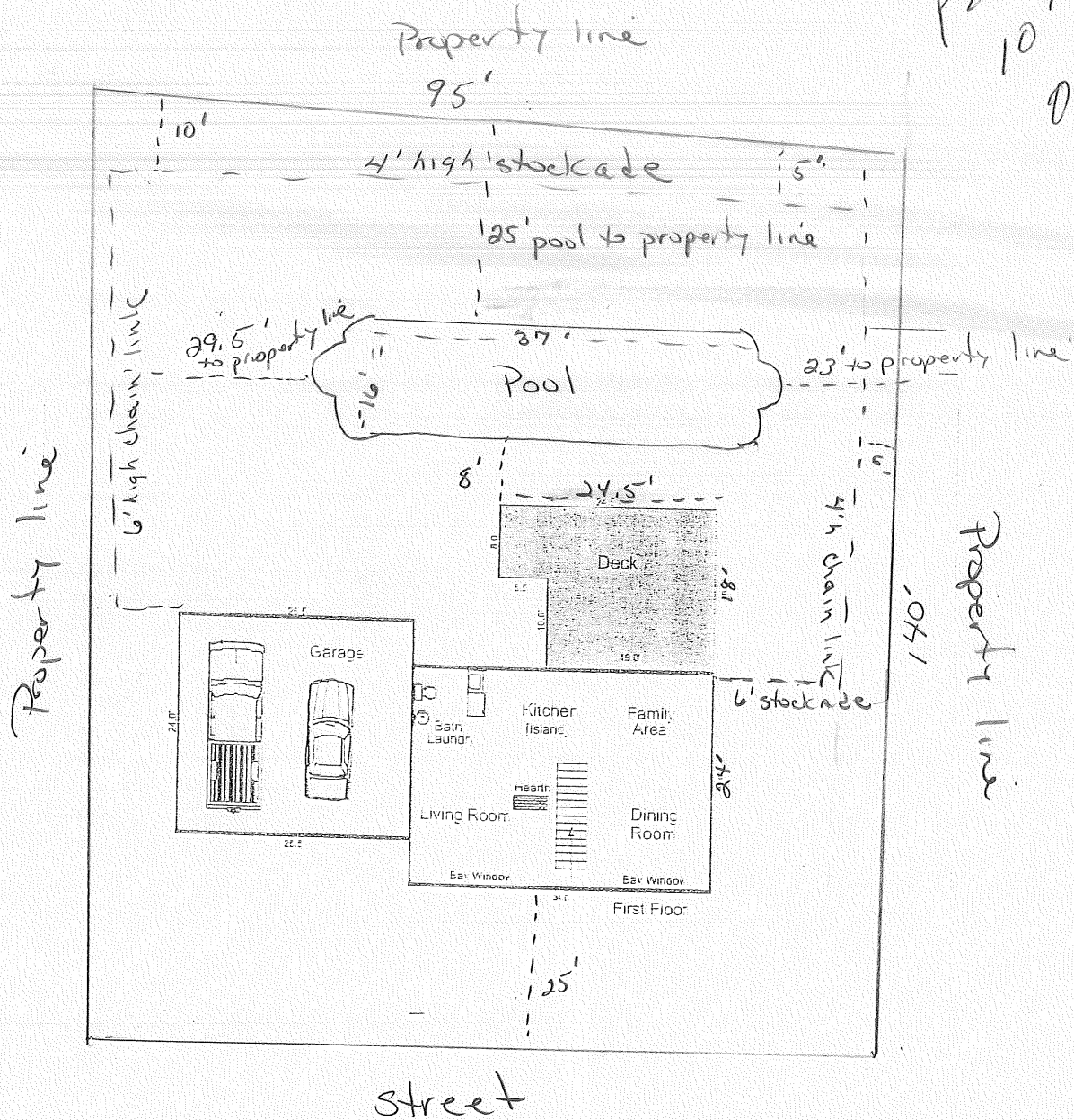

lot 140' deep x 75' w in front & 95' wide in back

# ROMAN END - 16' x 37'

x 37' ROMAN END

16' x 37' ROMAN END w/ RADIUS PLASTIC STEP

| PART NO. | DESCRIPTION                      |
|----------|----------------------------------|
| 3        | 05102 8' PLAIN PANEL             |
| 1        | 05104 8' SKIMMER PANEL           |
| 2        | 05108 8' RETURN PANEL            |
| 2        | 05123 4' PLAIN PANEL             |
| 2        | 05156 8' RADIUS PANEL 6"3"       |
| 2        | 05158 8' RADIUS PANEL 2"3"       |
| 4        | 05181 2' RADIUS PANEL            |
| 4        | 05209 ROMAN END FILLER           |
| 8        | 05225 ROMAN END FILLER STRAP     |
| 12       | 05188 ADJUSTABLE A-FRAME         |
| 1        | 07418RSNR 8' RADIUS STEP-N-REST  |
| 1        | 05202 NUT & BOLT PAK             |
|          | 05316 8' RADIUS LIGHT PANEL 6"3" |
|          | 05315 8' RADIUS PANEL 3"1 1/2"   |

|                         |                           |
|-------------------------|---------------------------|
| <b>FITTED ONLY FROM</b> | <b>GALLONS - 17850</b>    |
| <b>ED DIVING AREA.</b>  | <b>PERIMETER - 95'-6"</b> |

for use below grade and only in areas where the ground minimum of 4" below grade.  
 in earth, free of roots and debris. Do not allow the height of d the height of the water in the pool by more than 6" nor the he back fill by more than 6".  
 concrete footing around entire perimeter, minimum 6" deep. deck is to be poured at least 3" thickness and a slope of 1/4" to pool.  
 nensions are to be finished dimensions.  
 s to be 2" minimum of suitable material or undisturbed earth.  
 buoys, is to be permanently attached 10" to the shallow side t slope change.  
 ir layouts, refer to Imperial installation manual.  
 ing: Different methods and precautions may be dictated by nditions. This is to be determined by and is the he contractor who is not an agent of the manufacturer of the

done in accordance with all federal, state and local building N.S.P.I. suggested standards.

tion shown conforms with current NSPI / ANSI suggested minimum roved for use with manufactured diving equipment. If diving equipment i equipment manufacturer's installation, use and safety instructions.

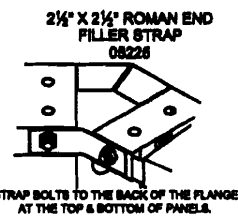
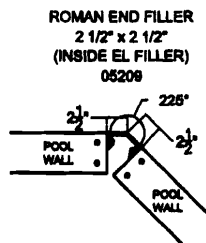

|               |
|---------------|
| FROM [A] TO:  |
| E 11'-3 3/4"  |
| F 30'-1"      |
| H 10'-8 1/2"  |
| J 24'         |
| K 16'-7 1/2"  |
| L 28'-10 1/4" |

|               |
|---------------|
| FROM [C] TO:  |
| E 11'-3 3/4"  |
| F 30'-1"      |
| H 16'-7 1/2"  |
| J 28'-10 1/4" |
| K 10'-6 1/4"  |
| L 24'         |

|              |
|--------------|
| FROM [B] TO: |
| E 30'-1"     |
| F 11'-3 3/4" |
| H 27'-3 3/4" |
| J 13'        |
| K 28'-8 1/2" |
| L 20'-7 1/2" |

|              |
|--------------|
| FROM [D] TO: |
| E 30'-1"     |
| F 11'-3 3/4" |
| H 29'-6 1/4" |
| J 20'-7 1/2" |
| K 27'-3 3/4" |
| L 13'        |

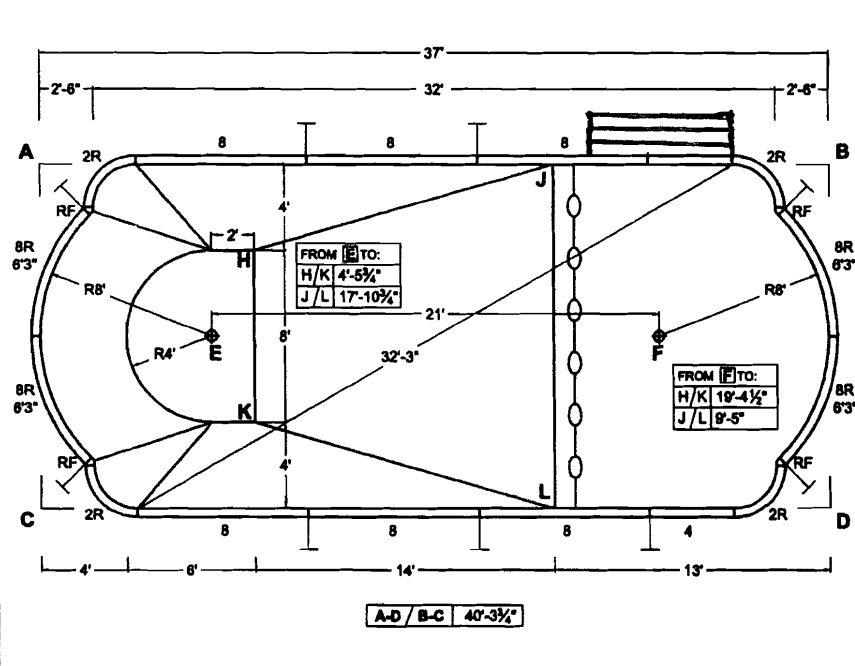

A-D / B-C 40'-3 3/4"

RF- ROMAN END FILLER

A-FRAME BRACE

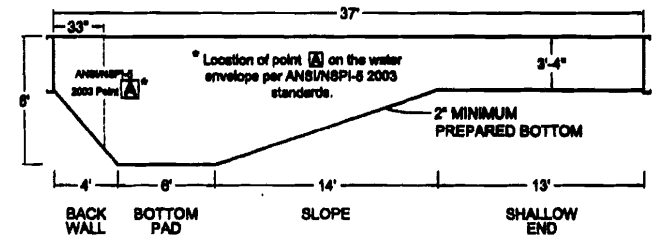
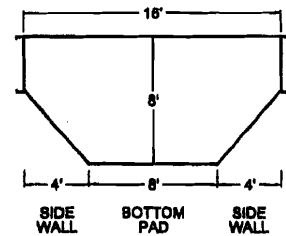

**ALL DIMENSIONS ARE FINISH DIMENSIONS**



# Commercial Interior & Change of Use Permit Application Checklist

All of the following information is required and must be submitted. Checking off each item as you prepare your application package will ensure your package is complete and will help to expedite the permitting process.

**One (1) complete set of construction drawings must include:**

Note: Construction documents for costs in excess of \$50,000.00 must be prepared by a Design Professional and bear their seal.

- Cross sections w/framing details
- Detail of any new walls or permanent partitions
- Floor plans and elevations
- Window and door schedules
- Complete electrical and plumbing layout.
- Mechanical drawings for any specialized equipment such as furnaces, chimneys, gas equipment, HVAC equipment or other types of work that may require special review
- Insulation R-factors of walls, ceilings, floors & U-factors of windows as per the IECC 2003
- Proof of ownership is required if it is inconsistent with the assessors records.
- Reduced plans or electronic files in PDF format are required if originals are larger than 11" x 17".
- Per State Fire Marshall, all new bathrooms must be ADA compliant.

**Separate permits are required for internal and external plumbing, HVAC & electrical installations.**

**For additions less than 500 sq. ft. or that does not affect parking or traffic, a site plan exemption should be filed including:**

- The shape and dimension of the lot, footprint of the existing and proposed structure and the distance from the actual property lines.
- Location and dimensions of parking areas and driveways, street spaces and building frontage.
- Dimensional floor plan of existing space and dimensional floor plan of proposed space.

**A Minor Site Plan Review is required for any change of use between 5,000 and 10,000 sq. ft. (cumulatively within a 3-year period)**

**Fire Department requirements.**

The following shall be submitted on a separate sheet:

- Name, address and phone number of applicant **and** the project architect.
- Proposed use of structure (NFPA and IBC classification)
- Square footage of proposed structure (total and per story)
- Existing and proposed fire protection of structure.
- Separate plans shall be submitted for
  - a) Suppression system
  - b) Detection System (separate permit is required)
- A separate Life Safety Plan must include:
  - a) Fire resistance ratings of all means of egress
  - b) Travel distance from most remote point to exit discharge
  - c) Location of any required fire extinguishers
  - d) Location of emergency lighting
  - e) Location of exit signs
  - f) NFPA 101 code summary
- Elevators shall be sized to fit an 80" x 24" stretcher.

**For questions on Fire Department requirements call the Fire Prevention Officer at (207) 874-8405.**

**Please submit all of the information outlined in this application checklist. If the application is incomplete, the application may be refused.**

In order to be sure the City fully understands the full scope of the project, the Planning and Development Department may request additional information prior to the issuance of a permit. For further information or to download copies of this form and other applications visit the Inspections Division on-line at [www.portlandmaine.gov](http://www.portlandmaine.gov), or stop by the Inspections Division office, room 315 City Hall or call 874-8703.

**Permit Fee: \$30.00 for the first \$1000.00 construction cost, \$10.00 per additional \$1000.00 cost**

**This is not a Permit; you may not commence any work until the Permit is issued.**



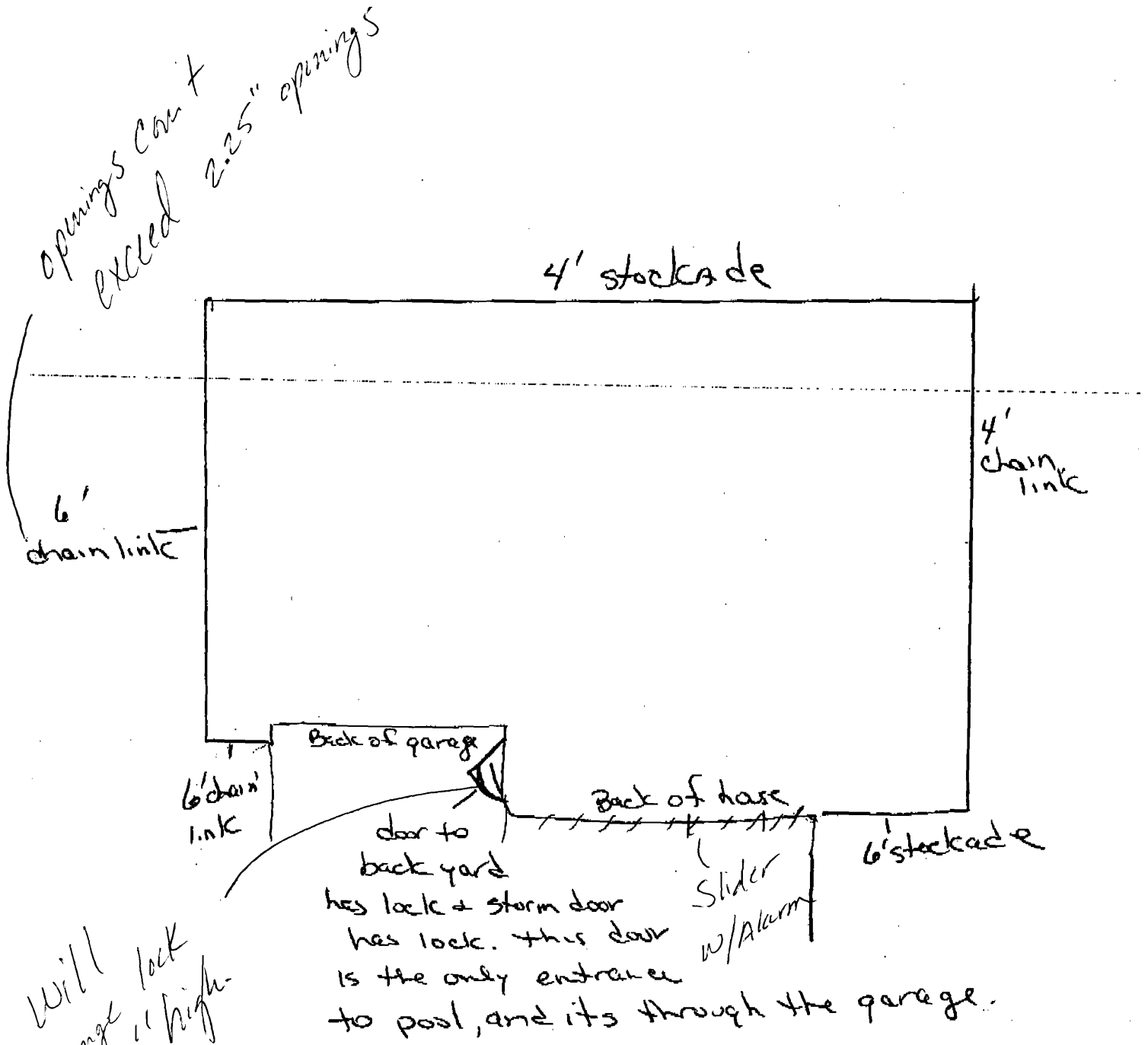

Will change lock to 54" high.

there is no entry to pool area unless its through the garage and all doors have locks.

ATTN: Lannie

---

From = Pam Grant

Pool Permit Additional info.

7/29/08

2 pages including cover

Please call if you need more  
info.

207-885-2486

**BUILDING PERMIT INSPECTION PROCEDURES**

**Please call 874-8703 or 874-8693 (ONLY )**

**to schedule your inspections as agreed upon**

**Permits expire in 6 months, if the project is not started or ceases for 6 months.**

The Owner or their designee is required to notify the inspections office for the following inspections and provide adequate notice. Notice must be called in 48-72 hours in advance in order to schedule an inspection:

**By initializing at each inspection time, you are agreeing that you understand the inspection procedure and additional fees from a "Stop Work Order" and "Stop Work Order Release" will be incurred if the procedure is not followed as stated below.**

**A Pre-construction Meeting will take place upon receipt of your building permit.**

  X   **Pool Location Inspection Required.**

  X   **Underground electrical inspection and grounding of pool required prior to pouring concrete**

  X   **Final inspection required at completion of work.**

Certificate of Occupancy is not required for certain projects. Your inspector can advise you if your project requires a Certificate of Occupancy. All projects DO require a final inspection.

**If any of the inspections do not occur, the project cannot go on to the next phase, REGARDLESS OF THE NOTICE OR CIRCUMSTANCES.**

**CERIFICATE OF OCCUPANICES MUST BE ISSUED AND PAID FOR, BEFORE THE SPACE MAY BE OCCUPIED.**

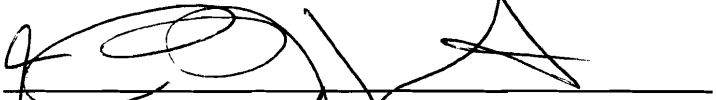
  
\_\_\_\_\_  
Signature of Applicant/Designee

  7-29-08    
Date

  
\_\_\_\_\_  
Signature of Inspections Official

  7/29/08    
Date

# ELECTRICAL PERMIT

## City of Portland, Me.



To the Chief Electrical Inspector, Portland Maine:  
 The undersigned hereby applies for a permit to make electrical installations  
 in accordance with the laws of Maine, the City of Portland Electrical Ordinance,  
 National Electrical Code and the following specifications:

Date 8/5/08  
 Permit # 2008 14544  
 CBL# 353-E-009

LOCATION: 80 Deering Ron METER MAKE & # \_\_\_\_\_  
 CMP ACCOUNT # \_\_\_\_\_ OWNER Dan Grant  
 TENANT \_\_\_\_\_ PHONE # \_\_\_\_\_

|                              |   |                  |   |               |  |                 | TOTAL EACH FEE |       |
|------------------------------|---|------------------|---|---------------|--|-----------------|----------------|-------|
| OUTLETS                      |   | Receptacles      | 1 | Switches      |  | Smoke Detector  | .20            | .20   |
| FIXTURES                     | 1 | Incandescent     |   | Fluorescent   |  | Strips          | .20            | .20   |
| SERVICES                     |   | Overhead         |   | Underground   |  | TTL AMPS <800   | 15.00          |       |
|                              |   | Overhead         |   | Underground   |  | >800            | 25.00          |       |
| Temporary Service            |   | Overhead         |   | Underground   |  | TTL AMPS        | 25.00          |       |
|                              |   |                  |   |               |  |                 | 25.00          |       |
| METERS                       |   | (number of)      |   |               |  |                 | 1.00           |       |
| MOTORS                       | 1 | (number of)      |   |               |  |                 | 2.00           | 2.00  |
| RESID/COM                    |   | Electric units   |   |               |  |                 | 1.00           |       |
| HEATING                      |   | oil/gas units    |   | Interior      |  | Exterior        | 5.00           |       |
| APPLIANCES                   |   | Ranges           |   | Cook Tops     |  | Wall Ovens      | 2.00           |       |
|                              |   | Insta-Hot        |   | Water heaters |  | Fans            | 2.00           |       |
|                              |   | Dryers           |   | Disposals     |  | Dishwasher      | 2.00           |       |
|                              |   | Compactors       |   | Spa           |  | Washing Machine | 2.00           |       |
|                              |   | Others (denote)  |   |               |  |                 | 2.00           |       |
| MISC. (number of)            |   | Air Cond/win     |   |               |  |                 | 3.00           |       |
|                              |   | Air Cond/cent    |   |               |  |                 | 10.00          | 10.00 |
|                              |   | HVAC             |   | EMS           |  | Thermostat      | 5.00           |       |
|                              |   | Signs            |   |               |  |                 | 10.00          |       |
|                              |   | Alarms/res       |   |               |  |                 | 5.00           |       |
|                              |   | Alarms/com       |   |               |  |                 | 15.00          |       |
|                              |   | Heavy Duty(CRKT) |   |               |  |                 | 2.00           |       |
|                              |   | Circus/Carnv     |   |               |  |                 | 25.00          |       |
|                              |   | Alterations      |   |               |  |                 | 5.00           |       |
|                              |   | Fire Repairs     |   |               |  |                 | 15.00          |       |
|                              |   | E Lights         |   |               |  |                 | 1.00           |       |
|                              |   | E Generators     |   |               |  |                 | 20.00          |       |
| PANELS                       |   | Service          |   | Remote        |  | Main            | 4.00           |       |
| TRANSFORMER                  |   | 0-25 Kva         |   |               |  |                 | 5.00           |       |
|                              |   | 25-200 Kva       |   |               |  |                 | 8.00           |       |
|                              |   | Over 200 Kva     |   |               |  |                 | 10.00          |       |
| TOTAL AMOUNT DUE             |   |                  |   |               |  |                 |                | 45.00 |
| MINIMUM FEE/COMMERCIAL 55.00 |   |                  |   |               |  |                 | MINIMUM FEE    | 45.00 |

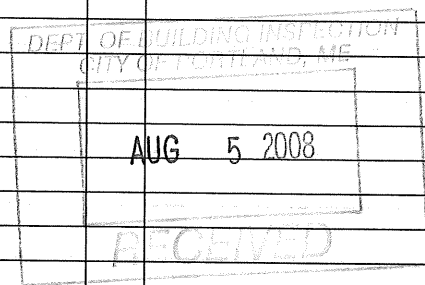

CONTRACTORS NAME M+RElectric Inc MASTER LIC. # MC60018650  
 ADDRESS 49 Haverlys Way Portland LIMITED LIC. # \_\_\_\_\_  
 TELEPHONE 878-5864 / 415-2957 ✓ 3718

SIGNATURE OF CONTRACTOR Karen Flaherty  
 White Copy - Office • Yellow Copy - Applicant