

# DISPLAY THIS CARD ON PRINCIPAL FRONTAGE OF WORK CITY OF PORTLAND

Please Read Application And Notes, If Any, Attached

## BUILDING INSPECTION PERMIT

Permit Number: 061105

This is to certify that CLAYTON RAY J & MICHAEL K JTS

has permission to build a 8' x 12' Shed

AT 58 DEERING RUN DR

PERMIT ISSUED  
JUL 27 2006  
CITY OF PORTLAND

provided that the person or persons who accept this permit shall comply with all of the provisions of the Statutes of the State and of the Ordinances of the City of Portland regulating the construction, maintenance and use of buildings and structures, and of the application on file in this department.

Apply to Public Works for street line and grade if nature of work requires such information.

Classification of inspection must be given and when permission proceeds before this building or part thereof is started or service closed-in. FOUR NOTICES REQUIRED.

A certificate of occupancy must be procured by owner before this building or part thereof is occupied.

### OTHER REQUIRED APPROVALS

Fire Dept. \_\_\_\_\_

Health Dept. \_\_\_\_\_

Appeal Board \_\_\_\_\_

Other \_\_\_\_\_

Department Name

*[Signature]*  
7/27/06  
Director of Building & Inspection Services

**PENALTY FOR REMOVING THIS CARD**

**City of Portland, Maine - Building or Use Permit Application**

389 Congress Street, 04101 Tel: (207) 874-8703, Fax: (207) 874-8716

**PERMIT ISSUED**

Permit No: 06-105	Issue Date: JUL 27 2006	CEL: 353 E005001
----------------------	----------------------------	---------------------

Location of Construction: 58 DEERING RUN DR	Owner Name: CLAYTON RAY J & MICHELE K	Owner Address: 58 DEERING RUN DR	Phone:
Business Name:	Contractor Name:	Contractor Address: CITY OF PORTLAND	Phone:
Lessee/Buyer's Name	Phone:	Permit Type: Sheds	Zone: R-2

Past Use: Single Family Home	Proposed Use: Single Family Home/ build a 8' x 12' Shed	Permit Fee: \$30.00	Cost of Work: \$30.00	CEO District: 5	
Proposed Project Description: build a 8' x 12' Shed		FIRE DEPT: <input checked="" type="checkbox"/> Approved <input type="checkbox"/> Denied Signature: <i>[Signature]</i>	INSPECTION: Use Group: U/R-3 Type: SB Signature: <i>[Signature]</i>		

PEDESTRIAN ACTIVITIES DISTRICT (P.A.D.)		
Action: <input type="checkbox"/> Approved	<input type="checkbox"/> Approved w/Conditions	<input type="checkbox"/> Denied
Signature:	Date:	

Permit Taken By: Idobson	Date Applied For: 07/27/2006	<b>Zoning Approval</b>	
-----------------------------	---------------------------------	------------------------	--

<ol style="list-style-type: none"> <li>This permit application does not preclude the Applicant(s) from meeting applicable State and Federal Rules.</li> <li>Building permits do not include plumbing, septic or electrical work.</li> <li>Building permits are void if work is not started within six (6) months of the date of issuance. False information may invalidate a building permit and stop all work..</li> </ol>	<b>Special Zone or Reviews</b> <input type="checkbox"/> Shoreland <input type="checkbox"/> Wetland <input type="checkbox"/> Flood Zone <input type="checkbox"/> Subdivision <input type="checkbox"/> Site Plan Maj <input type="checkbox"/> Minor <input type="checkbox"/> MM <input type="checkbox"/> Date: 7/27/06	<b>Zoning Appeal</b> <input type="checkbox"/> Variance <input type="checkbox"/> Miscellaneous <input type="checkbox"/> Conditional Use <input type="checkbox"/> Interpretation <input type="checkbox"/> Approved <input type="checkbox"/> Denied Date:	<b>Historic Preservation</b> <input checked="" type="checkbox"/> Not in District or Landmark <input type="checkbox"/> Does Not Require Review <input type="checkbox"/> Requires Review <input type="checkbox"/> Approved <input type="checkbox"/> Approved w/Conditions <input type="checkbox"/> Denied Date: 7/27/06
---	---	---	--

**CERTIFICATION**

I hereby certify that I am the owner of record of the named property, or that the proposed work is authorized by the owner of record and that I have been authorized by the owner to make this application as his authorized agent and I agree to conform to all applicable laws of this jurisdiction. In addition, if a permit for work described in the application is issued, I certify that the code official's authorized representative shall have the authority to enter all areas covered by such permit at any reasonable hour to enforce the provision of the code(s) applicable to such permit.

SIGNATURE OF APPLICANT	ADDRESS	DATE	PHONE
RESPONSIBLE PERSON IN CHARGE OF WORK, TITLE		DATE	PHONE

**City of Portland, Maine - Building or Use Permit**

389 Congress Street, 04101 Tel: (207) 874-8703, Fax: (207) 874-8716

<b>Permit No:</b> 06-1105	<b>Date Applied For:</b> 07/27/2006	<b>CBL:</b> 353 E005001
------------------------------	--	----------------------------

<b>Location of Construction:</b> 58 DEERING RUN DR	<b>Owner Name:</b> CLAYTON RAY J & MICHELE K	<b>Owner Address:</b> 58 DEERING RUN DR	<b>Phone:</b>
<b>Business Name:</b>	<b>Contractor Name:</b>	<b>Contractor Address:</b>	<b>Phone:</b>
<b>Lessee/Buyer's Name</b>	<b>Phone:</b>	<b>Permit Type:</b> Sheds	

Single Family Home/ build a 8' x 12' Shed

build a 8' x 12' Shed

**Dept:** Zoning      **Status:** Approved      **Reviewer:** Tammy Munson      **Approval Date:** 07/27/2006**Note:**      **Ok to Issue:** **Dept:** Building      **Status:** Approved with Conditions      **Reviewer:** Tammy Munson      **Approval Date:** 07/27/2006**Note:**      **Ok to Issue:** 

1) This structure is exempt from meeting the City of Portland Building Code based on size.



# General Building Permit Application

If you or the property owner owes real estate or personal property taxes or user charges on any property within the City, payment arrangements must be made before permits of any kind are accepted.

			ring Run Dr	
			Square Footage of Lot	
Tax Assessor's Chart, Block & Lot Chart#      Block#      Lot# 353                      5		Owner: Ray Clayton		Telephone:
Lessee/Buyer's Name (If Applicable)		Applicant name, address & telephone: 58 Deering Run Dr Portland, Me 04103		Cost Of Work: \$ 500.00 Fee: \$ _____ C of O Fee: \$ _____
Current Specific use: <u>single family home</u> If vacant, what was the previous use? _____ Proposed Specific use: _____				
Project description: <u>shed 8 x 12</u>				
Contractor's name, address & telephone:		Ray Clayton		
Who should we contact when the permit is ready:		58 Deering Run Dr		
Mailing address:		Phone: 797-7908		

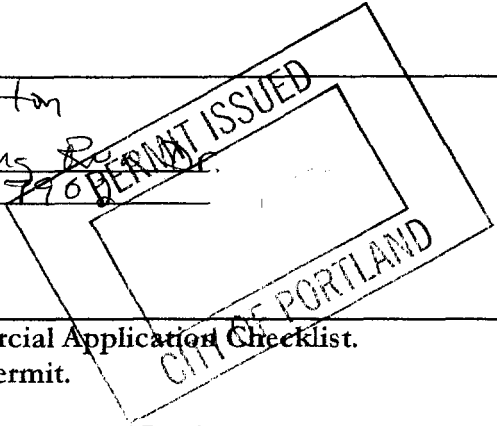

Please submit all of the information outlined in the Commercial Application Checklist. Failure to do so will result in the automatic denial of your permit.

In order to be sure the City fully understands the full scope of the project, the Planning and Development Department may request additional information prior to the issuance of a permit. For further information visit us on-line at [www.portlandmaine.gov](http://www.portlandmaine.gov), stop by the Building Inspections office, room 315 City Hall or call 874-8703.

I hereby certify that I am the Owner of record of the named property, or that the owner of record authorizes the proposed work and that I have been authorized by the owner to make this application as his/her authorized agent. I agree to conform to all applicable laws of this jurisdiction. In addition, if a permit for work described in this application is issued, I certify that the Code Official's authorized representative shall have the authority to enter all areas covered by this permit at any reasonable hour to enforce the provisions of the codes applicable to this permit.

Signature of applicant: <u>Ray Clayton</u>	Date: <u>7-27-06</u>
--	----------------------

This is not a permit; you may not commence ANY work until the permit is issued.

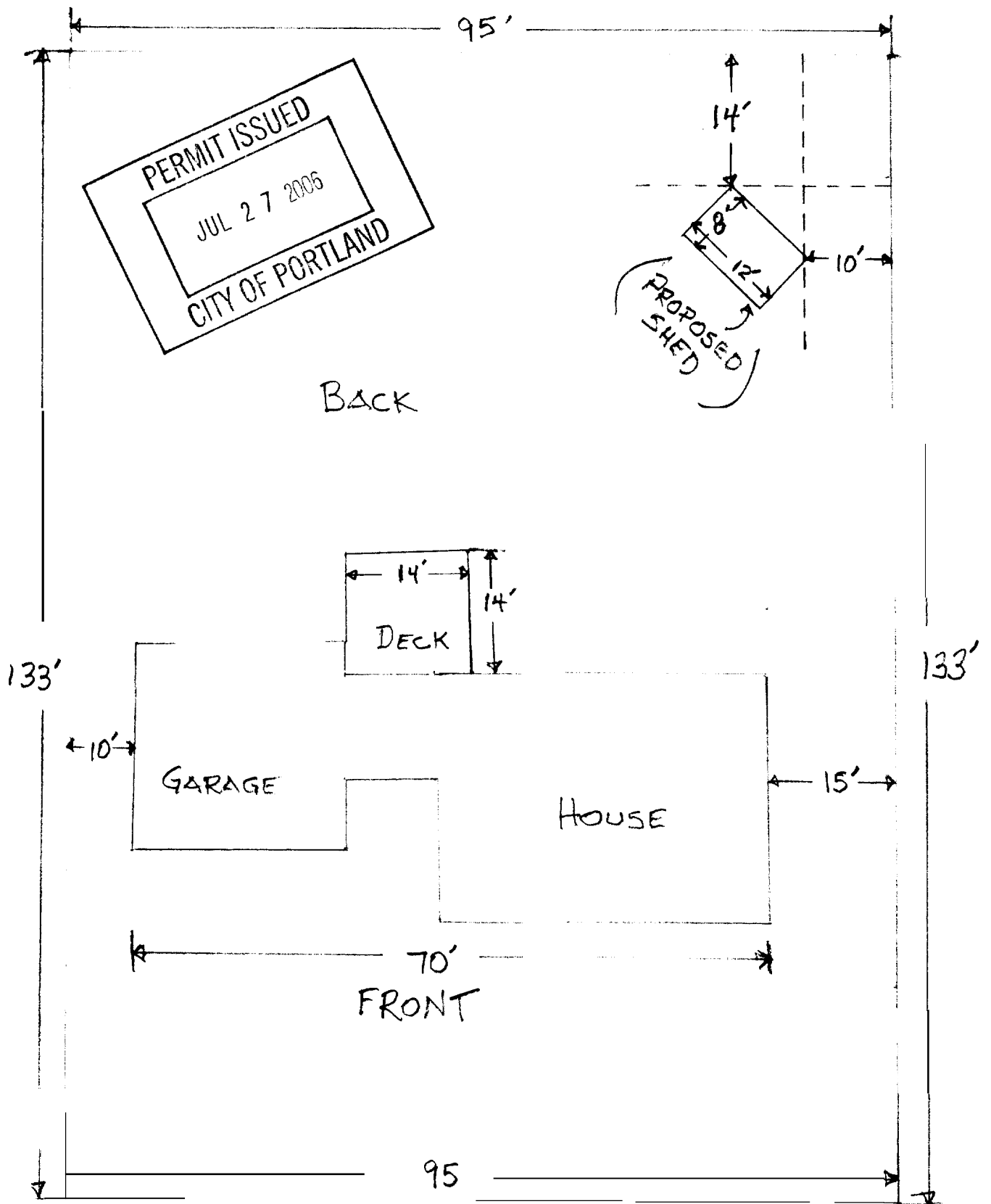

RAY CLAYTON  
 58 DEERING RUN DR  
 PORTLAND, ME 04103