

**City of Portland, Maine - Building or Use Permit Application**

389 Congress Street, 04101 Tel: (207) 874-8703, Fax: (207) 874-8716

**PERMIT ISSUED**

Permit No: 06-105 Issue Date: **JUL 27 2006** CBL: 353 E005001  
 Owner Address: 58 DEERING RUN DR Phone:  
 Contractor Address: CITY OF PORTLAND Phone:

Location of Construction: 58 DEERING RUN DR	Owner Name: CLAYTON RAY J & MICHELE K	Owner Address: 58 DEERING RUN DR	Phone: 353 E005001
Business Name:	Contractor Name:	Contractor Address: CITY OF PORTLAND	Phone:
Lessee/Buyer's Name	Phone:	Permit Type: Sheds	Zone: R-2

Past Use: Single Family Home	Proposed Use: Single Family Home/ build a 8' x 12' Shed	Permit Fee: \$30.00	Cost of Work: \$30.00	CEO District: 5
Proposed Project Description: build a 8' x 12' Shed		FIRE DEPT: <input checked="" type="checkbox"/> Approved <input checked="" type="checkbox"/> Denied Signature: <i>[Signature]</i>	INSPECTION: Use Group: <i>V/R-3</i> Type: <i>SB</i> <i>TRC 2003</i> Signature: <i>[Signature]</i>	
		PEDESTRIAN ACTIVITIES DISTRICT (P.A.D.) Action: <input type="checkbox"/> Approved <input type="checkbox"/> Approved w/Conditions <input type="checkbox"/> Denied Signature: _____ Date: _____		

Permit Taken By: ldobson	Date Applied For: 07/27/2006	<b>Zoning Approval</b>
-----------------------------	---------------------------------	------------------------

1. This permit application does not preclude the Applicant(s) from meeting applicable State and Federal Rules. 2. Building permits do not include plumbing, septic or electrical work. 3. Building permits are void if work is not started within six (6) months of the date of issuance. False information may invalidate a building permit and stop all work..	Special Zone or Reviews <input type="checkbox"/> Shoreland <input type="checkbox"/> Wetland <input type="checkbox"/> Flood Zone <input type="checkbox"/> Subdivision <input type="checkbox"/> Site Plan Maj <input type="checkbox"/> Minor <input type="checkbox"/> MM <input type="checkbox"/> Date: <i>7/27/06</i>	Zoning Appeal <input type="checkbox"/> Variance <input type="checkbox"/> Miscellaneous <input type="checkbox"/> Conditional Use <input type="checkbox"/> Interpretation <input type="checkbox"/> Approved <input type="checkbox"/> Denied Date: _____	Historic Preservation <input checked="" type="checkbox"/> Not in District or Landmark <input type="checkbox"/> Does Not Require Review <input type="checkbox"/> Requires Review <input type="checkbox"/> Approved <input type="checkbox"/> Approved w/Conditions <input type="checkbox"/> Denied Date: <i>7/27/06</i>
--	---	--	--

**CERTIFICATION**

I hereby certify that I am the owner of record of the named property, or that the proposed work is authorized by the owner of record and that I have been authorized by the owner to make this application as his authorized agent and I agree to conform to all applicable laws of this jurisdiction. In addition, if a permit for work described in the application is issued, I certify that the code official's authorized representative shall have the authority to enter all areas covered by such permit at any reasonable hour to enforce the provision of the code(s) applicable to such permit.

SIGNATURE OF APPLICANT \_\_\_\_\_ ADDRESS \_\_\_\_\_ DATE \_\_\_\_\_ PHONE \_\_\_\_\_

RESPONSIBLE PERSON IN CHARGE OF WORK, TITLE \_\_\_\_\_ DATE \_\_\_\_\_ PHONE \_\_\_\_\_

**City of Portland, Maine - Building or Use Permit**

389 Congress Street, 04101 Tel: (207) 874-8703, Fax: (207) 874-8716

Permit No: 06-1105	Date Applied For: 07/27/2006	CBL: 353 E005001
-----------------------	---------------------------------	---------------------

Location of Construction: 58 DEERING RUN DR	Owner Name: CLAYTON RAY J & MICHELE K	Owner Address: 58 DEERING RUN DR	Phone:
Business Name:	Contractor Name:	Contractor Address:	Phone:
Lessee/Buyer's Name	Phone:	Permit Type: Sheds	

Proposed Use: Single Family Home/ build a 8' x 12' Shed	Proposed Project Description: build a 8' x 12' Shed
--	--

Dept: Zoning	Status: Approved	Reviewer: Tammy Munson	Approval Date: 07/27/2006
Note:			Ok to Issue: <input checked="" type="checkbox"/>
Dept: Building	Status: Approved with Conditions	Reviewer: Tammy Munson	Approval Date: 07/27/2006
Note:			Ok to Issue: <input checked="" type="checkbox"/>

1) This structure is exempt from meeting the City of Portland Building Code based on size.



# General Building Permit Application

If you or the property owner owes real estate or personal property taxes or user charges on any property within the City, payment arrangements must be made before permits of any kind are accepted.

Location/Address of Construction: <u>58 Deering Run Dr</u>		
Total Square Footage of Proposed Structure <u>96</u>		Square Footage of Lot
Tax Assessor's Chart, Block & Lot Chart# <u>353</u> Block# <u>E</u> Lot# <u>5</u>		Owner: <u>Ray Clayton</u>
Lessee/Buyer's Name (If Applicable)		Telephone:
Applicant name, address & telephone: <u>58 Deering Run Dr Portland, Me 04103</u>		Cost Of Work: \$ <u>500.00</u>
Current Specific use: <u>Single Family Home</u>		Fee: \$ _____
If vacant, what was the previous use? _____		C of O Fee: \$ _____
Proposed Specific use: _____		
Project description: <u>Shed 8 x 12</u>		
Contractor's name, address & telephone: <u>Ray Clayton</u>		
Who should we contact when the permit is ready: <u>58 Deering Run Dr</u>		
Mailing address:		Phone: <u>797-7968</u>

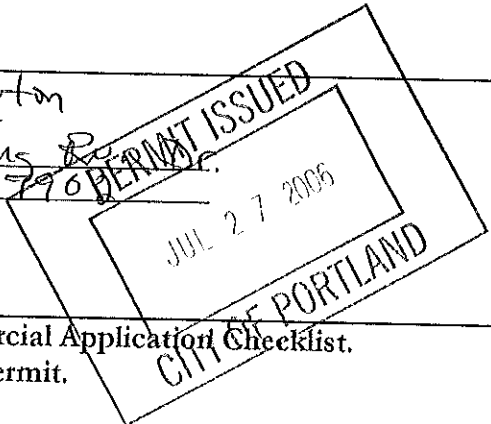

Please submit all of the information outlined in the Commercial Application Checklist. Failure to do so will result in the automatic denial of your permit.

In order to be sure the City fully understands the full scope of the project, the Planning and Development Department may request additional information prior to the issuance of a permit. For further information visit us on-line at [www.portlandmaine.gov](http://www.portlandmaine.gov), stop by the Building Inspections office, room 315 City Hall or call 874-8703.

I hereby certify that I am the Owner of record of the named property, or that the owner of record authorizes the proposed work and that I have been authorized by the owner to make this application as his/her authorized agent. I agree to conform to all applicable laws of this jurisdiction. In addition, if a permit for work described in this application is issued, I certify that the Code Official's authorized representative shall have the authority to enter all areas covered by this permit at any reasonable hour to enforce the provisions of the codes applicable to this permit.

Signature of applicant: <u>Ray Clayton</u>	Date: <u>7-27-06</u>
--	----------------------

This is not a permit; you may not commence ANY work until the permit is issued.

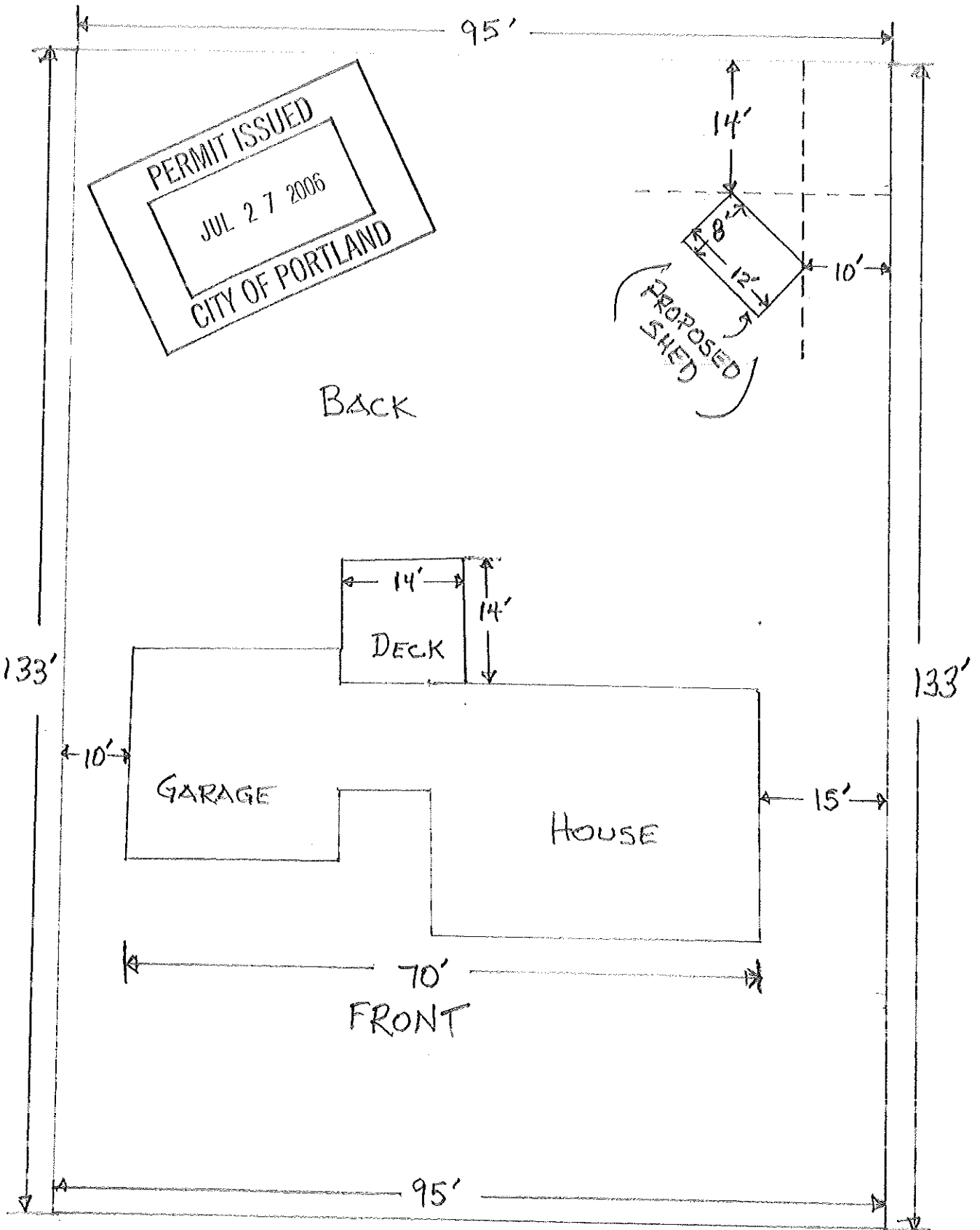

RAY CLAYTON  
 58 DEERING RUN DR.  
 PORTLAND, ME 04103

Form # P 04

DISPLAY THIS CARD ON PRINCIPAL FRONTAGE OF WORK  
**CITY OF PORTLAND**

**BUILDING INSPECTION  
PERMIT**

Please Read  
Application And  
Notes, If Any,  
Attached

PERMIT ISSUED  
Permit Number: 061038  
JUL 28 2006  
CITY OF PORTLAND

This is to certify that A & M PARTNERS INC / Benchmark  
has permission to Tenant Fit-up  
AT 396 CONGRESS ST

032 G00T001

provided that the person or persons who perform or supervise the work in accepting this permit shall comply with all of the provisions of the Statutes of the State of Oregon and of the Ordinances of the City of Portland regulating the construction, maintenance and use of buildings and structures, and of the application on file in this department.

Apply to Public Works for street line and grade if nature of work requires such information.

Notification of inspection must be given and when permission is procured before this building or part thereof is occupied or services are closed-in. 4  
YOUR NOTICE IS REQUIRED.

A certificate of occupancy must be procured by owner before this building or part thereof is occupied.

**OTHER REQUIRED APPROVALS**

Fire Dept. \_\_\_\_\_  
Health Dept. \_\_\_\_\_  
Appeal Board \_\_\_\_\_  
Other \_\_\_\_\_  
Department Name \_\_\_\_\_

*[Signature]*  
Director - Building & Inspection Services

**PENALTY FOR REMOVING THIS CARD**

# DISPLAY THIS CARD ON PRINCIPAL FRONTAGE OF WORK CITY OF PORTLAND

Please Read Application And Notes, If Any, Attached

## BUILDING INSPECTION

Permit Number: 061105

This is to certify that CLAYTON RAY J & MICHAEL K JTS

has permission to build a 8' x 12' Shed

AT 58 DEERING RUN DR

353 E005001

JUL 27 2006

**PERMIT ISSUED**  
CITY OF PORTLAND

provided that the person or persons who accept this permit shall comply with all of the provisions of the Statutes of Maine and of the Ordinances of the City of Portland regulating the construction, maintenance and use of buildings and structures, and of the application on file in this department.

Apply to Public Works for street line and grade if nature of work requires such information.

Classification of inspection must be given and when permission proceeds before this building or part thereof is started or work is closed-in. 4 OUR NOTES ARE REQUIRED.

A certificate of occupancy must be procured by owner before this building or part thereof is occupied.

### OTHER REQUIRED APPROVALS

Fire Dept. \_\_\_\_\_  
Health Dept. \_\_\_\_\_  
Appeal Board \_\_\_\_\_  
Other \_\_\_\_\_  
Department Name

*[Signature]* 7/27/06  
Director - Building & Inspection Services

**PENALTY FOR REMOVING THIS CARD**