

City of Portland, Maine - Building or Use Permit Application

389 Congress Street, 04101 Tel: (207) 874-8703, Fax: (207) 874-8716

Permit No: 05-0669	Issue Date: JUN 13 2005	CBL: 52 B010001
-----------------------	----------------------------	--------------------

Location of Construction: 105 Dole Dr	Owner Name: Elliott Don V & Janice D Jts	Owner Address: 105 Dole Dr	Phone:
Business Name:	Contractor Name: Gibraltar Pools	Contractor Address: 428 Boston St. Rt One, Topsheld	Phone: 9788872424
Lessee/Buyer's Name	Phone:	Permit Type: Swimming Pools	Zone: R-2

Past Use: Single Family	Proposed Use: Single Family install an above ground pool with decking.	Permit Fee: \$174.00	Cost of Work: \$16,995.00	CEO District: 5
-----------------------------------	--	--------------------------------	-------------------------------------	---------------------------

Proposed Project Description:
Install an above ground pool with decking.

FIRE DEPT: <input type="checkbox"/> Approved <input checked="" type="checkbox"/> Denied Signature: <i>[Signature]</i>	INSPECTION: Use Group: U Type: Pool IRC 2003 Signature: <i>[Signature]</i>
PEDESTRIAN ACTIVITIES DISTRICT (P.A.D.)	
Action: <input type="checkbox"/> Approved <input type="checkbox"/> Approved w/Conditions <input checked="" type="checkbox"/> Denied	
Signature: _____ Date: _____	

Permit Taken By: dmartin	Date Applied For: 05/31/2005	Zoning Approval
------------------------------------	--	------------------------

<p>Special Zone or P Reviews</p> <p><input type="checkbox"/> Shoreland</p> <p><input type="checkbox"/> Wetland</p> <p><input type="checkbox"/> Flood Zone</p> <p><input type="checkbox"/> Subdivision</p> <p><input type="checkbox"/> Site Plan</p> <p>Maj <input type="checkbox"/> Minor <input type="checkbox"/> MM <input type="checkbox"/></p> <p>Date: 6/10/05</p>	<p>Zoning Appeal</p> <p><input type="checkbox"/> Variance</p> <p><input type="checkbox"/> Miscellaneous</p> <p><input type="checkbox"/> Conditional Use</p> <p><input type="checkbox"/> Interpretation</p> <p><input type="checkbox"/> Approved</p> <p><input type="checkbox"/> Denied</p> <p>Date: _____</p>	<p>Historic Preservation</p> <p><input checked="" type="checkbox"/> Not in District or Landmark</p> <p><input type="checkbox"/> Does Not Require Review</p> <p><input type="checkbox"/> Requires Review</p> <p><input type="checkbox"/> Approved</p> <p><input type="checkbox"/> Approved w/Conditions</p> <p>Denied</p> <p>Date: 6/10/05</p>
--	--	--

CERTIFICATION

I hereby certify that I am the owner of record of the named property, or that the proposed work is authorized by the owner of record and that I have been authorized by the owner to make this application as his authorized agent and I agree to conform to all applicable laws of this jurisdiction. In addition, if a permit for work described in the application is issued, I certify that the code official's authorized representative shall have the authority to enter all areas covered by such permit at any reasonable hour to enforce the provision of the code(s) applicable to such permit.

SIGNATURE OF APPLICANT ADDRESS DATE PHONE

RESPONSIBLE PERSON IN CHARGE OF WORK, TITLE DATE PHONE

Pool Installation/Construction Permit Application

If you or the property owner owes real estate or personal property taxes or user charges on any property within the City, payment arrangements must be made before permits of any kind are accepted.

L DKE	
Total Square Footage of Proposed Structure	Square Footage of Lot
Tax Assessor's Chart, Block & Lot Chart# 352 Block# B010 Lot# 001	Owner: DON + JAVIEE ELLIOTT
Telephone:	797-8498
Lessee/Buyer's Name (If Applicable)	Applicant name, address & telephone: DON + JAVIEE ELLIOTT, 105 DOKE DR, PORTLAND - 797-8498
N/A	cost Of Work: \$ 16,995 Pool Price Fee: \$ 174.00
STREET, TOPSFIELD, MA 01983 Whom should we contact when the permit is ready: DONOR JAVIEE ELLIOTT, Mailing address: 105 DOKE DRIVE, PORTLAND, ME - 797-8498	
We will contact you by phone when the permit is ready. You must come in and pick up the permit and review the requirements before starting any work, with a Plan Reviewer. A stop work order will be issued and a \$100.00 fee if any work starts before the permit is picked up. PHONE:	

IF THE REQUIRED INFORMATION IS NOT INCLUDED IN THE SUBMISSIONS THE PERMIT WILL BE AUTOMATICALLY DENIED AT THE DISCRETION OF THE BUILDING/PLANNING DEPARTMENT, WE MAY REQUIRE ADDITIONAL INFORMATION IN ORDER TO APPROVE THIS PERMIT.

Signature of applicant: <i>Javiee A. Elliott</i>	Date: <i>May 27, 2005</i>
--	---------------------------

This is NOT a permit; you may not commence ANY work until the permit is issued.
 If you are in a Historic District you may be subject to additional permitting and fees with the Planning Department on the 4th floor of City Hall

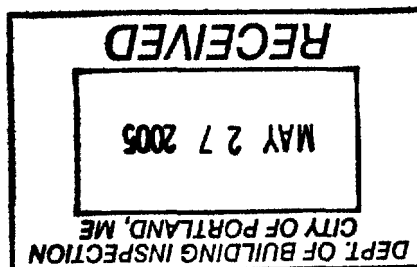

✓ # 3516

ATTACHMENT TO APPLICATION FOR SWIMMING POOL PERMIT

We have had a 24' round swimming pool in our back yard since 1980. We replaced the wall once and the liner twice during that time. The track, support posts and top rail were original. Part of the wall caved in during the winter months so we want to replace the old pool with a rectangular, easier to take of, pool from Gibraltar. We have removed the old pool from the premises. Enclosed are some pictures showing where the old pool was located. We want to put the new pool in approximately the same place. We have enclosed a color picture of the pool that we are buying. However, we will have the pool deck at the left end of the pool instead of the right end. The electrical box (shown as a box with the letter "E" in the plan that we drew) has been there since 1980 also. We want to locate the pool deck over the electrical box, and the enclosed drawing attempts to depict that.

The scale of the plan is that 1" equals approximately 8'.

Don and Janice Elliott
105 Dole Drive
Portland, me 04103
797-8498

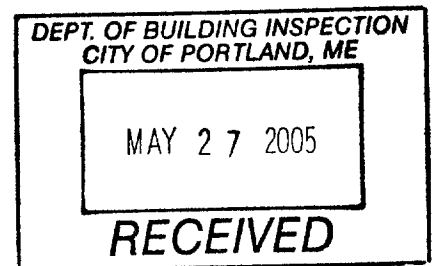

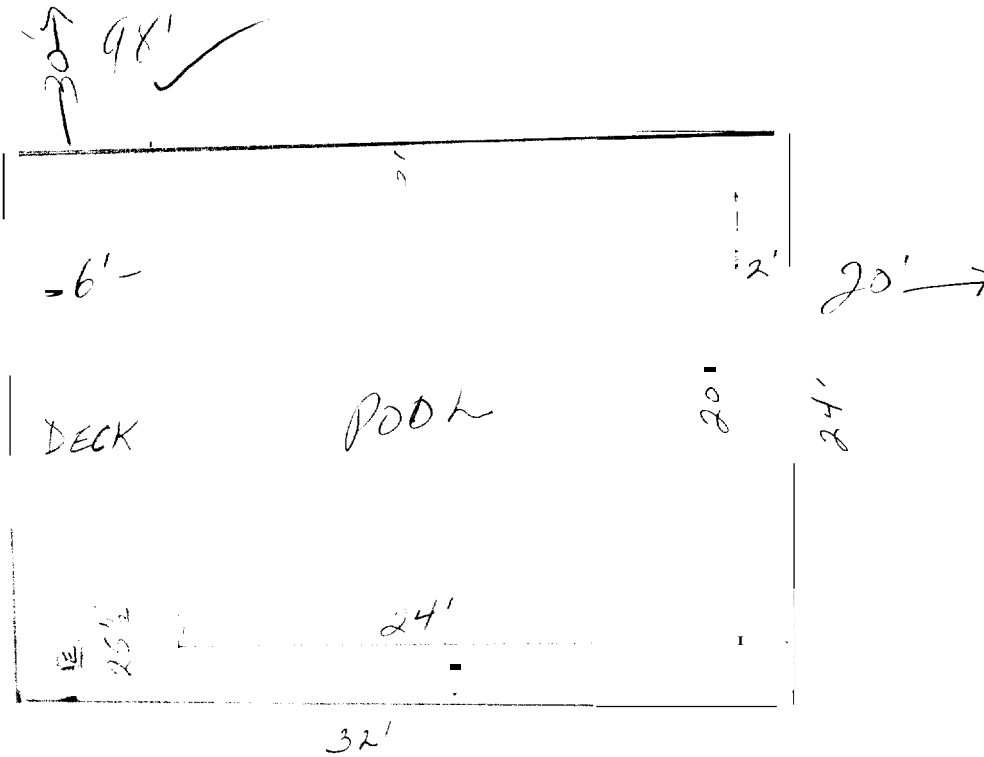
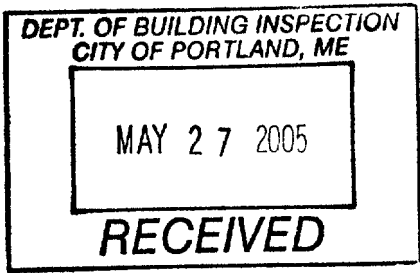

← 8

Spoke w/ Gibraltar -
ladder flips up.

24

R-2
25' Rear
12' Sides.
OK
Lot cov-OK

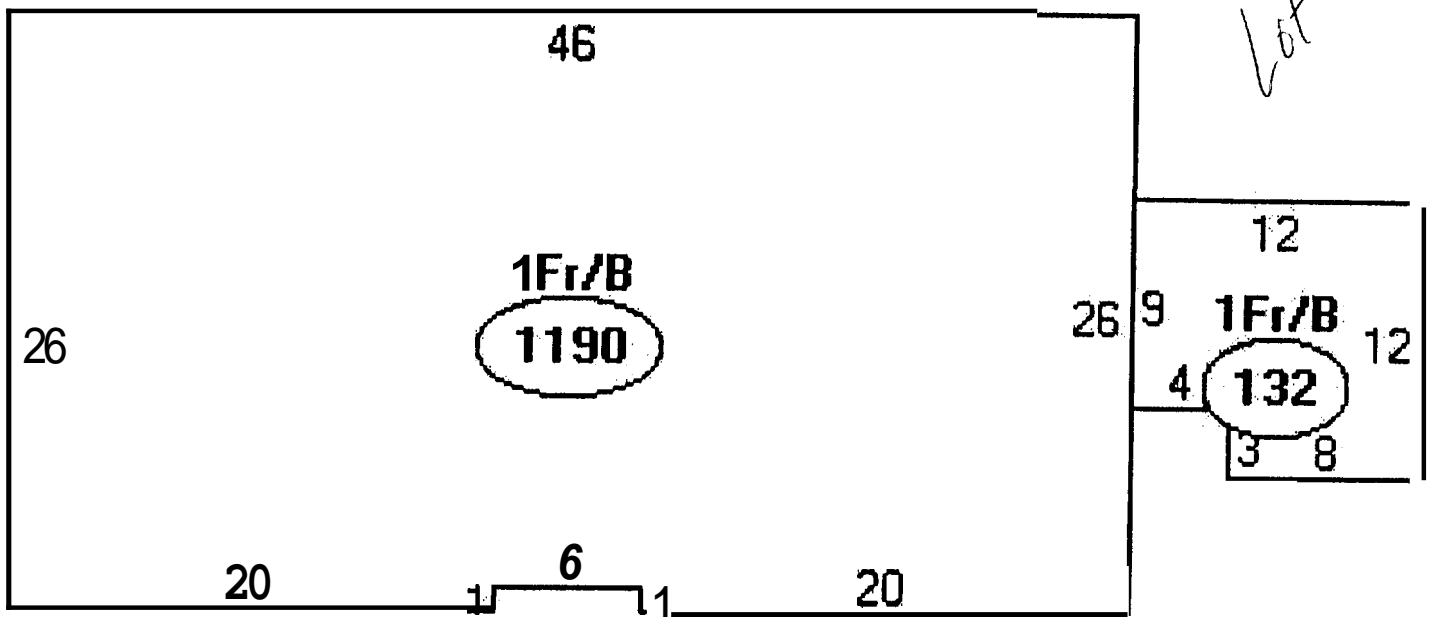

120'