

2017-07189
CBL 352 A025 001

Department of Health and Human Services
Maine Center for Disease Control and Prevention
286 Water Street
11 State House Station
Augusta, Maine 04333-0011
Tel: (207) 287-5672
Fax: (207) 287-4172; TTY: 1-800-606-0215

RECEIVED

MAY 16 2017

Permitting & Inspections
City of Portland Maine

SUBSURFACE WASTEWATER DISPOSAL SYSTEM VARIANCE REQUEST

This form must accompany an application (HHE-200 Form) for any subsurface wastewater disposal system which requires a variance to provisions of the Subsurface Wastewater Disposal Rules. The Local Plumbing Inspector must not issue a permit for the installation of a subsurface wastewater disposal system requiring a variance from the Department of Health and Human Services until approval has been received from the Department.

| | | |
|----------------------------|---------------------------------------|-----------------|
| GENERAL INFORMATION | Town of | <u>Portland</u> |
| Property Owner's Name: | <u>Mark Poplaski</u> | Tel. No.: |
| System's Location: | <u>60 Dole Drive</u> | |
| Property Owner's Address: | <u>60 Dole Drive, Portland, Maine</u> | Zip Code: |
| e-mail address: | <u>mrpoplaski@yahoo.com</u> | <u>04013</u> |

The subsurface wastewater disposal system design for the subject property requires a replacement system variance first time system variance to the Subsurface Wastewater Disposal Rules. This variance requires local approval local and state approval.

| SPECIFIC VARIANCE REQUESTED (To be filled in by Site Evaluator. Use additional sheets if needed.) | SECTION OF RULE |
|---|-----------------|
| 1. <u>Reduce separation from leachfield to property line from 10' to 8'</u> | <u>Table 8A</u> |
| 2. <u>Reduce separation from leachfield to garage from 15' to 10'</u> | <u>Table 8A</u> |
| 3. <u>Reduce separation from leachfield to shed from 15' to 8'</u> | <u>Table 8A</u> |

SITE EVALUATOR

When a property is found to be unsuitable for subsurface wastewater disposal by a licensed Site Evaluator, the Evaluator shall so inform the property owner. If the property owner, after exploring all other alternatives, wishes to request a variance to the Rules, and the Evaluator in his professional opinion feels the variance request is justified and the site limitations can be overcome, he shall document the soil and site conditions on the Application. The Evaluator shall list the specific variances necessary plus describe below the proposed system design and function. The Evaluator shall further describe how the specific site limitations are to be overcome, and provide any other support documentation as required prior to consideration by the Department. Attach a separate sheet if necessary.

Necessary to replace failing 1968 septic system.

I, Daye Chapman, S.E., certify that a variance to the Rules is necessary since a system cannot be installed which will completely satisfy all the Rule requirements. In my judgment, the proposed system design on the attached Application is the best alternative available; enhances the potential of the site for subsurface wastewater disposal; and that the system should function properly.

Daye Chapman
SIGNATURE OF SITE EVALUATOR

5-10-17
DATE

PROPERTY OWNER

I, Mark A Poplaski, am the owner agent for the owner of the subject property. I understand that the installation on the Application is not in total compliance with the Rules. Should the proposed system malfunction, I release all concerned provided they have performed their duties in a reasonable and proper manner, and I will promptly notify the Local Plumbing Inspector and make any corrections required by the Rules. By signing the variance request form, I acknowledge permission for representatives of the Department to enter onto the property to perform such duties as may be necessary to evaluate the variance request.

Mark A Poplaski
 SIGNATURE OF OWNER
 AGENT FOR THE OWNER

5-19-17
DATE

LOCAL PLUMBING INSPECTOR - Approval at local level

The local plumbing inspector shall review all variance requests prior to rendering a decision.

I, Douglas R. Noen, the undersigned, have visited the above property and find that the variance request submitted by the applicant does not conform with certain provisions of the wastewater disposal rules. The variance request submitted by the applicant is the best alternative for a subsurface wastewater disposal system on this property. The proposed system (does does not) conflict with any provisions controlling subsurface wastewater disposal in the shoreland zone. Therefore, I (do do not) approve the requested variance. I (will will not) issue a permit for the system's installation as proposed by the application.

Douglas R. Noen
LPI Signature

5/19/17
Date

LOCAL PLUMBING INSPECTOR - Referral to the Department

The local plumbing inspector shall review all variance requests prior to forwarding to the Division of Environmental Health.

I, _____, the undersigned, have visited the above property and find that the variance request submitted by the applicant does not conform with certain provisions of the wastewater disposal rules. The variance request submitted by the applicant is the best alternative for a subsurface wastewater disposal system on this property. The proposed system (does does not) conflict with any provisions controlling subsurface wastewater disposal in the shoreland zone. Therefore, I (do do not) recommend the issuance of a permit for the system's installation as proposed by the application.

LPI Signature

Date

FOR USE BY THE DEPARTMENT ONLY

The Department has reviewed the variance(s) and (does does not) give its approval. Any additional requirements, recommendations, or reasons for the Variance denial, are given in the attached letter.

SIGNATURE OF THE DEPARTMENT

DATE

- Notes: 1. Variances for soil conditions may be approved at the local level as long as the total point assessment is at least the minimum allowed. (See Section 7.B.4 of the Subsurface Wastewater Disposal Rules for Municipal Review.)
2. Variances for other than soil conditions or soil conditions beyond the limit of the LPI's authority are to be submitted to the Department for review. (See Section 7.B.3 for Department Review.) The LPI's signature is required on these variance requests prior to sending them to the Department.

SOIL, SITE AND ENGINEERING FACTORS FOR FIRST TIME SYSTEM VARIANCE ASSESSMENT WITH LIMITING SOIL DRAINAGE CONDITIONS (SEE TABLES 7C THROUGH 7M).

| | CHARACTERISTIC | POINT ASSESSMENT |
|--|--------------------------------|------------------|
| Soil Profile | | |
| Depth to Groundwater/Restrictive Layer | | |
| Terrain | | |
| Size of Property | | |
| Waterbody Setback | | |
| Water Supply | | |
| Type of Development | | |
| Disposal Area Adjustment | | |
| Vertical Separation Distance | | |
| Additional Treatment | | |
| | TOTAL POINT ASSESSMENT: | |

Minimum Points (Check One): Outside Shoreland Zone-50 Inside Shoreland Zone-65 Subdivision-65

SUBSURFACE WASTEWATER DISPOSAL SYSTEM APPLICATION

Maine Department of Human Services
 Division of Health Engineering, Station 10
 (207) 287-5672 Fax: (207) 287-3165

Town, City, Plantation
 Portland

Street, Road, Subdivision
 60 Dole Drive

Owner or Applicant Name
 Mark Poplaski

SUBSURFACE WASTEWATER DISPOSAL PLAN

Scale: 1" = 20 ft

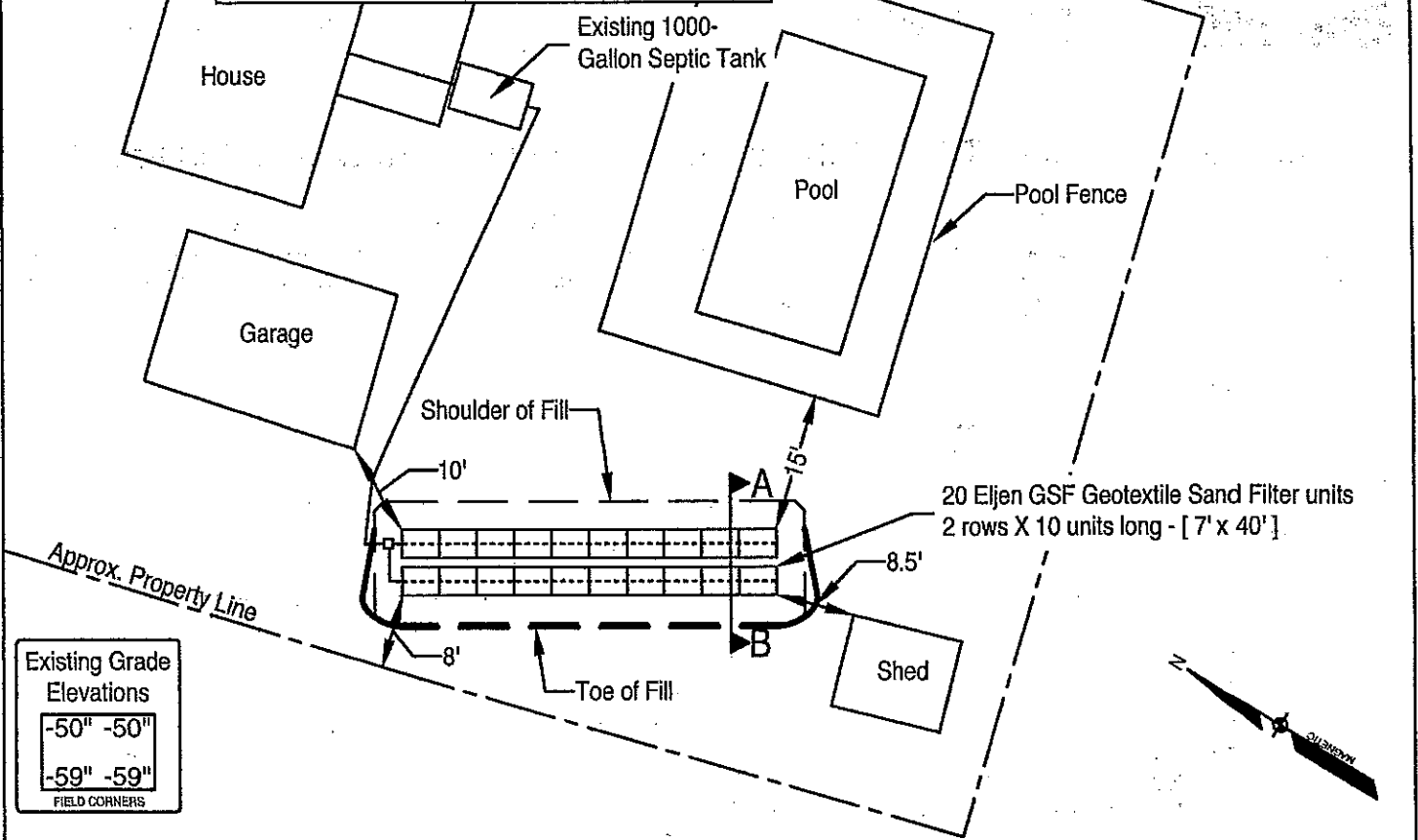

| Existing Grade Elevations | |
|---------------------------|------|
| -50" | -50" |
| -59" | -59" |
| FIELD CORNERS | |

BACKFILL REQUIREMENTS

Depth of Backfill (upslope) 0"
 Depth of Backfill (downslope) 4"

CONSTRUCTION ELEVATIONS

Finished Grade Elevation (at Row 1) -50"
 Top of Pipe -58"
 Bottom of Eljens -69"

ELEVATION REFERENCE POINT

Location & Description: Trim Board SW Garage
Flagged nail 31" Above Ground Corner
 Reference Elevation is 0.0" or:

NOTE: SCARIFY ALL GROUND SURFACE TO BE FILLED. USE GRAVELLY COARSE SAND WITHIN 3' OF ELJENS. REMAINING FILL: LOAMY SAND (no clay)

DISPOSAL FIELD CROSS SECTION

Scales:
 Vertical: 1" = 5'
 Horizontal: 1" = 5'

| | | |
|--------|------|------|
| ROW # | 1 | 2 |
| TOP | -58" | -63" |
| BOTTOM | -69" | -74" |

TOP OF ROW #1 INLET AT -58"

A

B

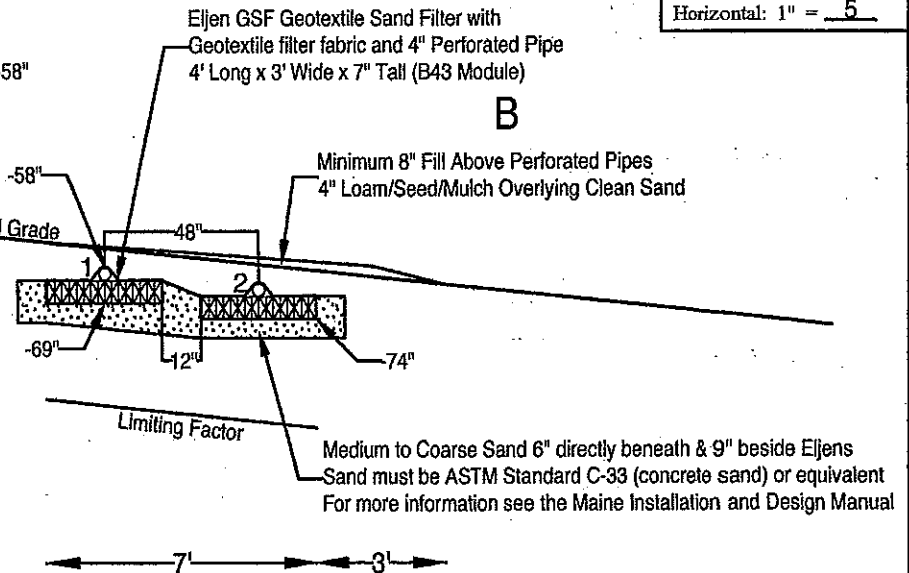

David V. Casper
 Site Evaluator Signature

293
 SE #

5-10-17
 Date

Page 3 of 3
 HHE-200 Rev. 2/11