

# SUBSURFACE WASTEWATER DISPOSAL SYSTEM APPLICATION

Maine Department of Human Services  
Division of Health Engineering, Station 10  
(207) 287-5672 Fax: (207) 287-3165

Town, City, Plantation  
**Portland**

Street, Road, Subdivision  
**60 Dole Drive**

Owner or Applicant Name  
**Mark Poplaski**

**SITE PLAN** Scale 1" = 50 ft.

**SITE LOCATION PLAN**

**NOTES:**

1. This is not a survey. All property lines, building locations and site features have been approximately located, unless otherwise shown.
2. Review the Eljen Geotextile Sand Filter (GSF) Design and Installation Manual before installing this system.
3. Replace broken septic tank outlet baffle with an outlet filter.

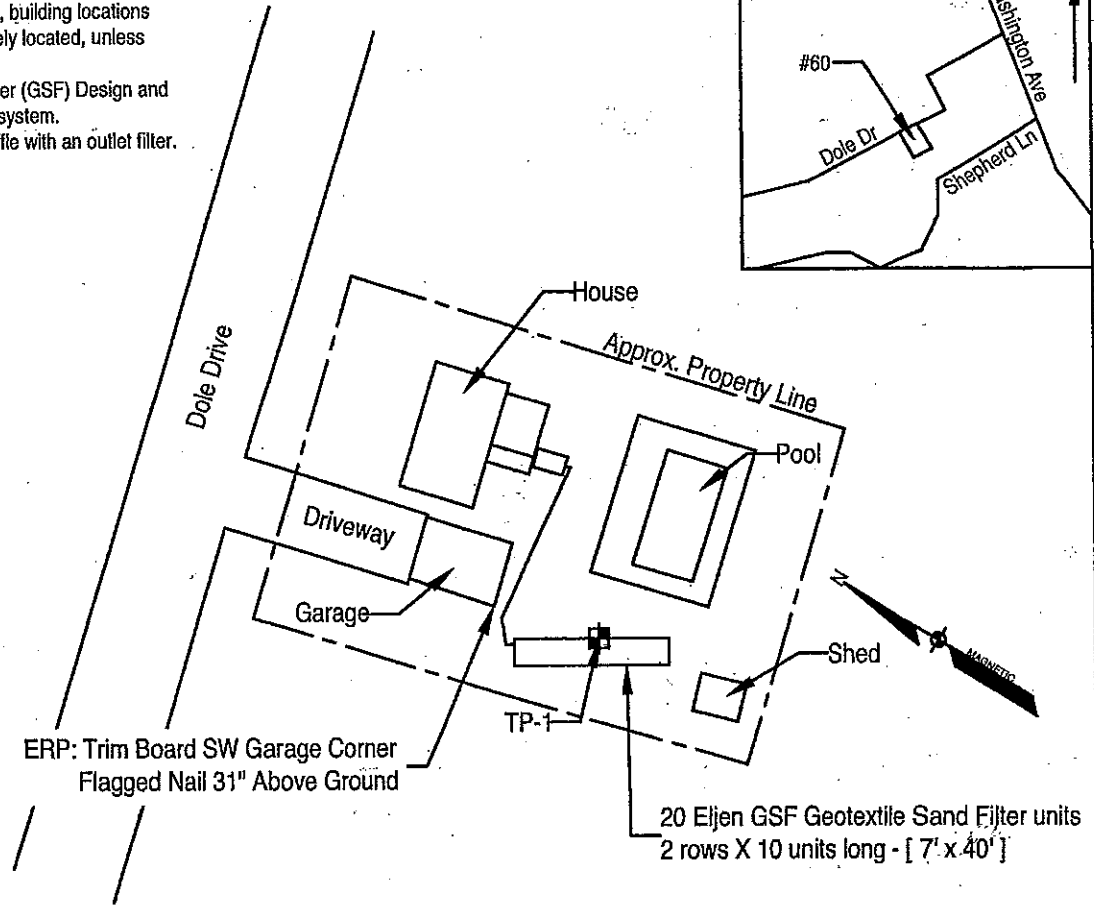

## SOIL PROFILE DESCRIPTION AND CLASSIFICATION (Location of Observation Holes Shown Above)

Observation Hole # TP-1  Test Pit  Boring

Observation Hole # \_\_\_\_\_  Test Pit  Boring

\_\_\_\_\_ " Depth of organic horizon above mineral soil

\_\_\_\_\_ " Depth of organic horizon above mineral soil

Depth below mineral soil surface (inches)	Texture	Consistency	Color	Mottling
0	Fine to Medium	Friable	Brown	
6	Sand (Fill)			
12				
18				
24	Fine to Medium Sand	Loose	Brown	
30			Reddish Brown to Yellowish Brown	
36				
42				
48				

Depth below mineral soil surface (inches)	Texture	Consistency	Color	Mottling
0				
6				
12				
18				
24				
30				
36				
42				
48				

Soil Profile	Classification Condition	Slope Percent	Limiting Factor Depth	<input checked="" type="checkbox"/> Groundwater <input type="checkbox"/> Restrictive Layer <input type="checkbox"/> Bedrock
5	C	8	43	

Soil Profile	Classification Condition	Slope Percent	Limiting Factor Depth	<input type="checkbox"/> Groundwater <input type="checkbox"/> Restrictive Layer <input type="checkbox"/> Bedrock

*David V. Chapman*  
Site Evaluator Signature

293  
SE #

5-10-17  
Date