

DISPLAY THIS CARD ON PRINCIPAL FRONTAGE OF WORK CITY OF PORTLAND

Please Read Application And Notes, If Any, Attached

BUILDING INSPECTION PERMIT

Permit Number: 070234

This is to certify that ROSSETTI PHILIP F JR & CATHERINE I ROSSETTI LTD Home

has permission to Install 8' x 10' Shed

AT 65 SHEPHERD LN

351 B007001

PERMIT ISSUED
MAR 14 2007
CITY OF PORTLAND

provided that the person or persons who accept this permit shall comply with all of the provisions of the Statutes of the State and of the Ordinances of the City of Portland regulating the construction, maintenance and use of buildings and structures, and of the application of file in this department.

Apply to Public Works for street line and grade if nature of work requires such information.

Notification of inspection must be given and when permission is procured before this building or part thereof is occupied or service is closed-in. 4 HOUR NOTICE REQUIRED.

A certificate of occupancy must be procured by owner before this building or part thereof is occupied.

OTHER REQUIRED APPROVALS

Fire Dept. _____

Health Dept. _____

Appeal Board _____

Other _____
Department Name

Thomas M. Mabley 3/7/07
Director - Building & Inspection Services

PENALTY FOR REMOVING THIS CARD

City of Portland, Maine - Building or Use Permit Application

389 Congress Street, 04101 Tel: (207) 874-8703, Fax: (207) 874-8716

Permit No: 07-0234	Issue Date:	CBL: 351 B007001
-----------------------	-------------	---------------------

Location of Construction: 65 SHEPHERD LN	Owner Name: ROSSETTI PHILIP F JR & KATH	Owner Address: 65 SHEPHERD LN	Phone:
Business Name:	Contractor Name: Home owner	Contractor Address:	Phone:
Lessee/Buyer's Name	Phone:	Permit Type: Sheds	Zone: R2

Past Use: Single Family Home	Proposed Use: Single Family Home - Install 8' x 10' Shed	Permit Fee: \$30.00	Cost of Work: \$1,000.00	CEO District: 5
Proposed Project Description: Install 8' x 10' Shed		FIRE DEPT: <input type="checkbox"/> Approved <input type="checkbox"/> Denied	INSPECTION: Use Group: R3 Type: SB IRC 2003 Signature: Jm 3/7/07	
		PEDESTRIAN ACTIVITIES DISTRICT (P.A.D.) Action: <input type="checkbox"/> Approved <input type="checkbox"/> Approved w/Conditions <input type="checkbox"/> Denied Signature: _____ Date: _____		

Permit Taken By: Idobson	Date Applied For: 03/07/2007	Zoning Approval
-----------------------------	---------------------------------	------------------------

1. This permit application does not preclude the Applicant(s) from meeting applicable State and Federal Rules.
2. Building permits do not include plumbing, septic or electrical work.
3. Building permits are void if work is not started within six (6) months of the date of issuance. False information may invalidate a building permit and stop all work..

Special Zone or Reviews <input type="checkbox"/> Shoreland <input type="checkbox"/> Wetland OK <input type="checkbox"/> Flood Zone <input type="checkbox"/> Subdivision <input type="checkbox"/> Site Plan Maj <input type="checkbox"/> Minor <input type="checkbox"/> MM <input type="checkbox"/> Date: 3/7/07	Zoning Appeal <input type="checkbox"/> Variance <input type="checkbox"/> Miscellaneous <input type="checkbox"/> Conditional Use <input type="checkbox"/> Interpretation <input type="checkbox"/> Approved <input type="checkbox"/> Denied Date: _____	Historic Preservation <input checked="" type="checkbox"/> Not in District or Landmark <input type="checkbox"/> Does Not Require Review <input type="checkbox"/> Requires Review <input type="checkbox"/> Approved NA <input type="checkbox"/> Approved w/Conditions <input type="checkbox"/> Denied Date: _____
--	---	--

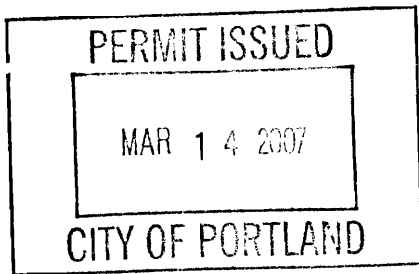

CERTIFICATION

I hereby certify that I am the owner of record of the named property, or that the proposed work is authorized by the owner of record and that I have been authorized by the owner to make this application as his authorized agent and I agree to conform to all applicable laws of this jurisdiction. In addition, if a permit for work described in the application is issued, I certify that the code official's authorized representative shall have the authority to enter all areas covered by such permit at any reasonable hour to enforce the provision of the code(s) applicable to such permit.

SIGNATURE OF APPLICANT	ADDRESS	DATE	PHONE
RESPONSIBLE PERSON IN CHARGE OF WORK, TITLE		DATE	PHONE

City of Portland, Maine - Building or Use Permit

389 Congress Street, 04101 Tel: (207) 874-8703, Fax: (207) 874-8716

Permit No: 07-0234	Date Applied For: 03/07/2007	CBL: 351 B007001
------------------------------	--	----------------------------

Location of Construction: 65 SHEPHERD LN	Owner Name: ROSSETTI PHILIP F JR & KATHE	Owner Address: 65 SHEPHERD LN	Phone:
Business Name:	Contractor Name: Home owner	Contractor Address:	Phone:
Lessee/Buyer's Name	Phone:	Permit Type: Sheds	

Proposed Use: Single Family Home - Install 8' x 10' Shed	Proposed Project Description: Install 8' x 10' Shed
--	---

Dept: Zoning **Status:** Approved **Reviewer:** Tom Markley **Approval Date:** 03/07/2007
Note: **Ok to Issue:**

Dept: Building **Status:** Approved with Conditions **Reviewer:** Tom Markley **Approval Date:** 03/07/2007
Note: **Ok to Issue:**

- 1) Separate permits are required for any electrical, plumbing, or HVAC systems. Separate plans may need to be submitted for approval as a part of this process.
- 2) Application approval based upon information provided by applicant. Any deviation from approved plans requires separate review and approval prior to work.
- 3) This structure is exempt from meeting the City of Portland Building Code based on size.



General Building Permit Application

If you or the property owner owes real estate or personal property taxes or user charges on any property within the City, payment arrangements must be made before permits of any kind are accepted.

Location/Address of Construction: <u>65 Shepherd Lane</u>		
Total Square Footage of Proposed Structure <u>10 x 8 = 80 SQ FT</u>		Square Footage of Lot
Tax Assessor's Chart, Block & Lot Chart# Block# Lot# <u>351 13007</u>	Owner: <u>Philip & Katherine Rossetti</u>	Telephone: <u>318-8189</u>
Lessee/Buyer's Name (If Applicable)	Applicant name, address & telephone: <u>Philip & Katherine Rossetti</u> <u>65 Shepherd Lane</u> <u>Portland, Me. 04103</u>	Cost Of Work: \$ <u>1000. -</u> Fee: \$ _____ C of O Fee: \$ _____
Current legal use (i.e. single family) <u>Single Family</u> If vacant, what was the previous use? _____ Proposed Specific use: _____ Is property part of a subdivision? _____ If yes, please name _____ Project description: <u>Bought from prison in North Windham</u> <u>when purchased home 8x10 Shed -</u>		
Contractor's name, address & telephone: Who should we contact when the permit is ready: <u>Katherine J. Rossetti</u> Mailing address: _____ Phone: <u>318-8189</u>		

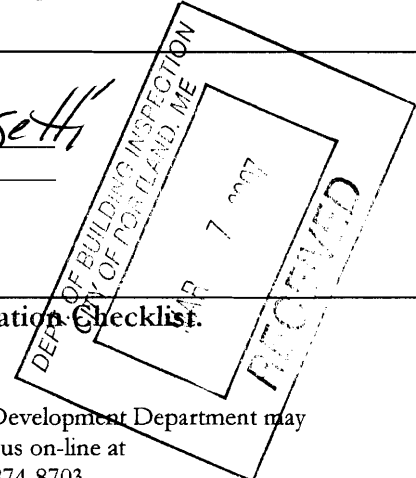

Please submit all of the information outlined in the Commercial Application Checklist. Failure to do so will result in the automatic denial of your permit.

In order to be sure the City fully understands the full scope of the project, the Planning and Development Department may request additional information prior to the issuance of a permit. For further information visit us on-line at www.portlandmaine.gov, stop by the Building Inspections office, room 315 City Hall or call 874-8703.

I hereby certify that I am the Owner of record of the named property, or that the owner of record authorizes the proposed work and that I have been authorized by the owner to make this application as his/her authorized agent. I agree to conform to all applicable laws of this jurisdiction. In addition, if a permit for work described in this application is issued, I certify that the Code Official's authorized representative shall have the authority to enter all areas covered by this permit at any reasonable hour to enforce the provisions of the codes applicable to this permit.

Signature of applicant: <u>Katherine J. Rossetti</u>	Date: <u>3/7/07</u>
--	---------------------

This is not a permit; you may not commence ANY work until the permit is issued.

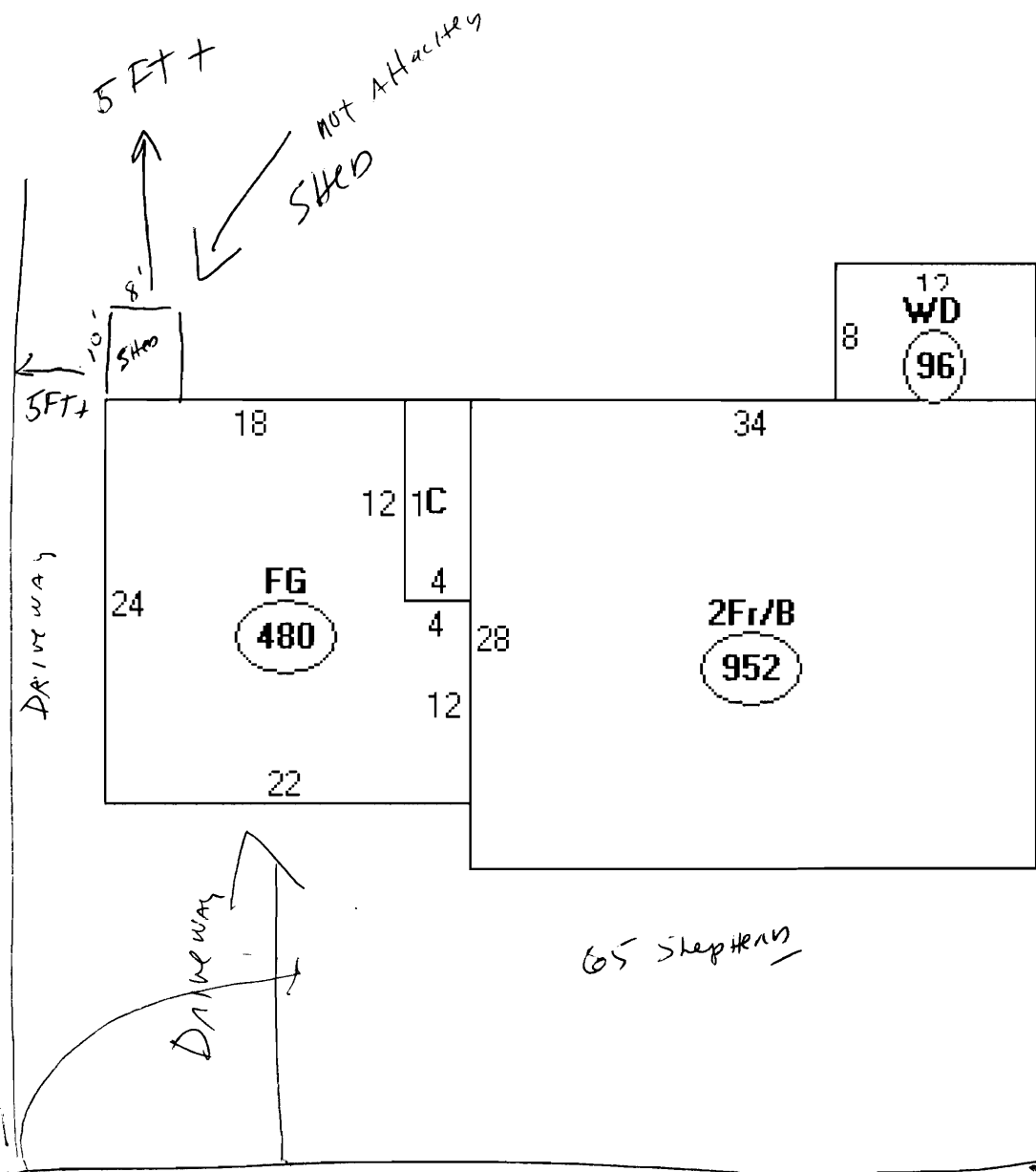

Descriptor/Area

A: 2Fr/B
952 sqft

B: FG
480 sqft

C: 1Fr
48 sqft

D: WD
96 sqft

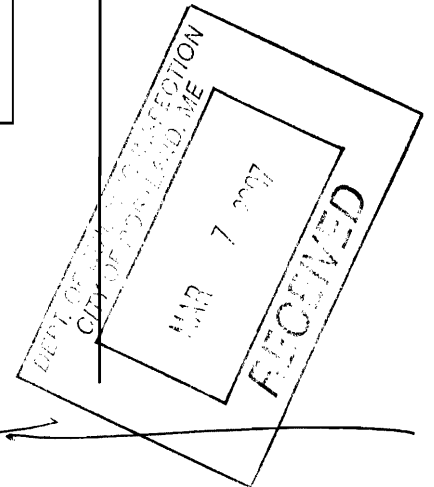

Shepherd Ln